



University of Central Florida
STARS

[Orange County Voter Registration](#)

[Vital Records of Central Florida](#)

1-1-1928

Orange County Voter Registration, Orlando, District 11, 1928-1930

Orange County

Find similar works at: <https://stars.library.ucf.edu/cfm-voter>
University of Central Florida Libraries <http://library.ucf.edu>

This Register is brought to you for free and open access by the Vital Records of Central Florida at STARS. It has been accepted for inclusion in Orange County Voter Registration by an authorized administrator of STARS. For more information, please contact STARS@ucf.edu.

Recommended Citation

Orange County, "Orange County Voter Registration, Orlando, District 11, 1928-1930" (1928). *Orange County Voter Registration*. 14.
<https://stars.library.ucf.edu/cfm-voter/14>



443

BOOK 443

PRECINCT REGISTER	
—FOR—	
<u>Orlando</u>	Precinct, <u>11</u>
<u>Orange</u>	County, Florida.

WALKER, EVANS & COGSWELL CO., CHARLESTON, S. C.

1930

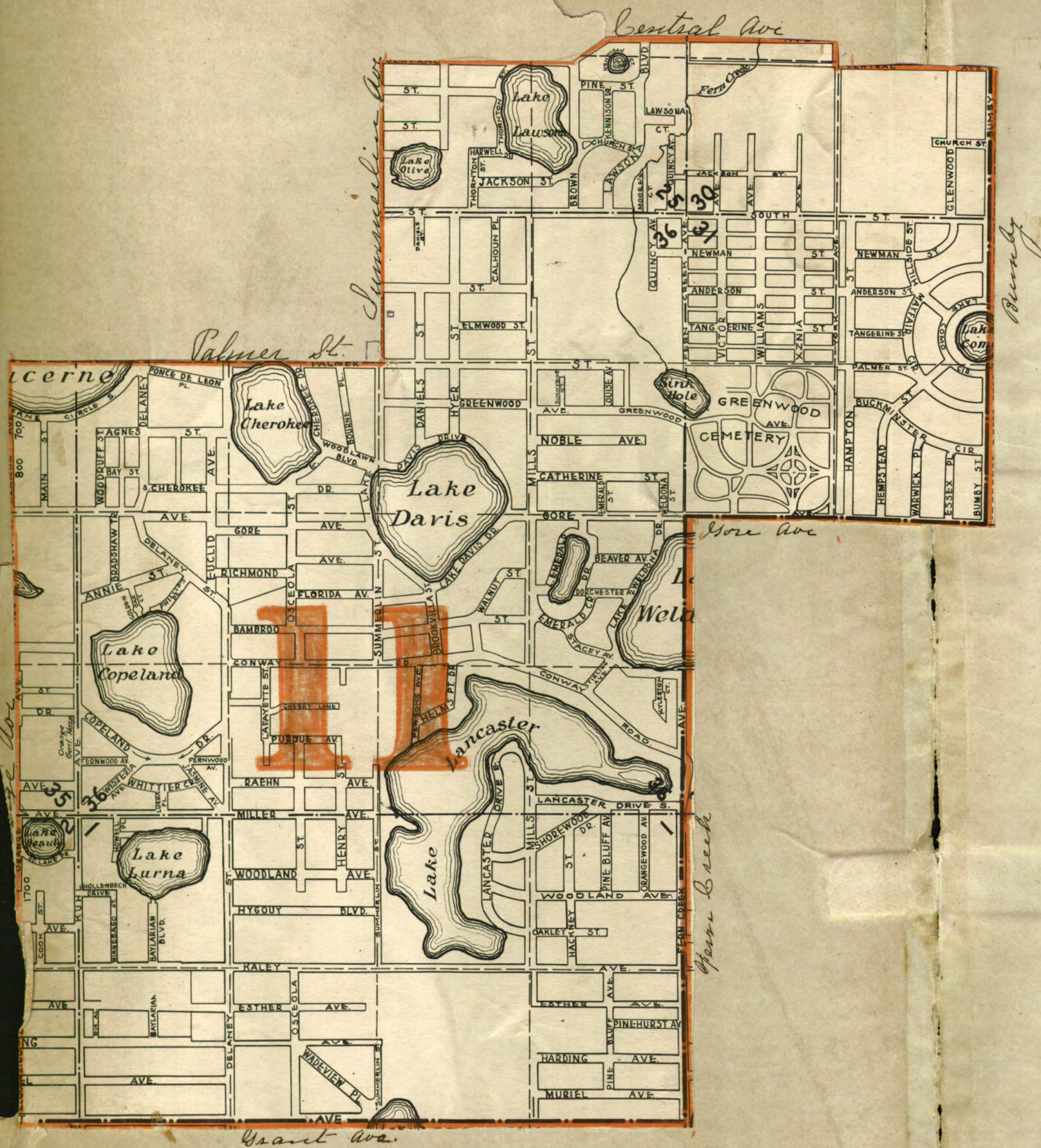

OFFICIAL REGISTER OF ELECTORS FOR

PRECINCT, COUNTY, FLORIDA

NUMBER	DATE	SURNAME AND GIVEN NAME	PARTY AFFILIATION	VOTED	POLL TAX		OCCUPATION	AGE	COLOR	NATIVITY	DECLARATION OR NATURALIZATION	RESIDENCE	OATH		SIGNATURE OF SUPERVISOR OR DEPUTY	REMARKS
					I, having been first duly sworn, say, upon Oath that the statements here entered opposite my name as to qualifications as an elector, are true											
					Year	Year							SIGNATURE OF ELECTOR			
52	3-31	Aulls Leila D.	R		Pd	Pd	Home	46	W	American		819 Anderson	Leila D. Aulls	Mina Jean Moore		
53	3-31	Aulls Lyman D.	R		Pd	Pd	Traffic Mgr.	47	W	American		819 Anderson	Lyman D. Aulls	"		owns property
94	4-5	Anderson Sarah A.	R		Ex	Ex	Nurse	75	W	Canadian	American by Marriage	212 Copeland	Sarah A. Anderson	"		owns property
0	4-11-30	Arthur A. E.	D		Pd	Pd	Contractor	41	"	American		1210 Kahl	A. E. Arthur	"		
	4-16-30	Allardice Ella W.	R				Home	36	"	"		1120 Greenwood	Ella W. Allardice	"		
	4-17-30	Allardice Edw H.	R		Pd	Pd	Contractors	39	"	"		1120 Greenwood	Edw H. Allardice	"		
0	4-20-30	Adams, Guinlan	D		Pd	Pd	Insurance	39	"	"		1115 Woodland	Guinlan Adams	"		
✓	4-20-30	Adams, Alice B.	D		Pd	Pd	Home	30	"	"		"	Alice B. Adams	J. H. Tucker		
	4-20-30	Alleman, Mrs. Byrde	R				Home	49	"	"		128 Thornton	Mrs. Byrde Alleman	"		
	4-30-30	Anderson, Lillian W.	D		Ex	Ex	Home	57	"	"		226 Annie	Mrs. Lillian W. Anderson	"		
	3-7-30	Anderson, Clara C.	I		Ex	Ex	Home	63	"	"		1144 S. Dedney	Signed in #12	"		

WALKER, EVANS & GODSWELL CO., CHARLESTON, S. C.

DATE	SURNAME AND GIVEN NAME	PARTY AFFILIATION	VOTED	POLL TAX		OCCUPATION	AGE	COLOR	NATIVITY	DECLARATION OR NATURALIZATION	RESIDENCE	OATH I, having been first duly sworn, say, upon Oath that the statements here entered opposite my name as to qualifications as an elector, are true		SIGNATURE OF SUPERVISOR OR DEPUTY	REMARKS
				Year	Year							SIGNATURE OF ELECTOR			
1930															
5 3/7	Bridges E. R. L.	R		pd	pd	Attorney	52	W	Amir		619 E Cherokee	E. S. Bridges	Wina Jean Moore		owns property
6 3/7	Bridges Emily L.	R		pd	pd	Home	45	W	Amir		" "	Emily L. Bridges	" "		owns property
7 3/7	Bridges Edward L.	R		pd	pd	Student	23	W	Amir		" "	Edward L. Bridges	" "		owns property
13-12	Bairden Fred R.	R		pd	pd	Attorney	27	W	american		1012 Hamwell	Fred R. Bairden	" "		no property
20 3/7	Batchelder Grace R.	R		pd	pd	Home	46	W	american		815 Woodlawn	Grace R. Batchelder	" "		owns property
31 3-26	Bickford C. L.	R		pd	pd	Asst Secretary	37	W	American		626 Florida	C. L. Bickford	" "		no property
34 3-27	Bales Milton M.	R		E	E	Minister	74	W	American		234 E. Miller	Milton M. Bales	" "		owns property
35 3-27	Bales Carrie H.	R		E	E	Home	61	W	American		234 E Miller	Mrs Carrie H. Bales	" "		owns property
45 3-31	Bartlett Henry	R		pd	E	Salesman	56	W	American		6. East Lucerne	Henry Bartlett	" "		no property
60 4-1	Brozier J. George	R		E	E	Chauffeur	58	W	American		614 So Lake St	George J. Brozier	" "		no property
69 4-2	Batchelder C. F.	R		pd	pd	Real Estate	50	W	American		815 Woodlawn	C. F. Batchelder	" "		owns property
91 4-4	Barry Ada M.	R				Home	53	W	American		1010 Elmwood	Ada M. Barry	" "		owns property
95 4-5	Beckett Paul	R		pd	pd	Attorney	40	W	American		704 E. Pine St.	Paul Beckett	" "		no property
4-17-30	Bacon Deveney Jr	D		pd	pd	Salesman	24	"	"		713 S. Sumner	Deveney Bacon, Jr.	J. H. Tucker		
4-30-30	Baronian, K. N.	D		pd	pd	Printer	35	"	"		813 Greenwood	K. N. Baronian	J. H. Tucker		

#1260626.

Mass. 1920.

OFFICIAL REGISTER OF ELECTORS FOR

PRECINCT, COUNTY, FLORIDA

DATE	SURNAME AND GIVEN NAME	PARTY AFFILIATION	VOTED	POLL TAX		OCCUPATION	AGE	COLOR	NATIVITY	DECLARATION OR NATURALIZATION	RESIDENCE	OATH		SIGNATURE OF SUPERVISOR OR DEPUTY	REMARKS
				Year	Year							I, having been first duly sworn, say, upon Oath that the statements here entered opposite my name as to qualifications as an elector, are true	SIGNATURE OF ELECTOR		
04-23-30	Boon, O. A.	✓	10	Pd	Pd	Insurance	36	W	American		526 Fla. Ave	O. A. Boon		J. H. Mucker	
04-23-30	Buckett, J. I.		10	Pd	Pd	City	30	W	American		1415 S. Asciola	J. I. Buckett		"	
04-24-30	Buckett, Geo M.		10			Clerk	33	W	American		138 E. Miami	Geo M Buckett		"	
04-28-30	Beatty, John W.	✓	D.	Pd	Pd	Bank Clerk	34	W			516 Woodland Ave.	John W. Beatty			
4-29-30	Berkowitz, Frances.		D.	Pd	Pd	Home.	29	W		# 976889 June 5, 1918.	1020 S. Delaney.	Frances Berkowitz			
✓4-30-30	Belitz, Nicholas.	✓	D.	Pd	Pd	Merchant.	36	W		Orange Co. 1924.	126 Kennison.	Nicholas Belitz			
✓4-30-30	Bruce, Eva M.	✓	D.	Ex	Ex	Saleslady.	58	W			1630 S. Delaney.	Eva M. Bruce			
4-30-30	Brown, Norah B.		D.	Ex	Ex	Home.	60	W			1309 Catherine.	Norah B Brown			
✓4-30-30	Brandt, Elvera.		R.	Pd	Pd	Bookkeeper.	39	W			900 E. Central.	Elvera Brandt			
✓4-30-30	Becton, Agnes L.		D.	Pd	Pd	Home.	31	W			906 E. Central.	Agnes L. Becton			
4-30-30	Bruce, Mildred M.		D.			Teacher.	25	W			1630 S. Delaney.	Mildred Bruce.			
04-30-30	Barry, Walter X.	✓	D.	Pd	Pd	Orlando Utilities	33	W			1010 Elmwood.	Walter X Barry			
4-30-30	Beardall, Florence.	✓	D.	Ex	Ex	Home.	70	W	England.	Orlando.	Orlando.	Florence Beardall			
4-30-30	Butt, Pauline.	✓	D.	Pd	Pd	Home.	34	W			331 Cherokee Dr.	Pauline Butt			
04-30-30	Butt, Nixon.		D.	✓	Pd	Pd	Auto.	31	W		331 Cherokee Dr.	Nixon Butt			
04-30-30	Burkhard, Jacob.		D.	Pd	Pd	Plumbing.	42	W	Germany.	nat. Orlando. 1912	1625 Henry St.	Signed in "R".			
04-29-30	Berkowitz, William	✓	D.	Pd	Pd	Business.	37	W		# 976889 June 5, 1918	1020 S. Delaney.				

(Over)

PRECINCT, _____ COUNTY, FLORIDA

DATE	SURNAME AND GIVEN NAME	PARTY AFFILIATION	VOTED	POLL TAX		OCCUPATION	AGE	COLOR	NATIVITY	DECLARATION OR NATURALIZATION	RESIDENCE	OATH		SIGNATURE OF SUPERVISOR OR DEPUTY	REMARKS
				Year	Year							I, having been first duly sworn, say, upon Oath that the statements here entered opposite my name as to qualifications as an elector, are true	SIGNATURE OF ELECTOR		
64-4-9-30	Buchanan, J. P.	✓ D	pd.	pd.	Constable	36	W	American			1322 E. Kalyane	J. P. Buchanan	J. H. Tucker		
93-9-30	Bruce, C. M.	✓ D	ex	ex	Meat Cutter	64	"	"			1630 S. DeLaney	C. M. Bruce	"		
10-8-30	Branham, J. J.	D	pd	pd.	Insurance	32	"	"			702 Woodruff	J. J. Branham	"		
4-9-30	Barnum, N. B.	✓ D	pd.	pd.	Clerk	43	"	"			934 Bradshaw	N. B. Barnum	"		
4-12-30	Barlow, A. W.	✓ W	pd.	pd.	Salisman	51	"	"			1879 Hallenbeck	A. W. Barlow	"		
4-14-30	Beardall, William	✓ W	pd.	pd.	Lawyer	39	"	"			214 Lucerne Circle	William Beardall	"		
4-14-30	Bledsoe, Elba	✓ W	pd.	pd.	Clerk	52	"	"			910 E. Pine	Elba Bledsoe	"		
4-15-30	Blakemore, N. E.	✓ W	pd.	pd.	Jeweler	42	"	"		(Has receipt)	1500 S. Summitt	N. E. Blakemore	"		
4-18-30	Branham, A. E.	✓ W	ex	ex	Orange Grower	70	"	"			126 Lucerne	A. E. Branham	"		
4-18-30	Branham, Mrs. E. L.	✓ W	ex	ex	Home	70	"	"			126 Lucerne	E. L. Branham	"		
4-18-30	Branham, Mary L.	✓ W	pd.	pd.	Teacher	40	"	"			126 Lucerne	Mary L. Branham	"		
4-19-30	Bennett, R. M.	✓ W	ex	ex	City	70	"	"			700 E. Central	R. M. Bennett	"		
4-22-30	Beardall, Laura J.	✓ W	pd.	pd.	Home	21	"	"			700 Euclid	Laura J. Beardall	"		
4-22-30	Buechler, C. H.	✓ W	pd.	pd.	Retired	51	"	"			918 Arcola	C. H. Buechler	"		
4-23-30	Buchanan, J. D.	W	ex	ex	Labor	66	"	"			1212 E. Muriel	J. D. Buchanan	"		
4-24-30	Bledsoe, Susie	✓ W	pd.	pd.	Home	40	"	"			910 E. Pine	Susie M. Bledsoe	"		
4-24-30	Baker, John D.	✓ W	pd.	pd.	Lawyer	32	"	"			330 Jasmine Ave.	John D. Baker	"		
4-25-30	Bae, Louis	W	pd.	pd.	Druggist	39	W	"			1724 Kuhl Ave.	Louis Bae	"		
4-26-30	Beatty, Beulah	W	pd.	pd.	Beauty Operator	39	"	"			516 Woodland	Beulah Beatty	"		
4-26-30	Branham, Dorothy R.	W	pd.	pd.	Home	26	"	"			702 Woodruff	Dorothy R. Branham	"		
4-28-30	^{Brokmann} Branham, Henry E.	R.	pd.	pd.	Wholesale	26	"	"			715 Delaney Park Dr.	Henry E. Branham	"		
4-28-30	Boyd, P. M.	✓ D	pd.	pd.	Preacher	40	W	"			119 Annie	P. M. Boyd	"		
4-28-30	Bailey, Mrs. E. E.	D	ex	ex	Home	61	"	"			511 Daniels	Mrs. E. E. Bailey	"		
4-29-30	Beardall, H. M.	✓ D	pd.	pd.	Physician	44	"	"			700 Euclid	H. M. Beardall	"		
4-29-30	Boyd, Mary S.	✓ D	pd.	pd.	Home	26	"	"			119 Annie St.	Mary S. Boyd	"		
4-30	Brown, C. L.	✓ D	pd.	pd.	✓										
4-30	Brown, Emma H.	D	pd.	pd.	✓										Signed in General Regis. Book.

OFFICIAL REGISTER OF ELECTORS FOR

PRECINCT,

COUNTY, FLORIDA

NUMBER	DATE	SURNAME AND GIVEN NAME	PARTY AFFILIATION	VOTED	POLL TAX		OCCUPATION	AGE	COLOR	NATIVITY	DECLARATION OR NATURALIZATION	RESIDENCE	OATH		SIGNATURE OF SUPERVISOR OR DEPUTY	REMARKS
					Year	Year							I, having been first duly sworn, say, upon Oath that the statements here entered opposite my name as to qualifications as an elector, are true	SIGNATURE OF ELECTOR		
	1930															
3	3/6	Cunningham Edgar S.	RD.	Ex	x		Civil Engineer	63	W.	Amer.		519 So. Hyer	Edgar S. Cunningham	Nina Jean Moore		owns property
4	3/6	Cunningham Claude R.	RD.				Home	53	W.	Amer.		519 S Hyer	Claude R. Cunningham	Nina Jean Moore		
9	3/10	Baldwell John C.	RD.	x	x		National Guard	25	W.	Amer		422 S. Osceola	John C. Caldwell			should be in 12
26	3-22	Cole Elma C.	R.	x	x		Home	67	W.	American		1606 Palmer	Elma C. Cole			owns property
38	3-27	Carter A. J.	RD.	Pd	Pd.		Hdms. Merchant	47	W.	American		627 Cherokee Drive	Carter A.J.			owns property
39	3-27	Carter Annie Leal	RD.	Pd.	Pd.		Home	47	W.	American		627 Cherokee Drive	Carter Annie Leal			owns property
61	4-1	Cavanaugh Wm H.	RD.	x	x		Retired	58	W.	American		114 Lawsons ^{Blod.}	Wm H. Cavanaugh			no property
63	4-1	Cavanaugh Mary E.	RD.	x	x		Home	57	W.	American		114 Lawsons ^{Blod.}	Mary E. Cavanaugh			no property
77	4-2	Conoly S. F.	RD.	Pd.	Pd.		Sanitary Insp.	26	W.	American		So Mills Estn	S. F. Conoly			owns property
86	4-3	Collier Hattie	R.	x	x		Artist	57	W.	American		800 Anderson St	Hattie Collier			owns property
87	4-3	Collins Chas. C.	R.	x	x		Salesman	58	W.	American		300 Anderson	Chas. C. Collins			owns property
96	4-5	Chapman Julia R.	RD.	Pd	Pd.		Ticket aqt.	54	W.	American		543 Mangrove ^{Emp}	Julia R. Chapman			owns property
102	4-5	Cory Ruth	R.	Pd	Pd.		Nurse	26	W.	American		516 Daniels St	Ruth Cory			no property
103	4-5	Cory Leland	R.	Pd	Pd.		Bookkeeper	28	W.	American		516 Daniels St.	Leland Cory			no property
118	4-7	Claybaugh Goldine	R.	Pd	not		Home	48	W.	American		205 Copeland Dr.	Goldine Claybaugh			owns property
119	4-7	Claybaugh Nat R.	R.	Ex	x		Realtor	60	W.	American		"	Nat R. Claybaugh			owns property
120	4-7	Culver Adelaide L.	RD.	Pd	not		Home	39	W.	American		1023 E. Jackson St.	Adelaide L. Culver			no property
121	4-7	Culver Julian J.	RD.	Pd	not		Entomologist	43	W.	American		" " "	Julian J. Culver			no property
94	4.9.30	Collins Charles J.	RD.	at.	Pd.		Physician	30	"	"		213 Whittier	Charles J. Collins	J. H. Tucker		
4-16.30		Crabbs C. L.	R.	Ex	Ex		Retired	63	"	"		115 S. Brown	C. L. Crabbs			
4-17.30		Crabbs Helen	R.	Pd.	Pd.		Sec	25	"	"		115 So. Brown	Helen C. Crabbs			
4-19.30		Cot. E. J.	W.	Pd	Pd.		Contractor	47	"	"		Mayfair	E. J. Cox			
4-21.30		Cobb N. J. Jr	Ind	Pd.	Pd.		Printing	31	"	"		1508 S. Delaney	N. J. Cobb			
4-22.30		Cobb Eleanor H.	I	Ex	x		Home	60	"	"		" " "	Eleanor H. Cobb			
4-22.30		Caruthon John W.	W	Pd.	Pd.		Merchant	48	"	"		801 S. Euclid	John W. Caruthon			
4-25.30		Caruthon J. M.	D.	Pd	Pd.		Florist	46	"	"		936 S. Delaney	J. M. Caruthon			
4-26.30		Covey Roy B.	W	not	Pd		P. O.	44	W.	"		1223 E. Gore	Roy B. Covey			
4-26.30		Cot. Leah	W		Pd.		Home	46	W.	"		Mayfair Ct	Leah Cox			
4-26.30		Cornac Frank E.	R.	Pd.			Real Estate	52	"	"		107 Annie	Frank E. Cornac			
4-28-30		Cavanaugh M. Agnes	D.	Pd.	Pd.		Bookkeeper	27	"	"		114 Lawsons Bld.	M. Agnes Cavanaugh			
4-28-30		Cobb N. J.	Ind.	Ex	Ex.		Auditor	63	"	"		1508 S. Delaney	N. J. Cobb			
4-29-30		Covey Mrs. C. B.	D.	Ex	Ex.		Home	57	W.	"		1223 E. Gore	Mrs. C. B. Covey			
4-30-30		Chance L. A.	D.	x	x.		Grocer	58	W.	"		1601 Kuhl Ave.	L. A. Chance			

NUMBER	DATE	SURNAME AND GIVEN NAME	PARTY AFFILIATION	VOTED	POLL TAX		OCCUPATION	AGE	COLOR	NATIVITY	DECLARATION OR NATURALIZATION	RESIDENCE	OATH		SIGNATURE OF SUPERVISOR OR DEPUTY	REMARKS
					Year	Year							I, having been first duly sworn, say, upon Oath that the statements here entered opposite my name as to qualifications as an elector, are true			
													SIGNATURE OF ELECTOR			
	4-30-30	Cole, Arthur L.	R.		Pd	✓	Jeweler.	49	w			443 Rahn.	Arthur L. Cole		J. H. Tucker	
✓	4-30-30	Crews, Mrs. Mary	R.		Pd	Pd	Clerk.	34	w			1112 Palmer.	Mrs Mary Crews		" "	
✓	4-30-30	Calhoun, S. W.	D.		Pd	Pd	Auditor.	33	w			709 S. Hammerlin.	S. W. Calhoun		" "	
	4-5-30	Cot, A. L.	W		ad.		Fireman	53	"			206. Copeland	See # 20 for Signature		" "	
	4-5-30	Cot, Mabel B.	W				Home	24	"			" "	" "		" "	
	4-29-30	Caruthers, Mary L.	D.		Pd	Pd	Home.	21	"			126 America.	Signed in # 20		" "	
	10-14-30	Condrey E. L.	R.				Home	62	W.	amrc.		526 Daniels	Mrs. E. L. Condrey			Property

OFFICIAL REGISTER OF ELECTORS FOR

PRECINCT, COUNTY, FLORIDA

NUMBER	DATE	SURNAME AND GIVEN NAME	PARTY AFFILIATION	VOTED	POLL TAX		OCCUPATION	AGE	COLOR	NATIVITY	DECLARATION OR NATURALIZATION	RESIDENCE	OATH I, having been first duly sworn, say, upon Oath that the statements here entered opposite my name as to qualifications as an elector, are true		SIGNATURE OF SUPERVISOR OR DEPUTY	REMARKS
					Year	Year										
18	3/15	Dickinson J. J.	R.				Attorney	57	W.	American		625 Palm St	J. J. Dickinson	Nina Jean Moore		owns property
19	3/17	Dickinson, Sinah J.	R.				Home	36	W.	American		625 Palm St	Sinah J. Dickinson	"	"	no property
36	3/27	Diamond Elsie M.	R.	Ex	Ex		Home	58	W.	American		1203 Kuhl Ave	Diamond, Elsie M.	"	"	owns property
37	3/27	Diamond W. R.	R.	Ex	Ex		Retired	59	W.	American	Jan. 18-94 Pittsburg, Penn. Common Pleas Court no. 1.	1203 Kuhl Ave	Diamond W. R.	"	"	owns property
57	3-31	Douglass, M.	R.	Ex	Ex		Retired	67	W.	Scotland		515 Daniels St	Douglass, M.	"	"	owns property
56	3-31	Douglass, Lizzie	R.	Ex	Ex		Home	59	W.	American		515 Daniels	Douglass Lizzie	"	"	owns property
78	4-2	Donnelly, C. Belle J.	R.	Ex	Ex		Home	57	W.	American		708 Anderson	C. Belle J. Donnelly	"	"	owns property
135	4-7	Donohue Sarah E.	R.	Ex	Ex		Home	68	W.	American		1214 Greenwood St	Sarah E. Donohue	"	"	owns property
141	4-7	Davis Martha	✓ R.	Pd	Pd		Home	40	W.	American		120 South Thornton	Martha Davis	J. H. Tucker	"	no property
142	4-7	Davis W. Clyde	✓ R.	Pd	Pd		Home	46	W.	American		"	W. Clyde Davis	"	"	owns property
4-11-30		Davis, Rolf J.	R.				Merchant	26	W.	"		615 Woodlawn	J. Rolf Davis	"	"	
4-15-30		Dean, J. H.	W.	Pd	Pd		Auto Dealer	50	W.	"		710 S. Delaney	See R. for Signature	"	"	
4-17-30		Delaparte W. B.	✓ W.	Pd	Pd		Salesman	50	W.	"		521 Richmond	W. B. Delaparte	"	"	
4-17-30		Duston, Martha J.	R.	Ex	Ex		Nurse	71	"	"		Euclid Ave	Martha J. Duston	"	"	
4-21-30		Davis, M. C.	D.	Pd	Pd		Y-Do Co.	25	W.	"		12 Kennerly St	M. C. Davis	"	"	
4-21-30		Drake, C. W.	✓ W.	Pd	Pd		Salesman	29	"	"		1307 Menard Ave	C. W. Drake	"	"	
4-22-30		Dungan, Honor	R.	Pd	Pd		Crate	50	"	"		1224 Palmer St	Honor E. Dungan	"	"	
4-22-30		Davis, Paul J.	✓ W.	Ex	Ex		Corp. Lawyer	59	"	"		1600 S. Delaney	Paul J. Davis	"	"	
4-24-30		Dabson, Margret	I	Ex	Ex		Home	71	"	"		1201 Hollinbeck	Margret Dabson	"	"	
4-24-30		Dabson, Henry	I	Ex	Ex		Retired	74	"	"		1801 Hollinbeck	Henry Dabson	"	"	
4-2		Dunn, Augusta H.	✓ W.	Ex	Ex		Home	75	"	"		309 Cherokee Rd	Mrs. Augusta H. Dunn	"	"	
4-29-30		Dewar, W. E.	R.	Pd	Pd		Bookkeeper	44	W.	"		1523 Conway Rd.	W. E. Dewar	"	"	
4-30-30		Dean, Hunt P.	D.	Pd			Home	42	"	"		710 S. Delaney	Hunt P. Dean	"	"	
4-30-30		Drake, Beulah	R.				Sec.	43	W.	"		707 E. Pine	Mrs. Beulah Drake	"	"	
4-30-30		Daniels, Asa W.	D.	Ex	Ex		Salesman	57	W.	"		530 Esther St.	Asa W. Daniels	"	"	
4-30-30		Dungan, R. M.	R.	Pd	Pd		R. E.	51	W.	"		1224 Palmer	R. M. Dungan	"	"	
4-30-30		Daniels, Gilbert H.	R.	Pd	Pd		Clerk	26	W.	"		1002 Delaney Park	Gilbert H. Daniels	"	"	

NUMBER	DATE	SURNAME AND GIVEN NAME	PARTY AFFILIATION	VOTED	POLL TAX		OCCUPATION	AGE	COLOR	NATIVITY	DECLARATION OR NATURALIZATION	RESIDENCE	OATH		SIGNATURE OF SUPERVISOR OR DEPUTY	REMARKS
					Year	Year							I, having been first duly sworn, say, upon Oath that the statements here entered opposite my name as to qualifications as an elector, are true			
													SIGNATURE OF ELECTOR			
	1930															
27	3-22	Edward Gaston H.	✓ D.		pd	pd	Surgeon	54		american		309 Chewpuck	Gaston H. Edwards	Nina Jean Moore		owns property
28	3-22	Edward Adair H.	✓ D.		pd	pd	Home	47		american		309 Chewpuck	Adair H. Edwards	"		owns property
✓	4-16-30	S. E. Echols	✓ D.		ex	ex	Farming	61	H	"		1216 Palmer	S. E. Echols	J. H. Tucker		
✓	4-16-30	Estes V. W.	✓ D.		pd	pd	Real Estate	44	"	"		221 E. Loring	W. V. Estes	J. H. Tucker		
✓	4-22-30	Empie, Marie H.	✓ D.		pd	pd	Bookkeeper	39	"	"		500 Richmond	Marie H. Empie	J. H. Tucker		
✓	4-22-30	Empie, John F.	✓ D.		pd	pd	Merchant	47	"	"		"	John F. Empie	J. H. Tucker		
✓	4-25-30	Estes, Judith	✓ D.		pd	pd	Home	42	"	"		121 E. Loring	Judith Estes	J. H. Tucker		
✓	4-25-30	Estes, Dorothy	✓ D.		ex	ex	Home	21	"	"		"	Dorothy Estes	J. H. Tucker		
✓	4-25-30	Echols, Katie Sue	✓ D.		pd	pd	Teacher	27	"	"		1216 Palmer	Katie Sue Echols	"	"	
✓	4-26-30	Ellison, V. D.	✓ D.		pd	pd						122 E. Esther	V. D. Ellison	"	"	
✓	4-28-30	Ebsen, C. L.	✓ D.		ex	ex	Teacher	58	w			9 S. Hyer	C. L. Ebsen	"	"	
	4-29-30	Essington, Shirley	✓ D.		pd	pd	Home	43	w			719 Endicott	Shirley C. Essington	"	"	
	4-29-30	Essington, W. C.	✓ D.		pd	pd	Investment	44	w			"	W. C. Essington	"	"	
	4-29-30	Englehard, Harry C.	✓ D.		pd	pd	Doct.	26	w			706 East Pine	Harry C. Engelhard	"	"	
✓	4-29-30	Evans, Z. W.	✓ R.		ex	ex	Retired	69	w			201 E. Miller	Z. W. Evans	"	"	
	4-29-30	Evans, Mrs. Z. W.	✓ R.		ex	ex	Home	68	w			201 E. Miller	Mrs. Z. W. Evans	"	"	
✓	4-30-30	Ellars, Martha E.	✓ D.		ex	ex	Home	69	w			941 Kuhl	Mrs. Martha E. Ellars	"	"	
✓	4-30-30	Echols, Maude F.	✓ D.		pd	pd	House	53	w			1216 Palmer	Mrs. Maude F. Echols	"	"	
✓	4-30-30	Ellars, O. R.	✓ D.		pd	pd	Lawyer	32	w			941 Kuhl	O. R. Ellars	"	"	
✓	4-30-30	Eberhardt, Mrs. W. F.	✓ D.		pd	pd	Merchant	27	w			127 Kennison	Mrs. W. F. Eberhardt	"	"	
	4-30-30	Engler, Mrs. Clara	✓ R.				Home	51	w			1218 Greenwood	Mrs. Clara Engler	"	"	

NUMBER	DATE	SURNAME AND GIVEN NAME	PARTY AFFILIATION	VOTED	POLL TAX		OCCUPATION	AGE	COLOR	NATIVITY	DECLARATION OR NATURALIZATION	RESIDENCE	OATH		SIGNATURE OF SUPERVISOR OR DEPUTY	REMARKS
					Year	Year							I, having been first duly sworn, say, upon Oath that the statements here entered opposite my name as to qualifications as an elector, are true	SIGNATURE OF ELECTOR		
	1930															
23	3-20	Frese Elizabeth	✓ D		Pl	Pl	Teacher	48	W	American		509 So. Osceola	Elizabeth Frese	Nina Jean Moore		owns property
41	3-29	Fuller Edna G.	✓ D		Pl	Pl	Home	56	W	American		605 De Laney	Edna G. Fuller			owns property
42	3-29	Fuller Dorothy	✓ D		Ex	Ex	Home	21	W			605 De Laney	Dorothy Fuller			
46	3-31	Frese A. J.	✓ D		Pl	Pl	None	55	W	Germany	July 12-1909 Boston, Mass. U.S. District Court Boston, Mass.	509 So. Osceola	A. J. Frese			owns property
47	3-31	Fort Leon B.	✓ D		Pl	Pl	Garage	43	W	American		604 So. Cherokee	Leon B. Fort			owns property
92	4-5	Ferguson, Frank L.	R.		Ex	Ex	Real Estate	68	W	Canada	New Haven Conn. 1888	21 E. Copland Ave	Frank L. Ferguson			owns property
93	4-5	Ferguson, Margaret J.	R.		Ex	Ex	Home	67	W	American		" "	Margaret J. Ferguson			owns property
13	4-8-30	Fillyaw, H. M.	✓ D		Ex	Ex	B. Watchman	65	"	"		Orlando	H. M. Fillyaw	J. H. Tucker		
✓	4-14-30	Fishback, G. B.	✓ W		Pl	Pl	Lawyer	37	"	"		1222 E. Kaley	G. B. Fishback			Pine beetle Trans # 41
✓	4-15-30	Foster, R. G.	✓ W		Ex	Ex	Janitor	63	"	"		815 Palmer St	R. G. Foster			
✓	4-22-30	Franklin, Pearl C.	✓ W		Pl	Pl	Home	45	"	"		214 J. Thonon	Pearl C. Franklin			
	4-22-30	Franklin, A. L.	✓ W		Pl	Pl	Real Estate	50	"	"		214 J. Thonon St.	A. L. Franklin			
✓	4-22-30	Freeman, Marie	✓ W		Pl	Pl	Home	33	"	"		1213 S. De Laney	Marie Freeman			
✓	4-22-30	Freeman, W. H.	✓ W		Pl	Pl	Manager	34	"	"		1213 S. De Laney	W. H. Freeman Jr			
✓	4-24-30	Ford, W. J. G.	✓ W		Pl	Pl	Physician	37	"	"		1248 Thornton	Dr. J. G. Ford			
✓	4-25-30	Fitzgerald, J. W.	✓ D		Pl	Pl	Sec.	50	"	"		711 De Laney St.	J. W. Fitzgerald			
	4-25-30	Fingate, H. H.	✓ D		Ex	Ex	Builder	62	"	"		545 Margaret St.	H. H. Fingate			
✓	4-29-30	Finley, S. H.	✓ D		Pl	Pl	Merchant	31	"	"		603 S. Mills	S. H. Finley			
✓	4-30-30	Fowler, C. B.	✓ D		Pl	Pl	Grocery Dpt.	38	W			438 Conway Rd.	C. B. Fowler			
✓	4-30-30	Fowler, Bessie	✓ D		Pl	Pl	Home	36	W			438 Conway Rd.	Bessie Fowler			
✓	4-30-30	Floyd, Carol	✓ D		Pl	Pl	Engineer	28	W			214 Annie	Carol Floyd			
	4-30-30	Furen, L. H.	✓ D		Pl	Pl	Retired	40	W			1612 Howell	L. H. Furen			
✓	4-30-30	Francisco, Pete	✓ D		Pl	Pl	Grocer	37	W	Turkey	#2845500 Orlando Nov. 17, 1928	119 Court	Pete Francisco			
	4-30-30	Floyd, Grace	✓ D		Pl	Pl	Home	27	W			214 Annie	Grace Floyd			
✓	4-30-30	Fishback, Florence	✓ D		Pl	Pl	Home	28	W			1222 E. Kaley	Florence Fishback			

OFFICIAL REGISTER OF ELECTORS FOR

PRECINCT, _____ COUNTY, FLORIDA

NUMBER	DATE	SURNAME AND GIVEN NAME	PARTY AFFILIATION	VOTED	POLL TAX		OCCUPATION	AGE	COLOR	NATIVITY	DECLARATION OR NATURALIZATION	RESIDENCE	OATH I, having been first duly sworn, say, upon Oath that the statements here entered opposite my name as to qualifications as an elector, are true.	SIGNATURE OF SUPERVISOR OR DEPUTY	REMARKS
					Year	Year							SIGNATURE OF ELECTOR		
12	3-13-30	Godfrey Ruth B.	10.		pd	pd.	Home	47	W	American		336 Ponce de Leon Pl.	Godfrey Ruth B.	Mina Jean Moore	owns property
14	3-13-30	Godfrey Frederick E.	10.		pd	pd.	Fruit Broker	47	W	American		" " "	Godfrey Frederick E.	" " "	owns property
44	3-29	Goss W. Robert	10.		ex	ex.	Clergyman	74	W	American		1414 E. Gore	Goss W. Robert	" " "	owns property
65	4-1	George David	R.		Ex	Ex	Retired	66	W	American		1306 Greenwood.	David George	" " "	owns property
68	4-1	Gisler Bessie A.	R.		pd	pd.	Home	50	W	American		315 Copeland Dr.	Bessie A. Gisler	" " "	owns property
73	4-2	Guernsey Edythe E.	10.		pd.	pd.	Home	28	W	American		516 So. Cherokee St.	Edythe E. Guernsey	" " "	owns property
74	4-2	Guernsey S. Kendrick	10.		pd	pd.	Investment	38	W	American		" "	S. Kendrick Guernsey	" " "	owns property
88	4-3	Gisler Chas. L.	R.		pd	pd.	Foot Doctor	53	W	American		315 Copeland Dr.	Dr Chas L. Gisler	" " "	owns property
106	4-7	Giles Jas. L.	10.		Ex	Ex	Mayor.	67	W	American		6 E Lucerne Circle	Jas. L. Giles	" " "	owns property
111	4-7	Giles Nannie B.	10.		Ex	Ex	Home	68	W	American		162 Lucerne Circle	Nannie B. Giles	" " "	owns property
112	4-7	Gettier Ida E.	10.		Ex	Ex	Home	72	W	American		717 Delaney St.	Ida E. Gettier	" " "	no property
✓	4-14-30	Garrett G. P.	10.		Pd	Pd	Lawyer	42	"	"		219 Phillips Pl.	G. P. Garrett	J. H. Tucker	
	4-15-30	Goss Katharine E.	10.		Ex	Ex	Home	76	"	"		144 E. Gore Ave	Mrs Katharine E. Goss	" " "	
✓	4-16-30	Godfrey J. B.	10.		pd	pd.	Insurance	53	"	"		700 W. Laney	J. B. Godfrey	" " "	
	4-19-30	Gabel Henry	10.		Pd	Pd	Carpenter	53	"	"		207 South Hyer	Henry Gabel	" " "	
	4-23-30	Gray Frank W.	10.		Pd	Pd	Physician	36	W	"		631 Bourne	Frank W. Gray	" " "	
✓	4-23-30	Gettier Norma	10.		Pd	Pd	Modest	41	"	"		717 Delaney Pl.	Norma Gettier	" " "	
✓	4-23-30	Garrett Rosalie J.	10.		Pd.	Pd	Home	30	"	"		219 Phillips Pl.	Rosalie J. Garrett	" " "	
✓	4-28-30	Getch Bertha	10.		pd	pd.	Teacher	47	W	"		1401 Catherine	Bertha Getch	" " "	
✓	4-29-30	Gabel Richard	10.		pd	pd.	Projectionist	22	W	"		207 S. Hyer	Richard Gabel	" " "	
✓	4-30-30	Gordon Clara	10.		Pd	Pd.	Home	35	W	"		210 S. Thornton	Clara Gordon	" " "	

Not Nov 1928
et. et. stamp to

OFFICIAL REGISTER OF ELECTORS FOR

PRECINCT, COUNTY, FLORIDA

NUMBER	DATE	SURNAME AND GIVEN NAME	PARTY AFFILIATION	VOTED	POLL TAX		OCCUPATION	AGE	COLOR	NATIVITY	DECLARATION OR NATURALIZATION	RESIDENCE	OATH		SIGNATURE OF SUPERVISOR OR DEPUTY	REMARKS
					Year	Year							I, having been first duly sworn, say, upon Oath that the statements here entered opposite my name as to qualifications as an elector, are true	SIGNATURE OF ELECTOR		
1930																
18	3/15	Dickinson J. J.	R.				Attorney	57	W.	American		625 Palmer St	J. J. Dickinson	Nina Jean Moore		owns property
19	3/17	Dickinson Sinah J.	R.				Home	36	W.	American		625 Palmer St	Sinah J. Dickinson	"	"	no property
36	3/27	Diamond Elsie M.	R.		Ex	Ex	Home	58	W.	American	Jan. 18-24 Pittsburg, Penn. Common Pleas Court no. 1	1203 Kuhl Ave	Diamond, Elsie M.	"	"	owns property
37	3/27	Diamond W. R.	R.		Ex	Ex	Retired	59	W.	American		1203 Kuhl Ave	Diamond W. R.	"	"	owns property
57	3-31	Douglass M.	R.		Ex	Ex	Retired	67	W.	Scotland		515 Daniels St	Douglass, M.	"	"	owns property
56	3-31	Douglass Lizzie	R.		Ex	Ex	Home	59	W.	American		515 Daniels	Douglass Lizzie	"	"	owns property
78	4-2	Donnelly C. Belle J.	R.		Ex	Ex	Home	57	W.	American		708 Anderson	C. Belle J. Donnelly			owns property
135	4-7	Donohue Sarah E.	R.		Ex	Ex	Home	68	W.	American		1214 Greenwood St	Sarah E. Donohue	"	"	owns property
141	4-7	Davis Martha	✓ R.		Pd	Pd	Home	40	W.	American		120 South Thornton	Martha Davis	J. H. Tucker	"	no property
142	4-7	Davis W. Clyde	✓ R.		Pd	Pd	Home	46	W.	American		"	W. Clyde Davis	"	"	owns property
4-11-30		Davis Rolf J.	R.				Merchant	26	W.	"		615 Woodlawn	J. Rolf Davis	"	"	
4-15-30		Dean J. H.	W.		Pd	Pd	Auto Dealer	50	W.	"		710 S. Delaney	See R for Signature			
4-17-30		Delaparte W. B.	W.		Pd	Pd	Salesman	50	W.	"		521 Richmond	W. B. Delaparte	"	"	
4-17-30		Duston Martha J.	R.		Ex	Ex	Nurse	71	"	"		Euclid Ave	Martha J. Duston	"	"	
4-21-30		Davis M. C.	D.		Pd	Pd	Y-Do Co.	25	W.	"		12 Kenner St	M. C. Davis	"	"	
4-21-30		Drake C. H.	W.		Pd	Pd	Salesman	29	"	"		1307 Morris Ave	C. H. Drake	"	"	
4-22-30		Dungan Honor	R.		Pd	Pd	Catere	50	"	"		1224 Palmer St	Honor E. Dungan	"	"	
4-22-30		Davis Paul J.	W.		Ex	Ex	Corp. Lawyer	59	"	"		1650 So. Delaney	Paul J. Davis	"	"	
4-24-30		Dabson Margaret	I		Ex	Ex	Home	71	"	"		1201 Holmberk	Margaret Dobson	"	"	
4-24-30		Dabson Henry	I		Ex	Ex	Retired	74	"	"		1801 Holmberk	Henry Dobson	"	"	
4-2		Dunn Augusta H.	W.		Ex	Ex	Home	75	"	"		309 Cherokee Ave	Mrs. Augusta H. Dunn	"	"	
4-29-30		Dewar W. E.	R.		Pd	Pd	Bookkeeper	44	W.	"		1523 Conway Rd.	W. E. Dewar	"	"	
4-30-30		Dean Hunt P.	D.		Pd		Home	42	"	"		710 S. Delaney	Hunt P. Dean	"	"	
4-30-30		Drake Beulah	R.				Sec.	43	W.	"		707 E. Pine	Beulah Drake	"	"	
4-30-30		Daniels Asa W.	D.		Ex	Ex	Salesman	57	W.	"		530 Esther St.	Asa W. Daniels	"	"	
4-30-30		Dungan R. M.	R.		Pd	Pd	R. E.	51	W.	"		1224 Palmer	R. M. Dungan	"	"	
4-30-30		Daniels Gilbert H.	R.		Pd	Pd	Clerk	26	W.	"		1002 Delaney Park	Gilbert H. Daniels	"	"	

NUMBER	DATE	SURNAME AND GIVEN NAME	PARTY AFFILIATION	VOTED	POLL TAX		OCCUPATION	AGE	COLOR	NATIVITY	DECLARATION OR NATURALIZATION	RESIDENCE	OATH		SIGNATURE OF SUPERVISOR OR DEPUTY	REMARKS
													I, having been first duly sworn, say, upon Oath that the statements here entered opposite my name as to qualifications as an elector, are true			
					Year	Year							SIGNATURE OF ELECTOR			
	1930															
27	3-22	Edward Gaston H.	✓ D.		pd	pd	Surgeon	54		american		309 Chewpuck	Gaston H. Edwards		Nina Jean Moore	owns property
28	3-22	Edward Adair W.	✓ D.		pd	pd	Home	47		american		309 Chewpuck	Adair W. Edwards		"	owns property
✓	4-10-30	S. E. Echols	✓ D.		ex	ex	Farming	61	M	"		1216 Palmer	S. E. Echols		J. H. Tucker	
✓	4-15-30	Estes V. W.	✓ D.		pd	pd	Real Estate	44	"	"		221 S. Lamy	V. W. Estes		J. H. Tucker	
	4-22-30	Empie, Marie H.	✓ D.		pd	pd	Bookkeeper	39	"	"		500 Richmond	Marie H. Empie		J. H. Tucker	
✓	4-22-30	Empie, John F.	✓ D.		pd	pd	Merchant	47	"	"		"	John F. Empie		J. H. Tucker	
✓	4-25-30	Estes, Judith	✓ D.		pd	pd	Home	42	"	"		121 S. Lamy	Judith Estes		J. H. Tucker	
✓	4-25-30	Estes, Dorothy	✓ D.		ex	ex	Home	21	"	"		"	Dorothy Estes		J. H. Tucker	
✓	4-25-30	Echols, Katie Sue	✓ D.		pd	pd	Teacher	27	"	"		1216 Palmer	Katie Sue Echols		"	
✓	4-26-30	Ellison, V. D.	✓ D.		pd	pd						122 E. Esther	V. D. Ellison		"	
✓	4-28-30	Ebsen, C. L.	✓ D.		ex	ex	Teacher	58	w			9 S. Hyer	C. L. Ebsen		"	
	4-29-30	Essington, Shirley	✓ D.		pd	pd	Home	43	w			719 Endick	Shirley L. Essington		"	
	4-29-30	Essington, W. C.	✓ D.		pd	pd	Investment	44	w			"	W. C. Essington		"	
	4-29-30	Engelhard, Harry C.	✓ D.		pd	pd	Doct.	26	w			706 East Pine	Harry C. Engelhard		"	
✓	4-29-30	Evans, Z. W.	✓ D.		ex	ex	Retired	69	w			201 E. Miller	Z. W. Evans		"	
	4-29-30	Evans, Mrs. Z. W.	✓ D.		ex	ex	Home	68	w			201 E. Miller	Mrs. Z. W. Evans		"	
✓	4-30-30	Ellars, Martha E.	✓ D.		ex	ex	Home	69	w			941 Kuhl	Mrs. Martha E. Ellars		"	
✓	4-30-30	Echols, Maude F.	✓ D.		pd	pd	Nurse	53	w			1216 Palmer	Mrs. Maude F. Echols		"	
✓	4-30-30	Ellars, O. R.	✓ D.		pd	pd	Lawyer	32	w			941 Kuhl	O. R. Ellars		"	
✓	4-30-30	Eberhardt, Mrs. W. F.	✓ D.		pd	pd	Merchant	27	w			127 Kennison	Mrs. W. F. Eberhardt		"	
	4-30-30	Engler, Mrs. Clara	✓ R.				Home	51	w			1218 Greenwood	Mrs. Clara Engler		"	

NUMBER	DATE	SURNAME AND GIVEN NAME	PARTY AFFILIATION	VOTED	POLL TAX		OCCUPATION	AGE	COLOR	NATIVITY	DECLARATION OR NATURALIZATION	RESIDENCE	OATH		SIGNATURE OF SUPERVISOR OR DEPUTY	REMARKS
					Year	Year							I, having been first duly sworn, say, upon Oath that the statements here entered opposite my name as to qualifications as an elector, are true	SIGNATURE OF ELECTOR		
1930																
23	3-20	Frese Elizabeth	✓ D.		Pl	Pl	Teacher	48	W	American		509 So. Osceola	Elizabeth Frese	Mia Jean Moore		owns property
41	3-29	Fuller Edna G.	✓ D.		Pl	Pl	Home	56	W	American		605 De Laney	Edna G. Fuller			owns property
42	3-29	Fuller Dorothy	✓ D.		Ex	Ex	Home	21	W			605 De Laney	Dorothy Fuller			
46	3-31	Frese A. J.	✓ D.		Pl	Pl	None	55	W	Germany	July 12-1909 Boston, Mass. U.S. District Court Boston, Mass.	509 So. Osceola	A. J. Frese			owns property
47	3-31	Fort Leon B.	✓ D.		Pl	Pl	Garage	43	W	American		604 So. Cherokee	Leon B. Fort			owns property
92	4-5	Ferguson, Frank L.	R.		Ex	Ex	Real Estate	68	W	Canada	New Haven Conn. 1888.	21 E. Copeland Ave	Frank L. Ferguson			owns property
93	4-5	Ferguson, Margaret J.	R.		Ex	Ex	Home	67	W	American		" "	Margaret J. Ferguson			owns property
13	4-8-30	Fillyaw, H. M.	✓ D.		Ex	Ex	G. Watchman	65	"	"		Orlando	H. M. Fillyaw	J. H. Tucker		
✓	4-14-30	Fishback, G. B.	✓ D.		Pl	Pl	Lawyer	37	"	"		1222 E. Kaley	G. B. Fishback			Pine beetle Trans # 41
✓	4-16-30	Foster, R. G.	✓ D.		Ex	Ex	Janitor	63	"	"		815 Palmer St	R. G. Foster			
✓	4-22-30	Franklin, Pearl C.	✓ D.		Pl	Pl	Home	45	"	"		214 J. Thonson	Pearl C. Franklin			
✓	4-22-30	Franklin, A. L.	✓ D.		Pl	Pl	Real Estate	50	"	"		214 J. Thonson St.	A. L. Franklin			
✓	4-22-30	Freeman, Marie	✓ D.		Pl	Pl	Home	33	"	"		1213 S. De Laney	Marie Freeman			
✓	4-22-30	Freeman, W. H.	✓ D.		Pl	Pl	Manager	34	"	"		1213 S. De Laney	W. H. Freeman Jr			
✓	4-24-30	Ford, W. J.	✓ D.		Pl	Pl	Physician	37	"	"		124 S. Thonson	Dr. J. L. Ford			
✓	4-25-30	Fitzgerald, J. W.	✓ D.		Pl	Pl	Sec.	50	"	"		711 De Laney St.	J. W. Fitzgerald			
✓	4-25-30	Fingate, H. H.	✓ D.		Ex	Ex	Builder	62	"	"		545 Margaret St.	H. H. Fingate			
✓	4-29-30	Finley, G. H.	✓ D.		Pl	Pl	Merchant	31	"	"		603 S. Mills	G. H. Finley			
✓	4-30-30	Fowler, C. B.	✓ D.		Pl	Pl	Grove Supt.	38	W			438 Conway Rd.	C. B. Fowler			
✓	4-30-30	Fowler, Bessie	✓ D.		Pl	Pl	Home	36	W			438 Conway Rd.	Bessie Fowler			
✓	4-30-30	Floyd, Carol	✓ D.		Pl	Pl	Engineer	28	W			214 Annie	Carol Floyd			
✓	4-30-30	Furen, L. H.	✓ D.		Pl	Pl	Retired	40	W			1612 Howell	L. H. Furen			
✓	4-30-30	Francisco, Pete	✓ D.		Pl	Pl	Grocer	37	W	Turkey	#2845500 Orlando Nov. 17, 1928	119 Court	Pete Francisco			
✓	4-30-30	Floyd, Grace	✓ D.		Pl	Pl	Home	27	W			214 Annie	Grace Floyd			
✓	4-30-30	Fishback, Florence	✓ D.		Pl	Pl	Home	28	W			1222 E. Kaley	Florence Fishback			

OFFICIAL REGISTER OF ELECTORS FOR

PRECINCT,

COUNTY, FLORIDA

NUMBER	DATE	SURNAME AND GIVEN NAME	PARTY AFFILIATION	VOTED	POLL TAX		OCCUPATION	AGE	COLOR	NATIVITY	DECLARATION OR NATURALIZATION	RESIDENCE	OATH		SIGNATURE OF SUPERVISOR OR DEPUTY	REMARKS
													I, having been first duly sworn, say, upon Oath that the statements here entered opposite my name as to qualifications as an elector, are true.			
					Year	Year							SIGNATURE OF ELECTOR			
13	3-13-30	Godfrey Ruth B	NO.		pd	pd.	Home	47	W	American		335 Pine de la Pl	Godfrey Ruth B.	Thina Jean Moore		owns property
14	3-13-30	Godfrey Frederick E.	NO.		pd	pd.	Fruit Broker	47	W	American		" " "	Godfrey Frederick E	" " "		owns property
44	3-29	Goss W. Robert	NO.		ex	ex.	Clergyman	74	W	American		1414 E. Gore	Goss W. Robert	" " "		owns property
65	4-1	George David	R.		Eq	Eq	Retired	66	W	American		1306 Greenwood.	David George	" " "		owns property
68	4-1	Gisler Bessie A.	R.		pd	pd.	Home	50	W	American		315 Copeland Dr.	Bessie A. Gisler	" " "		owns property
73	4-2	Guernsey Edythe L.	NO.		pd.	pd.	Home	28	W	American		516 So. Charles St.	Edythe L. Guernsey	" " "		owns property
74	4-2	Guernsey S. Kendrick	NO.		pd	pd.	Knockout	38	W	American		" "	S. Kendrick Guernsey	" " "		owns property
88	4-3	Gisler Chas. L.	R.		pd	pd.	Foot Doctor	53	W	American		315 Copeland Dr.	Dr Chas L. Gisler	" " "		owns property
106	4-7	Giles Jas. L.	NO.		Eq	Eq	Mayor.	67	W	American		6 E Lucerne Circle	Jas. L. Giles	" " "		owns property
111	4-7	Giles Harnie B.	NO.		Eq	Eq	Home	68	W	American		62 Lucerne Circle	Harnie B. Giles	" " "		owns property
112	4-7	Gettier Ida E.	NO.		Eq	Eq	Home	72	W	American		717 Delaney St.	Ida E. Gettier	" " "		no property
✓	4-14-30	Garrett G. P.	NO.		pd.	pd.	Lawyer	42	"	"		219 Phillips Pl.	G. P. Garrett	J. H. Wheeler		
	4-15-30	Goss Katharine E.	NO.		Eq	Eq	Home	76	"	"		144 E. Gore Ave	Tha Katharine E. Goss	" " "		
✓	4-16-30	Godfrey J. B.	NO.		pd	pd.	Insurance	53	"	"		700 W. Lancy	J. B. Godfrey	" " "		
	4-19-30	Gabel Henry	NO.		pd	pd.	Carpenter	53	"	"		207 South Hyer	Henry Gabel	" " "		

OFFICIAL REGISTER OF ELECTORS FOR

PRECINCT, COUNTY, FLORIDA

NUMBER	DATE	SURNAME AND GIVEN NAME	PARTY AFFILIATION	VOTED	POLL TAX		OCCUPATION	AGE	COLOR	NATIVITY	DECLARATION OR NATURALIZATION	RESIDENCE	OATH		SIGNATURE OF SUPERVISOR OR DEPUTY	REMARKS
													I, having been first duly sworn, say, upon Oath that the statements here entered opposite my name as to qualifications as an elector, are true			
					Year	Year							SIGNATURE OF ELECTOR			
1930																
18	3/15	Dickinson J. J.	R.				Attorney	57	W.	American		625 Palmer St	J. J. Dickinson	Nina Jean Moore		owns property
19	3/17	Dickinson Sarah J.	R.				Home	36	W.	American		625 Palmer St	Sarah J. Dickinson	"	"	no property
36	3/27	Diamond Elsie M.	R.		Ex	24	Home	58	W.	American		1203 Kuhl Ave	Diamond, Elsie M.	"	"	owns property
37	3/27	Diamond W. R.	R.		24	24	Retired	59	W.	American	Jan. 18-94 Pittsburg, Penn. Common Pleas Court No. 1	1203 Kuhl Ave	Diamond W. R.	"	"	owns property
57	3-31	Douglass M.	R.		24	24	Retired	67	W.	Scotland		515 Daniels St	Douglass, M.	"	"	owns property
56	3-31	Douglass Lizzie	R.		24	24	Home	59	W.	American		515 Daniels	Douglass Lizzie	"	"	owns property
78	4-2	Donnelly C. Belle J.	R.		24	24	Home	57	W.	American		708 Anderson	C. Belle J. Donnelly	"	"	owns property
135	4-7	Donohue Sarah E.	R.		24	24	Home	68	W.	American		1214 Greenwood St	Sarah E. Donohue	"	"	owns property
141	4-7	Davis Martha	W.		Pd	Pd	Home	40	W.	American		120 South Houston	Martha Davis	J. H. Tucker	"	no property
142	4-7	Davis W. Clyde	W.		Pd	Pd	Home	46	W.	American		"	W. Clyde Davis	"	"	owns property
4-11-30		Davis Rolf J.	R.				Merchant	26	W.	"		615 Woodlawn	J. Rolf Davis	"	"	
4-15-30		Dean J. H.	W.		Pd	Pd	Auto Dealer	50	W.	"		710 S. Delaney	See R. for Signature	"	"	
4-17-30		Delaporte W. B.	W.		Pd	Pd	Salesman	50	W.	"		531 Richmond	W. B. Delaporte	"	"	
4-17-30		Duston Martha J.	R.		Ex	Ex	Nurse	71	"	"		Euclid Ave	Martha J. Huston	"	"	
4-21-30		Davis M. E.	D.		Pd	Pd	Y-Do Co.	25	W.	"		12 Kenner St	M. E. Davis	"	"	
4-21-30		Drake C. W.	W.		Pd	Pd	Salesman	29	"	"		1507 Meade Ave	C. W. Drake	"	"	
4-22-30		Dungan Honor	R.		Pd	Pd	Caterer	50	"	"		1224 Palmer St	Honor E. Dungan	"	"	
4-22-30		Davis Paul J.	W.		Ex	Ex	Corp. Lawyer	59	"	"		1650 S. Delaney	Paul J. Davis	"	"	
4-24-30		Dabson Margaret	I		Ex	Ex	Home	71	"	"		1801 Holmberk	Margaret Dobson	"	"	
4-24-30		Dabson Henry	I		Ex	Ex	Retired	74	"	"		1801 Holmberk	Henry Dobson	"	"	
4-2		Dunn Augusta H.	W.		Ex	Ex	Home	75	"	"		309 Cherokee Ave	Mrs. Augusta H. Dunn	"	"	
4-29-30		Dewar W. E.	R.		Pd	Pd	Bookkeeper	44	W.	"		1523 Conway Rd.	W. E. Dewar	"	"	
4-30-30		Dean Hunt P.	D.		Pd		Home	42	"	"		710 S. Delaney	Hunt P. Dean	"	"	
4-30-30		Drake Beulah	R.				Sec.	43	W.	"		707 E. Pine	Mrs. Beulah Drake	"	"	
4-30-30		Daniels Asa W.	D.		Ex	Ex	Salesman	57	W.	"		530 E. 30th St.	Asa W. Daniels	"	"	
4-30-30		Dungan R. M.	R.		Pd	Pd	R. E.	51	W.	"		1224 Palmer	R. M. Dungan	"	"	
4-30-30		Daniels Gilbert H.	R.		Pd	Pd	Clerk	26	W.	"		1002 Delaney Park	Gilbert H. Daniels	"	"	

NUMBER	DATE	SURNAME AND GIVEN NAME	PARTY AFFILIATION	VOTED	POLL TAX		OCCUPATION	AGE	COLOR	NATIVITY	DECLARATION OR NATURALIZATION	RESIDENCE	OATH I, having been first duly sworn, say, upon Oath that the statements here entered opposite my name as to qualifications as an elector, are true		SIGNATURE OF SUPERVISOR OR DEPUTY	REMARKS
					Year	Year							SIGNATURE OF ELECTOR			
	1930															
✓ 27	3-22	Edward Gaston H.	✓ D.		pd	pd	Surgeon	54		american		309 Chewbeek	Gaston H. Edwards		Nina Jean Moore	owns property
28	3-22	Edward Adair H.	D.		pd	pd	Home	47		american		309 Chewbeek	Adair H. Edwards		"	owns property
✓	4-10-30	S. E. Echols	D.		ex	ex	Farming	61	W	"		1216 Palmer	S. E. Echols		J. H. Tucker	
✓	4-15-30	Estes V. W.	✓ W.		pd	pd	Real Estate	44	"	"		721 S. Lacey	V. W. Estes		J. H. Tucker	
	4-22-30	Empie, Marie H.	✓ D.		pd	pd	Bookkeeper	39	"	"		500 Richmond Ave.	Marie H. Empie		J. H. Tucker	
✓	4-22-30	Empie, John F.	✓ W.		pd	pd	Merchant	47	"	"		"	John F. Empie		J. H. Tucker	
✓	4-25-30	Estes, Judith	W.		pd	pd	Home	42	"	"		121 S. Lacey	Judith Estes		J. H. Tucker	
✓	4-25-30	Estes, Dorothy	✓ W.		ex	ex	Home	21	"	"		"	Dorothy Estes		J. H. Tucker	
✓	4-25-30	Echols, Katie Sue	✓ W.		pd	pd	Teacher	27	"	"		1216 Palmer	Katie Sue Echols		"	
✓	4-26-30	Ellison, V. D.	D.		pd	pd						122 E. Esther	V. D. Ellison		"	
✓	4-28-30	Ebsen, C. L.	✓ D.		ex	ex	Teacher	58	W			9 S. Hyer	C. L. Ebsen		"	
	4-29-30	Essington, Shirley	D.		pd	pd	Home	43	W			719 Endick Ave.	Shirley C. Essington		"	
	4-29-30	Essington, W. C.	D.		pd	pd	Investment	44	W			"	W. C. Essington		"	
	4-29-30	Engelhard, Harry C.	D.		pd	pd	Doct.	26	W			706 East Pine	Harry C. Engelhard		"	
✓	4-29-30	Evans, Z. W.	R.		ex	ex	Retired	69	W			201 E. Miller	Z. W. Evans		"	
	4-29-30	Evans, Mrs. Z. W.	R.		ex	ex	Home	68	W			201 E. Miller	Mrs. Z. W. Evans		"	
✓	4-30-30	Ellars, Martha E.	✓ D.		ex	ex	Home	69	W			941 Kuhl	Mrs. Martha E. Ellars		"	
✓	4-30-30	Echols, Maude F.	✓ D.		pd	pd	Nurse	53	W			1216 Palmer	Mrs. Maude F. Echols		"	
✓	4-30-30	Ellars, O. R.	✓ D.		pd	pd	Lawyer	32	W			941 Kuhl	O. R. Ellars		"	
✓	4-30-30	Eberhardt, Mrs. W. F.	D.		pd	pd	Merchant	27	W			127 Kennison Dr.	Mrs. W. F. Eberhardt		"	
	4-30-30	Engler, Mrs. Clara	R.				Home	51	W			1218 Greenwood	Mrs. Clara Engler		"	

OFFICIAL REGISTER OF ELECTORS FOR

PRECINCT, COUNTY, FLORIDA

NUMBER	DATE	SURNAME AND GIVEN NAME	PARTY AFFILIATION	VOTED	POLL TAX		OCCUPATION	AGE	COLOR	NATIVITY	DECLARATION OR NATURALIZATION	RESIDENCE	OATH		SIGNATURE OF SUPERVISOR OR DEPUTY	REMARKS
					Year	Year							I, having been first duly sworn, say, upon Oath that the statements here entered opposite my name as to qualifications as an elector, are true	SIGNATURE OF ELECTOR		
	1930															
23	3-20	Frese Elizabeth	✓ D.		Pl	Pl	Teacher	48	W.	American		509 So. Osceola	Elizabeth Frese	Nina Jean Moore		owns property
41	3-29	Fuller Edna G.	✓ D.		Pl.	Pl	Home	56	W.	American		605 De Laney	Edna G. Fuller			owns property
42	3-29	Fuller Dorothy	✓ D.		Ex	Ex	Home	21	W.			605 De Laney	Dorothy Fuller			
46	3-31	Frese A. F.	✓ D.		Pl	Pl.	None	55	W.	Germany	July 12-1909 Boston, Mass. U.S. District Court Boston, Mass.	509 S. Osceola	A. F. Frese			owns property
47	3-31	Fort Leon B.	✓ D.		Pl	Pl	Garage	43	W.	American		604 So. Cherokee	Leon B. Fort			owns property
92	4-5	Ferguson, Frank L.	R.		Ex	Ex	Real Estate	68	W.	Canada.	New Haven Conn. 1888.	21 E. Copeland Dr.	Frank L. Ferguson			owns property
93	4-5	Ferguson, Margaret J.	R.		Ex	Ex	Home	67	W.	American		" "	Margaret J. Ferguson			owns property
13	4-8-30	Fillyaw, H. M.	✓ D.		Ex	Ex	B. Watchman	65	"	"		Orlando	H. M. Fillyaw	J. H. Mucker		
✓	4-14-30	Fishback, G. B.	✓ D.		Pl.	Pl	Lawyer	37	"	"		1222 E. Kaley	G. B. Fishback			Pine beetle Travis # 41
✓	4-15-30	Foster, R. G.	✓ D.		Ex	Ex	Janitor	63	"	"		815 Palmer St	R. G. Foster			
✓	4-22-30	Franklin, Pearl C.	✓ D.		Pl	Pl	Home	45	"	"		214 J. Thonon	Pearl C. Franklin			
✓	4-22-30	Franklin, A. L.	✓ D.		Pl	Pl	Real Estate	50	"	"		214 J. Thonon St.	A. L. Franklin			
✓	4-22-30	Freeman, Marie	✓ D.		Pl	Pl	Home	33	"	"		1213 S. De Laney	Marie Freeman			
✓	4-22-30	Freeman, W. H.	✓ D.		Pl	Pl	Manager	34	"	"		1213 S. De Laney	W. H. Freeman Jr			
✓	4-24-30	Ford, Mr. J. G.	✓ D.		Pl.	Pl	Physician	37	"	"		1248 Thornton	Dr. J. G. Ford			
✓	4-25-30	Fitzgerald, J. W.	✓ D.		Pl	Pl.	Sec.	50	"	"		711 De Laney St.	J. W. Fitzgerald			
✓	4-25-30	Fingate, H. H.	✓ D.		Ex	Ex	Builder	62	"	"		545 Margaret St.	H. H. Fingate			
✓	4-29-30	Finley, G. H.	✓ D.		Pl	Pl	Merchant	31	"	"		603 S. Hills.	G. H. Finley			
✓	4-30-30	Fowler, C. B.	✓ D.		Pl.	Pl	Grove Supt.	38	W			438 Conway Rd.	C. B. Fowler			
✓	4-30-30	Fowler, Bessie	✓ D.		Pl.	Pl.	Home	36	W			438 Conway Rd.	Bessie Fowler			
✓	4-30-30	Floyd, Carol	✓ D.		Pl.	Pl	Engineer	28	W			214 Annie.	Carol Floyd			
✓	4-30-30	Furen, L. H.	✓ D.		Pl.	Pl	Retired	40	W			1612 Howell.	L. H. Furen			
✓	4-30-30	Francisco, Pete	✓ D.		Pl	Pl	Grocer	37	W	Turkey.	# 2845520. Orlando Nov. 17, 1928	119 Court.	Pete Francisco			
✓	4-30-30	Floyd, Grace	✓ D.		Pl.	Pl	Home	27	W			214 Annie.	Grace Floyd			
✓	4-30-30	Fishback, Florence	✓ D.		Pl.	Pl	Home	28	W			1222 E. Kaley.	Florence Fishback			

OFFICIAL REGISTER OF ELECTORS FOR

PRECINCT, COUNTY, FLORIDA

NUMBER	DATE	SURNAME AND GIVEN NAME	PARTY AFFILIATION	VOTED	POLL TAX		OCCUPATION	AGE	COLOR	NATIVITY	DECLARATION OR NATURALIZATION	RESIDENCE	OATH		SIGNATURE OF SUPERVISOR OR DEPUTY	REMARKS
					Year	Year							I, having been first duly sworn, say, upon Oath that the statements here entered opposite my name as to qualifications as an elector, are true.			
													SIGNATURE OF ELECTOR			
12	3-13-30	Godfrey Ruth B	10.		pd	pd.	Home	47	W	American		336 Ponce de Leon Pl.	Godfrey Ruth B.	Mina Jean Moore		owns property
14	3-13-30	Godfrey Frederick E.	10.		pd	pd.	Fruit Broker	47	W	American		" " "	Godfrey Frederick E	" " "		owns property
44	3-29	Goss W. Robert	10.		ex	ex.	Clergyman	74	W	American		1414 E. Gore	Goss W. Robert	" " "		owns property
65	4-1	George David	R.		Ex	Ex	Retired	66	W	American		1306 Greenwood.	David George	" " "		owns property
68	4-1	Gisler Bessie A.	R.		pd	pd.	Home	50	W	American		315 Copeland Dr.	Bessie A. Gisler	" " "		owns property
73	4-2	Guernsey Edythe L.	10.		pd.	pd.	Home	28	W	American		516 So. Cherokee St.	Edythe L. Guernsey	" " "		owns property
74	4-2	Guernsey S. Kendrick	10.		pd	pd.	Investment	38	W	American		" "	S. Kendrick Guernsey	" " "		owns property
88	4-3	Gisler Chas. L.	R.		pd	pd.	Foot Doctor	53	W	American		315 Copeland Dr.	Dr Chas L. Gisler	" " "		owns property
106	4-7	Giles Jas. L.	10.		Ex	Ex	Mayor.	67	W	American		66 Lucerne Circle	Jas. L. Giles	" " "		owns property
111	4-7	Giles Harnie B.	10.		Ex	Ex	Home	68	W	American		162 Lucerne Circle	Harnie B. Giles	" " "		owns property
112	4-7	Gethier Ida E.	10.		Ex	Ex	Home	72	W	American		717 Delaney St.	Ida E. Gethier	" " "		no property
✓	4-14-30	Garrett G. P.	10.		Pd.	Pd.	Lawyer	42	"	"		219 Phillips Pl.	G. P. Garrett	J. H. Wheeler		
	4-15-30	Goss Kathrine E.	10.		Ex	Ex	Home	76	"	"		144 E. Lane Ave.	Mrs Kathrine E. Goss	" " "		
✓	4-16-30	Godfrey J. B.	10.		pd	pd.	Insurance	53	"	"		700 De Laney	J. B. Godfrey	" " "		
	4-19-30	Gabel Henry	10.		Pd	Pd	Carpenter	53	"	"		207 South Hyer	Henry Gabel	" " "		
	4-23-30	Gray Frank W.	10.		Pd	Pd	Physician	36	W	"		631 Bourne	Frank W. Gray	" " "		
✓	4-23-30	Gethier Norma	10.		Pd	Pd	Modest	41	"	"		717 Delaney Pl.	Norma Gethier	" " "		
✓	4-23-30	Garrett Rosalie J.	10.		Pd.	Pd	Home	30	"	"		219 Phillips Pl.	Rosalie J. Garrett	" " "		
✓	4-28-30	Getch Bertha	10.		pd	pd.	Teacher	47	W	"		1401 Catherine	Bertha Getch	" " "		
✓	4-29-30	Gabel Richard	10.		pd	pd.	Projectionist	22	W	"		207 S. Hyer.	Richard Gabel	" " "		
✓	4-30-30	Gordon Clara	10.		Pd	Pd.	Home	35	W.	"		210 S. Thornton.	Clara Gordon	" " "		

OFFICIAL REGISTER OF ELECTORS FOR

PRECINCT,

COUNTY, FLORIDA

NUMBER	DATE	SURNAME AND GIVEN NAME	PARTY AFFILIATION	VOTED	POLL TAX		OCCUPATION	AGE	COLOR	NATIVITY	DECLARATION OR NATURALIZATION	RESIDENCE	OATH		SIGNATURE OF SUPERVISOR OR DEPUTY	REMARKS	
													I, having been first duly sworn, say, upon Oath that the statements here entered opposite my name as to qualifications as an elector, are true				
					Year	Year							SIGNATURE OF ELECTOR				
1930																	
18	3/15	Dickinson J. J.	R.				Attorney	57	W.	American		625 Palmer St	J. J. Dickinson	Nina Jean Moore		owns property	
19	3/17	Dickinson Sarah J.	R.				Home	36	W.	American		625 Palmer St	Sarah J. Dickinson	"	"	no property	
36	3/27	Diamond Elsie M.	R.				Home	58	W.	American	Jan. 18-94 Pittsburg, Penn. Common Pleas Court no. 1	1203 Kuhl Ave	Diamond, Elsie M.	"	"	owns property	
37	3/27	Diamond W. R.	R.				Retired	59	W.	American		1203 Kuhl Ave	Diamond W. R.	"	"	owns property	
57	3-31	Douglass M.	R.				Retired	67	W.	Scotland		515 Daniels St	Douglass M.	"	"	owns property	
56	3-31	Douglass Lizzie	R.				Home	59	W.	American		515 Daniels	Douglass Lizzie	"	"	owns property	
78	4-2	Donnelly C. Belle J.	R.				Home	57	W.	American		708 Anderson	C. Belle J. Donnelly	"	"	owns property	
135	4-7	Donohue Sarah E.	R.				Home	68	W.	American		1214 Greenwood	Sarah E. Donohue	"	"	owns property	
141	4-7	Davis Martha	R.				Home	40	W.	American		120 South Thornton	Martha Davis	J. H. Tucker	"	no property	
142	4-7	Davis W. Clyde	R.				Home	46	W.	American		"	W. Clyde Davis	"	"	owns property	
4-11-30		Davis Rolf J.	R.				Merchant	26	W.	"		615 Woodlawn	Rolf J. Davis	"	"		
4-15-30		Dean J. H.	W.				Auto Dealer	50	W.	"		710 S. Delaney	See R. for Signature	"	"		
4-17-30		Delaporte W. B.	W.				Salesman	50	W.	"		531 Richmond	W. B. Delaporte	"	"		
4-17-30		Duston Martha J.	R.				Nurse	71	"	"		Euclid Ave	Martha J. Duston	"	"		
4-21-30		Davis M. C.	D.				Y-Do Co.	25	"	"		12 Kemmer Ct	M. C. Davis	"	"		
4-21-30		Drake C. W.	W.				Salesman	29	"	"		1507 Meade Ave	C. W. Drake	"	"		
4-22-30		Dungan Honor	R.				Crate	50	"	"		1224 Palmer St	Honor E. Dungan	"	"		
4-22-30		Davis Paul J.	W.				Corp. Lawyer	59	"	"		1650 S. Delaney	Paul J. Davis	"	"		
4-24-30		Dabson Margat	I				Home	71	"	"		1201 Hollinbeck	Margat Dabson	"	"		
4-24-30		Dabson Henry	I				Retired	74	"	"		1801 Hollinbeck	Henry Dabson	"	"		
4-2		Dunn Augusta H.	W.				Home	75	"	"		309 Cherokee Rd	Mrs. Augusta H. Dunn	"	"		
4-29-30		Dewar W. E.	R.				Bookkeeper	44	W.	"		1523 Conway Rd.	W. E. Dewar	"	"		
4-30-30		Dean Hunt P.	D.				Home	42	"	"		710 S. Delaney	Hunt P. Dean	"	"		
4-30-30		Drake Beulah	R.				Sec.	43	W.	"		707 E. Pine	Mrs. Beulah Drake	"	"		
4-30-30		Daniels Asa W.	D.				Salesman	57	W.	"		5-30 Esther St.	Asa W. Daniels	"	"		
4-30-30		Dungan R. M.	R.				R. E.	51	W.	"		1224 Palmer	R. M. Dungan	"	"		
4-30-30		Daniels Gilbert H.	R.				Clerk	26	W.	"		1002 Delaney Park	Gilbert H. Daniels	"	"		

OFFICIAL REGISTER OF ELECTORS FOR

PRECINCT, COUNTY, FLORIDA

NUMBER	DATE	SURNAME AND GIVEN NAME	PARTY AFFILIATION	VOTED	POLL TAX		OCCUPATION	AGE	COLOR	NATIVITY	DECLARATION OR NATURALIZATION	RESIDENCE	OATH		SIGNATURE OF SUPERVISOR OR DEPUTY	REMARKS
													I, having been first duly sworn, say, upon Oath that the statements here entered opposite my name as to qualifications as an elector, are true			
					Year	Year							SIGNATURE OF ELECTOR			
27	3-22-30	Edward Gaston H.	D.		pd	pd	Surgeon	54		american		309 Chewpeck	Edward H. Gaston		Mina Jean Moore	owns property
28	3-22-30	Edward Adair H.	D.		pd	pd	Home	47		american		309 Chewpeck	Edward H. Adair		"	owns property
✓	4-16-30	S. E. Echols	D.		ex	ex	Farming	61	W	"		1216 Palmer	S. E. Echols		J. H. Tucker	
✓	4-16-30	Estes V. W.	D.		pd	pd	Real Estate	44	"	"		221 S. Lang	V. W. Estes		J. H. Tucker	
✓	4-22-30	Empie, Marie H.	D.		pd	pd	Bookkeeper	39	"	"		500 Richmond	Marie H. Empie		J. H. Tucker	
✓	4-22-30	Empie, John F.	D.		pd	pd	Merchant	47	"	"		"	John F. Empie		J. H. Tucker	
✓	4-25-30	Estes, Judith	D.		pd	pd	Home	42	"	"		121 S. Lang	Judith Estes		J. H. Tucker	
✓	4-25-30	Estes, Dorothy	D.		ex	ex	Home	21	"	"		"	Dorothy Estes		J. H. Tucker	
✓	4-25-30	Echols, Katie Sue	D.		pd	pd	Teacher	27	"	"		1216 Palmer	Katie Sue Echols		"	
✓	4-26-30	Ellison, V. D.	D.		pd	pd						122 E. Esther	V. D. Ellison		"	
✓	4-28-30	Ebsen, C. L.	D.		ex	ex	Teacher	58	W			9 S. Hyer	C. L. Ebsen		"	
✓	4-29-30	Essington, Shirley	D.		pd	pd	Home	43	W			719 Endicott	Shirley L. Essington		"	
✓	4-29-30	Essington, W. C.	D.		pd	pd	Investment	44	W			"	W. C. Essington		"	
✓	4-29-30	Engelhard, Harry C.	D.		pd	pd	Doct.	26	W			706 Ernst	Harry C. Engelhard		"	
✓	4-29-30	Evans, Z. W.	R.		ex	ex	Retired	69	W			201 E. Miller	Z. W. Evans		"	
✓	4-29-30	Evans, Mrs. Z. W.	R.		ex	ex	Home	68	W			201 E. Miller	Mrs. Z. W. Evans		"	
✓	4-30-30	Ellars, Martha E.	D.		ex	ex	Home	69	W			941 Kuhl	Mrs. Martha E. Ellars		"	
✓	4-30-30	Echols, Maude F.	D.		pd	pd	Nurse	53	W			1216 Palmer	Mrs. Maude F. Echols		"	
✓	4-30-30	Ellars, O. R.	D.		pd	pd	Lawyer	32	W			941 Kuhl	O. R. Ellars		"	
✓	4-30-30	Eberhardt, Mrs. W. F.	D.		pd	pd	Merchant	27	W			127 Kennison	Mrs. W. F. Eberhardt		"	
✓	4-30-30	Engler, Mrs. Clara	R.				Home	51	W			1218 Greenwood	Mrs. Clara Engler		"	

OFFICIAL REGISTER OF ELECTORS FOR

PRECINCT,

COUNTY, FLORIDA

NUMBER	DATE	SURNAME AND GIVEN NAME	PARTY AFFILIATION	VOTED	POLL TAX		OCCUPATION	AGE	COLOR	NATIVITY	DECLARATION OR NATURALIZATION	RESIDENCE	OATH		SIGNATURE OF SUPERVISOR OR DEPUTY	REMARKS
					Year	Year							I, having been first duly sworn, say, upon Oath that the statements here entered opposite my name as to qualifications as an elector, are true			
													SIGNATURE OF ELECTOR			
	1930															
23	3-20	Frese Elizabeth	✓ D.		Pl	Ed.	Teacher	48	W.	American		509 So. Osceola	Elizabeth Frese	Maria Jean Moore		owns property
41	3-29	Fuller Edna G.	✓ D.		Pl.	Pl.	Home	56	W.	American		605 De Laney	Edna G. Fuller	"		owns property
42	3-29	Fuller Dorothy	✓ D.		Ex	Ex	Home	21	W.			605 De Laney	Dorothy Fuller	"		
46	3-31	Frese A. J.	✓ D.		Pl	Pl.	None	55	W.	Germany	July 12-1909 Boston, Mass. U.S. District Court Boston, Mass.	509 So. Osceola	A. J. Frese	"		owns property
47	3-31	Fort Leon B.	✓ D.		Pl	Pl	Garage	43	W.	American		604 So. Cherokee	Leon B. Fort	"		owns property
92	4-5	Ferguson, Frank L.	R.		Ex	Ed	Real Estate	68	W.	Canada.	New Haven Conn. 1888.	21 E. Copland Ave	Frank L. Ferguson	"		owns property
93	4-5	Ferguson, Margaret J.	R.		Ex	Ex	Home	67	W.	American		" "	Margaret J. Ferguson	"		owns property
13	4-8-30	Fillyaw, H. M.	✓ D.		Ex	Ex	G. Watchman	65	"	"		Orlando	H. M. Fillyaw	J. H. Tucker		
✓	4-14-30	Fishback, G. B.	✓ W.		Pl.	Pl	Lawyer	37	"	"		1222 E. Kaley	G. B. Fishback	"		Pine beetle Trans # 41
✓	4-15-30	Foster, R. G.	✓ W.		Ed	Ed	Janitor	63	"	"		815 Palmer St	R. G. Foster	"		
✓	4-22-30	Franklin, Pearl C.	✓ W.		Pl	Pl	Home	45	"	"		214 J. Thonston	Pearl C. Franklin	"		
	4-22-30	Franklin, A. L.	✓ W.		Pl	Pl	Real Estate	50	"	"		214 J. Thonston St.	A. L. Franklin	"		
✓	4-22-30	Freeman, Marie	✓ W.		Pl	Pl	Home	33	"	"		1213 S. De Laney	Marie Freeman	"		
✓	4-22-30	Freeman, W. H.	✓ W.		Pl	Pl	Manager	34	"	"		1213 S. De Laney	W. H. Freeman Jr	"		
✓	4-24-30	Ford, Mr. J. G.	✓ D.		Pl.	Pl	Physician	37	"	"		1248 Thonston	Dr. J. G. Ford	"		
✓	4-25-30	Fitzgerald, J. W.	✓ D.		Pl	Pl.	Sec.	50	"	"		711 Delaney St.	J. W. Fitzgerald	"		
	4-25-30	Fingate, H. H.	D.		Ex	Ex	Builder	62	"	"		545 Margaret St.	H. H. Fingate	"		
✓	4-29-30	Finley, G. H.	✓ D.		Pl.	Pl.	Merchant	31	"	"		603 S. Mills.	G. H. Finley	"		
✓	4-30-30	Fowler, C. B.	D.		Pl.	Pl	Grove Supt.	38	W			438 Conway Rd.	C. B. Fowler	"		
✓	4-30-30	Fowler, Bessie	✓ D.		Pl.	Pl.	Home	36	W			438 Conway Rd.	Bessie Fowler	"		
✓	4-30-30	Floyd, Carol	D.		Pl.	Pl	Engineer	28	W			214 Annie.	Carol Floyd	"		
	4-30-30	Furen, L. H.	✓ D.		Pl.	Pl	Retired	40	W			1612 Howell.	L. H. Furen	"		
✓	4-30-30	Francisco, Pete	✓ D.		Pl	Pl	Grocer	37	W	Turkey.	#2845550. Orlando Nov. 17, 1928	119 Court.	Pete Francisco	"		
	4-30-30	Floyd, Grace	D.		Pl.	Pl	Home	27	W			214 Annie.	Grace Floyd	"		
✓	4-30-30	Fishback, Florence	✓ D.		Pl.	Pl	Home	28	W			1222 E. Kaley.	Florence Fishback	"		

OFFICIAL REGISTER OF ELECTORS FOR

PRECINCT,

COUNTY, FLORIDA

NUMBER	DATE	SURNAME AND GIVEN NAME	PARTY AFFILIATION	VOTED	POLL TAX		OCCUPATION	AGE	COLOR	NATIVITY	DECLARATION OR NATURALIZATION	RESIDENCE	OATH		SIGNATURE OF SUPERVISOR OR DEPUTY	REMARKS
													I, having been first duly sworn, say, upon Oath that the statements here entered opposite my name as to qualifications as an elector, are true.			
					Year	Year							SIGNATURE OF ELECTOR			
12	3-13-30	Godfrey Ruth B	10.		pd	pd.	Home	47	W	American		338 Pine de Leon Pl.	Godfrey Ruth B.	Mina Jean Moore		owns property
14	3-13-30	Godfrey Frederick, E.	10.		pd	pd.	Fruit Broker	47	W	American		" " "	Godfrey Frederick E.	" " "		owns property
44	3-29	Goss W. Robert	10.		ex	ex.	Chapman	74	W	American		1414 E. Gore	Goss W. Robert	" " "		owns property
65	4-1	George David	R.		E	E	Retired	66	W	American		1306 Greenwood.	David George	" " "		owns property
68	4-1	Gisler Bessie A.	R.		pd	pd.	Home	50	W	American		315 Copeland Dr.	Bessie A. Gisler	" " "		owns property
73	4-2	Guernsey Edythe S.	10.		pd.	pd.	Home	28	W	American		516 So. Cherokee St.	Edythe S. Guernsey	" " "		owns property
74	4-2	Guernsey S. Kendrick	10.		pd	pd.	Investment	38	W	American		" "	S. Kendrick Guernsey	" " "		owns property
88	4-3	Gisler Chas. L.	R.		pd	pd.	Foot Doctor	53	W	American		315 Copeland Dr.	Dr Chas L. Gisler	" " "		owns property
106	4-7	Giles Jas. L.	10.		E	E	Mayor.	67	W	American		66 Lucerne Circle	Jas. L. Giles	" " "		owns property
111	4-7	Giles Nannie B.	10.		E	E	Home	68	W	American		142 Lucerne Circle	Nannie B. Giles	" " "		owns property
112	4-7	Gettier Ida E.	10.		E	E	Home	72	W	American		717 Delaney St.	Ida E. Gettier	" " "		owns property
✓	4-14-30	Garrett G. P.	10.		pd	pd.	Lawyer	42	"	"		219 Phillips Pl.	G. P. Garrett	J. H. Wheeler		
	4-15-30	Goss Katharine E.	10.		E	E	Home	76	"	"		144 E. Gore Ave	Mrs Katharine E. Goss	" " "		
✓	4-16-30	Godfrey J. B.	10.		pd	pd.	Insurance	53	"	"		700 W. Paney	J. B. Godfrey	" " "		
	4-19-30	Gabel Henry	10.		pd	pd.	Carpenter	53	"	"		207 South Hyer	Henry Gabel	" " "		
	4-23-30	Gray Frank W.	10.		pd	pd.	Physician	36	W	"		631 Bourne	Frank W. Gray	" " "		
✓	4-23-30	Gettier Norma	10.		pd	pd.	Modest	41	"	"		717 Delaney Pl.	Norma Gettier	" " "		
✓	4-23-30	Garrett Rosalie J.	10.		pd.	pd.	Home	30	"	"		219 Phillips Pl.	Rosalie J. Garrett	" " "		
✓	4-28-30	Getch Bertha	10.		pd	pd.	Teacher	47	W	"		1401 Catherine	Bertha Getch	" " "		
✓	4-29-30	Gabel Richard	10.		pd	pd.	Projectionist	22	W	"		207 S. Hyer	Richard Gabel	" " "		
✓	4-30-30	Gordon Clara	10.		pd	pd.	Home	35	W	"		210 S. Thornton	Clara Gordon	" " "		

OFFICIAL REGISTER OF ELECTORS FOR

PRECINCT,

COUNTY, FLORIDA

NUMBER	DATE	SURNAME AND GIVEN NAME	PARTY AFFILIATION	VOTED	POLL TAX		OCCUPATION	AGE	COLOR	NATIVITY	DECLARATION OR NATURALIZATION	RESIDENCE	OATH I, having been first duly sworn, say, upon Oath that the statements here entered opposite my name as to qualifications as an elector, are true		SIGNATURE OF SUPERVISOR OR DEPUTY	REMARKS
					Year	Year										
	1930															
✓ 54	3-31	Hearley Bess M.	R.	Pd.	Pd.		Home	52	W.	American		903 S. Mills St.	Bess M. Hearley	Nina Jean Moore		owns property
✓ 79	4-2	Hardaway Mary J.	R.	Pd.	Pd.		Stenographer	40	W.	American		708 Anderson	Mary J. Hardaway			owns property
✓ 80	4-2	Harkness Estella	R.	Pd.	Pd.		Practical Nurse	48	W.	American		613 Daniels	Estella Harkness			owns property
✓ 81	4-3	Harris J. A.	R.	Ex.	Ex.		Carpenter	57	W.	American		1003 Palmer St.	J. A. Harris			no property
✓ 89	4-4	Hearley Dal R.	R.	Pd.	Pd.		Groceryman	53	W.	American		903 S. Mills St.	Dal R. Hearley			owns property
124	4-7	Hughes John M.	R.				Salesman	28	W.	American		6 E. Duane Circle	John M. Hughes			no property
123	4-7	Hopkins Helen L.	R.	Pd.	Pd.		Home	42	W.	American		519 S. Sumner	Helen L. Hopkins			owns property
✓ 65	4-9-30	Howard Robert F.	D.	Pd.	Pd.		Wholesale Grocery	50	"	"		824 S. Osceola	Robert F. Howard	J. H. Wheeler		
	4-16-30	Harnden A. B.	W.				Civil Engineer	39	"	"		710 E. Central Ave.	A. B. Harnden			
✓	4-16-30	Hollenbeck J. A.	Ind.	Ex.	4		Retired	64	W.	American		1805 Hollenbeck Dr.	J. A. Hollenbeck			
✓	4-21-30	Hansel E. W.	✓ D.	Pd.	Pd.		Fruit Business	46	W.			1717 Kuhl Ave.	E. W. Hansel			
	4-22-30	Hays Jack	✓ D.	Pd.	Pd.		Lawyer	31	W.			337 Power Dr. from St.	Jack Hays			
	4-22-30	Hansel Vera Mae	Ind.	Pd.	Pd.		Home	36	"	"		1717 Kuhl Ave.	Vera Mae Hansel			
	4-22-30	Hollenbeck Katie L.	Ind.	Ex.	Ex.		Home	65	W.	"		1805 Hollenbeck Dr.	Katie L. Hollenbeck			
✓	4-25-30	Hammett S. W.	✓ D.	Pd.	Pd.		Salesman	33	W.			1311 S. Osceola St.	S. W. Hammett			
✓	4-26-30	Hurlburt Gerald B.	W.	Pd.	Pd.		Dealer	35	"	"		700 S. Sumner	Gerald B. Hurlburt			
✓	4-26-30	Hartley Pearl C.	R.	Ex.	Pd.		Home	42	"			729 Euclid Ave.	Pearl C. Hartley			
✓	4-26-30	Hartley Guy B.	R.	Ex.	Pd.		Salesman	45	"	"		"	Guy B. Hartley			
	4-26-30	Hammett Mary B.	Ind.				Saleslady	27	"	"		1311 S. Osceola St.	Mary B. Hammett			
✓	4-28-30	Hagar Otto L.	✓ D.	Pd.	Pd.		Merchant	42	"			1107 Palmer	Otto L. Hagar			
	4-28-30	Haine Louis	R.	Ex.	Ex.		Retired	66	W.	"		1208 E. Central	Louis Haine			
	4-29-30	Harris S. S.	D.	Pd.	Pd.		Accountant	47	W.			2115 Delaney	S. S. Harris			
✓	4-29-30	Howard Marie B.	✓ D.	Pd.	Pd.		Home	39	W.			502 Palmer	Marie B. Howard			
	4-29-30	Hodgkinson Geo. J.	✓ D.	Pd.	Pd.		R. E.	53	W.			855 Walnut	Geo. J. Hodgkinson			
	4-29-30	Hodgkinson Mary B.	✓ D.	Pd.	Pd.		Home	45	W.			855 Walnut	Mary B. Hodgkinson			
✓	4-30-30	Hall I. L.	✓ D.	Ex.	Ex.		Gardner	59	W.			E. Central	I. L. Hall			
	4-30-30	Houser J. B.	D.				Self	54	W.			1701 Kuhl Ave.	J. B. Houser			
	4-30-30	Haley A. L.	D.				Hyg. A. & P. G.	23	W.			940 Bradshaw Terrace	A. L. Haley			
✓	4-30-30	Howard R. M.	✓ D.	Pd.	Pd.		Broker	30	W.			824 S. Osceola	R. M. Howard			
✓	4-30-30	Hutchinson Max	✓ D.	Ex.	Ex.		Bookkeeper	21	W.			1714 E. Kuhl Ave.	Max Hutchinson			
✓	4-30-30	Hart Mrs. Mattie	D.	Pd.	Pd.		Clerk	55	W.			710 Woodruff	Mrs. Mattie Hart			
✓	4-30-30	Hill W. J.	R.	Pd.	Pd.		Landscaping	46	W.			126 Lawrence	W. J. Hill	C. F. Batchelder Clerk		

OFFICIAL REGISTER OF ELECTORS FOR

PRECINCT, COUNTY, FLORIDA

NUMBER	DATE	SURNAME AND GIVEN NAME	PARTY AFFILIATION	VOTED	POLL TAX		OCCUPATION	AGE	COLOR	NATIVITY	DECLARATION OR NATURALIZATION	RESIDENCE	OATH		SIGNATURE OF SUPERVISOR OR DEPUTY	REMARKS
					Year	Year							I, having been first duly sworn, say, upon Oath that the statements here entered opposite my name as to qualifications as an elector, are true			
													SIGNATURE OF ELECTOR			
✓ 43	3-79	Ives Lois F.	✓	20	Pd	Pd	Home	24	W.	American		617 DeLaney	Lois F. Ives		Nina Jean Moore	no property
97	4-5	Ives S. E. Jr.	✓	20	pl	pl	Merchant	51	W.	American		116 Annie	S. E. Ives Jr.		"	owns property
✓ 100	4-5	Ives Maude C.	✓	20	pl	pl	Home	49	W.	American		116 Annie	Maude C Ives		"	owns property
✓ 4-23-30		Ivey Grover J.	✓	10	Pd	Pd	Druggist	37	"	"		112 Annie	Grover J Ivey		J. H. Tucker	
✓ 4-25-30		Ives, M. B.	✓	20	pl	Pd	Druggist	47	"	"		818 S. Main St.	M. B. Ives		"	
4-26-30		Ireminger, Fannie		10	Ex	Ex	Home	63	W.	"		434 E. Harding	Fannie Ireminger		"	
4-26-30		Ives, Edith G.	✓	10	pl	Pd	Home	40	"	"		818 S Main	Edith G. Ives		"	
✓ 4-30-30		Ivey, Mary King	✓	20	Pd	Pd	Home	34	"	"		112 Annie St.	Mary King Ivey		"	

NUMBER	DATE	SURNAME AND GIVEN NAME	PARTY AFFILIATION	VOTED	POLL TAX		OCCUPATION	AGE	COLOR	NATIVITY	DECLARATION OR NATURALIZATION	RESIDENCE	OATH I, having been first duly sworn, say, upon Oath that the statements here entered opposite my name as to qualifications as an elector, are true		SIGNATURE OF SUPERVISOR OR DEPUTY	REMARKS
					Year 24	Year 29							SIGNATURE OF ELECTOR			
	1930															
2	3 7	Jones Virgil N.	D.		by	4	Real Estate	59	W.	Amir.		931 S. Mills St	Virgil N. Jones		Nina Jean Moore	No property
10	3/10	Jochum Henry	D.		Pd		Janitor	54	W.	Amir.		1408 E. Gore ave	Henry Jochum		"	owns home
✓ 137	4-7	Garman Katherine	D.		Pd	Pd	Home	44	W.	American		642 Bourne Pl.	Katherine Garman		"	no property
	4-19-30	Garman A. B.	W.		Pd	Pd	Traveling	50	W.	"		642 Bourne	A. B. Garman		J. H. Tucker	
✓	4-23-30	Jacobson L.	✓ W.		Pd	Pd	Merchant	47	"	"	"Nat" Boston Mass #1257680	222 S. Thornton	L. Jacobson		"	
✓	4-29-30	Jones, E. E.	D.		Pd	Pd	—	43	"			15-05 Conway Rd.	E. E. Jones		"	
✓	4-29-30	Jacobson, John	D.		Pd	Pd	Merchant	42	"			1615 Delaney Park	John Jacobson		"	
✓	4-30-30	Jones, Mrs. Elmer	D.		Pd	Pd	Home	42	W.			15-05 Conway Rd.	Mrs. Elmer Jones		"	

NUMBER	DATE	SURNAME AND GIVEN NAME	PARTY AFFILIATION	VOTED	POLL TAX		OCCUPATION	AGE	COLOR	NATIVITY	DECLARATION OR NATURALIZATION	RESIDENCE	OATH I, having been first duly sworn, say, upon Oath that the statements here entered opposite my name as to qualifications as an elector, are true		SIGNATURE OF SUPERVISOR OR DEPUTY	REMARKS
					Year 28	Year 29										
55	3-31	King Sam. H.	R.				Insurance agt.	32	w.	American		5255 Simolin	Sam. H. King	Nina Jean Moore	in property	
✓	204-4-9-30	Karel. Frank Jr.	D		Pd	Pd	D. Sheriff	23	"	"		922 1/2 E. 1st	Frank Karel Jr.	J. H. Tucker		
✓	4-10-30	Karel. Frank Sr.	D	✓	Pd	4	Sheriff	58	"	"		"	Frank Karel			
	4-17-30	Klineet. John	W		4	4	Retired	67	"	"		202 E. Kaley	John Klineet			
✓	4-23-30	Kasper, Albert	R		Pd	Pd	Carpenter	38	"	"		517 Woodland	Albert Kasper			
✓	4-24-30	Kottelman. Harry	W		Pd	Pd	Merchant	31	"	"	"Nat" by father Papers	422 Rahau	Harry Kottelman			
	4-24-30	Kottelman. Rubie	W		Pd	Pd	Home	29	"	"		422 Rahau	Rubie Kottelman			
✓	4-25-30	Kasper, William C.	R.		Pd	Pd	Drink Stand	33	"	"		1128 Conway Rd	Wm. C. Kasper			
✓	4-25-30	Kasper, Ernest Sr.	R.		ex	x.	Retired	64	"	"		1206 S. Delaney	Ernest Kasper Sr.			
✓	4-29-30	Knox, G. S.	✓ D.		ex	x.	Farmer	72	"	"		Lancaster Park	G. S. Knox			
✓	4-29-30	Knox, Mrs. G. S.	D.		ex	x.	Home	69	w	"		Lancaster Park	Mrs. G. S. Knox			
	4-30-30	Kennison, Chester	R.				Builder	43	w	"		1320 E. Central	Chester Kennison			
	4-30-30	Klineet, Julia	D.		ex	4.	Home	66	w	"		202 E. Kaley	Julia Klineet			
✓	4-30-30	Kethredy, M. K.	✓ D.		Pd	Pd	Accountant	27	w	"		1212 Palmer	M. K. Kethredy			
	4-30-30	Kennison, Myrtle E.	R.				Home	30	w	"		1 Kennison	Myrtle E. Kennison			

NUMBER	DATE	SURNAME AND GIVEN NAME	PARTY AFFILIATION	VOTED	POLL TAX		OCCUPATION	AGE	COLOR	NATIVITY	DECLARATION OR NATURALIZATION	RESIDENCE	OATH		SIGNATURE OF SUPERVISOR OR DEPUTY	REMARKS
					Year 28	Year 29							I, having been first duly sworn, say, upon Oath that the statements here entered opposite my name as to qualifications as an elector, are true	SIGNATURE OF ELECTOR		
	1930.															
25	3-21	Lippincott Margaret J.	R.				Home	40	W.	American		919 Bradshaw Terrace	Mrs Margaret J. Lippincott		Nina Jean Moore	owns property
✓ 104	4-7	Laicester John T.	R.		✓	✓	Poultry	67	W.	Canada	Dec. 3, 1891 Newsown. Comm. Common Pleas Court.	1108 Palmer St.	John T. Lancaster		"	owns property
✓ 117	4-7	Lee Florence L.	✓ R.		✓	✓	Home	57	W.	American		1521 Conway Road	Florence L. Lee		"	owns property
✓ 127	4-7	Lee Joe.	✓ R.		✓	✓	Baker	58	W.	American		1521 Conway Rd.	Joe L. Lee		"	owns property
✓ 4-14-30		Lamb Jas M.	✓ W.		Pd.	Pd.	Insurance	58	W.	"		1206 E. Kaley	Jas M. Lamb		J. H. Tucker	
✓ 4-18-30		Link John	✓ W.		✓	✓	Ex Sailor	73	W.	"	Nat # 2845516 17 Nov. 1928 Orange Ct. Ct.	458 E. Kaley	John Links		"	
✓ 4-19-30		Landstreet Herman	W.		Pd.	Pd.	H. Boney	36	"	"		518 E. Gore Ave.	(Mrs) Lucile Landstreet		"	
✓ 4-19-30		Langford Hamm	W.		Pd.	Pd.	State Banking	28	"	"		116 Annie	Herman Langford		"	
✓ 4-21-30		Landstreet Arthur F.	D.		Pd.		Manager	39	"	"		518 E. Gore Ave.	Arthur F. Landstreet		"	
✓ 4-23-30		Luff M. H.	✓ W.		Pd.	Pd.	Manager	37	W.	"		112 Hawthorne	M. H. Luff		"	
✓ 4-29-30		Langston Mrs. E. C.	✓ D.		Pd.	Pd.	Home	49	W.	"		805 Euclid.	Mrs. E. C. Langston		"	
✓ 4-29-30		Langston Lucille	✓ D.		Pd.	Pd.	Home	23	W.	"		"	Lucille Langston		"	
4-30-30		Long W. E.	D.		Ex	Ex	Orange Culture	63	W.	"		1606 E. Central.	W. E. Long		"	
4-30-30		Long Mrs. E. R.	✓ D.		Ex	Ex	Home	70	W.	"		1606 E. Central.	Mrs. E. R. Long		"	
✓ 4-30-30		Langston E. C.	D.		Pd.	Pd.	Contractor	56	W.	"		805 Euclid.	E. C. Langston		"	
4-30-30		Lindersmith Effie D.	R.		Pd.	Pd.	Acct.	39	W.	"		1007 Harwell.	Effie D. Lindersmith		"	
✓ 4-30-30		Langston W. H.	✓ D.		Ex	Ex	Grover	60	W.	"		501 Conway Rd.	W. H. Langston		"	
✓ 4-30-30		Langston Fannie	✓ R.		Ex	Ex	Home	61	W.	"		501 Conway Rd.	Mrs Fannie Langston		"	
4-30-30		Ley Mrs. J. B.	D.		Ex	Ex	Home	65	W.	"		1226 S. Delaney	Mrs J. B. Ley		"	
4-30-30		Locke Mrs. Carrie	D.		Pd.		Stenog.	26	W.	"		706 S. Mills.	Mrs Carrie Locke		"	
4-30-30		Locke Spencer	D.		Pd.		Postal Clerk	26	W.	"		706 S. Mills.	Spencer Locke		"	
10-14-30			W.				Real Estate	42	W.	American		509 S. Ocala	W. S. Lamberton			Property

NUMBER	DATE	SURNAME AND GIVEN NAME	PARTY AFFILIATION	VOTED	POLL TAX		OCCUPATION	AGE	COLOR	NATIVITY	DECLARATION OR NATURALIZATION	RESIDENCE	OATH I, having been first duly sworn, say, upon Oath that the statements here entered opposite my name as to qualifications as an elector, are true		SIGNATURE OF SUPERVISOR OR DEPUTY	REMARKS
					Year	Year										
	1930															
17	3-15	McCutcheon Peter	✓ D.		ex	ex	Farmer	74	W	American		523 E. Miller	Peter McCutcheon	Tina Jean Moore		owns property
40	3-29	Mather Arthur E.	R.		ex	ex	Carpenter	69	W	American		1003 So. Mills	Arthur E. Mather	"		owns property
66	4-1	Metzinger Celia	R.				Home	45	W	American		733 Euclid	Celia Metzinger	"		owns property
67	4-1	Metzinger Emil	R.		ex	ex	Real Estate	58	W	Romania	April 27-1897 Minneapolis Minn. Hampden Co. Court.	733 Euclid	Emil Metzinger	"		owns property
70	4-2	McCorie Wm J.	R.		ex	ex	Decorator	68	W	American		615 S. Mills	Wm J. McCorie	"		owns property
84	4-3	McGarity J. C.	✓ D.		Pd.	Pd.	Baggage agt.	40	W	American		507 So. Hyer St.	J. C. McGarity	"		owns property
85	4-3	McGarity Fannie	✓ D.		Pd.	Pd.	Home	38	W	American		507 So. Hyer St.	Fannie McGarity	"		owns property
114	4-7	McEntire H. V.	R.		ex	ex	Painter	58	W	American		1009 Greenwood	H. V. McEntire	"		owns property
124	4-7	McGrath Blaine	R.		Pd.		Advertising	42	W	American		615 Woodlawn Blvd.	Blaine McGrath	"		owns property
123	4-7	McKinnon D. M.	✓ D.				Letter carrier	47	W	American		129 Grant	D. M. McKinnon	"		owns property
126	4-7	Moorman J. L.	✓ D.		Pd.	Pd.	Railroad	47	W	American		128 Wackeria	J. L. Moorman	"		owns property
128	4-7	McFerrin Elie	R.		ex	ex	Home	21	W	American		406 Nottingham	Elie McFerrin	"		no property
129	4-7	Metzinger Harold	R.		ex	ex	Musician	31	W	American		733 Euclid Ave.	Harold Metzinger	"		no property
130	4-7	Metzinger Mattie Mae	D.		ex	ex	Home	21	W	American		642 Buena Pl.	Mattie Mae Metzinger	"		no property
131	4-7	Metzinger Julian	✓ D.		ex	Pd.	Realtor	23	W	American		642 Buena Pl.	Julian Metzinger	"		owns property
✓	4-14-30	Moorman Mary S.	W		Pd.	Pd.	Home	41	"	"		128 Wackeria Ave.	Mary S. Moorman	J. H. Tucker		
✓	4-18-30	Mosteller J. W.	W		Pd.	Pd.	Real Estate	53	"	"		142 E. Gore Ave.	J. W. Mosteller	"		
✓	4-19-30	Menges Jacob J.	W		ex	ex	Carpenter	91	"	"		916 E. Pine	Jacob J. Menges	"		
✓	4-22-30	Miller Constant	D.		ex	x.	Delesman	66	"	"		1413 Kuhl Ave.	Constant Miller	"		
✓	4-22-30	Morse Geo. G.	✓ D.		Pd.	ex	Mgr.	56	"	"		210 Phillips Pl.	Geo. G. Morse	"		
✓	4-22-30	McComack Joe M.	W		Pd.	Pd.	Lumber	51	"	"		713 De Laney	Joe M. McComack	"		
✓	4-23-30	McEwan W. J.	W		Pd.	Pd.	Physician	52	"	"		705 S. D. Laney	W. J. McEwan	"		
✓	4-24-30	Mokrey George	R.		Pd.	Pd.	Labor	50	"	"	New Jersey Co of Public May 14/1003	921 Bradshaw	George Mokrey	"		
✓	4-24-30	Morris James A. Jr.	D.				Mfg.	47	"	"		22 E. Esther Ave.	James A. Morris Jr.	"		
✓	4-25-30	McEwan Roberta	W		Pd.	Pd.	Home					705 S. Delaney	Roberta McEwan	"		
✓	4-26-30	Mosteller Florence	W		Pd.	Pd.	Home	52	W	"		142 E. Gore	Florence Mosteller	"		
✓	4-26-30	Morris Maud N.	W				"	46	"	"	Nat' By Father Papier	22 E. Arthur	Maud N. Morris	"		
✓	4-28-30	Morgan C. C.	D.		Pd.	Pd.	Contr.	30	W	"		1413 Kaley Ave.	C. C. Morgan	"		
✓	4-29-30	Macleon A. L.	✓ D.		ex	ex	Retired	71	W	"		319 Kaley Ave.	A. L. Macleon	"		
✓	4-29-30	Maguire R. F.	D.		Pd.	Pd.	Lawyer	39	W	"		806 Euclid Ave.	R. F. Maguire	"		
✓	4-29-30	Mather Mrs. A. E.	✓ D.		ex	ex	Dressmaker	70	W	"		1003 S. Mills	Mrs. A. E. Mather	"		
✓	4-30-30	Miller Varena	D.				Sten.	24	W	"		1411 S. Osceola	Varena Miller	"		
✓	4-30-30	Moore Annie S.	D.		Pd.	ex	Home	55	W	"		210 Phillips Place	Annie S. Moore	"		

WALKER, EVANS & COGSWELL CO., CHARLESTON, S. C.

NUMBER	DATE	SURNAME AND GIVEN NAME	PARTY AFFILIATION	VOTED	POLL TAX		OCCUPATION	AGE	COLOR	NATIVITY	DECLARATION OR NATURALIZATION	RESIDENCE	OATH		SIGNATURE OF SUPERVISOR OR DEPUTY	REMARKS
					Year 28	Year 29							I, having been first duly sworn, say, upon Oath that the statements here entered opposite my name as to qualifications as an elector, are true			
													SIGNATURE OF ELECTOR			
	4-30-30	Massey, J. E.	D.		Pd		Retired	51	W			1210 Delaney	J. E. Massey		J. H. Tucker	
	4-30-30	Morris, James A. Jr.	D.		Ex	Ex	Paint Maker	22	W			22 E. Esther	James A. Morris Jr.		"	
✓	4-30-30	Nickler, Rolfe	D.		Ex	Ex	—	22	W			808 Anderson	Rolfe Nickler		"	
	4-30-30	Maguire, Ruth M.	D.		Pd	Pd	Home	33	W			800 Euclid	Ruth M. Maguire		"	

OFFICIAL REGISTER OF ELECTORS FOR

PRECINCT, _____ COUNTY, FLORIDA

NUMBER	DATE	SURNAME AND GIVEN NAME	PARTY AFFILIATION	VOTED	POLL TAX		OCCUPATION	AGE	COLOR	NATIVITY	DECLARATION OR NATURALIZATION	RESIDENCE	OATH		SIGNATURE OF SUPERVISOR OR DEPUTY	REMARKS
					Year	Year							I, having been first duly sworn, say, upon Oath that the statements here entered opposite my name as to qualifications as an elector, are true	SIGNATURE OF ELECTOR		
✓	4-25-30	Mc Keever, Josephine	✓ D.		2x	2x	None	59	w			900 E. Central	Mrs Josephine M. Keever	J. H. Tucker		
✓	4-26-30	Mc Cormick, Edna Mae	✓ W		pd	pd	Home	50	w	American		713 E. Mc Lamy	Edna Mae McCormick	J. H. Tucker		

OFFICIAL REGISTER OF ELECTORS FOR

PRECINCT, COUNTY, FLORIDA

NUMBER	DATE	SURNAME AND GIVEN NAME	PARTY AFFILIATION	VOTED	POLL TAX		OCCUPATION	AGE	COLOR	NATIVITY	DECLARATION OR NATURALIZATION	RESIDENCE	OATH		SIGNATURE OF SUPERVISOR OR DEPUTY	REMARKS
					Year	Year							I, having been first duly sworn, say, upon Oath that the statements here entered opposite my name as to qualifications as an elector, are true	SIGNATURE OF ELECTOR		
✓	11-16-30	McDowell, E. H.	✓	W	28	29	Ed. Pol City Insurer	31	W	American		612 Brian Place	E. H. McDowell	J. H. Tucker		

NUMBER	DATE	SURNAME AND GIVEN NAME	PARTY AFFILIATION	VOTED	POLL TAX		OCCUPATION	AGE	COLOR	NATIVITY	DECLARATION OR NATURALIZATION	RESIDENCE	OATH		SIGNATURE OF SUPERVISOR OR DEPUTY	REMARKS
					28-29								I, having been first duly sworn, say, upon Oath that the statements here entered opposite my name as to qualifications as an elector, are true			
					Year	Year							SIGNATURE OF ELECTOR			
✓ 48	3-31	Newby Leroy W.	R.				Insurer	41	W	American		1500 E. Gore	Leroy W. Newby	Mrs. Jean Moore		owns property
49	3-31	Newby Augusta C.	R.				Home	41	W	American		1500 E. Gore	Augusta C. Newby	"		owns property
✓ 18	4-8-30	Nash Vera D.	✓ D.		pd	pd	Home	36	"	"		420 S. Cherokee	Vera D. Nash	J. H. Tucker		
✓ 4	17-30	Newell L. G.	✓ W.		pd	pd	Attorney	38	"	"		522 S. Cherokee	L. G. Newell	"		
✓ 4	17-30	Nash Geo. S.	W.	✓	pd	pd	Teller	40	"	"		420 S. Cherokee	Geo. S. Nash	"		
✓ 4	19-30	Nable Gustavus R.	R.		ex	ex	Painter	61	"	"		1518 Greenwood	Gustavus Nable	"		
✓ 4	19-30	Nable Isabella R.	R.		ex	ex	Home	60	"	"		1518 Greenwood	Isabella R. Nable	"		
✓ 4	19-30	Nable William G.	R.				Carpenter	34	"	"		1522 Greenwood	William G. Nable	"		
✓ 4	22-30	Neal J. A.	✓ W.		pd	pd	Physician	55	"	"		514 Palmer St	Dr. J. A. Neal	"		
	4-29-30	Newell Eleanor H.	D.		pd	pd	—	27	W			605 Conway	Eleanor H. Newell	"		
	4-30-30	Newman Mrs. Ollie	D.		ex	ex	Home	74	"			721 Anderson	Mrs. Ollie Newman	"		
4	4-30-30	Nelson W. U.	D.				Salesman	24	W			706 Palmer	W. U. Nelson	"		
✓ 4	30-30	Nice Emma J.	R.		pd	pd	Home	39	"			1510 Conway	Emma J. Nice	"		
	4-30-30	Newman W. C.	D.				T. S. D. Agent	39	"			721 Anderson	W. C. Newman	"		
✓ 4	30-30	Newman Sidney P.	✓ D.		pd	pd	Merchant	33	"			605 Conway	Sidney P. Newell	"		
✓ 4	30-30	Nable Raymond	R.		ex	ex	Salesman	21	W			1518 Greenwood	Raymond Nable	"		
4	4-30-30	Nice Clarence C.	✓ D.		pd	pd	Musician	38	W			1510 Conway Rd.	Clarence C. Nice	"		

ADJUTANT

OFFICIAL REGISTER OF ELECTORS FOR

PRECINCT, COUNTY, FLORIDA

WALKER, EVANS & COSEWELL CO., CHARLESTON, S. C.

NUMBER	DATE	SURNAME AND GIVEN NAME	PARTY AFFILIATION	VOTED	POLL TAX		OCCUPATION	AGE	COLOR	NATIVITY	DECLARATION OR NATURALIZATION	RESIDENCE	OATH		SIGNATURE OF SUPERVISOR OR DEPUTY	REMARKS
					Year	Year							I, having been first duly sworn, say, upon Oath that the statements here entered opposite my name as to qualifications as an elector, are true	SIGNATURE OF ELECTOR		
	1930															
✓ 21	3-19	O'Neal Willie	✓ R		Pd	Pd	Secretary	47	W	American		6 E. Lucerne Cr.	Willie O'Neal		Nina Jean Moss	owns property
58	3-31	Otto John B.	R		4	4	Retired	82	W	American		526 So Hyer	John B. Otto		"	owns property
✓ 59	4-1	O'Neal Mabelle	R		Pd	Pd	Home	41	W	American		614 S. Lake	Mabelle O'Neal		"	owns property
✓ 62	4-1	O'Neal W. R.	R		W	4	Barber	65	W	American		614 So Lake	Mr O'Neal		"	owns property
✓ 98	4-5	Overton E. W.	R		4	4	Carpenter	64	W	American		516 Daniels	E W Overton		"	owns property
193	4-7	Oatley Ernest J.	R		4	4	Clerk	62	W	England	Oct 1896 New Haven Conn Court of Common Pleas	514 So. Lake	Ernest J Oatley		"	owns property
4-17-30		O'Neal. A. J.	R		Pd		Salesman	42	W	American		715 Delaney Park	A. J. O'Neal		J. H. Tucker	
✓ 0	4-22-30	O'Steen, J. B.	✓ D		Pd	Pd	Ingr.	37	W			718 Amel St	J B O'Steen		"	
0	4-23-30	O'Neal, E. M.	W				Mechanic	39	"	"		33. Cather	E. M. O'Neal		"	
✓ 4	25-30	Orr, Dorothy Barr	✓ W		rd.	Pd	Home	25	W	"		908 S. Lake	Dorothy Barr Orr		"	
✓ 4	26-30	Orr, Dr Louis	W		Pd.	Pd	Physician	30	"	"		"	Louis Orr		"	
(cell)	4-29-30	O'Neal, Mabel C.	D.		rd	rd	Home.	41	"	"		715 Delaney Park	Mabel C. O'Neal		"	
0	4-30-30	O'steen, J. M.	✓ D.		rd	Pd	Salesman.	41	"	"		168. E. Central	J M O'steen		"	
	4-30-30	Omar, C. S.	D.		rd.		Supt.	31	W	"		512 Rahn.	C S Omar.		"	

NUMBER	DATE	SURNAME AND GIVEN NAME	PARTY AFFILIATION	VOTED	POLL TAX		OCCUPATION	AGE	COLOR	NATIVITY	DECLARATION OR NATURALIZATION	RESIDENCE	OATH		SIGNATURE OF SUPERVISOR OR DEPUTY	REMARKS
					Year	Year							I, having been first duly sworn, say, upon Oath that the statements here entered opposite my name as to qualifications as an elector, are true	SIGNATURE OF ELECTOR		
	1930															
96	3-15	Partin James M.	✓ R.		Pd	Pd	Farmer	50	W.	American		523 E. Miller Ave.	James M. Partin	Mrs. Jean Moore		owns property
98	3-18	Partin Minnie	✓ D.		Pd	Pd	Home	47	W.	American		523 E. Miller Ave.	Minnie Partin	"		no property
91	4-2	Patch A. A.	R.		✓	✓	Business mgr.	61	W.	American		218 Copeland Dr.	A. A. Patch	"		owns property
72	4-2	Patch Adell	R.		✓	✓	Home	39	W.	American		218 Copeland Dr.	Adell Patch	"		owns property
107	4-7	Pierson Rose H.	R.		✓	✓	Home	62	W.	American		229 Copeland Dr.	Rose H. Pierson	"		owns property
108	4-7	Pierson M. G.	R.		✓	✓	Salesman	65	W.	American		229 Copeland Dr.	M. G. Pierson	"		owns property
110	4-7	Phillips Alice M.	✓ D.		✓	✓	Home	60	W.	American		103 Lucerne Cir.	Alice M. Phillips	"		owns property
134	4-7	Provost Norma	R.		✓	✓	Coffeteria mgr.	42	W.	American		519 S Summerlin	Norma Provost	"		no property
✓	4-12-30	Ponder R. C.	✓ D.		Pd	Pd	Salesman	41	W.	American		700 Anderson	R. C. Ponder	J. H. Tucker		
✓	4-18-30	Phillips, Chas	W.		✓	✓	Salesman	75	"	"		141 E. Esther	Chas. Phillips	"		
✓	4-21-30	Putnam, Percy	✓ D.		Pd	Pd	Insurance	55	"	"		1722 Fla. Ave.	Percy Putnam	"		
✓	4-22-30	Putnam, Elizabeth	✓ W.		Pd	Pd	Home	48	"	"		1722 Fla. Ave.	Mrs. Elizabeth L. Putnam	J. H. Tucker		
✓	4-22-30	Prugn, Alta B.	✓ R.		Pd	Pd	Home	47	"	"		4 E. Copeland	Alta B. Prugn	J. H. Tucker		
✓	4-24-30	Pound, Lee Roy	W.		Pd	Pd	Manager	40	W.	"		1514 E. Central	Lee Roy Pound	"		
✓	4-24-30	Pound, Marie L.	W.		Pd	Pd	Home	32	W.	"		1514 E. Central	Marie L. Pound	"		
✓	4-24-30	Pharr, William B.	✓ W.		Pd	Pd	Salesman	24	"	"		507 Richmond	William B. Pharr	"		
✓	4-25-30	Prugn, C. L.	R.		Pd	✓	Jeweler	56	"	"		4 E. Copeland	C. L. Prugn	"		
✓	4-28-30	Peterson, J. A.	✓ D.		Pd	Pd	Carpenter	48	"	"		200 Mural Ave.	J. A. Peterson	"		
✓	4-29-30	Phillips, Nettie F.	✓ D.		✓	✓	Home	73	W.	"		14 E. Esther	Nettie F. Phillips	"		
✓	4-30-30	Ponder, Cornelia	✓ D.		✓	✓	Home	68	W.	"		505 S. Summerlin	Mrs. Cornelia Ponder	"		
✓	4-30-30	Palmer, C. A.	✓ D.		✓	✓	Met.	33	W.	"		711 Greenwood	C. A. Palmer	"		
✓	4-30-30	Palmer, Allison Z.	✓ D.		Pd	✓	Lawyer	33	W.	"		511 Woodlawn	Allison Z. Palmer	J. H. Tucker		
✓	4-30-30	Purdy, Mrs. Frank A.	✓ R.		Pd	✓	Home	56	W.	"		939 Kahl	Mrs. Frank A. Purdy	"		
✓	4-30-30	Powell, Leah Jane	✓ D.		Pd	✓	Home	29	W.	"		309 Lawsona Blvd.	Leah Jane Powell	"		
✓	4-30-30	Powell, W. U.	✓ D.		Pd	Pd	Bookkeeper	32	W.	"		309 Lawsona Blvd.	W. U. Powell	"		
✓	4-30-30	Palmer, Martha B.	✓ D.		✓	✓	Home	57	W.	"		331 Ponce De Leon Place	M. B. Palmer	"		
✓	4-30-30	Porter, James	✓ D.		Pd	✓	Farmer	33	W.	"		1301 Delaney	James Porter	"		
✓	4-30-30	Porter, Alford	✓ D.		Pd	Pd	Orange Gro.	39	W.	"		924 Bradshaw	Alford Porter	"		
✓	4-30-30	Palmer, Lilla	✓ D.		✓	✓	Home	34	W.	"		711 Greenwood	Lilla Palmer	"		see #19-in "P"

NUMBER	DATE	SURNAME AND GIVEN NAME	PARTY AFFILIATION	VOTED	POLL TAX		OCCUPATION	AGE	COLOR	NATIVITY	DECLARATION OR NATURALIZATION	RESIDENCE	OATH		SIGNATURE OF SUPERVISOR OR DEPUTY	REMARKS
					Year	Year							I, having been first duly sworn, say, upon Oath that the statements here entered opposite my name as to qualifications as an elector, are true	SIGNATURE OF ELECTOR		
	1930															
✓ 11	3/11/30	Raines Nelle	✓ D		Pd	Pd	Bookkeeper	24	W	American		528 Daniels St	Nelle Raines	Mrs Jean Moore		No property
64	4-1	Ragsdale J. P.	✓ D		Ex	Ex	Carpenter	80	W	American		1920 Greenwood Ave	J P Ragsdale			owns property
75	4-2	Rush Edward	D		Ex	Ex	Carpenter	63	W	American		522 Daniel	Edward Rush			owns property
76	4-2	Rush Mrs. Bella	D		Ex	Ex	Home	57	W	American		522 Daniels St	Mrs Bella Rush			owns property
939	4-7	Rhodes Clifford	✓ D		Pd	Pd	Insurance	39	W	American		719 Summerlin St	Clifford Rhodes			owns property
✓ 40	4-8-30	Rose Ruby H.	Ry		Pd	Pd	Bookkeeper	38	W	"		603 S. Miller	Ruby H. Rose	J. H. Tucker		
✓	4-15-30	Rogers Robert B.	✓ D		Pd	Pd	Home	36	"	"		5179 Woodlawn Blvd	Robert B. Rogers			
✓	4-15-30	Rogers W. H.	✓ D		Pd	Pd	Bookkeeper	41	W	"		517 Woodlawn Blvd	W H Rogers			
✓	4-15-30	Dean J. H.	D				Auto Dealer	50	W	"		710 Delaney	J H Dean	See "D"		
✓	4-21-30	Radebaugh, C. S.	D		Pd	Pd	Lawyer	26	W	"		216 Milton Circle	C S Radebaugh	J. H. Tucker		
✓	4-21-30	Reynolds, H. M.	✓ D		Pd	Pd	Architect	43	W	"		204 So Brown	H M Reynolds			
✓	4-21-30	Robertson, H. C.	✓ W		Pd	Pd	Salesman	49	W	"		6048 De Laney	H C Robertson			
✓	4-23-30	Routh, Florence	✓ W		Pd	Pd	Home	45	W	"		132 E. Mural	Florence Routh			
✓	4-23-30	Reed, Elizabeth J.	✓ W		Ex	Ex	Home	63	W	"		125 E. Copeland Drive	Mrs. Elizabeth J. Reed			
✓	4-23-30	Reed, Helen	✓ W		Pd	Pd	Bookkeeper	29	"	"		125 E. Copeland Drive	Helen Reed			
✓	4-25-30	Radebaugh, Adeline G.	D		Pd	Pd	Home	27	"	"		216	Adeline G. Radebaugh			
✓	4-26-30	Raines, R. R.	W		Pd	Pd	Merchant	32	W	"		1210 S. Decosta	R R Raines			
✓	4-26-30	Ricketson, W. M.	✓ W		Pd	Pd	Inspector	42	"	"		18 E. Columbia	W M Ricketson			
✓	4-28-30	Rish, A. W.	D		Ex	Ex	Plumber	58	"	"		1215 E. Gore	A W Rish			
✓	4-30-30	Rush, Elizabeth K.	D				Home	43	W	"		1500 De Laney	Elizabeth K. Rush			
✓	4-30-30	Richards, J. B.	D		Pd		Auto Top.	51	W	"		1012 Harwell	J B Richards			
✓	4-30-30	Rachn, Annie E.	D				Home	33	W	"		1200 De Laney	Annie E. Rachn			
✓	4-30-30	Richards, V. L.	D		Pd		Salesman	25	W	"		1012 Harwell	V L Richards			
✓	4-30-30	Richards, Core A.	D		Pd		Home	49	W	"		1012 Harwell	Core A Richards			
✓	4-30-30	Richardson, Mary J.	✓ D		Ex	Ex	Music Teacher	66	W	"		427 S. Summerlin	Mary J. Richardson			
✓	4-30-30	Rush, F. G.	D				Auto Busi.	48	W	"		1500 De Laney	F G Rush			

NUMBER	DATE	SURNAME AND GIVEN NAME	PARTY AFFILIATION	VOTED	POLL TAX		OCCUPATION	AGE	COLOR	NATIVITY	DECLARATION OR NATURALIZATION	RESIDENCE	OATH		SIGNATURE OF SUPERVISOR OR DEPUTY	REMARKS
					1928 Year	1929 Year							I, having been first duly sworn, say, upon Oath that the statements here entered opposite my name as to qualifications as an elector, are true	SIGNATURE OF ELECTOR		
9	3-3	Starling Alvin A. R.	R.				Salesman	23	W.						A. A. Starling	Valid not in 11th district.
15	3-12-30	Stolzembach J. W. R.	R.				Retired	74	W.	american		704 So. Summerlin	J. W. Stolzembach		Mina Jean Moore	owns property
32	3-27	Stewart R. I. R.	R.				Collector	37	W.	american		709 S. Mill	R. I. Stewart			owns property
33	3-27	Stone J. C. R.	R.				Police Officer	24	W.	american		605 Louise	J. C. Stone			property owner
82	4-3	Swoen Mrs. W. A. R.	R.				Home	68	W.	american		1422 E. Gore	Mrs. Dora Swoen			
83	4-3	Swoen W. C. R.	R.				Retired	69	W.	american		1422 E. Gore	W. C. Swoen			owns property
101	4-5	Sturges Helen E. R.	R.				Home	50	W.	american		1012 Anderson	Helen E. Sturges			owns property
105	4-5	Schwalt Max R.	R.				Cement work	64	W.	Germany	Caniden, New Jersey 1884	1325 Coburn St.	Max Schwalt			owns property
115	4-7	Smith Elizabeth N. R.	R.				Home	49	W.	american		1515 Conway Road	Elizabeth N. Smith			owns property
916	4-7	Smith Howard S. R.	R.				Mechanic	26	W.	american		1515 Conway Road	Howard S. Smith			owns property
925	4-7	Slaughter Brantley R.	R.				Salesman	29	W.	american		1016 Delaney Park Dr.	Brantley R. Slaughter			owns property
136	4-7	Sturges, W. H. R.	R.				School work	56	W.	american		1012 Anderson St.	W. H. Sturges			owns property
140	4-7	Schnur Florence Charles R.	R.				Mechanic	35	W.	american		1313 Catherine St.	Florence Charles Schnur			owns property
143	4-7	Slaughter Nina D. R.	R.				Bookkeeper	30	W.	american		1016 Delaney Park Dr.	Nina D. Slaughter			
29	4-8	Somerville Henrietta R.	R.				Home	55	"	"		1302 E. Central	Henrietta R. Somerville		J. H. Tucker	
28	4-8	Somerville J. M. R.	R.				Retired	64	"	"		" " "	J. M. Somerville			
0	4-16-30	Smith, W. H. R.	R.				Painter	50	"	"		1515 Conway	W. H. Smith			
0	4-17-30	Swardmark A. P. R.	R.				Motion Club	43	"	"		139 E. Muriel	A. P. Swardmark			
0	4-17-30	Sargent B. Felton W.	R.				Stenographer	37	"	"		615 Cherokee Ave.	B. Felton Sargent			
0	4-21-30	Shiver, E. J. R.	R.				Real Estate	46	"	"		1007 Golden Oak Ct.	E. J. Shiver			
0	4-22-30	Sligh, S. J. R.	R.				Truck	67	"	"		239 Copeland	S. J. Sligh			
0	4-23-30	Smith, J. P. R.	R.				Police	46	W.	"		1307 E. Gore	J. P. Smith			
0	4-24-30	Sligh, Helen P. R.	R.				Home	45	"	"		239 Copeland Dr.	Helen P. Sligh			
0	4-24-30	Schmidle, May E. R.	R.				Steno	26	"	"		1016 Delaney St.	May E. Schmidle			
0	4-25-30	Slaughter, A. C. R.	R.				Trafficman	44	W.	american		213 Phelps Pl.	A. C. Slaughter			
0	4-26-30	Stevens, Harold R.	R.				V. S. D. A.	50	W.	"		206 Phillips	Harold E. Stevens			
0	4-26-30	Stewart, Elsie A. R.	R.				Home	58	"	"		320 Jasmine	Elsie A. Stewart			
0	4-28-30	Stemons, Phil J. R.	R.				Merchant	52	W.	american		339 Cherokee Dr.	Phil J. Stemons			
0	4-26-30	Stacey, W. A. R.	R.				Truck	65	"	"		E. Gore Ave.	W. A. Stacey			Signed in # 17.
0	4-28-30	Stenham, Mina J. R.	R.				Home	53	W.	american		230 E. Copeland	Mina J. Stenham			
0	4-28-30	Stenham, J. C. R.	R.				Salesman	56	W.	american		230 E. Copeland	J. C. Stenham			
0	4-28-30	Smith, Mrs. Howard A. R.	R.				Housewife	24	W.	american		1515 Conway Rd.	Mrs. Howard A. Smith			
0	4-28-30	Scarborough, Ernest W. R.	R.				Shoemaker	30	W.	american		435 E. Miller	Ernest W. Scarborough			
0	4-29-30	Smith, Frank A. R.	R.				Judge	40	W.	american		1226 Delaney	Frank A. Smith			

OFFICIAL REGISTER OF ELECTORS FOR

PRECINCT, COUNTY, FLORIDA

NUMBER	DATE	SURNAME AND GIVEN NAME	PARTY AFFILIATION	VOTED	POLL TAX		OCCUPATION	AGE	COLOR	NATIVITY	DECLARATION OR NATURALIZATION	RESIDENCE	OATH		SIGNATURE OF SUPERVISOR OR DEPUTY	REMARKS
					Year	Year							I, having been first duly sworn, say, upon Oath that the statements here entered opposite my name as to qualifications as an elector, are true			
													SIGNATURE OF ELECTOR			
0	4-30-30	Slemons, J. M.	✓ D.		Pd	Pd	Merchant.	46	W			1125 Palmer.	J. M. Slemons	J. H. Tucker		
	4-30-30	Sanderson, C.	✓ D.		Ex	Ex	Travelling.	60	W			7 Lucerne Ct.	C. Sanderson	"		
	4-30-30	Sydam, Mrs. Ada	R		Ex	Ex	Nurse	58	W	American		420 E. Noble	Ada Sydam	"	Witness	Ed. T. Jones
✓	4-30-30	Stowe, Mina B.	R		Ex	Ex	Home	70	W	American		1802 Holinbeck	Mina B. Stowe	"		Wm. B. Brown
	4-30-30	Scarborough, Stella W.	D				Teacher	30	W	American		435 E. Miller	Stella W. Scarborough	"	Witness	Burke De Witt
	4-30-30	Sharp, C. H.	D				Dentist	28	W	American		116 Annie St.	C. H. Sharp	"		John W. Wells
✓	4-30-30	Smith, Hallie L.	✓ D.		Pd	Pd	Home	38	W	American		1226 Delaney	Hallie L. Smith	"		
0	4-30-30	Sasser, J. B.	✓ D.		Pd	Pd	Retired	43	W	American		1214 E. Kaley	J. B. Sasser	"		
	4-30-30	Sasser, Kathleen H.	D				Home	27	W	American		1214 Kaley	Kathleen H. Sasser	"		
	4-30-30	Sackett, Mary E.	D		Pd	Pd	Cosmetician	49	W	American		274 E. Kaley	Mary E. Sackett	"		
0	4-30-30	Stowe, C. D.	D		Pd		Reporter-Star	33	W	American		946 Bradshaw	C. D. Stowe	946 Bradshaw Terrace		
0	4-30-30	Stowe, Carleton H. S.	D				Real Estate	33	W	American		815 S. Orange	Carleton H. S. Stowe	815 S. Orange Ave.		
	4-21-30	Stinebaugh, Lambert R.	R		Pd	Pd	Insurance	26	"	"		230 Copeland	Lambert R. Stinebaugh	See 17 for Signature		
	4-11-30	Steele, B. M.	R		Ex	Ex	Retired	69	"	"		1200 1 Euhl				
	4-16-30	Steele, M. A.	✓ D		Pd	Pd	Home	47	"	"		"				
0	4-25-30	Stacey, Jack R.	✓ D		Ex	Pd	Farm		"	"		1600 E. Elm.	Jack R. Stacey			
	8-30-30	T. E. Stapleton	D				Merchant	25					T. E. Stapleton			

NUMBER	DATE	SURNAME AND GIVEN NAME	PARTY AFFILIATION	VOTED	POLL TAX		OCCUPATION	AGE	COLOR	NATIVITY	DECLARATION OR NATURALIZATION	RESIDENCE	OATH I, having been first duly sworn, say, upon Oath that the statements here entered opposite my name as to qualifications as an elector, are true		SIGNATURE OF SUPERVISOR OR DEPUTY	REMARKS
					Year	Year										
	1930															
✓ 21	3-19	O'Neal Willie	✓ R		Pd	Pd	Secretary	41	W	American		6 E. Lucerne Cr.	Willie O'Neal	Nina Jean Moore		owns property
58	3-31	Otto John B.	R		4	4	Retired	82	W	American		526 So Hyer	John B. Otto	"	"	owns property
✓ 59	4-1	O'Neal Mabelle	R		Pd	Pd	Home	41	W	American		614 S. Lake	Mabelle O'Neal	"	"	owns property
✓ 62	4-1	O'Neal W. R.	R		W	4	Barber	65	W	American		614 So Lake	Mr O'Neal	"	"	owns property
✓ 98	4-5	Overtone E. W.	R		4	4	Carpenter	64	W	American		516 Daniels	E W Overtone	"	"	owns property
103	4-7	Oatley Ernest J.	R		4	4	Clerk	62	W	England	Oct 1896 New Haven Conn Court of Common Pleas	514 S. Lake	Ernest J Oatley	"	"	owns property
4-17-30		O'Neal A. J.	R		Pd		Salesman	42	W	American		715 Delaney Park	A. J. O'Neal	J. H. Tucker		
✓ 0	4-22-30	O'Steen, J. B.	✓ D		Pd	Pd	Ingr.	37	W			718 Amie St	J B O'Steen	"	"	
0	4-23-30	O'Neal E. M.	W				Mechanic	39	"	"		33. Arthur	E. M. O'Neal	"	"	
✓	4-25-30	Ors. Dorothy Barr	✓ W		Id.	Pd	Home	25	W	"		908 S. Lake Davis Divis	Dorothy Barr Ors	"	"	
✓	4-26-30	Ors. Wm Louis	W		Pd.	Pd	Physician	30	"	"		" " " "	Wm Louis Ors	"	"	
cell)	4-29-30	O'Neal, Mabel C.	D.		Pd	Pd	Home	41	"	"		715 Delaney Park	Mabel C. O'Neal	"	"	
0	4-30-30	O'steen, J. M.	✓ D.		Pd	Pd	Salesman	41	"	"		168 E. Central	J M O'steen	"	"	
	4-30-30	Omar, C. G.	D.		Pd.		Supt.	31	W	"		512 Rahn.	C G Omar	"	"	

NUMBER	DATE	SURNAME AND GIVEN NAME	PARTY AFFILIATION	VOTED	POLL TAX		OCCUPATION	AGE	COLOR	NATIVITY	DECLARATION OR NATURALIZATION	RESIDENCE	OATH		SIGNATURE OF SUPERVISOR OR DEPUTY	REMARKS
					Year	Year							I, having been first duly sworn, say, upon Oath that the statements here entered opposite my name as to qualifications as an elector, are true	SIGNATURE OF ELECTOR		
	1930															
✓ 96	3-15	Partin James M.	✓ D.		Pd	Pd	Farmer	50	W.	American		523 E. Miller ave	James M. Partin	Mina Jean Moore		owns property
✓ 22	3-19	Partin Minnie	✓ D.		Pd	Pd	Home	47	W.	American		523 E. Miller ave	Minnie Partin	"		no property
✓ 91	4-2	Patch A. A.	R.		U	U	Business mgr.	61	W.	American		218 Copeland Dr.	A. A. Patch	"		owns property
✓ 72	4-2	Patch Adell	R.		U	U	Home	39	W.	American		218 Copeland Dr.	Adell Patch	"		owns property
✓ 107	4-7	Pierson Rose H.	R.		U	U	Home	62	W.	American		229 Copeland Dr.	Rose H. Pierson	"		owns property
✓ 108	4-7	Pierson M. G.	R.		U	U	Salesman	65	W.	American		229 Copeland Dr.	M. G. Pierson	"		owns property
✓ 110	4-7	Phillips Alice M.	✓ D.		U	U	Home	60	W.	American		133 Lucerne Cir.	Alice M. Phillips	"		owns property
✓ 134	4-7	Provost Norma.	R.		Dr.		Coffeteria mgr.	42	W.	American		519 S Summerlin	Norma Provost	"		no property
✓ 10	4-12-30	Ponder, R. C.	✓ D.		Pd	Pd	Salesman	41	W.	American		700 Audwin	R. C. Ponder	J. H. Tucker		
✓	4-18-30	Phillips, Chas	W.		Ex	Ex	Salesman	75	"	"		141 E. Esther	Chas. Phillips	"		
✓ 10	4-21-30	Putnam, Percy	✓ D.		Pd	Pd	Insurance	55	"	"		1722 Fla. Ave.	Percy Putnam	"		
✓	4-22-30	Putnam, Elizabeth L.	W.		Pd	Pd	Home	48	"	"		1722 Fla. Ave.	Mrs. Elizabeth L. Putnam	J. H. Tucker		
✓	4-22-30	Pruyn, Alta B.	✓ D.		Pd	Pd	Home	47	"	"		4 E. Copeland	Alta B. Pruyn	J. H. Tucker		
✓ 10	4-24-30	Pound, Lee Roy	W.		Pd	Pd	Manager	40	W.	"		1514 E. Central	Lee Roy Pound	"		
✓	4-24-30	Pound, Marie L.	W.		Pd	Pd	Home	32	W.	"		1514 E. Central	Marie L. Pound	"		
✓ 10	4-24-30	Pharr, William B.	✓ W.		Pd	Pd	Salesman	24	"	"		507 Richmond	William B. Pharr	"		
✓ 10	4-25-30	Pruyn, C. L.	R.		Pd	Ex.	Jeweler	56	"	"		4 E. Copeland	C. L. Pruyn	"		
✓ 10	4-28-30	Peterson, J. A.	✓ D.		Pd	Pd	Carpenter	48	"	"		200 Murrel Ave.	J. A. Peterson	"		
✓	4-29-30	Phillips, Nettie F.	✓ D.		Ex	Ex	Home	73	W.	"		14 E. Esther	Nettie F. Phillips	"		
✓	4-30-30	Ponder, Cornelia	✓ D.		Ex	Ex	Home	68	W.	"		505 S. Summerlin	Mrs. Cornelia Ponder	"		
✓	4-30-30	Palmer, C. A.	✓ D.				Met.	33	W.	"		711 Greenwood	C. A. Palmer	"		
✓	4-30-30	Palmer, Allison Z.	✓ D.		Pd	Pd	Lawyer	33	W.	"		511 Woodlawn	Allison Z. Palmer	J. H. Tucker		
✓	4-30-30	Purdy, Mrs. Frank A.	R.		Pd	Ex	Home	56	W.	"		939 Kuhl	Mrs. Frank A. Purdy	"		
✓	4-30-30	Powell, Leah Jane	✓ D.		Pd	Pd	Home	29	W.	"		309 Lawrence Blvd.	Leah Jane Powell	"		
✓ 10	4-30-30	Powell, W. U.	✓ D.		Pd	Pd	Bookkeeper	32	W.	"		309 Lawrence Blvd.	W. U. Powell	"		
✓	4-30-30	Palmer, Martha B.	✓ D.		Pd	Ex.	Home	57	W.	"		331 Ponce DeLeon Place	M. B. Palmer	"		
✓ 10	4-30-30	Porter, James	✓ D.		Pd		Farmer	33	W.	"		1301 Delaney	James Porter	"		
✓ 10	4-30-30	Porter, Alford	✓ D.		Pd	Pd	Orange Grove	39	W.	"		924 Bradshaw	Alford Porter	"		
✓	4-30-30	Palmer, Lilla	✓ D.				Home	34	W.	"		711 Greenwood	Lilla Palmer	"		

NUMBER	DATE	SURNAME AND GIVEN NAME	PARTY AFFILIATION	VOTED	POLL TAX		OCCUPATION	AGE	COLOR	NATIVITY	DECLARATION OR NATURALIZATION	RESIDENCE	OATH		SIGNATURE OF SUPERVISOR OR DEPUTY	REMARKS
					Year	Year							I, having been first duly sworn, say, upon Oath that the statements here entered opposite my name as to qualifications as an elector, are true	SIGNATURE OF ELECTOR		
	1930															
✓ 11	3/11/30	Raines Nelle	✓ D		Pd	Pd	Bookkeeper	24	W	American		528 Daniels St	Nelle Raines	Mrs Jean Moore		No property
64	4-1	Ragsdale J. P.	✓ D		4	4	Carpenter	80	W	American		1920 Greenwood Ave	J P Ragsdale	"		owns property
75	4-2	Rush Edward	D		4	4	Carpenter	63	W	American		522 Daniel	Edward Rush	"		owns property
76	4-2	Rush Mrs. Bella	D		4	4	Home	57	W	American		522 Daniels St	Mrs Bella Rush	"		owns property
939	4-7	Rhodes Clifford	✓ D		Pd	Pd	Insurance	39	W	American		719 Summerlin St	Clifford Rhodes	"		owns property
40	4-8-30	Rose Ruby H.	Ry		Pd	Pd	Bookkeeper	38	W	"		603 S. Miller	Ruby H. Rose	J. H. Mucker		
	4-15-30	Rogers Robert B.	✓ D		Pd	Pd	Home	36	"	"		517 Woodlawn Blvd	Robert B. Rogers	"		
✓ 4	15-30	Rogers W. H.	✓ D		Pd	Pd	Auto Dealer	41	W	"		517 Woodlawn Blvd	W H Rogers	"		
✓ 4	15-30	Rogers J. H.	D				Auto Dealer	50	W	"		710 Delaney	J H Rogers	Lee "D"		
✓ 4	21-30	Rodebaugh C. S.	D		Pd	Pd	Lawyer	26	W	"		2167 Mission Circle	C. S. Rodebaugh	J. H. Mucker		
✓ 4	21-30	Reynolds H. M.	✓ D		Pd	Pd	Architect	43	W	"		204 So. Brown	H. M. Reynolds	"		
✓ 4	21-30	Robertson H. C.	✓ W		Pd	Pd	Salesman	49	W	"		6048 De Laney Park 10r	H. C. Robertson	"		
✓ 4	23-30	Routh Florence	✓ W		Pd	Pd	Home	45	W	"		132 E. Mural	Florence Routh	"		
✓ 4	23-30	Reed Elizabeth J.	✓ W		Ex	Ex	Home	63	W	"		125 E. Copeland Drive	Mrs. Elizabeth J. Reed	X		
✓ 4	23-30	Reed Helen	✓ W		Pd	Pd	Bookkeeper	29	"	"		125 E. Copeland Drive	Helen Reed	"		
4	25-30	Rodebaugh Adeline S.	D		Pd	Pd	Home	27	"	"		216	Adeline S. Rodebaugh	"		
✓ 4	26-30	Raines R. R.	W		Pd	Pd	Merchant	32	W	"		1210 S. Alameda	R. R. Raines	"		
4	26-30	Rickerson W. M.	✓ W		Pd	Pd	Inspector	42	"	"		18 E. Columbia	W. M. Rickerson	"		
✓ 4	28-30	Rish U. W.	D		4	4	Plumber	58	"	"		1215 E. Gore	U. W. Rish	"		
4	30-30	Rush Elizabeth K.	D				Home	43	W	"		1500 De Laney	Elizabeth K. Rush	"		
4	30-30	Richards J. B.	D		Pd		Auto Top.	51	W	"		1012 Harwell	J. B. Richards	"		
4	30-30	Raehn Annie E.	D				Home	33	W	"		1200 Delaney	Annie E. Raehn	"		
4	30-30	Richards V. L.	D		Pd		Salesman	25	W	"		1012 Harwell	V. L. Richards	"		
4	30-30	Richards Core A.	D		Pd		Home	49	W	"		1012 Harwell	Core A. Richards	"		
✓ 4	30-30	Richardson Mary J.	✓ D		Ex	Ex	Music Teacher	66	W	"		427 S. Summerlin	Mary J. Richardson	"		
4	30-30	Rush F. G.	D				Auto Busi.	48	W	"		1500 Delaney	F. G. Rush	"		

OFFICIAL REGISTER OF ELECTORS FOR

PRECINCT,

COUNTY, FLORIDA

NUMBER	DATE	SURNAME AND GIVEN NAME	PARTY AFFILIATION	VOTED	POLL TAX		OCCUPATION	AGE	COLOR	NATIVITY	DECLARATION OR NATURALIZATION	RESIDENCE	OATH		SIGNATURE OF SUPERVISOR OR DEPUTY	REMARKS
					1928	1929							I, having been first duly sworn, say, upon Oath that the statements here entered opposite my name as to qualifications as an elector, are true	SIGNATURE OF ELECTOR		
9	3-3	Starling Alvin A. R.	R.				Salesman	23	W.						A. A. Starling	Valid not in 11th district
15	3-12-30	Stolzembach J. W. R.	R.				Retired	74	W.	American		704 So. Summerlin	J. W. Stolzembach	Mina Jean Moon		owns property
32	3-27	Stewart R. I. R.	R.				Collector	37	W.	American		709 S. Mill	R. I. Stewart			owns property
33	3-27	Stone J. C. R.	R.				Police Officer	24	W.	American		605 Loxial	J. C. Stone			property owner
82	4-3	Sween Mrs. Nora R.	R.				Home	68	W.	American		1422 E. Gore	Mrs. Nora Sween			
83	4-3	Sween W. C. R.	R.				Retired	69	W.	American		1422 E. Gore	W. C. Sween			owns property
101	4-5	Sturges Helen E. R.	R.				Home	50	W.	American		1012 Anderson	Helen E. Sturges			owns property
105	4-5	Schwalt Max R.	R.				Cement work	64	W.	Germany	Caniden, New Jersey 1884	1325 Coplien St.	Max Schwalt			owns property
115	4-7	Smith Elizabeth N. R.	R.				Home	49	W.	American		1515 Conway Road	Elizabeth N. Smith			owns property
916	4-7	Smith Howard S. R.	R.				Musician	26	W.	American		1515 Conway Road	Howard S. Smith			owns property
925	4-7	Slaughter Brantley R.	R.				Salesman	29	W.	American		1016 Delaney Park Dr.	Brantley P. Slaughter			owns property
136	4-7	Sturges, W. H. R.	R.				School work	26	W.	American		1012 Anderson St.	W. H. Sturges			owns property
140	4-7	Schnur Florence Charles R.	R.				Mechanic	35	W.	American		1313 Catherine St.	Florence Charles Schnur			owns property
143	4-7	Slaughter Nina D. R.	R.				Bookkeeper	30	W.	American		1016 Delaney Park Dr.	Nina D. Slaughter			
29	4-8	Somerville Henrietta R.	R.				Home	55	"	"		1302 E. Central	H. N. Somerville	J. H. Tucker		
28	4-8	Somerville J. M. R.	R.				Retired	64	"	"		" " "	J. M. Somerville			
6	4-16-30	Smith, W. H. R.	R.				Painter	50	"	"		1515 Conway				
6	4-17-30	Swaidsmark A. P. R.	R.				Motion Club	43	"	"		139 E. Meriel	A. P. Swaidsmark			
4-17-30	Sargent B. Felton W.	W.					Stenographer	37	"	"		615 Cherokee Drive	B. Felton Sargent			
4-21-30	Shiver, E. J. R.	R.					Real Estate	46	"	"		1007 Golden Oak Ct.	E. J. Shiver			
4-22-30	Sligh, S. J. R.	R.					Trist	67	"	"		239 Copeland	S. J. Sligh			
4-23-30	Smith, J. P. R.	R.					Police	46	W.	"		1307 E. Gore	J. P. Smith			
4-24-30	Sligh, Helen P. R.	R.					Home	45	"	"		239 Copeland Dr.	Helen P. Sligh			
4-24-30	Schmidle, May E. R.	R.					Steno	26	"	"		1016 Delaney St.	May E. Schmidle			
4-25-30	Slaughter, A. C. R.	R.					Trafficman	44	W.	American		213 Phelps St.	A. C. Slaughter			
4-26-30	Stevens, Harold R.	R.					V. S. D. A.	50	W.	"		206 Phillips	Harold E. Stevens			
4-26-30	Stewart, Albie A. R.	R.					Home	58	"	"		320 Jasmine	Albie A. Stewart			
4-28-30	Stemons, Phil J. R.	R.					Merchant	52	W.	American		339 Cherokee Dr.	Phil J. Stemons			
4-26-30	Stacey, W. A. R.	R.					Trist	65	"	"		E. Gore Ave	W. A. Stacey	Signed in # 17.		
4-28-30	Stenbans, Mina J. R.	R.					Home	53	W.	American		230 E. Copeland	Mina J. Stenbans			
4-28-30	Stenbans, J. C. R.	R.					Salesman	56	W.	American		230 E. Copeland	J. C. Stenbans			
4-28-30	Smith, Mrs. Howard A. D.	D.					Housewife	24	W.	American		1515 Conway Rd.	Mrs. Howard A. Smith			
4-28-30	Scarborough, Ernest W. D.	D.					Shoemaker	30	W.	American		435 E. Miller	Ernest W. Scarborough			
4-29-30	Smith, Frank A. D.	D.					Judge	40	W.	American		1226 Delaney	Frank A. Smith			

OFFICIAL REGISTER OF ELECTORS FOR

PRECINCT, COUNTY, FLORIDA

NUMBER	DATE	SURNAME AND GIVEN NAME	PARTY AFFILIATION	VOTED	POLL TAX		OCCUPATION	AGE	COLOR	NATIVITY	DECLARATION OR NATURALIZATION	RESIDENCE	OATH		SIGNATURE OF SUPERVISOR OR DEPUTY	REMARKS
					Year	Year							I, having been first duly sworn, say, upon Oath that the statements here entered opposite my name as to qualifications as an elector, are true			
														SIGNATURE OF ELECTOR		
0	4-30-30	Slemmons, J. M.	✓ D.		Pd	Pd	Merchant.	46	W			1125 Palmer.	J. M. Slemmons	J. H. Tucker		
	9-20-30	Sanderson, C.	✓ D.		Ex	Ex	Travelling.	60	W			7 Lucerne Ct.	C. Sanderson	"		
	4-30-30	Sydam, Mrs. Ada	R		Ex	Ex	Nurse	58	W	American		420 E. Noble	Ada Sydam	"	Witness	Ed. T. Jones
✓	4-30-30	Stowe, Mina B.	R		Ex	Ex	Home	70	W	American		1802 Holmbeck	Mina B. Stowe	"	Witness	Frank B. Brown
	4-30-30	Scarborough, Stella W.	D				Teacher	30	W	American		435 E. Miller	Stella W. Scarborough	"	Witness	Bushy A. DeWitt
	4-30-30	Sharp, C. H.	D				Dentist	28	W	American		116 Annie St.	C. H. Sharp	"		John W. Mills
✓	4-30-30	Smith, Hallie L.	✓ D		Pd	Pd	Home	38	W	American		1226 Delaney	Hallie L. Smith	"		
0	4-30-30	Sasser, J. B.	✓ D		Pd	Pd	Retired	43	W	American		1214 E. Kaley	J. B. Sasser	"		
	4-30-30	Sasser, Kathleen H.	D				Home	27	W	American		1214 Kaley	Kathleen H. Sasser	"		
✓	4-30-30	Sackett, Mary E.	D		Pd	Pd	Cosmetician	49	W	American		274 E. Kaley	Mary E. Sackett	"		
0	4-30-30	Stowe, C. D.	D		Pd		Reporter-Star	33	W	American		946 Bradshaw Ter.	C. D. Stowe	946 Bradshaw Terrace		
0	4-30-30	Stowe, Carleton H. S.	D				Real Estate	33	W	American		815 S. Orange	Carleton H. Stowe	815 S. Orange Ave.		
	4-21-30	Stinehaus, Lambert R.	R		Pd	Pd	Insurance	26	"	"		230 Copeland St.	Lambert R. Stinehaus	See 17 for Signature		
	4-11-30	Steele, B. M.	R		Ex	Ex	Retired	69	"	"		1200 1 Euhl	B. M. Steele			
✓	4-16-30	Steele, M. A.	✓ D		Pd	Pd	Home	47	"	"		"	M. A. Steele			
0	4-25-30	Stacey, Jack R.	✓ D		Ex	Pd	Farm		"	"		1600 E. Gm.	Jack R. Stacey			
	8-20-30	T E Stapleton	D				Merchant	25					T. E. Stapleton			

NUMBER	DATE	SURNAME AND GIVEN NAME	PARTY AFFILIATION	VOTED	POLL TAX		OCCUPATION	AGE	COLOR	NATIVITY	DECLARATION OR NATURALIZATION	RESIDENCE	OATH		SIGNATURE OF SUPERVISOR OR DEPUTY	REMARKS
					Year	Year							I, having been first duly sworn, say, upon Oath that the statements here entered opposite my name as to qualifications as an elector, are true			
													SIGNATURE OF ELECTOR			
✓ 74	4-9-30	Thornburg, R.	Rep		Ex	Ex	Carpenter	62	W	American	1305	1305 Cathrine	R Thornburg			
✓ 4	11-30	Tresher, J. K.	Dem		Ex	Ex	Drummer	59	W	"		121 Wisteria	J. K. Tresher			
	4-17-30	Talley, Jerry B.	W		Ex	Ex	Home	59	W	"		819 E. Pine	Mr. Jerry B. Talley			
	4-30-30	Tresher, Jean H.	R		Pd	Pd	Home	53	W	American		121 Wisteria	Mrs. Jean H. Tresher			
✓ 0	4-30-30	Tubbs, R. A.	R		Pd	Pd	Auto Dealer	45	W	American		316 Fernwood	R. A. Tubbs			
0	4-30-30	Turner, R. J.	R		Pd	Pd	Dealer	42	W	American		720 Delaney	R. J. Turner			
✓	4-30-30	Tubbs, Elizabeth P.	R		Pd	Pd	Home	48	W	American		316 Fernwood	Elizabeth P. Tubbs			

NUMBER	DATE	SURNAME AND GIVEN NAME	PARTY AFFILIATION	VOTED	POLL TAX		OCCUPATION	AGE	COLOR	NATIVITY	DECLARATION OR NATURALIZATION	RESIDENCE	OATH I, having been first duly sworn, say, upon Oath that the statements here entered opposite my name as to qualifications as an elector, are true	SIGNATURE OF SUPERVISOR OR DEPUTY	REMARKS
					Year	Year							SIGNATURE OF ELECTOR		
✓ 10	4-22-30	Teasey, H. N.	✓ W		Pd	Pd	Relieve S	53	M	American		509 W. Lane Park Rd.	H. N. Teasey.	J. H. Tucker	
✓	4-24-30	Teasey, Miriam L.	✓ W		Pd	Pd	Home	51	"	"		" " " "	Miriam L. Teasey	"	
													Myrtle B. Monte	"	
✓ 10	4-30-30	Vining, L. C.	✓ D		Pd	Pd	Clerk	30	M	American		117 E. Grant	L. C. Vining	"	

OFFICIAL REGISTER OF ELECTORS FOR

PRECINCT, COUNTY, FLORIDA

NUMBER	DATE	SURNAME AND GIVEN NAME	PARTY AFFILIATION	VOTED	POLL TAX		OCCUPATION	AGE	COLOR	NATIVITY	DECLARATION OR NATURALIZATION	RESIDENCE	OATH		SIGNATURE OF SUPERVISOR OR DEPUTY	REMARKS
					Year 28	Year 29							I, having been first duly sworn, say, upon Oath that the statements here entered opposite my name as to qualifications as an elector, are true	SIGNATURE OF ELECTOR		
	1930															
8	3-10	White James W.	✓ R.		24	24	Farmer	78	W.	American		502 Rachel ave	James W. White		H. Jean Mara	owns property
24	3-20	Wilcox Carl W.	R.		Pd	Pd	U.S. N. R.	44	W.	American		733 So. Mills St.	Carl W. Wilcox		" " "	no property
29	3-22	Wolfe Annie	R.		24	24	Housekeeper	74	W.	American		525 So Summerlin	Annie Wolfe		" " "	owns property
30	3-23	Wolfe Albert	R.		24	24	Retired	80	W	American		525 So. Summerlin	Albert Wolfe		" " "	no. property
50	3-31	Wilmoth Julia H.	✓ R.		24	24	Home	56	W.	American		806 E. Central	Julia Harbmoth		" " "	owns property
51	3-31	Wilmoth James W.	✓ R.		24	24	Retired	83	W.	American		806 E. Central	James W. Wilmoth		" " "	owns property
90	4-4	Williams Blenus	✓ R.		Pd	Pd	Insurance	28	W	American		122 Lawton Blvd	Blenus Williams		" " "	no. property
99	4-5	Williams J. F.	R.				Railway Clerk	25	W.	American		122 Lawton Blvd	J. F. Williams		" " "	no. property
109	4-5	Woodruff Seth	✓ R.		24	24	Farmer	68	W.	American		604 Don. Cherokee	Seth Woodruff		" " "	owns property
132	4-7	Wilson Ida	R.		Pd		Home	51	W.	American		615 Cherokee Dr	Ida Wilson		" " "	owns property
138	4-7	Wilson J J.	✓ R.		24	24	Grower	69	W	American		615 Cherokee Dr	J. J. Wilson		" " "	owns property
76	4-9-30	Wells M. H.	✓ R.		Pd	Pd	Attorney	28	"	"		17 E. Miller	Wells		J. H. Thacker	
	4-14-30	Woodruff Richard S.	✓ W.		Pd	Pd	Lawyer	25	"	"		367 Lucerne Circle	Richard Woodruff		"	
	4-14-30	Wright Homer W.	✓ W.		Pd	Pd	"	42	"	"		1622 Kuhl	Homer W. Wright		"	
	4-23-30	White E. E.	✓ W.		Pd	Pd	Civil Engineer	46	"	"		1505 S. De Laney	E. E. White		"	
	4-28-30	Wells Lucian W.	✓ W.		Pd	Pd	Home	27	"	"		17 E. Miller	Lucian W. Wells		"	
	4-24-30	White William H.	✓ W.		Pd	Pd	Home	41	"	"		1505 S. De Laney	William H. White		"	
	4-25-30	Warren, Wilbur	✓ D.		24	24	Orange Grower	69	W	American		1 E. Gore	Wilbur Warren		"	
	4-26-30	Williams Geo. W.	W.		Pd	Ex	Janitor					1014 Palmer	Geo. W. Williams		"	
	4-26-30	Wright A. J.	W.		Pd	Pd	Merchant	44	W	"		224 Annie	Wright A. J.		"	
	4-28-30	Willits, Hewitt	D.		24	24	None	21	W	American		3 Lucerne Ct	Willits, H. W.		"	
	4-5-30	Willits Chas Q.	✓ W.		24	24	Grower	63	W			" " "	Signed in 12	transferred from 12		
	5-7-30	Willits Leta	Rep.		24	24	Home	65	"			" " "	" " "	" " "	" " "	
	4-28-30	Warren, Mrs. Tommie	D.		Pd	Pd	Home	54	W	American		17 E. Gore	Mrs. Tommie Warren		"	
	4-28-30	Wilson, Robert L.	D.		Pd		Solicitor	46	W	American		416 Nottingham	Robert L. Wilson		"	
	4-29-30	Way, W. De Laney	✓ D.		Pd	Pd	Clerk	33	W	American		601 E. Gore	W. De Laney Way		"	
	4-29-30	Way, Louise H.	D.		Pd	Pd	Home	28	W	American		601 E. Gore	Louise H. Way		"	
	4-30-30	Weeks, Donald L.	✓ D.		Pd	Pd	Insurance	33	W	American		424 Cherokee	Donald L. Weeks		"	
	4-30-30	Williams, Charles R.	D.		Pd	Pd	Merchant	38	W	American		1000 Mills St.	Charles R. Williams		"	
	4-30-30	Walters, Clifford	✓ D.		Pd	Pd	Salesman	28	W	American		1601 Kuhl	Clifford Walters		"	
	4-30-30	Warren, J. A.	D.		24		Caretaker	56	W	American		23 Greenwood	J. A. Warren		"	
	4-30-30	Warren, Rosa	D.				Home	47	W	American		C-23 Greenwood	Rosa Warren		"	

ORANGE

WALKER, EVANS & COGSWELL CO., CHARLESTON, S. C.

