

2-14-2022

## Excavation Paperwork of Unit G Levels 1-8 From Penny (8BR158)

Sara Winklepleck  
*University of Central Florida*

Megan McCauley  
*University of Central Florida*

Emily Tyler  
*University of Central Florida*

Find similar works at: <https://stars.library.ucf.edu/penny-excavation>  
University of Central Florida Libraries <http://library.ucf.edu>

This Excavation Paperwork is brought to you for free and open access by the Penny Site (8BR158) at STARS. It has been accepted for inclusion in Penny Site Excavation by an authorized administrator of STARS. For more information, please contact [STARS@ucf.edu](mailto:STARS@ucf.edu).

---

### Recommended Citation

Winklepleck, Sara; McCauley, Megan; and Tyler, Emily, "Excavation Paperwork of Unit G Levels 1-8 From Penny (8BR158)" (2022). *Penny Site Excavation*. 14.  
<https://stars.library.ucf.edu/penny-excavation/14>

# ARCHAEOLOGY LEVEL EXCAVATION FORM

Project Name: CCAMPV

Site Name and #: penny 8BR158

Unit Name: G Unit Size: 2m<sup>2</sup>

Level: 1(0-10) Level Thickness: 10cm

Excavators: SW, MM, ET, JO, AG, NDPHD

Date Begun: 2-14-2022

Recorded by: SW and AG, MM

Date Ended: 02/28/2022

## EXCAVATION METHODS:

Soil Screened? ☒ Yes ☐ No Screening Method: ☐ Water ☒ Dry Mesh Size: ☐ 1/16" ☐ 1/8" ☒ 1/4"

Excavation Methods: ☒ Shovel ☐ Trowel ☐ Other: dustpan, shears

## DEPTHS BELOW UNIT DATUM: cm bd

Initial Depth: SW 13cm SE 16cm NW 12cm NE 12cm Center 15cm

Final Depth: SW 16cm SE 15cm NW 18cm NE 19cm Center 19cm

Elevation of Unit Datum: 12cm

## SOIL SEDIMENT DESCRIPTION:

Munsell Number: 10 YR 3/1 Color Description: Very dark grey

Texture: gritty and dry Inclusions: twigs and roots, shells, possible charcoal residue

## Soil Changes from Previous Level:

Soil Color: ☐ Lighter ☐ Darker ☒ Unchanged ☐ Mottled ☐ More than one ☐ NA

Soil Texture: ☐ Sandier ☐ More Clay-like ☐ Wetter ☒ Unchanged ☐ NA

Description: The soil is very rooted and leaves charcoal residue on  
2-16-2022 hands.

## ARTIFACTS:

☐ Sterile ☒ Artifacts: FS Number: MSM 1 Total Number of Bags: 1 (02/28/22)

Artifacts Density: ☒ Increased from previous level ☐ Decreased from previous level ☐ Same ☐ NA

Artifacts in this Level: ☒ Evenly distributed ☐ Concentrated in one of more areas ☐ NA

Description: Evenly distributed fish bones, turtle shells, and pottery  
throughout the soil.

## Describe Artifact Content:

☒ Prehistoric Ceramics ☐ Lithics ☒ Shell ☐ Modified Shell ☒ Faunal Remains

☐ Modified Faunal Remains ☐ Human Remains ☐ Metal ☐ Glass ☒ Charcoal

☐ Historic Ceramics ☐ Masonry ☐ Bead ☐ Coin ☒ Other: dirt

Description: small bits of pottery, fish and turtle remains,

Charcoal collected as special sample.

Small pieces collected

PLAN VIEW:

Scale

Mapped Item and Elev. (cmbd)

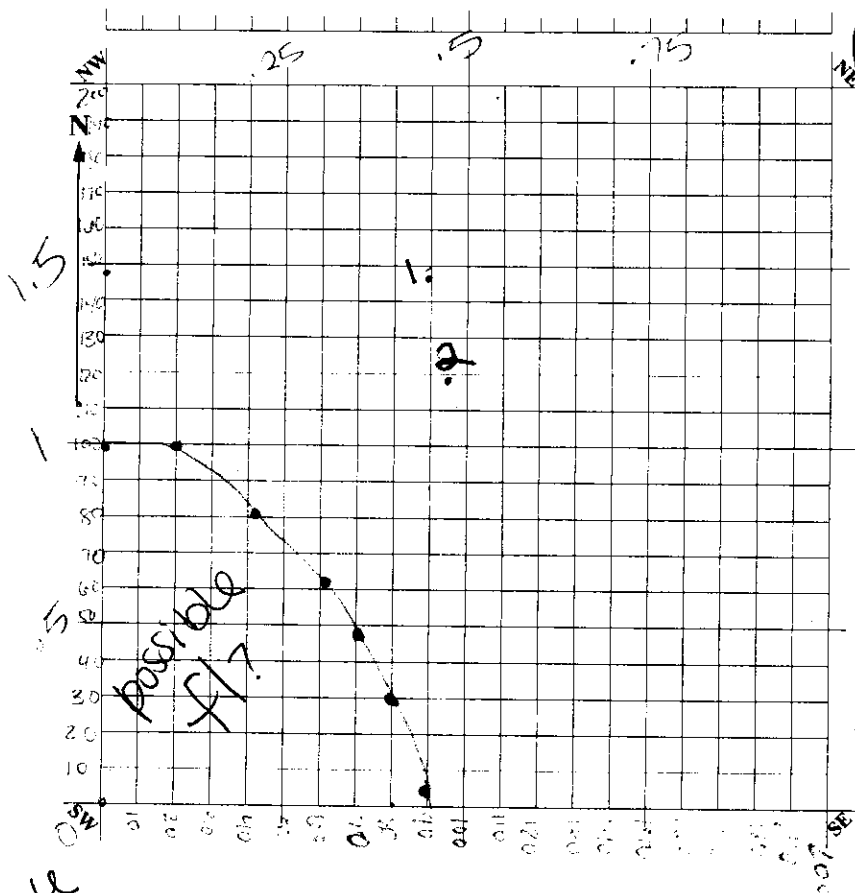

(14 cmbd) turtle shell fragment +  
2. pottery (St Johns) #  
fl feature unknown

4. \_\_\_\_\_
5. \_\_\_\_\_
6. \_\_\_\_\_
7. \_\_\_\_\_
8. \_\_\_\_\_
9. \_\_\_\_\_
10. \_\_\_\_\_

FEATURES (Record on Feature Form):

☒ Yes ☐ No Feature Number: 1 Depth Below Surface: 15cm Size: 130 cm

☐ Possible Post Mold ☐ Hearth ☐ Burial ☐ Trash Pit ☐ Well ☐ Cistern ☐ Foundation

☐ Artifact Concentration ☐ Living Floor ☐ Charcoal Concentration ☐ Other: unknown

Description: greyish sand and brown inclusions. charcoally.

- root mat

SPECIAL SAMPLES:

☒ Yes ☐ No Special Sample Number: \_\_\_\_\_

☒ C14 ☐ Floatation ☐ Pollen ☐ Sediment/Soil ☒ Other dirt

Description: small sample of charcoal, dirt sample

NOTES: 150cm West of Judgemental. Approx 130cm from STP 7

unit progress: SE=17cm, SW=45.5cm, NE=17.5cm, NW=same

Restarted on 2/16/2022 = NW=12cm, SW=17, SE=18, NE=15 center=12

Finding pitting and burnt bone. Found charcoal-making a grab bag.

Continued on Note Form: ☒ Yes ☐ No Number of Pages: 2

Crew Chief's Review & Approval: [Signature]

Principal Investigator's Approval: \_\_\_\_\_

possible radius: 90cm  
on the diagonal:

- taken down  
to level 3  
on 02/28/2022

TUG

# FIELD NOTES

Project Name: ~~CCAMP6~~ <sup>Sara</sup> Site Name and #: Penny 882158  
Excavators: SW, ET, JO, MM, AG Date(s): 2-16-2022

Notes: (Started from other form for TUG on 2-16-2022)

Finding turtle shell as well.

We mapped some pottery and turtle shell.

Found possible feature - significant color change

• We are measuring to see level depth

• Center 16 cmbd, SE 19 cmbd, NE 20 cmbd, NW 17 cmbd

• continuing to dig to reach 20 cm, end of level 2

• still finding little pieces of fish bone, turtle shell

• Jason clearing several roots on the east side of the test pit.

• Finding quite a bit of bone and pottery

• Reached 20 cmbd on all the corners except for SW (possible feature) and will continue later, completing sunset. JRL 2/16

- Had faulty reading - continuing level Two:

• Small bone fragments - burnt/non-schmriting continues,

• using trowel and dust pan to collect dirt around stubborn roots.

• A lot of root inclusions

• large vertebrae being found, a long with multiple fish carapaces.

• Found a drum fish tooth.

• more pottery found as depth increases, as well as faunal remains

• small shells throughout the dirt - not so much a deposit though <sup>seen</sup> right near the feature.

• found a tooth - large - top half cut off - root part of tooth still attached - racoon or opossum molar.

• finding more drum fish teeth and a fish butt bone.

• 18 ~~inches~~ cmbd in NW, NE, SW, and center. 17 cmbd in the SE corner at the end of the day

page 2

Notes (continued):

Cent. on 2/23/2022 - NW <sup>18cm bd</sup> ~~16cm bd~~, NE 17cm bd, SE 15cm bd (due to root inclusion)  
Center <sup>19cm bd</sup> ~~19cm bd~~, S <sup>1/4</sup> 16cm bd

SE corner has huge root inclusion which is why it is significantly less depth.

final depths due to root inclusions in corners

MEM

02/28/2022 - 1 bag

possible feature ended up being root mat.

SW corner - 12cm bd datum - 12cm

will be taken down to level 3

large piece of pottery found in screen

Small pieces of bone + pottery being found.

burnt bone - smaller fragment

drum fish tooth found

burnt shell shell collected

- many pieces of pottery found

burnt turtle shell fragments being found.

Small pieces of artifacts being collected

larger piece of turtle shell found

more pottery + bone being found

middle - 19cm bd, SW - 18 cm bd  
of taken down area

- feature leveled to level 3 -

Munsell - 10YR 2/2 very dark brown  
Wet, grainy

- end 02/28/2022 - MEM

all  
soil  
collected  
screened  
and  
artifact  
contents  
collected

# ARCHAEOLOGY LEVEL EXCAVATION FORM

Project Name: CCamp

Site Name and #: penny 8B2158

Unit Name: G Unit Size: 2m<sup>2</sup>

Level: 3 (20-30) Level Thickness: 10cm

Excavators: SN, MM, JO, AG, ET

Date Begun: 02/23/2022

Recorded by: MM, AG

Date Ended: 03/23/2022

## EXCAVATION METHODS:

Soil Screened? ☒ Yes ☐ No Screening Method: ☐ Water ☒ Dry Mesh Size: ☐ 1/16" ☐ 1/8" ☐ 1/4"

Excavation Methods: ☒ Shovel ☒ Trowel ☒ Other: dustpan, root cutters, saw

## DEPTHS BELOW UNIT DATUM:

Initial Depth: SW 10 SE 15 NW 18 NE 17 Center 19

Final Depth: SW 33 SE 31 NW 33 NE 30 Center 32

Elevation of Unit Datum: 12

## SOIL/SEDIMENT DESCRIPTION:

Munsell Number: 10YR 3/1 Color Description: very dark gray

Texture: Charcoal Inclusions: roots

## Soil Changes from Previous Level:

Soil Color: ☐ Lighter ☐ Darker ☒ Unchanged ☐ Mottled ☐ More than one ☐ NA

Soil Texture: ☐ Sandier ☐ More Clay-like ☐ Wetter ☒ Unchanged ☐ NA

Description: more charcoal patches

## ARTIFACTS:

☐ Sterile ☒ Artifacts: FS Number: \_\_\_\_\_ Total Number of Bags: 14

Artifacts Density: ☒ Increased from previous level ☐ Decreased from previous level ☐ Same ☐ NA

Artifacts in this Level: ☐ Evenly distributed ☒ Concentrated in one of more areas ☐ NA

Description: more special samples collected  
03/21/2022

## Describe Artifact Content:

☐ NA ☒ Prehistoric Ceramics ☐ Lithics ☒ Shell ☒ Modified Shell ☒ Faunal Remains ☐ Metal

☒ Modified Faunal Remains ☐ Human Remains ☐ Glass ☐ Charcoal ☐ Masonry ☐ Bead

☐ Historic Ceramics ☐ Coin ☐ Other: \_\_\_\_\_

Description: Pottery, large bird bone, Modified Shell

PLAN VIEW:

Scale

Mapped Item and Elev. (cmbd)

1. Large conch shell (22.5 cmbd)
2. modified sherd (27 cmbd)
3. rim sherd (25 cmbd)
4. Mod. deer bone (29 cmbd)
5. butchered deer bone (28 cmbd)
6. \_\_\_\_\_
7. \_\_\_\_\_
8. \_\_\_\_\_
9. \_\_\_\_\_
10. \_\_\_\_\_

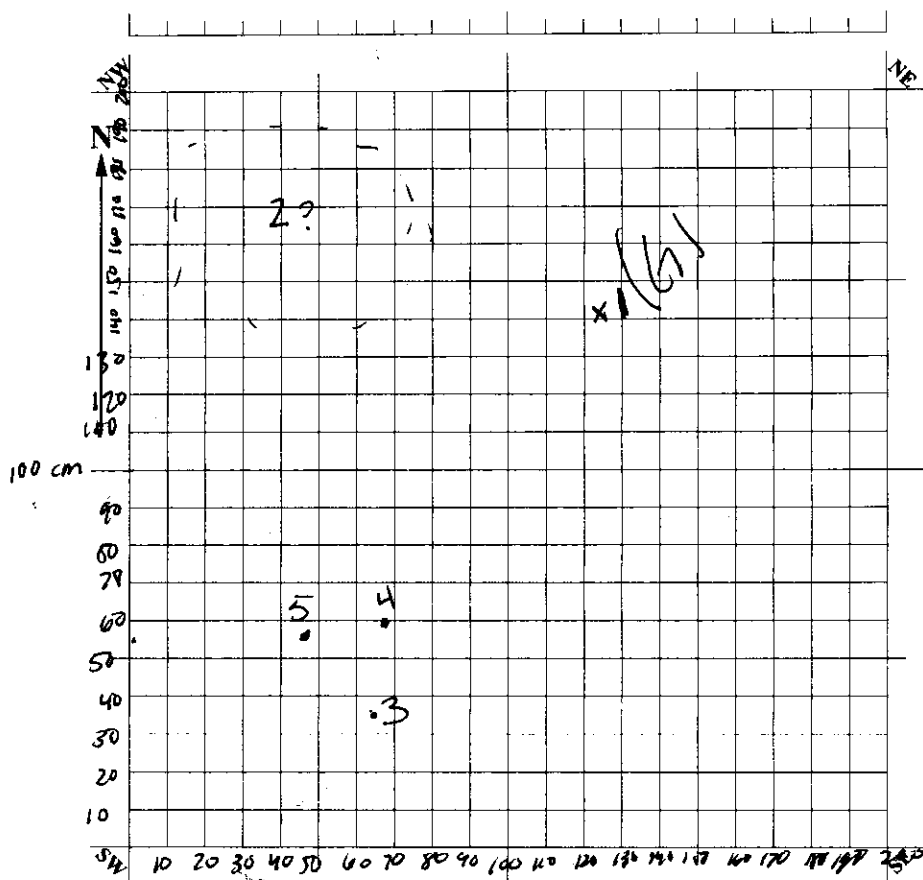

FEATURES (Record on Feature Form):

☒ Yes ☐ No Feature Number: 61 Depth Below Surface: 22.5 Size: N/A cm

☐ Possible Post Mold ☐ Hearth ☐ Burial ☐ Trash Pit ☐ Well ☐ Cistern ☐ Foundation

☐ Artifact Concentration ☐ Living Floor ☐ Charcoal Concentration ☒ Other: Welch Shell

Description: Welch Shell - Modified

SPECIAL SAMPLES:

☒ Yes ☐ No Special Sample Number: \_\_\_\_\_

☐ C14 ☐ Floatation ☐ Pollen ☒ Sediment/Soil ☒ Other: shell, pottery, bone

Description: feature collection

Initial depths not 20 cmbd due to root inclusions in corners.

NOTES: tiny piece of pottery, as well as larger pieces  
smaller pieces of faunal remains, as well as  
a large vertebrae found among bucket of  
soil. Large turtle shell fragments being found

Continued on Note Form: ☐ Yes ☐ No Number of Pages: 3

Crew Chief's Review & Approval: MJR

Principal Investigator's Approval: \_\_\_\_\_

TUG

# FIELD NOTES

Project Name: C Camp

Site Name and #: penny BBR 153

Excavators: SW, MM, JD, AG, ET  
level 3

Date(s): 02/23/2022,  
03/21/2022

Notes: NE corner: Conch shell found clustered w/ a piece of pottery + bone. Small bones being found around as well.

- NO change in soil color,
- Small donax shell around

PTN: 142 cm

~~pedestal~~ pedestal

PTE: 125 cm

- where color change begins. 22.5 cmbd

- Outer layer:

- large bones - turtle, bird, ~~pottery~~
- raccoon tooth
- large pottery shards - st. Johns

- pedestal the shell and surrounding pottery.

Continuing to level the surrounding area

collected sample of rim sherd piece and bone. (1 bag)  
~~found large shark tooth~~ <sup>SPW</sup> found shark tooth

• large root inclusions making it difficult to level

• ~~findings~~

• patches of what looks to be charcoal throughout

PTN: 35 cm  
PTE: 65 cm  
25 cmbd

modified deer bone (on surface)

PTN: 60 cm PTE: 69 cm 21 cmbd

found w/ other small bone



Notes (continued):

deer bone w/ butcher marks: PTN: 55cm PTE: 46cm 28cmbd  
weir

~~Coon~~ shell cluster cleaned, and  
collected - Feature 61

collected w/ artifacts in  
same context

- soil sample

22.5  
cmbd-3/cmbd

1 bag

1 bag

10 bags collected 03/21/2022

3-23-2022

ET

We decided to use 3 screens and recruited  
extra people to TUG. The NW corner of  
the unit began at 28.5cm. The SW at 27,  
the NE at 30 and the SE at 29cm.

A large rim sherd was found in the SW  
area, but was found in the shovel, so  
we didn't have a point provenience.

one bag collected

one bag collected for wall  
cleanup

wall cleanup done before continuing to  
level 4 (30-40)

• finding pieces of pottery under larger  
root in the SE corner.

\* also found in the screen.

4/6

# FIELD NOTES

Project Name: CAMP 6

Site Name and #: Pemby 4BR158

Excavators: SW, MM, JO, AG, ET

Date(s): 02/23/2022

Level 3 (20-30) 10 cm

Notes: Finding a lot of turtle shell, fish bones, and some pottery

- First few cm of Level 3, quite a bit of shells as well
- Some pieces of burnt shell.
- Some root inclusion, we are cutting through
- NW + NE depths measured @ 23 cmbd @ 2:30 pm
- Fossilized shark tooth, along with smaller shark tooth.

NW - 25 cmbd NE - 23 cmbd

Started w/ ~~these~~ <sup>NW + NE</sup> corners,

SW - 16 cmbd, SE - 15 cmbd

(02/23/2022)

1 bag collected on 02/23/2022

02/28/2022

datum - 12cm

NW - 24 cmbd, NE - 20 cmbd, SE - 18 cmbd, SW - 12 cmbd

SW still in level 1 due to possible feature

- being taken down to level 3.
- SW corner - 18 cmbd
- wall cleanup - 1 bag (AG, ET, MM)
- Cleanup for level 3

- few pieces of pottery, turtle shell, & bone found

Notes (continued):

Had to close up early for the day.  
NW corner at 23cm, SW corner at 21.5cm  
Center at 20 cm, SE at 20 cm  
NE at 21.5 cm

Cleanup done for 02/28/2022

MM

03/21/2022

Starting NW - 24 cm NE - 26, Center - 20, SE - 15 cm, (not)  
SW - 16 cm

Wall cleanup (03/21/2022) - 1 bag

- Small pieces of turtle shell + pottery.

Lowering of the level continues

• Piece of large conch shell, Southeast corner

PTN: 34 cm PTE: 183 cm 17 cm bd.

\* collected in separate bag. ①

• pottery + small bird bone being found

• A lot of root inclusions, but finding large pieces of pottery.

• ~~Small shell~~ small ~~shell~~ snail shell found in Southeast corner

PTN: 71 cm PTE: 168 cm 19 cm bd.

\* Collected in separate bag. ①

• turtle carapace, bird bone, pottery, and shell (some burnt) being found throughout the level.

• large vertebrae - unknown species.

Root inclusion  
in SE  
made depth  
higher than  
level 3

# ARCHAEOLOGY LEVEL EXCAVATION FORM

Project Name: Ccamp  
 Site Name and #: penny 8B215B  
 Unit Name: G Unit Size: 2m<sup>2</sup>  
 Level: 4 Level Thickness: 10cm  
 Excavators: ET, AG, JO, KH, CB Date Begun: 03/23/2022  
 Recorded by: MM Date Ended: 03/28/2022

## EXCAVATION METHODS:

Soil Screened? ☒ Yes ☐ No Screening Method: ☐ Water ☒ Dry Mesh Size: ☐ 1/16" ☐ 1/8" ☒ 1/4"  
 Excavation Methods: ☒ Shovel ☐ Trowel ☐ Other: \_\_\_\_\_

## DEPTHS BELOW UNIT DATUM:

Initial Depth: SW 33 SE 31 NW 33 NE 30 Center 32  
 Final Depth: SW 39 SE 39 NW 39 NE 39 Center 38  
 Elevation of Unit Datum: 12

## SOIL/SEDIMENT DESCRIPTION:

Munsell Number: 10YR 2/1 Color Description: black  
 Texture: ashy Inclusions: roots/shell

## Soil Changes from Previous Level:

Soil Color: ☐ Lighter ☒ Darker ☐ Unchanged ☐ Mottled ☐ More than one ☐ NA

Soil Texture: ☐ Sandier ☐ More Clay-like ☐ Wetter ☒ Unchanged ☐ NA

Description: Soil marbled gray + black

## ARTIFACTS:

☐ Sterile ☒ Artifacts: FS Number: \_\_\_\_\_ Total Number of Bags: 9

Artifacts Density: ☐ Increased from previous level ☐ Decreased from previous level ☒ Same ☐ NA

Artifacts in this Level: ☒ Evenly distributed ☐ Concentrated in one of more areas ☐ NA

Description: pottery, shell, faunal remains found throughout the level

## Describe Artifact Content:

☐ NA ☒ Prehistoric Ceramics ☐ Lithics ☒ Shell ☐ Modified Shell ☒ Faunal Remains ☐ Metal  
☐ Modified Faunal Remains ☐ Human Remains ☐ Glass ☐ Charcoal ☐ Masonry ☐ Bead  
☐ Historic Ceramics ☐ Coin ☐ Other: \_\_\_\_\_

Description: turtle carapace, bird bone, burnt shell (oyster/clam)  
large + small  
shards of pottery

PLAN VIEW:

Scale

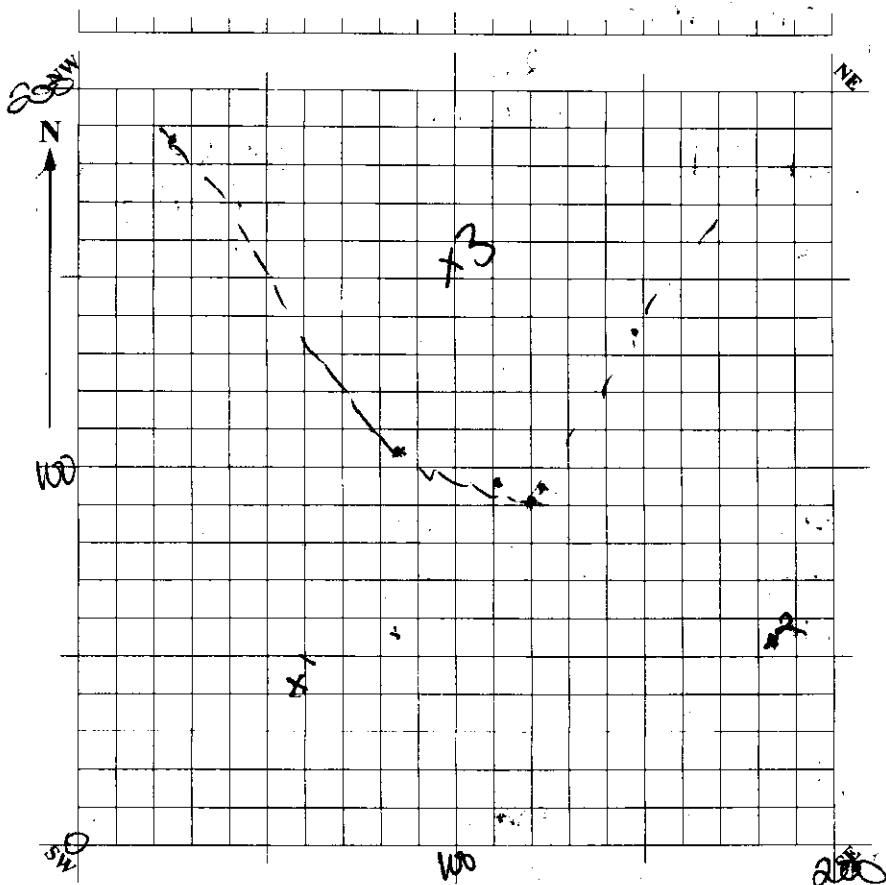

Mapped Item and Elev. (cmbd)

1. pottery sherd (38.5 cmbd)
2. pottery sherd (31 cmbd)
3. shell deposit (38.5 cmbd)
4. \_\_\_\_\_
5. \_\_\_\_\_
6. \_\_\_\_\_
7. \_\_\_\_\_
8. \_\_\_\_\_
9. \_\_\_\_\_
10. \_\_\_\_\_

FEATURES (Record on Feature Form):

- ☐ Yes ☒ No Feature Number: \_\_\_\_\_ Depth Below Surface: \_\_\_\_\_ Size: \_\_\_\_\_ cm
- ☐ Possible Post Mold ☐ Hearth ☐ Burial ☐ Trash Pit ☐ Well ☐ Cistern ☐ Foundation
- ☐ Artifact Concentration ☐ Living Floor ☐ Charcoal Concentration ☐ Other: \_\_\_\_\_

Description: \_\_\_\_\_

SPECIAL SAMPLES:

- ☒ Yes ☐ No Special Sample Number: \_\_\_\_\_

- ☒ C14 ☐ Floatation ☐ Pollen ☒ Sediment/Soil ☒ Other shell, pottery

Description: soil, shell (clam, oyster), pottery

NOTES: looking out for clam + oyster shell, modified along bone, faunal remains that may have been worked.

Continued on Note Form: ☒ Yes ☐ No Number of Pages: 2

Crew Chief's Review & Approval: \_\_\_\_\_

Principal Investigator's Approval: \_\_\_\_\_

TUG

FIELD NOTES

Project Name: CAMP 6

Site Name and #: Penny 8BR158

Excavators: ET, AG, JO, CB, KH, MM

Date(s): 3/23/2022

(4)

Notes: LVL 4

- found <sup>possible</sup> calcium deposit or coquina in Eastern side of unit
- lots of shell throughout surface of level
- Clam + oyster shell collected for special sample (isotope)
- several larger shells in SE corner

Soil: more compact, damp, ashy (stains hands) so no soil change

↳ roots everywhere

FINDING...

- small sherds
- bits of turtle bone

Progress Measurements: NW<sup>(cmbd)</sup>33 SW35 SE33 NE32 Center 35

33, 34, 36

- pottery on surface - ~~SW~~ SW corner

PTN: ~~111~~ 59 cm PTE: ~~111~~ 59 cm, 36.5 cmbd  
bagged for special sample

- pottery on surface - SE corner

PTN: ~~111~~ 53 cm PTE: ~~111~~ 184 cm top cmbd: 31

• Red staining pottery in SE corner to see depth.

• Possible shell deposit in SW corner, taking points.  
(149E, 136N), (122E, 96N), (120E, 94N), (87E, 105N),  
(22E, 189N), 

Depth: 38.5 cmbd. Clam, oyster, soil samples taken  
PTN: 145 cm PTE: 121 cm  
40 cmbd

Notes (continued):  
ending depths: 39 cmbd @ all corners  
38 cmbd @ center

ending depths: 39 cmbd @ all corners  
38 cmbd @ center

# ARCHAEOLOGY LEVEL EXCAVATION FORM

Project Name: Ccamp6

Site Name and #: penny 882158

Unit Name: G Unit Size: 2m<sup>2</sup>

Level: 5 (40-50) Level Thickness: 10cm

Excavators: SW, AG, JO, ET, KH Date Begun: 03/28/2022

Recorded by: MM Date Ended: 03/28/2022  
4/4/2022

## EXCAVATION METHODS:

Soil Screened? ☒ Yes ☐ No Screening Method: ☐ Water ☒ Dry Mesh Size: ☐ 1/16" ☐ 1/8" ☒ 1/4"

Excavation Methods: ☒ Shovel ☒ Trowel ☐ Other: \_\_\_\_\_

## DEPTHS BELOW UNIT DATUM:

Initial Depth: SW 40 SE 40 NW 38 NE 40 Center 40

Final Depth: SW 50 SE 51 NW 51 NE 49 Center 54

Elevation of Unit Datum: 12

## SOIL/SEDIMENT DESCRIPTION:

Munsell Number: 10YR 3/1 Color Description: very dark gray

Texture: sandy Inclusions: roots/shell

## Soil Changes from Previous Level:

Soil Color: ☒ Lighter ☐ Darker ☐ Unchanged ☐ Mottled ☐ More than one ☐ NA

Soil Texture: ☒ Sandier ☐ More Clay-like ☐ Wetter ☐ Unchanged ☐ NA

Description: Marbled w/ tan sand

## ARTIFACTS:

☐ Sterile ☒ Artifacts: FS Number: \_\_\_\_\_ Total Number of Bags: 9

Artifacts Density: ☐ Increased from previous level ☒ Decreased from previous level ☐ Same ☐ NA

Artifacts in this Level: ☒ Evenly distributed ☐ Concentrated in one of more areas ☐ NA

Description: less pottery, more shell

## Describe Artifact Content:

☐ NA ☒ Prehistoric Ceramics ☐ Lithics ☒ Shell ☐ Modified Shell ☒ Faunal Remains ☐ Metal

☒ Modified Faunal Remains ☐ Human Remains ☐ Glass ☐ Charcoal ☐ Masonry ☐ Bead

☐ Historic Ceramics ☐ Coin ☐ Other: \_\_\_\_\_

Description: Modified shell in tin foil, burnt  
burnt shell faunal remains



PLAN VIEW:

Scale

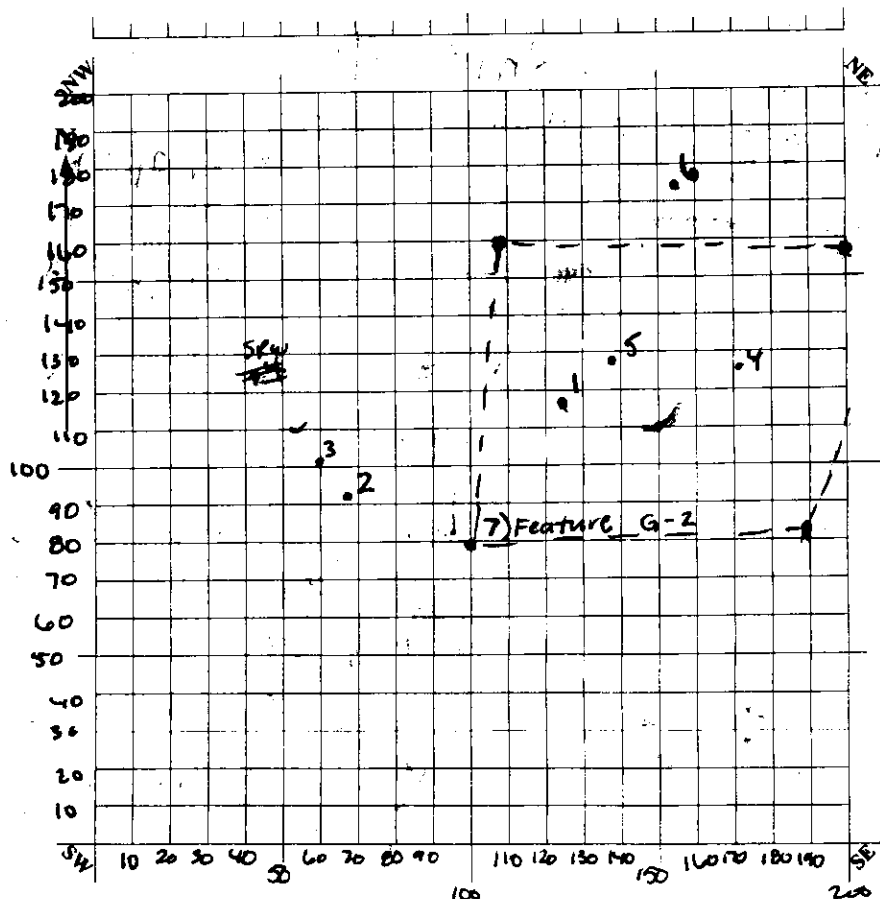

Mapped Item and Elev. (cmbd)

1. Clam shell cluster (40cmbd)
2. Intact oyster shell (41cmbd)
3. Possible Modified bone (41cmbd)
4. Small shell cluster (42cmbd)
5. big shell cluster (44cmbd)
6. pottery shard (49cmbd)
7. Feature G-2 pedestal (45-50cmbd)
8. \_\_\_\_\_
9. \_\_\_\_\_
10. \_\_\_\_\_

FEATURES (Record on Feature Form):

☒ Yes ☐ No Feature Number: G-2 Depth Below Surface: 45-50 Size: ~ 100 cm

☐ Possible Post Mold ☐ Hearth ☐ Burial ☐ Trash Pit ☐ Well ☐ Cistern ☐ Foundation

☐ Artifact Concentration ☐ Living Floor ☐ Charcoal Concentration ☒ Other: Shell

Description: lots of shells and some charcoal in the SW corner

SPECIAL SAMPLES:

☒ Yes ☐ No Special Sample Number: \_\_\_\_\_

☐ C14 ☐ Floatation ☐ Pollen ☐ Sediment/Soil ☒ Other: shell, pottery, bone

Description: Multiple bags collected of clam/oyster

NOTES: level 4 wall cleanup done before level 5  
began - shell, pottery, turtle shell  
1 bag collected

Continued on Note Form: ☒ Yes ☐ No Number of Pages: 2

Crew Chief's Review & Approval: MM

Principal Investigator's Approval: \_\_\_\_\_

# FIELD NOTES

Project Name: Clampo

Site Name and #: penny ORK 158

Excavators: MM, JD, AG, SW, ET, KH

Date(s): 03/28/2022

level 5

Notes: Clam shell cluster

40

1 bag

PTN: 126 cm PTE: 125 cm Cmbd

- collected for special sample

Clam + oyster shell sample collected

2 bags

• burnt turtle, shark tooth,  
burnt shell, modified bone

- intact oyster shell - PTN: 91 cm

PTE 67 cm

41 cmbd

- collected

- root growing through, broke as collected.

possible modified bone

PTN 101

PTE 60

Collected Special

41 cmbd

Point Provenience, small shell cluster

Depth - 42 cmbd North: 125 cm East: 173 cm

127 - Easting, large feature 139 - Northing, large

44 - depth of ~~the~~ large feature feature

↑ slight color change - not sure if new level or part of feature. (blotched)

Soil change really coming in @ 49 cmbd (on south side mostly)

Point provenience on pottery shard ~~to~~ NE wall - 8 cmbd, 154 = Easting, 174 = Northing

Significant color change throughout new - <sup>slow</sup> lighter brown color.

Notes (continued):

Possible charcoal deposits in SW and NE corners.

SE corner - ~~10yr~~ 10yr 5/3 - brown  
Sandy

NE corner - possible ~~6yr~~ charcoal  
7.5 yr 2.5/1  
black  
Charcoal

Pedestaled shell concentration  
45 cmbd - 50 cmbd. Named  
Feature G-2.

SE depth - 50 cmbd

PTN 83 / PTE 189

NW - 50 cmbd

PTN 158 / PTE 99

NE - "

PTN 157 / PTE 200

SW - "

PTN 79 / PTE 101

Wall clean up bag ~~the~~  
level ~~the~~ 5

- liner left off of bag - bag  
edited on 04/04/2022

Wall cleaning bag - liner 5  
on

04/04/2022

- bone, pottery (small)  
~~the~~

# ARCHAEOLOGY LEVEL EXCAVATION FORM

Project Name: CCAMP 6

Site Name and #: Penny 8BR158

Unit Name: G Unit Size: 2m<sup>2</sup>

Level: 6 Level Thickness: 10 cm (50-60 cm)

Excavators: ET, MM, JD, KH, SW, AG Date Begun: 3-28-2022

Recorded by: ET, MM, SW Date Ended: 4-4-2022

## EXCAVATION METHODS:

Soil Screened? ☒ Yes ☐ No Screening Method: ☐ Water ☒ Dry Mesh Size: ☐ 1/16" ☐ 1/8" ☒ 1/4"

Excavation Methods: ☒ Shovel ☒ Trowel ☐ Other: \_\_\_\_\_

## DEPTHS BELOW UNIT DATUM:

Initial Depth: SW 50 cm SE 50 cm NW 50 cm NE 50 cm Center 50 cm

Final Depth: SW 60 SE 60 NW 60 NE 59 Center 60

Elevation of Unit Datum: 12 60 59

## SOIL/SEDIMENT DESCRIPTION:

Munsell Number: 2.5Y 3/2 Color Description: very dark grayish brown

Texture: ashy sandy Inclusions: root shell

## Soil Changes from Previous Level:

Soil Color: ☐ Lighter ☐ Darker ☐ Unchanged ☐ Mottled ☐ More than one ☐ NA

Soil Texture: ☐ Sandier ☐ More Clay-like ☐ Wetter ☐ Unchanged ☐ NA

Description: motting in color, dark charcoal, sandy, and orangey soil

## ARTIFACTS:

☐ Sterile ☒ Artifacts: FS Number: \_\_\_\_\_ Total Number of Bags: 5

Artifacts Density: ☐ Increased from previous level ☒ Decreased from previous level ☐ Same ☐ NA

Artifacts in this Level: ☒ Evenly distributed ☐ Concentrated in one of more areas ☐ NA

Description: shell, pottery, bone

## Describe Artifact Content:

☐ NA ☒ Prehistoric Ceramics ☐ Lithics ☒ Shell ☐ Modified Shell ☒ Faunal Remains ☐ Metal

☐ Modified Faunal Remains ☐ Human Remains ☐ Glass ☐ Charcoal ☐ Masonry ☐ Bead

☐ Historic Ceramics ☐ Coin ☐ Other: \_\_\_\_\_

Description: Smaller concentration of artifacts

PLAN VIEW:

Scale

Mapped Item and Elev. (cmbd)

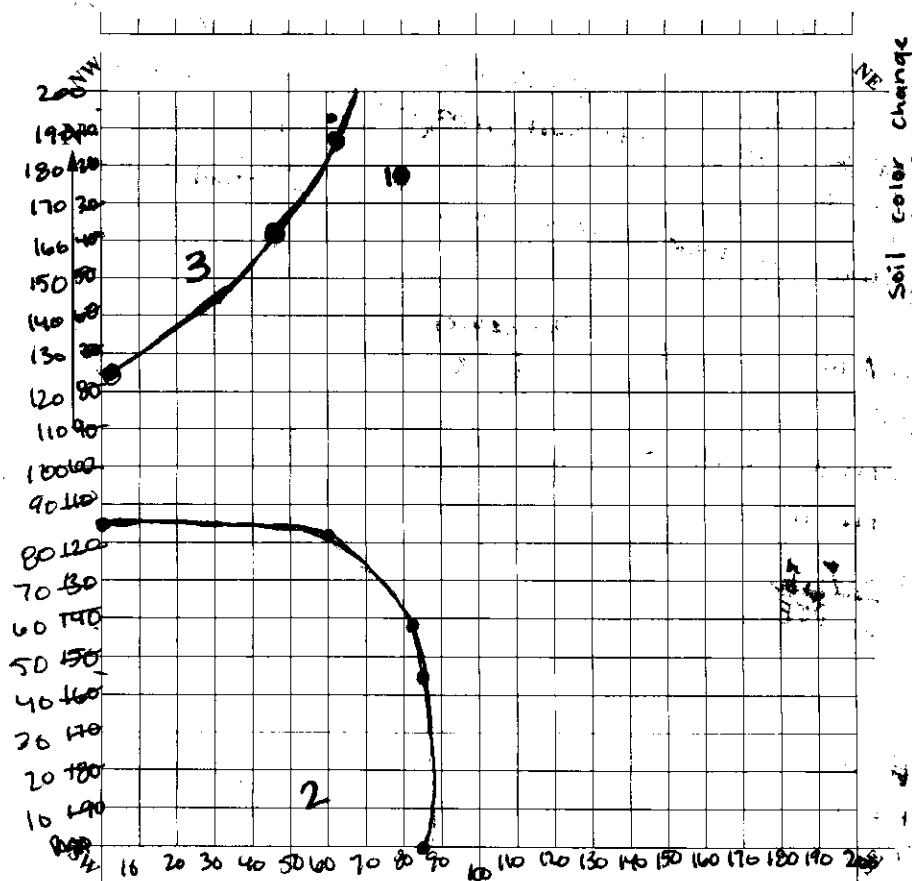

1. Piece of Pottery
2. 2.5Y 3/2 / 61 cmbd
3. 10YR 3/1 / 59 cmbd
- 4.
- 5.
- 6.
- 7.
- 8.
- 9.
- 10.

FEATURES (Record on Feature Form):

☒ Yes ☐ No Feature Number: G-2 Depth Below Surface: 45-50 Size: ~100 cm

☐ Possible Post Mold ☐ Hearth ☐ Burial ☐ Trash Pit ☐ Well ☐ Cistern ☐ Foundation

☐ Artifact Concentration ☐ Living Floor ☐ Charcoal Concentration ☒ Other: Shell

Description: Shell concentration

SPECIAL SAMPLES:

☒ Yes ☐ No Special Sample Number: 2

☐ C14 ☐ Floatation ☐ Pollen ☐ Sediment/Soil ☒ Other: Shell, pottery

Description: Clam shell, pottery

NOTES: SE corner soil change to light tan from charcoal; other corners continue to stay the same color.

Collection of artifacts continues in this area

Continued on Note Form: ☒ Yes ☐ No Number of Pages: 2

Crew Chief's Review & Approval: MSW

Principal Investigator's Approval: \_\_\_\_\_

# FIELD NOTES

Project Name: CCAMPL

Site Name and #: Penny 08R158

Excavators: ET, MM, AG, JD, SW, CR, MH

Date(s): 4/4/2022

## Notes:

- dark charcoal soil w/ charred shell and bone in NW corner, ~~shell~~ surrounded by lighter soft soil, similar in SW corner - but less shell (so far).
- taking everything down to base of level to see where dark soil goes.
- Piece of pottery in NW corner, Point Provenience: PTN: 179 PTE: 80 53 CMBD?
- Right at located the dark soil in the SW corner turned into the lighter sandy soil.
- ~~see~~ (MAYBE) ~~feature~~ ~~reduction~~ in NW corner because a defined dark lined. Points: PTN 200 PTE 125, other corners: 122N, 148SW 52E CMbd: 59

## TO BE MAPPED:

- (SW) discoloration: PTN: 85 PTE 0, PTN 83 PTE 60, PTN 53 PTE 82, PTN 43 PTE 86 PTN 0 PTE 84.
- Munsell: 2.5Y 3/2 very dark grayish brown; ashy + sandy
- (SE) discoloration: PTN 0 PTE 64, PTN 26 PTE 175, PTN 36 PTE 200 Munsell: 10YR 2/1 Black
- (NW) Munsell: 10YR 3/1 very dark gray sandy/gritty PTN 194 PTE 62, PTN 14 PTE 2, PTN 161 PTE 47
- (NE) Munsell: 10YR 2/1 Black PTN: 196 PTE 149, PTN 153 PTE 199 (small semi circle)
- Now doing wall clean-up with a shovel.

(1) corner  
SW

59 cm bd  
NW

57 cm bd  
NE

60 cm bd  
SE

# ARCHAEOLOGY LEVEL EXCAVATION FORM

Project Name: C CAMP G

Site Name and #: Penny 8BR158

Unit Name: G Unit Size: 2m<sup>2</sup>

Level: 7 Level Thickness: 10cm

Excavators: JD, SW, MM, AG Date Begun: 4-4-2022

Recorded by: ET, mm Date Ended: 4-4-2022

## EXCAVATION METHODS:

Soil Screened? ☒ Yes ☐ No Screening Method: ☐ Water ☒ Dry Mesh Size: ☐ 1/16" ☐ 1/8" ☒ 1/4"

Excavation Methods: ☒ Shovel ☐ Trowel ☐ Other: \_\_\_\_\_

## DEPTHS BELOW UNIT DATUM:

Initial Depth: SW 61 SE 60 NW 59 NE 59 Center 60

Final Depth: SW 70 SE 70 NW 70 NE 70 Center 70

Elevation of Unit Datum: 12

## SOIL/SEDIMENT DESCRIPTION:

Munsell Number: 10YR 5/6 Color Description: yellowish brown

Texture: grainy Inclusions: roots, shell

## Soil Changes from Previous Level:

Soil Color: ☒ Lighter ☐ Darker ☐ Unchanged ☐ NA

Soil Texture: ☒ Sandier ☐ More Clay-like ☐ Wetter ☐ Unchanged ☐ NA

Description: ~~Orange~~ Orange, ~~sp~~

## ARTIFACTS:

☐ Sterile ☒ Artifacts: FS Number: \_\_\_\_\_ Total Number of Bags: 3

Artifacts Density: ☐ Increased from previous level ☒ Decreased from previous level ☐ Same ☐ NA

Artifacts in this Level: ☒ Evenly distributed ☐ Concentrated in one of more areas ☐ NA

Description: ~~less~~ significantly less collected

## Describe Artifact Content:

☒ Prehistoric Ceramics ☐ Lithics ☒ Shell ☐ Modified Shell ☒ Faunal Remains

☐ Modified Faunal Remains ☐ Human Remains ☐ Metal ☐ Glass ☐ Charcoal

☐ Historic Ceramics ☐ Masonry ☐ Bead ☐ Coin ☐ Other: \_\_\_\_\_

Description: clam, pottery, small bone

**PLAN VIEW:**

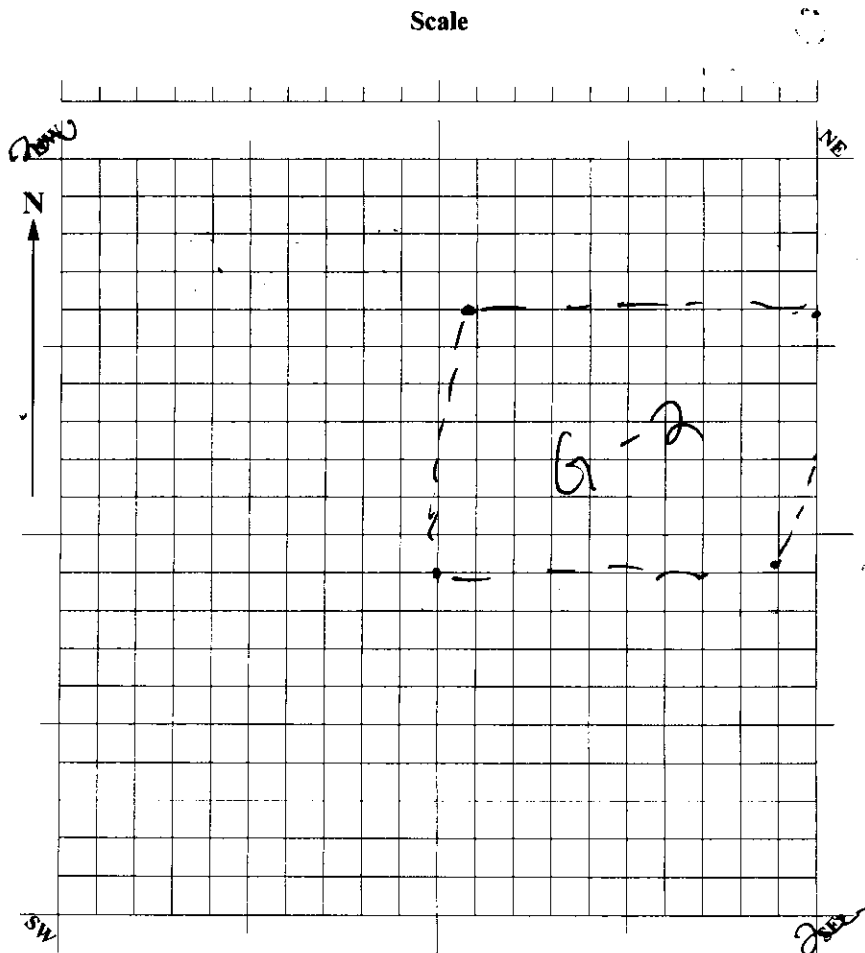

**Mapped Item and Elev. (cmbd)**

1. G-2 (45-50 cmbd)
2. \_\_\_\_\_
3. \_\_\_\_\_
4. \_\_\_\_\_
5. \_\_\_\_\_
6. \_\_\_\_\_
7. \_\_\_\_\_
8. \_\_\_\_\_
9. \_\_\_\_\_
10. \_\_\_\_\_

**FEATURES (Record on Feature Form):**

- ☒ Yes ☐ No **Feature Number:** G-2 **Depth Below Surface:** 45-50 **Size:** ~100 cm
- ☐ Possible Post Mold ☐ Hearth ☐ Burial ☐ Trash Pit ☐ Well ☐ Cistern ☐ Foundation
- ☐ Artifact Concentration ☐ Living Floor ☐ Charcoal Concentration ☒ Other: shell
- Description:** shell concentration

**SPECIAL SAMPLES:**

- ☐ Yes ☒ No **Special Sample Number:** \_\_\_\_\_
- ☐ C14 ☐ Floatation ☐ Pollen ☐ Sediment/Soil ☐ Other \_\_\_\_\_

**Description:** \_\_\_\_\_

**NOTES:** on extra field note page

**Continued on Note Form:** ☒ Yes ☐ No **Number of Pages:** 2

**Crew Chief's Review & Approval:** mgk

**Principal Investigator's Approval:** \_\_\_\_\_



# FIELD NOTES

JUG2

Project Name: CCamp 6 Site Name and #: Penny 8BR 158

Excavators: JO, SW, ET, AG, MM Date(s): 4-4-2022

## Notes:

We started Level 7 with 2 people shovelling. This Level has a lot more sandy soil and is a huge color change from previous levels. Rather than ashy, black soil, this Level 7 consists mostly of sandy tan soil.

At the beginning of the Level, mostly bone and shell were found.

NW and SW at 66 cm.

NE at 62 cm SE corner at 64 cm

Many small vertebrae found.

Level color @ 70 cm: 10YR 5/6  
yellowish brown

Wall cleanup on 04/06/2022  
- pottery, faunal remains

# ARCHAEOLOGY LEVEL EXCAVATION FORM

Project Name: C sample

Site Name and #: penny BBR 158

Unit Name: G Unit Size: 2m<sup>2</sup>

Level: 8 Level Thickness: 10cm

Excavators: AG, JO, MT, EH, ET Date Begun: 04/06/2022

Recorded by: mm SW Date Ended: 4/11/2022

## EXCAVATION METHODS:

Soil Screened? ☒ Yes ☐ No Screening Method: ☐ Water ☒ Dry Mesh Size: ☐ 1/16" ☐ 1/8" ☒ 1/4"

Excavation Methods: ☒ Shovel ☒ Trowel ☐ Other: \_\_\_\_\_

## DEPTHS BELOW UNIT DATUM:

Initial Depth: SW 70 SE 69 NW 70 NE 69 Center 73

Final Depth: SW 80 SE 80 NW 80 NE 80 Center 81

Elevation of Unit Datum: 12

## SOIL/SEDIMENT DESCRIPTION:

Munsell Number: 10Yr 5/4 Color Description: yellowish brown

Texture: fine + dry Inclusions: ROOTS

## Soil Changes from Previous Level:

Soil Color: ☒ Lighter ☐ Darker ☐ Unchanged ☐ Mottled ☐ More than one ☐ NA

Soil Texture: ☒ Sandier ☐ More Clay-like ☐ Wetter ☐ Unchanged ☐ NA

Description: yellow sand, no shell

## ARTIFACTS:

☐ Sterile ☒ Artifacts: FS Number: \_\_\_\_\_ Total Number of Bags: 2

Artifacts Density: ☐ Increased from previous level ☒ Decreased from previous level ☐ Same ☐ NA

Artifacts in this Level: ☒ Evenly distributed ☐ Concentrated in one of more areas ☐ NA

Description: Significantly less collected

## Describe Artifact Content:

☐ NA ☒ Prehistoric Ceramics ☐ Lithics ☒ Shell ☐ Modified Shell ☒ Faunal Remains ☐ Metal

☐ Modified Faunal Remains ☐ Human Remains ☐ Glass ☐ Charcoal ☐ Masonry ☐ Bead

☐ Historic Ceramics ☐ Coin ☐ Other: \_\_\_\_\_

Description: Small faunal remains, small piece of pottery  
Shell collected as well.

PLAN VIEW:

Scale

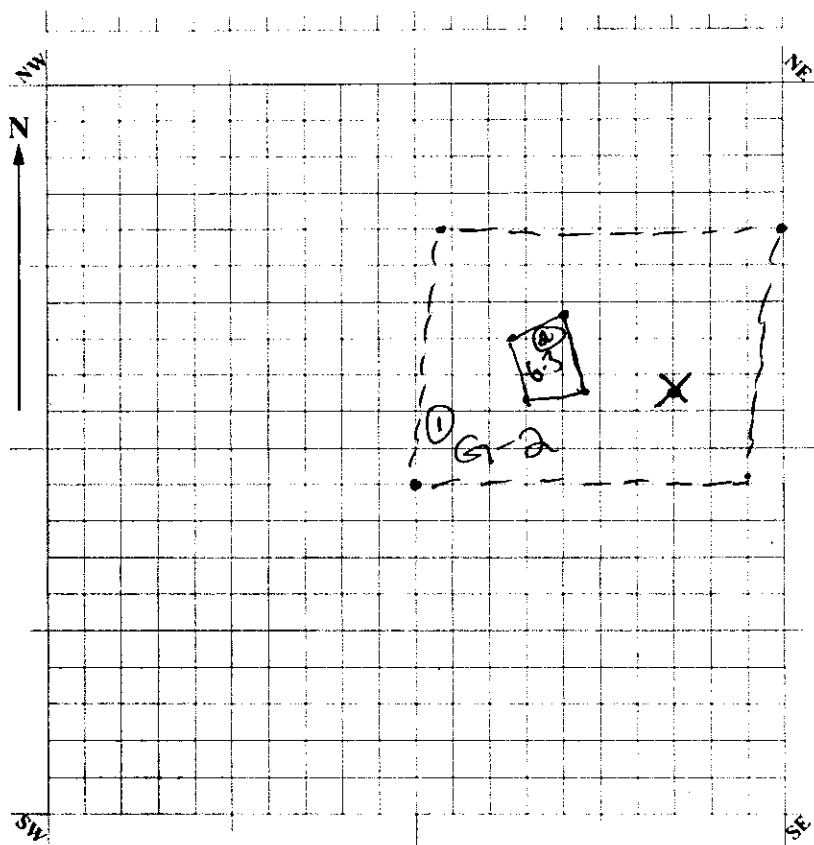

Mapped Item and Elev. (cmbd)

1. G-2 (45-50 cmbd)
2. G-3 (44 cmbd)
3. X = G-2A
4. \_\_\_\_\_
5. \_\_\_\_\_
6. \_\_\_\_\_
7. \_\_\_\_\_
8. \_\_\_\_\_
9. \_\_\_\_\_
10. \_\_\_\_\_

FEATURES (Record on Feature Form):

☒ Yes ☐ No Feature Number: G-2 Depth Below Surface: 45-50 cmbd Size: 100 cm

☐ Possible Post Mold ☐ Hearth ☐ Burial ☐ Trash Pit ☐ Well ☐ Cistern ☐ Foundation

☐ Artifact Concentration ☐ Living Floor ☐ Charcoal Concentration ☒ Other: Sherd

Description: hearth found after further inspection

SPECIAL SAMPLES:

☒ Yes ☒ No Special Sample Number: \_\_\_\_\_

☐ C14 ☐ Floatation ☐ Pollen ☐ Sediment/Soil ☒ Other: Sherd Sample

Description: ~~pottery~~ pottery found in S. wall

NOTES: Smaller artifact sample collected,  
Notes cont. on 4/11 by SW. We need to completely remap both  
features for the unit. We are still on level B, but almost  
complete, about to remeasure feature points and depth.

Continued on Note Form: ☐ Yes ☒ No Number of Pages: 3

Crew Chief's Review & Approval: [Signature]

Principal Investigator's Approval: \_\_\_\_\_

37 cmbd  
PTN 163  
PTC 0

TUG

FIELD NOTES

Project Name: Clamp Site Name and #: Penny BBK 158

Excavators: MM, JA, AG, SW, ET Date(s): 01/06/2022

(8)

04/20/2022

Notes:

04/20/2022

(1 bag)

• wall cleanup, artifacts collected when soil screened

— turtle shell, shell, faunal remain, pottery

→ Wall stratigraphy photographed + and mapped

\* features noted on field note form

~~West~~ West Wall mapped for normal stratigraphy - line level 3 cm below datum

\* North, South, East walls mapped for feature stratigraphy.

North - 4 cm below datum measured  
South - ~~at datum~~ at datum

East - 3 cm below datum

West - 3 cm below datum

Measured

Notes (continued):

West wall: pottery in wall:

• we took a piece of pottery out  
of the west wall; PTN: 163

PTZ: 0; 37 cm<sup>2</sup>

• Shell came out in association with  
pottery.

Southern point

160 cm,

34 cm

Northern point

165 cm,

34 cm