

3-2-2022

Feature Paperwork of Features C1-C4 From Penny (8BR158)

Shayleen Cruz
University of Central Florida

Mel/Melanna Jordan
University of Central Florida

Emma Delis
University of Central Florida

Find similar works at: <https://stars.library.ucf.edu/penny-excavation>
University of Central Florida Libraries <http://library.ucf.edu>

This Feature Paperwork is brought to you for free and open access by the Penny Site (8BR158) at STARS. It has been accepted for inclusion in Penny Site Excavation by an authorized administrator of STARS. For more information, please contact STARS@ucf.edu.

Recommended Citation

Cruz, Shayleen; Jordan, Mel/Melanna; and Delis, Emma, "Feature Paperwork of Features C1-C4 From Penny (8BR158)" (2022). *Penny Site Excavation*. 24.
<https://stars.library.ucf.edu/penny-excavation/24>

FEATURE FORM

Project Name: CCAMP 6
 Site Name and #: Penny 8BR158
 Feature Number: C1 Unit Name: TUC Level: 5
 Excavators: SCC, MJ, ED, KH, RCV, KT Date Begun: 3/2/22
 Recorded by: Shayleen Chabrier-cm2 Date Ended: 3-23-2022

EXCAVATION METHODS:

Soil Screened? ☒ Yes ☐ No Screening Method: ☐ Water ☒ Dry Mesh Size: ☐ 1/16" ☐ 1/8" ☒ 1/4"

Excavation Methods: ☐ Shovel ☒ Trowel ☐ Other: _____

Bisected? ☒ Yes ☐ No Which half? WEST

How was Feature Identified? soil darkening

TYPE OF FEATURE:

☐ Activity Area ☐ Artifact Concentration ☐ Burial ☐ Charcoal/Ash Concentration ☐ Storage Pit
☐ Hearth/Fire Pit ☐ Living Floor ☐ Possible Post Mold ☐ Cistern ☐ Foundation ☐ Privy Pit
☐ Trash Pit ☐ Trench ☐ Well ☐ Midden ☐ Pot/Basket Dump ☒ Other (Describe): soil staining (darkening)

FEATURE DESCRIPTION:

Dimensions: Shape: Square-ish
 Max. Length: 23 cm Direction: N Max. Width: 21 cm Direction: E
 Diameter: 27 cm

Soils: Feature Soil Color (Munsell): 10yr 3/1 "Very Dark Gray"

Feature Soil Description: Texture: Sandy Inclusions: Roots

Matrix Soil Color (Munsell): 10yr 4/1 "Dark Gray"

Matrix Soil Description: Texture: Sandy Inclusions: Roots

Feature Fill: ☐ Soil only ☐ Soil and shell ☐ Ceramics ☐ Shell (60% or more shell) ☐ Charcoal
☐ Ash ☐ Daub/Clay Nodules ☐ Clay ☐ Lithics ☐ Faunal ☐ Human Remains ☐ Historic trash/debris
☐ Fire Cracked Rock ☐ Mixed ☐ Other: _____

Describe: _____

FEATURE LOCATION:Top Elevation: 49 cmbdCenter: PTN: 44 PTE: 68 North: PTN: 50 PTE: 66 South: PTN: 34 PTE: 68
East: PTN: 41 PTE: 78 West: PTN: 38 PTE: 56

Bottom Elevation: _____ cmbd

Center: PTN: 41 PTE: 67 North: PTN: 51 PTE: 70 South: PTN: 31 PTE: 70
East: PTN: 42 PTE: 84 West: PTN: 40 PTE: 54**ARTIFACT CONTENT AND DENSITY:**

- ☐ Sterile ☐ Artifacts: FS Number(s): _____ Number of Bags: _____
- ☐ Bead ☐ Bottle/Container Glass ☐ Ceramics ☐ Charcoal ☐ Daub ☐ Faunal Remains, Modified
- ☐ Faunal Remains, Unmodified ☐ Fire Cracked Rock ☐ Fired Clay Object ☐ Human Remains ☐ Metal
- ☐ Lithics, Debitage ☐ Lithics, Tool ☐ Masonry (Brick, Mortar, Tabby, etc) ☐ Shell ☐ Shell, Modified
- ☐ Other: _____

SPECIAL SAMPLES:Special Sample Collected? ☒ Yes ☐ No Special Sample Number(s): _____ Number of Bags: _____Type of Sample: ☐ c14/Dating Sample ☒ Flotation ☐ Pollen ☐ Soil ☐ Other: _____Material Collected: ☐ Charcoal ☐ Faunal ☐ Shell ☒ Soil ☐ Wood ☐ Other: _____**ASSOCIATED FEATURES:**

☒ Yes ☐ No Number of Features: 3 Feature Numbers: C2, C3, C4 Type: soil stains

Location in relationship to this feature: C2 = North; C3 = ~~North~~ Northeast; C4 = slightly North West

Describe: all amorphous shaped stains w/ Munsell color: very dark grey; root filled features

NOTES:

FEATURE # C1 PLANVIEW MAP

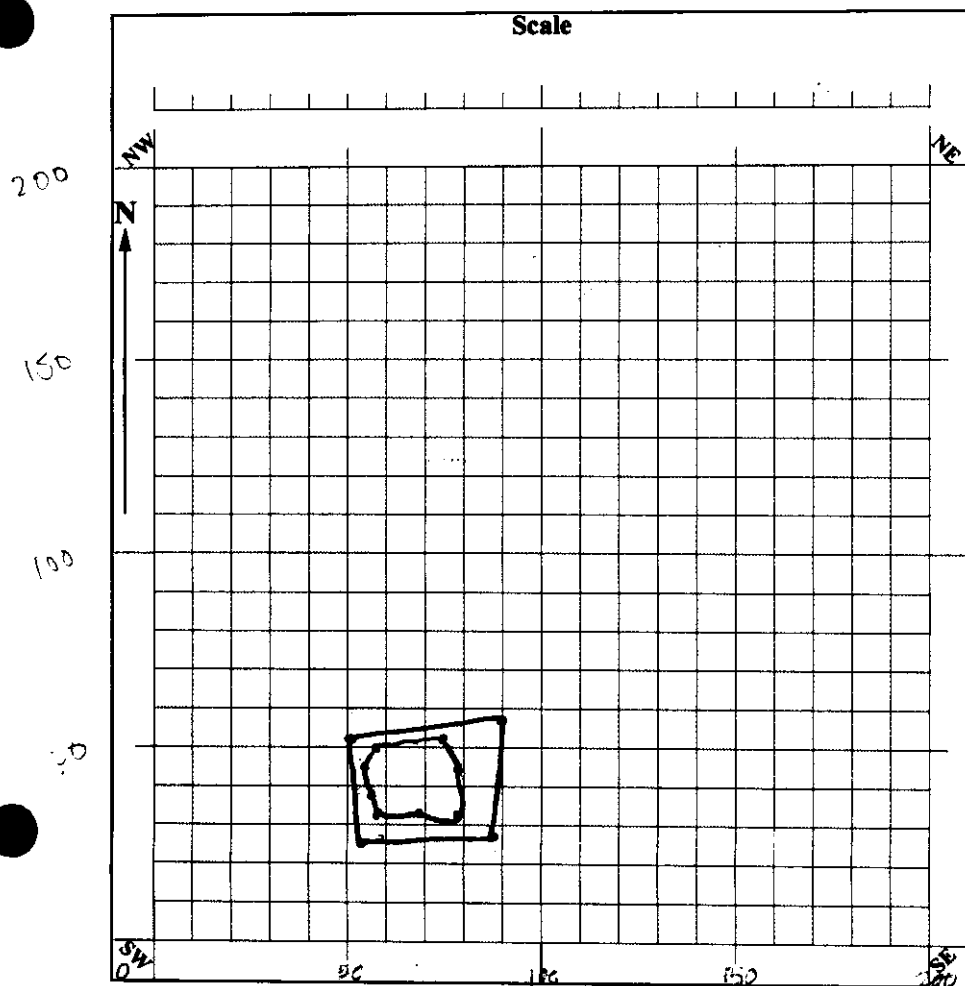

Mapped Item and Elev. (cmbd)

1. darkened soil - 49 cmbd
2. KH
49 cmbd
3. _____
4. _____
5. _____
6. _____
7. _____
8. _____
9. _____
10. _____

FEATURE PLANVIEW MAP NOTES:

Pedestal

NW Corner: 50 E, 51 N
 NE Corner: 90 E, 57 N
 SW Corner: 56 E, 25 N
 SE corner: 88 E, 27 N

Feature Outline

33 N, 69 E
 34 N, 68 E
 32 N, 76 E
 41 N, 78 E
 51 N, 75 E
 49 N, 57 E
 45 N, 53 E
 38 N, 56 E

FEATURE # C1 PROFILE MAP

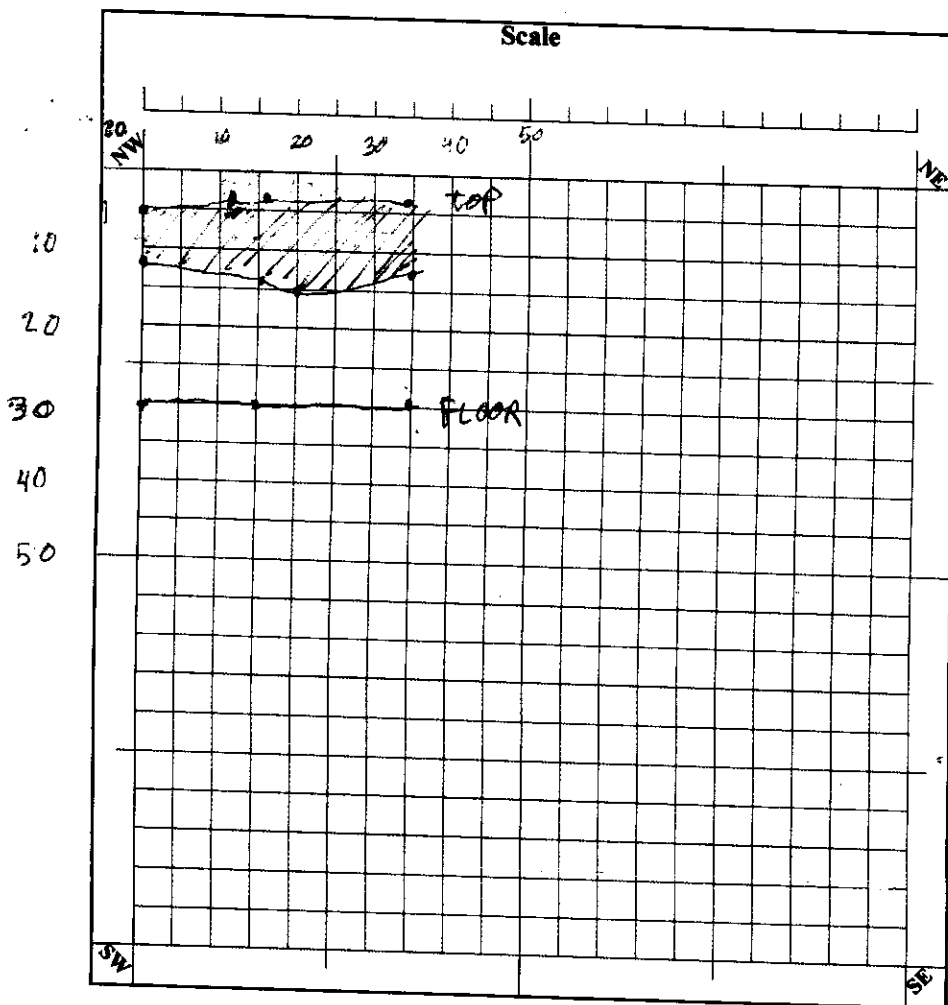

Mapped Item and Elev. (cmbd)

1. darkened soil 49 cmbd

2. _____

3. _____

4. _____

5. _____

6. _____

7. _____

8. _____

9. _____

10. _____

FEATURE PROFILE MAP NOTES:

Continued on Level Excavation Note Form: ☐ Yes ☒ No Number of Pages: 2

Crew Chief's Review & Approval: ED

Principal Investigator's Approval: _____

FEATURE FORM

Project Name: CCAMP Season 6
 Site Name and #: Penny site 8BR158
 Feature Number: C2 Unit Name: TUC Level: 5
 Excavators: KH MJ SCC RCV ED Date Begun: 3/2/2022
 Recorded by: Kaley Haff Date Ended: 3-23-22

EXCAVATION METHODS:

Soil Screened? ☒ Yes ☐ No Screening Method: ☐ Water ☒ Dry Mesh Size: ☐ 1/16" ☐ 1/8" ☒ 1/4"
 Excavation Methods: ☒ Shovel ☒ Trowel ☐ Other: _____
 Bisected? ☒ Yes ☐ No Which half? NORTH
 How was Feature Identified? soil change (darker)

TYPE OF FEATURE:

☐ Activity Area ☐ Artifact Concentration ☐ Burial ☐ Charcoal/Ash Concentration ☐ Storage Pit
☐ Hearth/Fire Pit ☐ Living Floor ☐ Possible Post Mold ☐ Cistern ☐ Foundation ☐ Privy Pit
☐ Trash Pit ☐ Trench ☐ Well ☐ Midden ☐ Pot/Basket Dump ☒ Other (Describe): darkened soil

FEATURE DESCRIPTION:

Dimensions: Shape: rounded rectangular shape
 Max. Length: 34 cm Direction: E Max. Width: 15 cm Direction: N
 Diameter: 33 cm

Soils: Feature Soil Color (Munsell): 10 YR 2/1 black
 Feature Soil Description: Texture: sandy, fine Inclusions: roots
 Matrix Soil Color (Munsell): 10 YR 4/3 brown
 Matrix Soil Description: Texture: finer than feature Inclusions: roots

Feature Fill: ☐ Soil only ☐ Soil and shell ☐ Ceramics ☒ Shell (60% or more shell) ☐ Charcoal
☐ Ash ☐ Daub/Clay Nodules ☐ Clay ☐ Lithics ☐ Faunal ☐ Human Remains ☐ Historic trash/debris
☐ Fire Cracked Rock ☐ Mixed ☐ Other: _____

Describe: _____

FEATURE LOCATION:Top Elevation: 51 cmbdCenter: PTN: 180 PTE: 59 North: PTN: 200 PTE: ^{EP}154 South: PTN: 181 PTE: ^{EP}154East: PTN: 190 PTE: 63 West: PTN: 185 PTE: 28Bottom Elevation: 55 cmbdCenter: PTN: 195 PTE: 47 North: PTN: 200 PTE: 45 South: PTN: 190 PTE: 53East: PTN: 196 PTE: 61 West: PTN: 195 PTE: 32**ARTIFACT CONTENT AND DENSITY:**

- ☐ Sterile ☐ Artifacts: FS Number(s): _____ Number of Bags: _____
- ☐ Bead ☐ Bottle/Container Glass ☐ Ceramics ☐ Charcoal ☐ Daub ☐ Faunal Remains, Modified
- ☐ Faunal Remains, Unmodified ☐ Fire Cracked Rock ☐ Fired Clay Object ☐ Human Remains ☐ Metal
- ☐ Lithics, Debitage ☐ Lithics, Tool ☐ Masonry (Brick, Mortar, Tabby, etc) ☐ Shell ☐ Shell, Modified
- ☐ Other: _____

SPECIAL SAMPLES:Special Sample Collected? ☒ Yes ☐ No Special Sample Number(s): _____ Number of Bags: _____Type of Sample: ☐ c14/Dating Sample ☒ Flotation ☐ Pollen ☐ Soil ☐ Other: _____Material Collected: ☐ Charcoal ☐ Faunal ☐ Shell ☒ Soil ☐ Wood ☐ Other: _____**ASSOCIATED FEATURES:**☒ Yes ☐ No Number of Features: 3 Feature Numbers: C1, C2, C4 Type: soil stainsLocation in relationship to this feature: C1 = South; C2 = East; C4 = SouthwestDescribe: amorphous shapes for soil stains; Munsell: very dark grey (for stains);
tens of roots throughout**NOTES:**

FEATURE # C2 PLANVIEW MAP

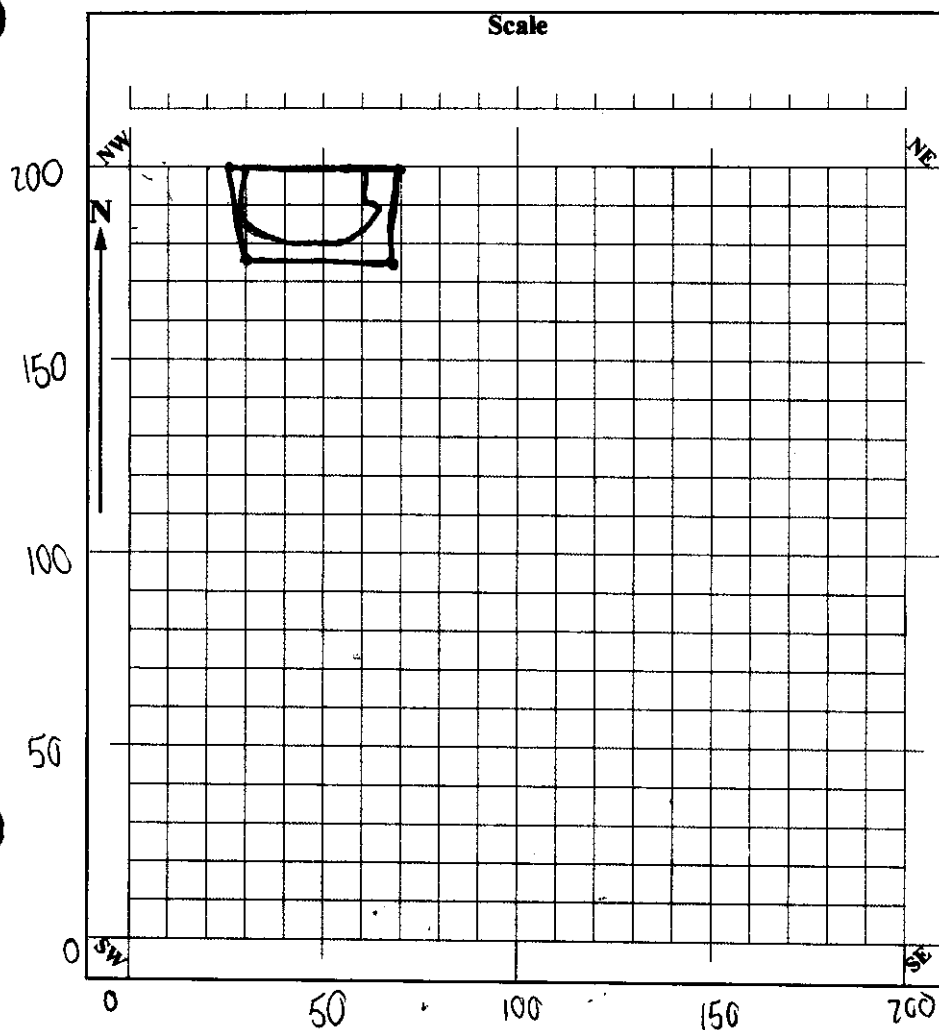

Mapped Item and Elev. (cmbd)

1. darkened soil - 49 cmbd
2. _____
3. _____
4. _____
5. _____
6. _____
7. _____
8. _____
9. _____
10. _____

FEATURE PLANVIEW MAP NOTES:

Pedestal:

NW corner: 200 N, 27 E
 NE corner: 200 N, 69 E
 SW corner: 178 N, 29 E
 SE corner: 176 N, 67 E

Feature:

1 NW pt: 200 N, 29 E
 2 185 N, 28 E
 3 181 N, 54 E
 4 184 N, 60 E
 5 NE pt: 190 N, 63 E
 6 191 N, 61 E
 7 200 N, 61 E

FEATURE # C2 PROFILE MAP

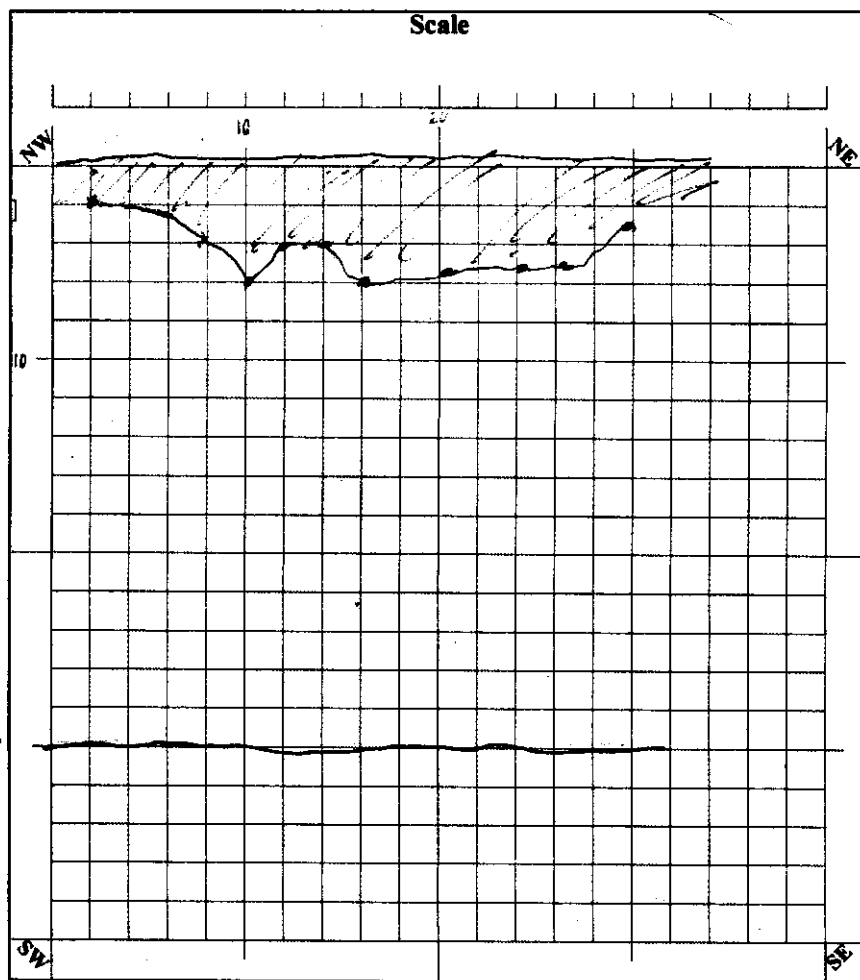

Mapped Item and Elev. (cmbd)

1. darkened soil 49cmbd
2. _____
3. _____
4. _____
5. _____
6. _____
7. _____
8. _____
9. _____
10. _____

FEATURE PROFILE MAP NOTES:

Continued on Level Excavation Note Form: ☐ Yes ☒ No Number of Pages: 2

Crew Chief's Review & Approval: ED

Principal Investigator's Approval: _____

FEATURE FORM

Project Name: CCAMP 6
Site Name and #: Penny site EBR 158
Feature Number: C3 Unit Name: Test Unit 6 Level: 6
Excavators: MS, EP, KH, SL, RCW Date Begun: 3-2-22
Recorded by: MS Date Ended: 3-23-22

EXCAVATION METHODS:

Soil Screened? ☒ Yes ☐ No Screening Method: ☐ Water ☒ Dry Mesh Size: ☐ 1/16" ☐ 1/8" ☒ 1/4"

Excavation Methods: ☒ Shovel ☒ Trowel ☐ Other: _____

Bisected? ☒ Yes ☐ No Which half? East

How was Feature Identified? soil staining

TYPE OF FEATURE:

☐ Activity Area ☐ Artifact Concentration ☐ Burial ☐ Charcoal/Ash Concentration ☐ Storage Pit
☐ Hearth/Fire Pit ☐ Living Floor ☐ Possible Post Mold ☐ Cistern ☐ Foundation ☐ Privy Pit
☐ Trash Pit ☐ Trench ☐ Well ☐ Midden ☐ Pot/Basket Dump ☒ Other (Describe): darkened soil

FEATURE DESCRIPTION:

Dimensions: Shape: Amorphous
Max. Length: 61 cm Direction: N Max. Width: 25 cm Direction: E
Diameter: 70 cm

Soils: Feature Soil Color (Munsell): 10YR 3/1, very dark gray

Feature Soil Description: Texture: sandy, grainy Inclusions: roots

Matrix Soil Color (Munsell): 10YR 5/4, yellowish brown

Matrix Soil Description: Texture: soft, fine Inclusions: roots

Feature Fill: ☐ Soil only ☒ Soil and shell ☐ Ceramics ☐ Shell (60% or more shell) ☒ Charcoal
☐ Ash ☐ Daub/Clay Nodules ☐ Clay ☐ Lithics ☒ Faunal ☐ Human Remains ☐ Historic trash/debris

☐ Fire Cracked Rock ☐ Mixed ☐ Other: _____

Describe: handfull of faunal remains unmodified as well as burnt bone +
handfull (small) of small bits of charcoal, few larger bits all fit w/in
palm of hand

FEATURE LOCATION:Top Elevation: 53 cmbdCenter: PTN: 1123 PTE: 121 North: PTN: 200 PTE: 150 South: PTN: 126 PTE: 120
East: PTN: 1100 PTE: 105 West: PTN: 200 PTE: 80Bottom Elevation: 96 cmbdCenter: PTN: 165 PTE: 170 North: PTN: 193 PTE: ^{ED 145}~~145~~ South: PTN: 132 PTE: 171
East: PTN: 165 PTE: 142 West: PTN: 190 PTE: ^{ED}~~145~~ 90**ARTIFACT CONTENT AND DENSITY:**

- ☐ Sterile ☒ Artifacts: FS Number(s): _____ Number of Bags: _____
- ☐ Bead ☐ Bottle/Container Glass ☐ Ceramics ☒ Charcoal ☐ Daub ☐ Faunal Remains, Modified
- ☒ Faunal Remains, Unmodified ☐ Fire Cracked Rock ☐ Fired Clay Object ☐ Human Remains ☐ Metal
- ☐ Lithics, Debitage ☐ Lithics, Tool ☐ Masonry (Brick, Mortar, Tabby, etc) ☒ Shell ☐ Shell, Modified
- ☐ Other: (burnt bone) + burnt oyster shell

SPECIAL SAMPLES:

- Special Sample Collected? ☒ Yes ☐ No Special Sample Number(s): _____ Number of Bags: _____
- Type of Sample: ☒ c14/Dating Sample ^(west) ☒ Flotation ☐ Pollen ☐ Soil ☐ Other: _____
- Material Collected: ☒ Charcoal ☐ Faunal ☐ Shell ☒ Soil ☐ Wood ☐ Other: _____

ASSOCIATED FEATURES:

- ☒ Yes ☐ No Number of Features: 3 Feature Numbers: C1, C2, C4 Type: soil stains
- Location in relationship to this feature: G = west; C1 = Southwest; C4 = Southwest
- Describe: all amorphous shapes of soil w/ Munsell color: very dark grey; several roots throughout features as well

NOTES:Top of [East] part of pedestal is 60 cmbd + Bottom is 82 cmbdPP: charcoal 136^{cm} E 169^{cm} N

- low frequency of bone + burnt bone
- C3 Profile Datum: 43 cm below unit datum

FEATURE # C2 PROFILE MAP

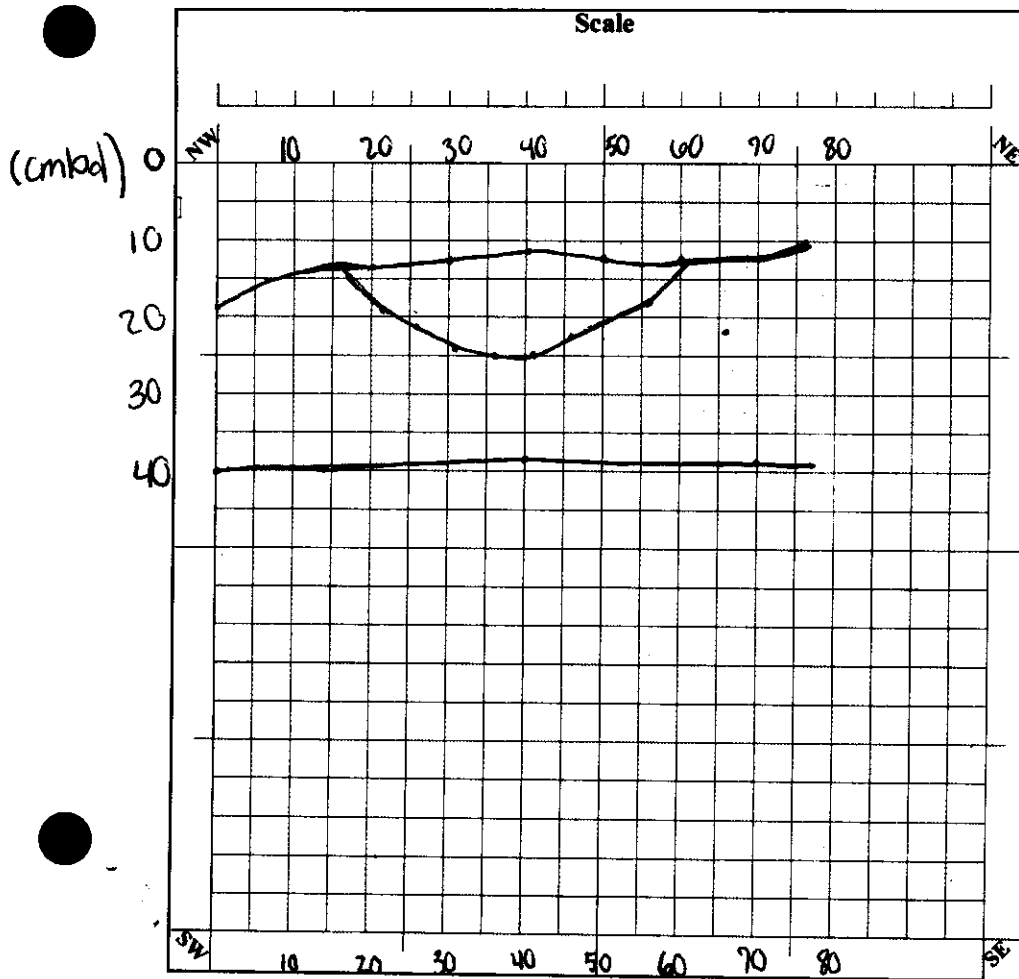

Mapped Item and Elev. (cmbd)

1. West profile 10 1/2
2. Munsell feature: 3/1
very dark grey
3. Munsell matrix: 5/4
yellowish brown
4. _____
5. _____
6. _____
7. _____
8. _____
9. _____
10. _____

FEATURE PROFILE MAP NOTES:

Length: 0 - 78 cm

Depth: 10 - 40 cmbd (feature datum)

Continued on Level Excavation Note Form: ☒ Yes ☐ No Number of Pages: 2

Crew Chief's Review & Approval: ED

Principal Investigator's Approval: _____

FEATURE # 3 PLANVIEW MAP

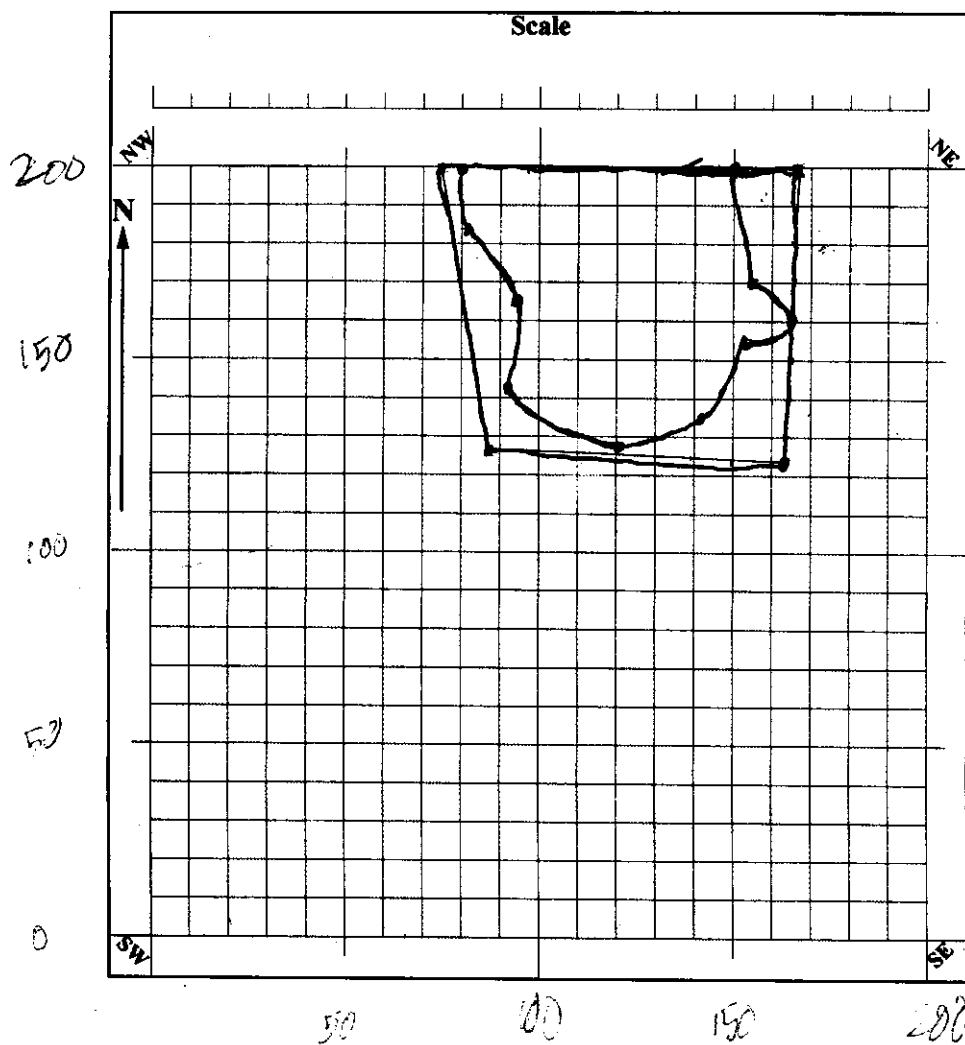

Mapped Item and Elev. (cmbd)

1. Darkened soil, 52 cmbd
(possible trees)

2. _____

3. _____

4. _____

5. _____

6. _____

7. _____

8. _____

9. _____

10. _____

FEATURE PLANVIEW MAP NOTES:

Pedestal
SE N 123 E 161
NE N 200 E 166
SW N 127 E 86
NW N 200 E 75

52 cmbd

Feature
N 200 E 150
N 170 E 154
N 160 E 165
N 156 E 152
N 136 E 142
N 126 E 120
N 142 E 90
N 166 E 94
N 183 E 381
N 200 E 80

FEATURE FORM

Project Name: CAMP season 6
 Site Name and #: Penny Site 8BR158
 Feature Number: C4 Unit Name: TVC Level: 6
 Excavators: ICH, MJ, ED, RCV, SCC Date Begun: 3/2/2022
 Recorded by: Kaley Haff Date Ended: 3/23/2022

EXCAVATION METHODS:

Soil Screened? ☒ Yes ☐ No Screening Method: ☐ Water ☒ Dry Mesh Size: ☐ 1/16" ☐ 1/8" ☒ 1/4"
 Excavation Methods: ☐ Shovel ☒ Trowel ☐ Other: _____
 Bisected? ☒ Yes ☐ No Which half? WEST
 How was Feature Identified? darkened soil

TYPE OF FEATURE:

☐ Activity Area ☐ Artifact Concentration ☐ Burial ☐ Charcoal/Ash Concentration ☐ Storage Pit
☐ Hearth/Fire Pit ☐ Living Floor ☐ Possible Post Mold ☐ Cistern ☐ Foundation ☐ Privy Pit
☐ Trash Pit ☐ Trench ☐ Well ☐ Midden ☐ Pot/Basket Dump ☒ Other (Describe): darkened soil

FEATURE DESCRIPTION:

Dimensions: Shape: oval - looks like a shield - more ovoid
 Max. Length: 28 cm Direction: N Max. Width: 33 cm Direction: E
 Diameter: 35 cm
 Soils: Feature Soil Color (Munsell): 7.5 YR 3/1 very dark grey
 Feature Soil Description: Texture: fine, grainy Inclusions: roots
 Matrix Soil Color (Munsell): 10 YR 4/3 brown
 Matrix Soil Description: Texture: fine, sandy Inclusions: roots
 Feature Fill: ☐ Soil only ☐ Soil and shell ☐ Ceramics ☐ Shell (60% or more shell) ☐ Charcoal
☐ Ash ☐ Daub/Clay Nodules ☐ Clay ☐ Lithics ☐ Faunal ☐ Human Remains ☐ Historic trash/debris
☐ Fire Cracked Rock ☐ Mixed ☐ Other: _____
 Describe: _____

FEATURE LOCATION:Top Elevation: 56 cmbdCenter: PTN: 92cm PTE: 15cm North: PTN: 88cm PTE: 8E South: PTN: 86cm PTE: 27cm
East: PTN: 98cm PTE: 33cm West: PTN: 115 PTE: 20Bottom Elevation: 65 cmbdCenter: PTN: 93cm PTE: 11cm North: PTN: 109cm PTE: 13cm South: PTN: 71cm PTE: 9cm
East: PTN: 91cm PTE: 17cm West: PTN: 92cm PTE: 3cm**ARTIFACT CONTENT AND DENSITY:**

- ☐ Sterile ☐ Artifacts: FS Number(s): _____ Number of Bags: _____
- ☐ Bead ☐ Bottle/Container Glass ☐ Ceramics ☐ Charcoal ☐ Daub ☐ Faunal Remains, Modified
- ☐ Faunal Remains, Unmodified ☐ Fire Cracked Rock ☐ Fired Clay Object ☐ Human Remains ☐ Metal
- ☐ Lithics, Debitage ☐ Lithics, Tool ☐ Masonry (Brick, Mortar, Tabby, etc) ☐ Shell ☐ Shell, Modified
- ☐ Other: _____

SPECIAL SAMPLES:Special Sample Collected? ☒ Yes ☐ No Special Sample Number(s): _____ Number of Bags: _____Type of Sample: ☐ c14/Dating Sample ☒ Flotation ☐ Pollen ☐ Soil ☐ Other: _____Material Collected: ☐ Charcoal ☐ Faunal ☐ Shell ☒ Soil ☐ Wood ☐ Other: _____**ASSOCIATED FEATURES:**☒ Yes ☐ No Number of Features: 3 Feature Numbers: C1, C2, C3 Type: soil stainsLocation in relationship to this feature: C1: slightly southeast; C2: slightly Northeast; C3: NortheastDescribe: all amorphous shapes of soil stains w/ Munsell color: very dark grey;
several roots throughout**NOTES:**

FEATURE # C4 PLANVIEW MAP

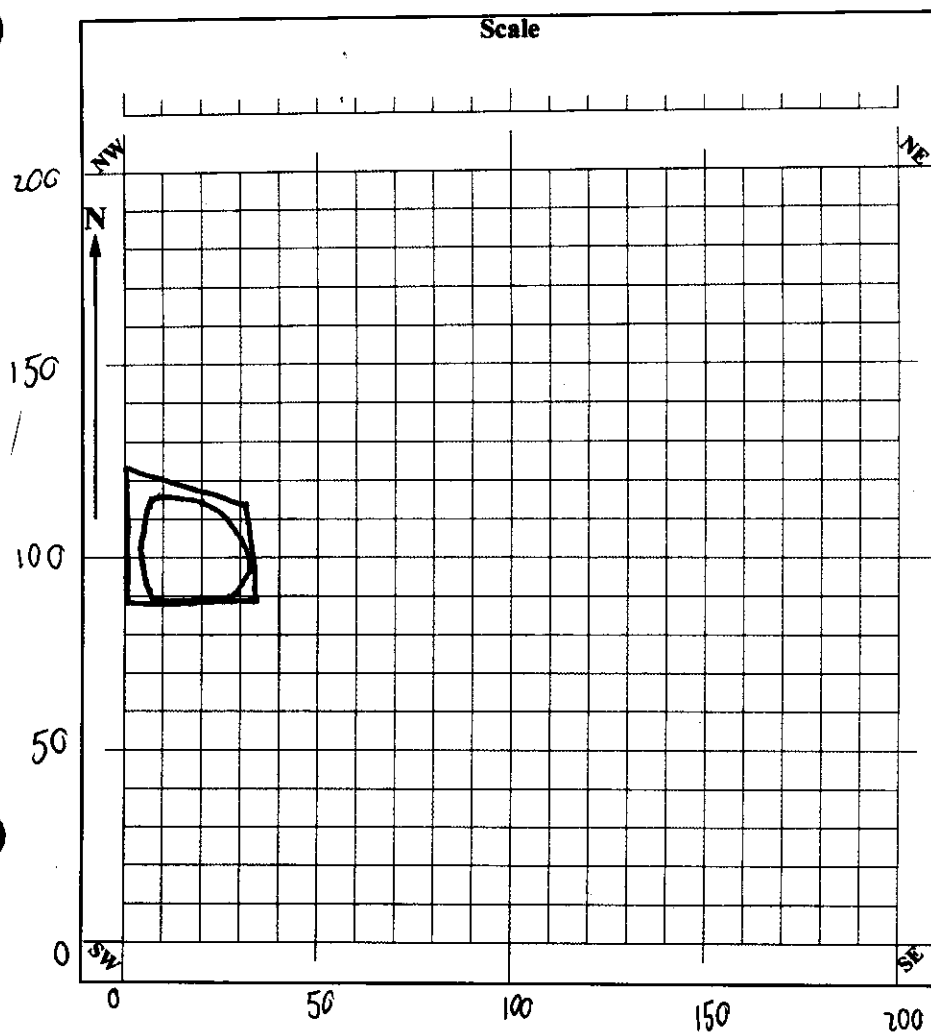

Mapped Item and Elev. (cmbd)

1. darkened soil - 56 cmbd
2. _____
3. _____
4. _____
5. _____
6. _____
7. _____
8. _____
9. _____
10. _____

FEATURE PLANVIEW MAP NOTES:

Pedestal:

(corners)
 NE: 89 N, 33 E
 NW: 89 N, 0 E
 SE: 113 N, 32 E
 SW: 123 N, 0 E

Feature:

- 1) 88 N, 8 E
- 2) 89 N, 27 E
- 3) 98 N, 33 E
- 4) 115 N, 20 E
- 5) 115 N, 7 E
- 6) 101 N, 6 E

FEATURE # C4 PROFILE MAP

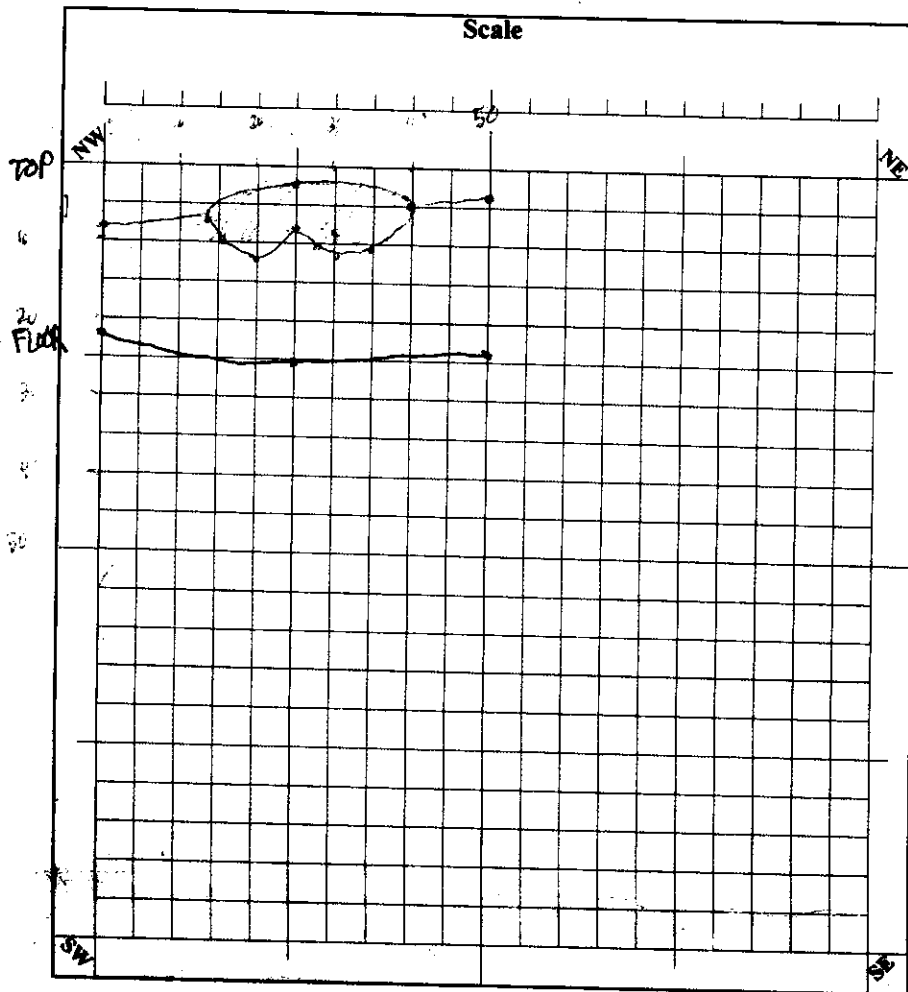

Mapped Item and Elev. (cmbd)

1. darkened soil 56cmbd
2. _____
3. _____
4. _____
5. _____
6. _____
7. _____
8. _____
9. _____
10. _____

FEATURE PROFILE MAP NOTES:

Continued on Level Excavation Note Form: ☐ Yes ☒ No Number of Pages: _____

Crew Chief's Review & Approval: ED

Principal Investigator's Approval: _____