

5-11-2004

Apparatus and Method for Drawing Continuous Fiber

Aravinda Kar
University of Central Florida

Yonggang Li
Fipro LLC.

Raymond McNeice
Fipro LLC.

Nathaniel Quick
Fipro LLC.

Find similar works at: <https://stars.library.ucf.edu/patents>

University of Central Florida Libraries <http://library.ucf.edu>

This Patent is brought to you for free and open access by the Technology Transfer at STARS. It has been accepted for inclusion in UCF Patents by an authorized administrator of STARS. For more information, please contact STARS@ucf.edu.

Recommended Citation

Kar, Aravinda; Li, Yonggang; McNeice, Raymond; and Quick, Nathaniel, "Apparatus and Method for Drawing Continuous Fiber" (2004). *UCF Patents*. 27.
<https://stars.library.ucf.edu/patents/27>



US006732562B2

(12) **United States Patent**
Quick et al.

(10) **Patent No.:** **US 6,732,562 B2**
(45) **Date of Patent:** **May 11, 2004**

(54) **APPARATUS AND METHOD FOR DRAWING CONTINUOUS FIBER**

(75) Inventors: **Nathaniel R. Quick**, Lake Mary, FL (US); **Aravinda Kar**, Oviedo, FL (US); **Yonggang Li**, Orlando, FL (US); **Raymond R. McNeice**, Debary, FL (US)

(73) Assignee: **University of Central Florida**, Orlando, FL (US)

(*) Notice: Subject to any disclaimer, the term of this patent is extended or adjusted under 35 U.S.C. 154(b) by 10 days.

(21) Appl. No.: **09/851,517**

(22) Filed: **May 8, 2001**

(65) **Prior Publication Data**

US 2002/0043091 A1 Apr. 18, 2002

Related U.S. Application Data

(60) Provisional application No. 60/203,048, filed on May 9, 2000.

(51) **Int. Cl.**⁷ **B21D 37/16**

(52) **U.S. Cl.** **72/342.1; 72/38; 72/279; 72/286; 72/342.5; 72/342.6; 72/342.94**

(58) **Field of Search** **72/274, 278, 279, 72/286, 289, 342.1, 342.94, 364, 377, 378, 38, 342.5, 342.6; 219/121.6, 121.73, 121.75, 121.85, 121.86**

(56) **References Cited**

U.S. PATENT DOCUMENTS

3,605,469 A 9/1971 Queralto

3,788,120 A	1/1974	Takeo et al.	
3,854,193 A	* 12/1974	Yamaguchi et al.	29/473.9
3,865,564 A	2/1975	Jaeger et al.	
3,943,324 A	3/1976	Haggerty	
3,944,640 A	3/1976	Haggerty et al.	
3,965,328 A	6/1976	Locke	
3,981,705 A	9/1976	Jaeger et al.	
4,043,170 A	8/1977	Erodi et al.	
4,135,902 A	1/1979	Oehrle	
4,142,088 A	2/1979	Hirsch	
4,215,263 A	7/1980	Grey et al.	
4,383,843 A	5/1983	Iyengar	
4,547,650 A	10/1985	Arditty et al.	
4,872,923 A	* 10/1989	Borodin	72/286
4,901,550 A	* 2/1990	Koide et al.	72/38
4,962,085 A	* 10/1990	deBarbadillo, II et al.	148/284
5,127,364 A	* 7/1992	Savkar et al.	118/712
5,336,360 A	8/1994	Nordine	
5,549,971 A	8/1996	Nordine	
5,823,039 A	* 10/1998	Umeda et al.	72/286

* cited by examiner

Primary Examiner—Ed Tolan

(74) *Attorney, Agent, or Firm*—Frijouf, Rust & Pyle, P.A.

(57) **ABSTRACT**

An apparatus and method is disclosed for drawing continuous metallic wire having a first diameter to a metallic fiber having a reduced second diameter. A feed mechanism moves the wire at a first linear velocity. A laser beam heats a region of the wire to an elevated temperature. A draw mechanism draws the heated wire at a second and greater linear velocity for providing a drawn metallic fiber having the reduced second diameter.

16 Claims, 8 Drawing Sheets

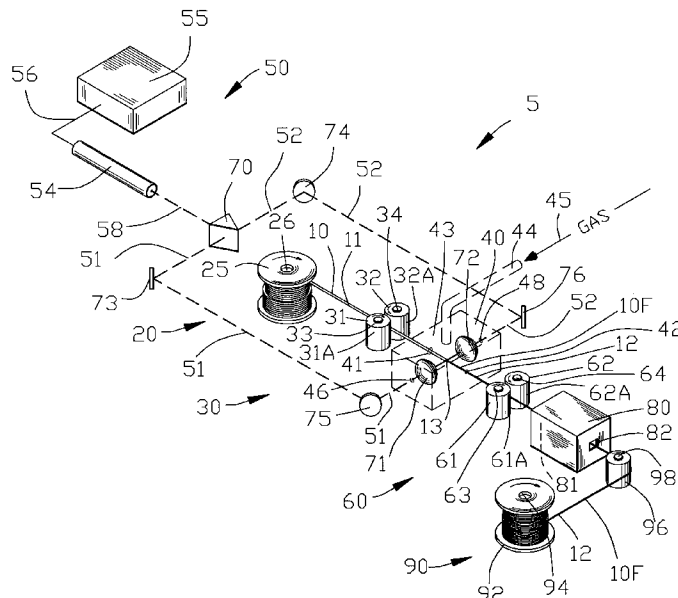

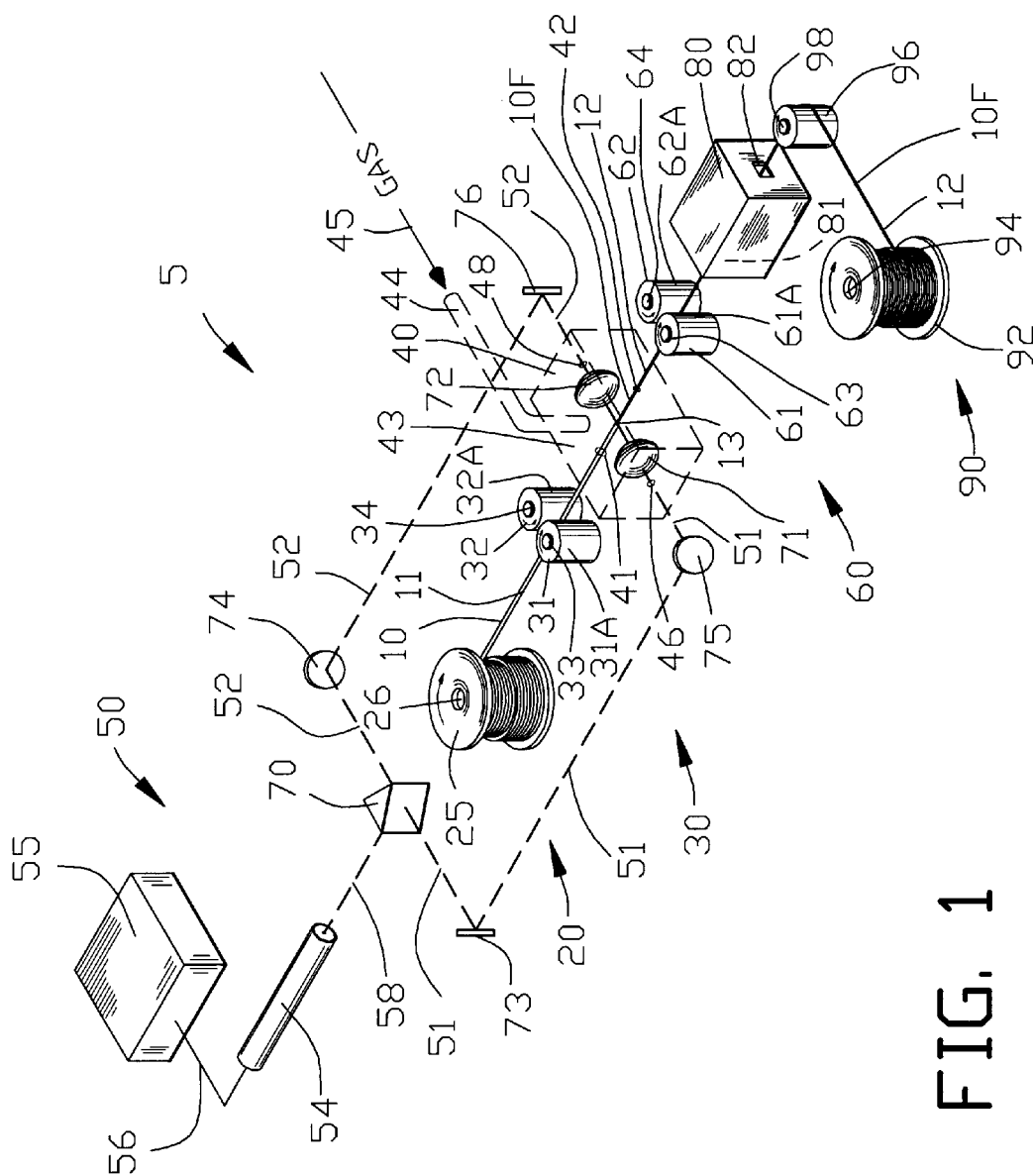

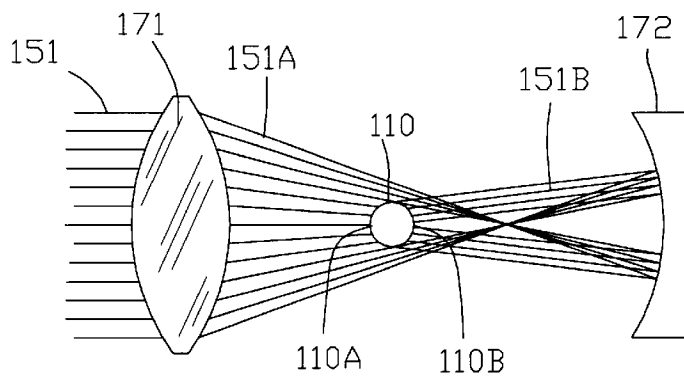
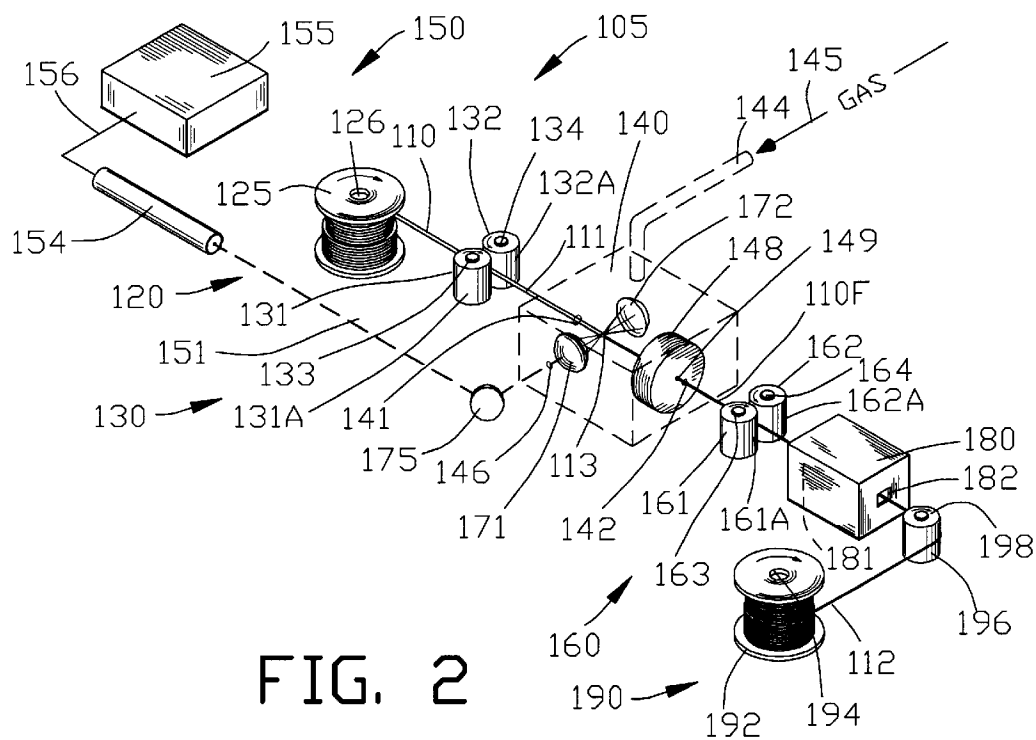

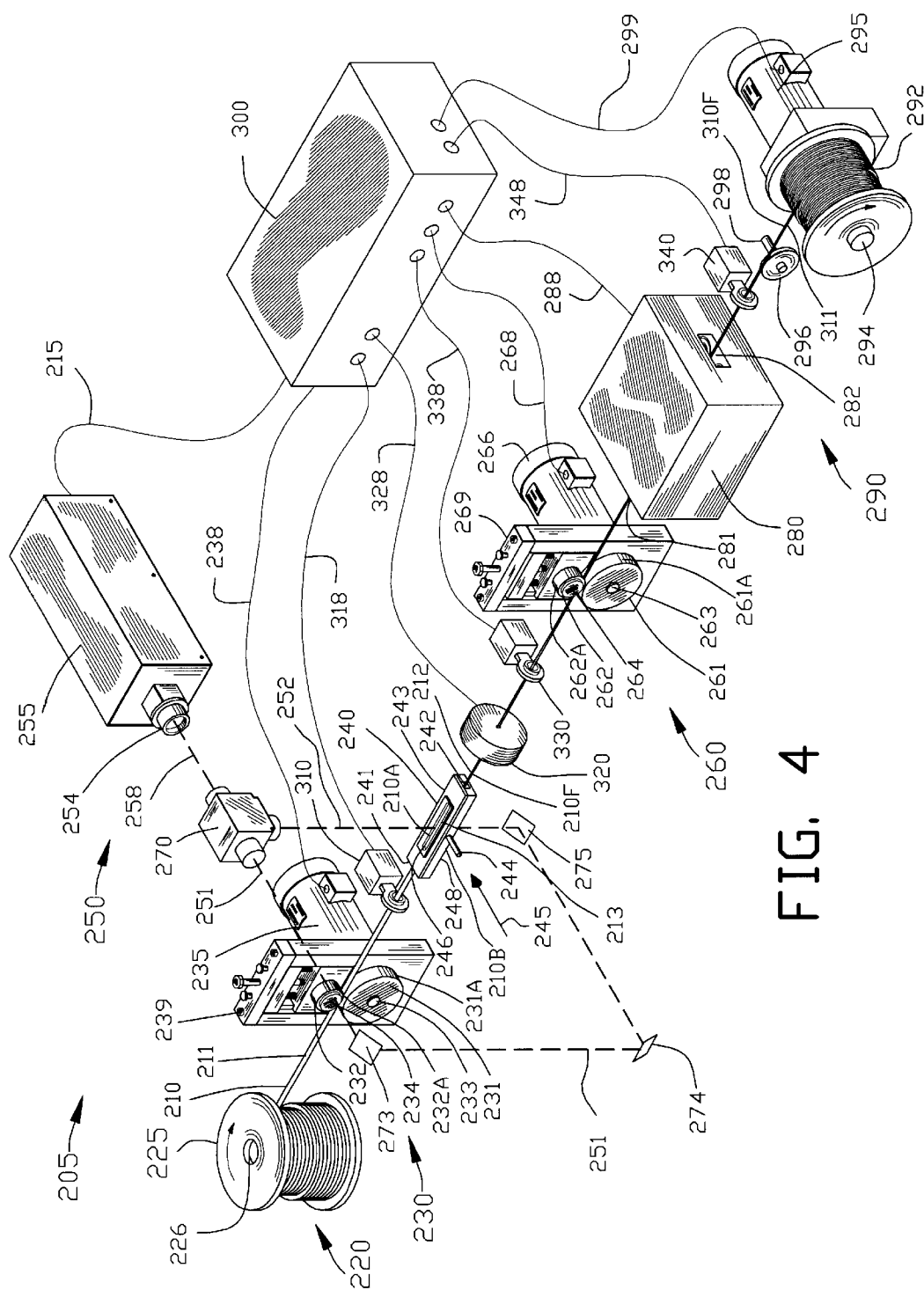
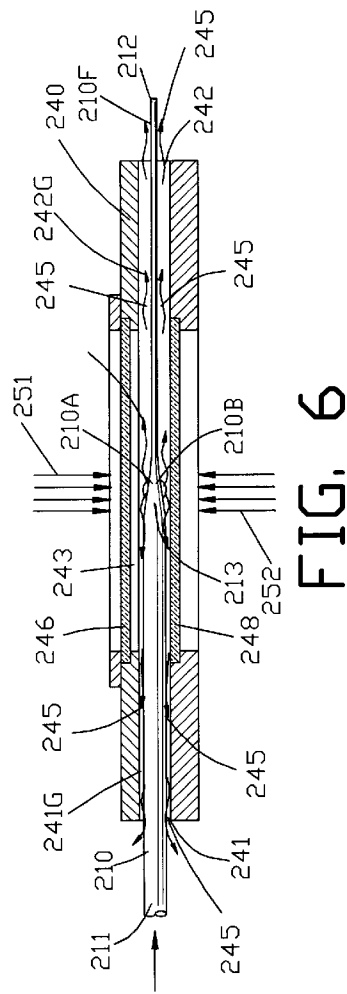
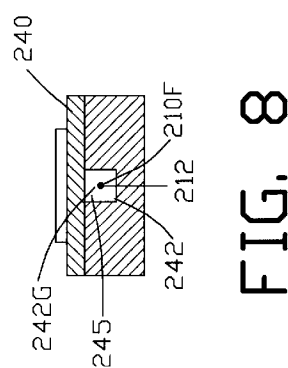
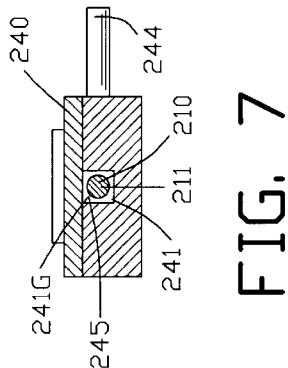
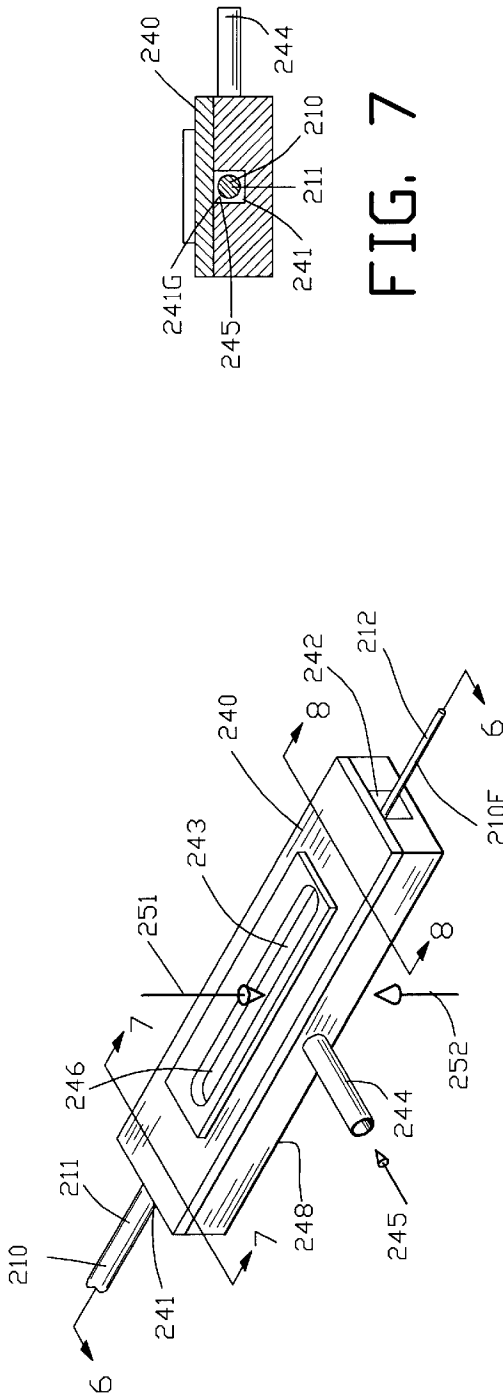

FIG. 4



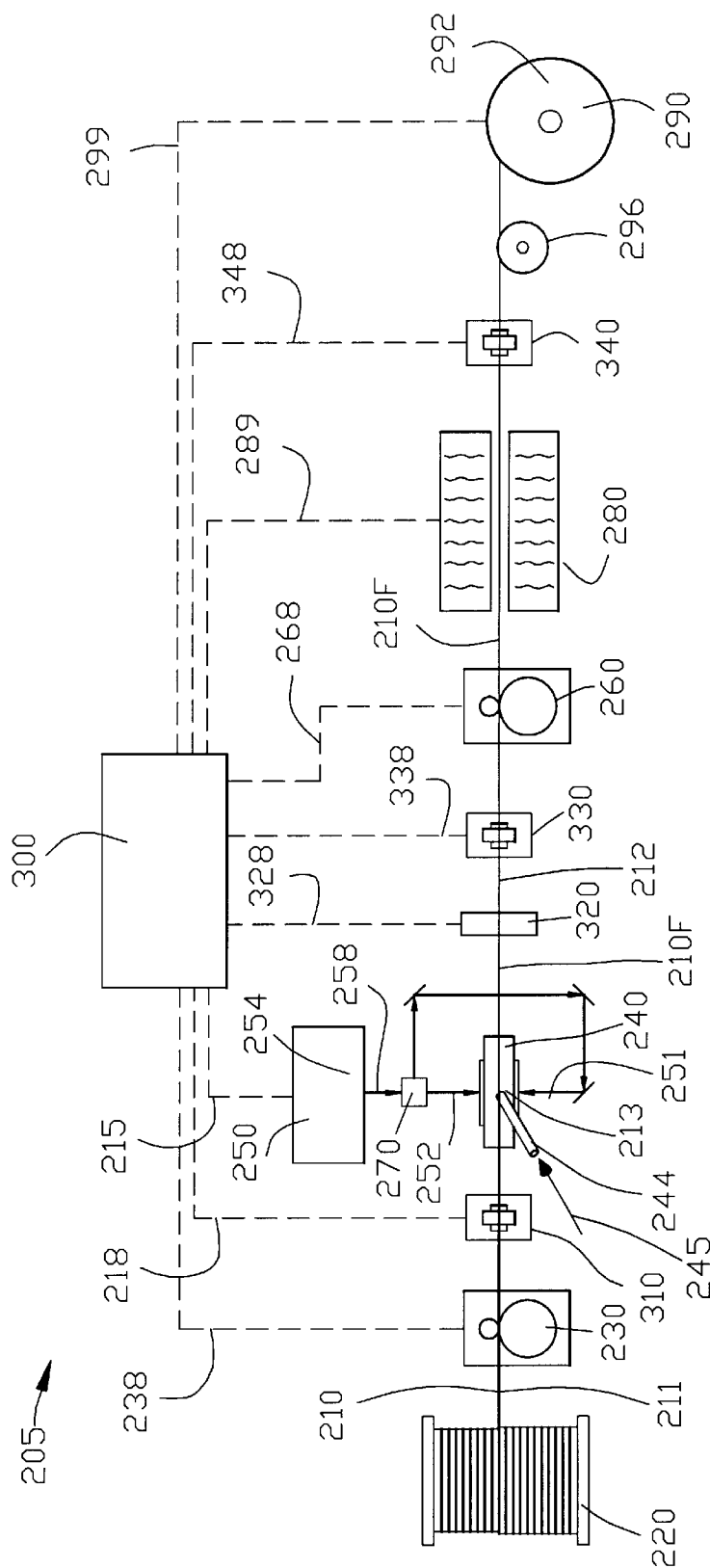

FIG. 9

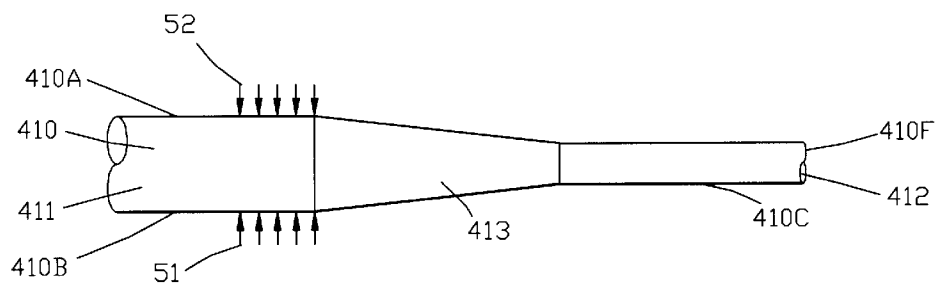

FIG. 10

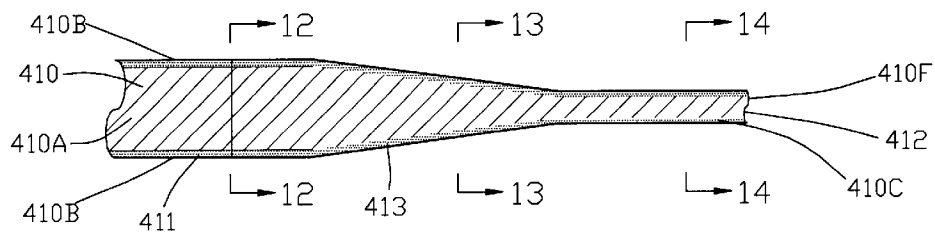

FIG. 11

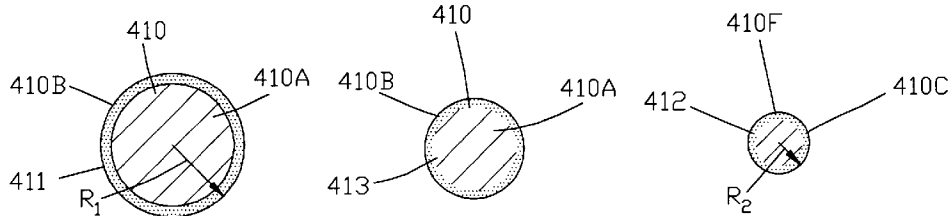

FIG. 12 FIG. 13 FIG. 14

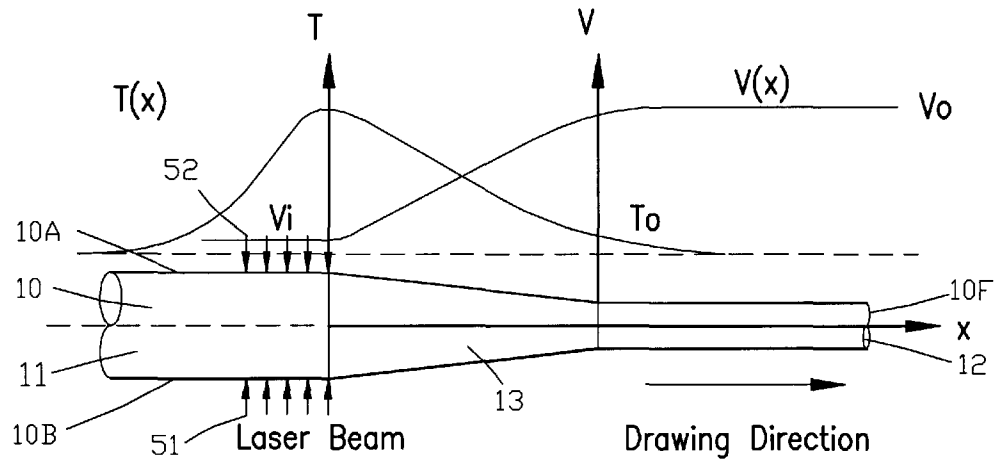

FIG. 15

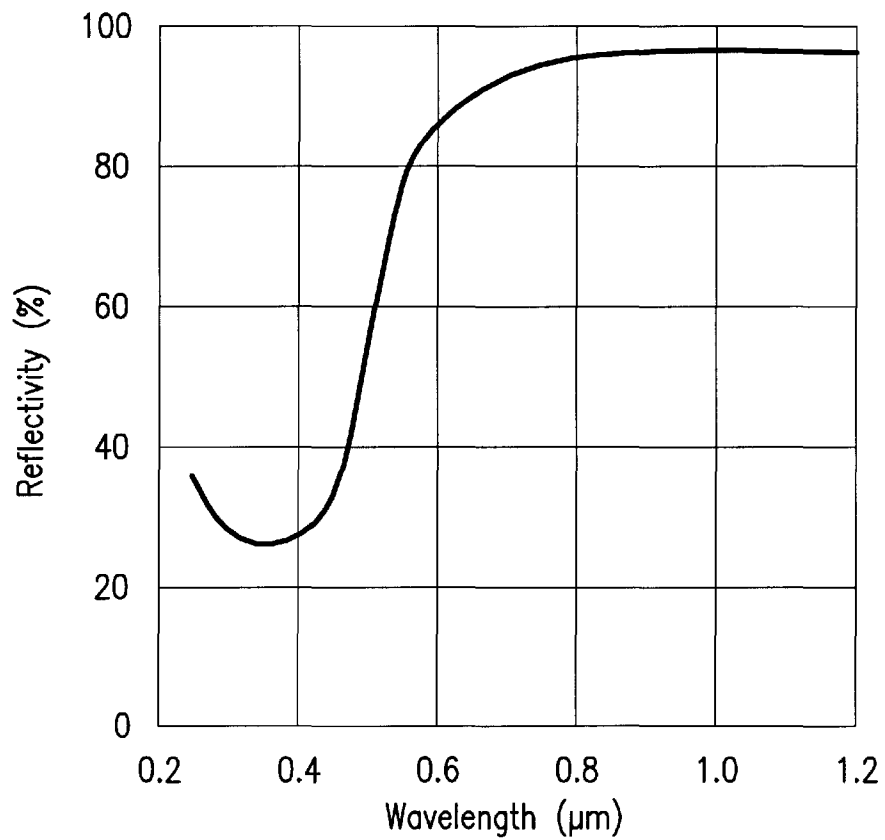

FIG. 16

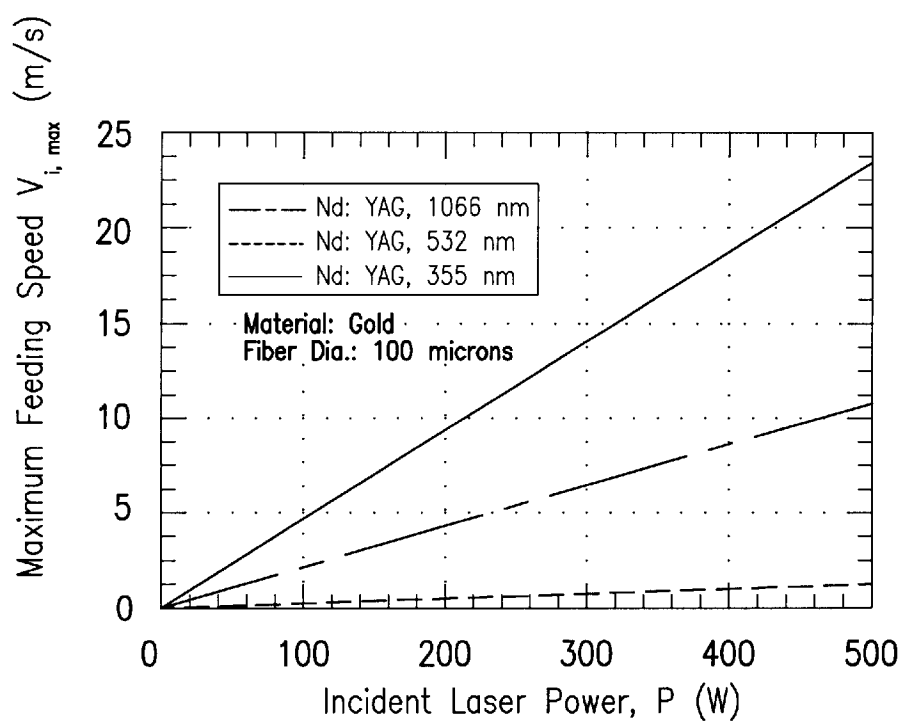

FIG. 17

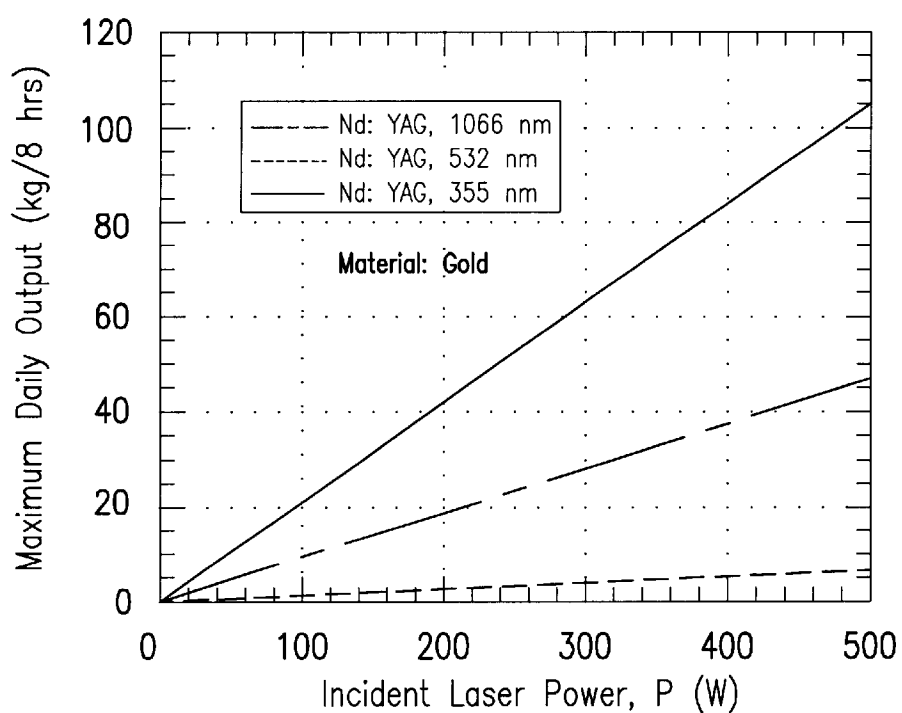

FIG. 18

APPARATUS AND METHOD FOR DRAWING CONTINUOUS FIBER

CROSS-REFERENCE TO RELATED APPLICATIONS

This application claims benefit of United States Provisional application serial No. 60/203,048 filed May 9, 2000. All subject matter set forth in provisional application serial No. 60/203,048 is hereby incorporated by reference into the present application as if fully set forth herein.

BACKGROUND OF THE INVENTION

1. Field of the Invention

This invention relates to an apparatus and method for drawing continuous metallic fiber and more particularly to an apparatus and a method for heating and drawing wire for providing a drawn metallic fiber.

2. Description of the Related Art

The art of metal working and metal forming have been well known for a great number of years. Metal may be deformed into various useful shapes by a multitude of apparatuses and methods. One particular form of metal working comprises the working and/or fashioning of metallic wire into fine metallic wire.

Metallic wires and more particularly fine metallic wires have found a wide variety of applications in modern military, industrial and consumer applications. Of the many processes of metal working that have been developed by the prior art, the process of wire drawing is considered one of the preferred processes to produce fine metallic wires. The process of wire drawing has proven to be an effective technique to reduce the diameter of metallic wire. A commercially feasible conventional wire drawing process is capable of producing metallic wire having a diameter of only 100 microns.

In a conventional wire drawing process, a metallic wire is passed through a wire drawing die for reducing the diameter of the metallic wire. In many cases, the metallic wire is passed through a series of wire drawing dies for producing the fine metallic wires. Unfortunately, the production of fine metallic wires by a wire drawing process remains a costly undertaking. In addition, the fine metallic wires may be contaminated by wire drawing dies during the conventional wire drawing process.

The drawing of ductile metallic wire may be accomplished by other drawing processes. One example of a non-conventional wire drawing process comprises the use of a laser to heat the ductile metallic wire. Laser radiation can be focused using a lens system to produce a small spot of high intensity heat energy. The high intensity heat energy may be used for drawing the ductile metallic wire in a non-conventional fashion. The following United States patents are representative of the uses of lasers for heating ductile metallic wire. Many of these United States patents employ complex systems to modify the shape of the laser beam to produce desired heating effects for the production of small diameter wires.

U.S. Pat. No. 3,944,640 to Haggerty et al teaches the method of forming fibers of refractory materials using a focused laser beam and optical system to create a heating zone. The laser beam is split into four beams focused on the refractory material.

U.S. Pat. No. 5,336,360 and U.S. Pat. No. 5,549,971 to Nordine teaches laser assisted fiber growth which includes small diameter fibers of zinc or tungsten of 10 to 170

micrometers. The fiber growth is achieved by movement of a metallurgical microscope stage. The laser beam has a focal point adjusted to coincide with the tip of the growing fiber. Producing an annular laser beam aligned with the axis of the fiber has proved to be an effective though more complex method to control laser energy.

U.S. Pat. No. 3,865,564 to Jaeger et al teaches the drawing of both clad and unclad glass fibers from preform using a laser beam having an annular cross section to soften the preform. The annular laser beam is directed along the axis of the fiber. A modulated control system is also discussed.

U.S. Pat. No. 3,981,705 to Jaeger et al teaches the use of a conical reflector to focus laser radiation in an annular configuration around a glass preform in drawing glass fibers.

U.S. Pat. No. 3,943,324 to Haggerty discloses an apparatus for forming refractory tubing that includes creating a heated zone using a laser. Various optical systems are illustrated for beam splitting and creating annular laser beam configuration.

U.S. Pat. No. 4,135,902 to Oehrle teaches the use of an annular beam to form a melt zone on a fiber using an optical system which includes oscillating galvanometer controlled mirrors, fixed mirror, and a conical reflector to focus the annular laser beam at the surface of the fiber.

U.S. Pat. No. 4,215,263 to Grey et al teaches the use of a rotating reflector, annular mirrors and a conical reflector to create an annular laser beam heating zone for drawing an optical wave guide wherein the annular laser beam does not intersect the axis of the blank wave guide.

U.S. Pat. No. 4,383,843 to Iyengar suggests use of an annular laser beam as a source for heating a preform from which a light guide fiber is drawn.

U.S. Pat. No. 4,547,650 to Arditty et al discloses an optical system utilizing a laser beam directed towards a spherical mirror then from an ellipsoidal mirror to direct the laser energy in a threadlike annular heating zone.

Although the aforementioned prior art provided a method of fine wire production, these prior art processes did have a major disadvantage and did not fulfill the needs of the wire drawing art.

Therefore, it is an object of the present invention to provide an apparatus and method for drawing continuous metallic fiber that overcomes the disadvantages of the prior art devices and provides a substantial contribution to the wire and metallic fiber production art.

Another object of this invention is to provide an apparatus and method for drawing continuous metallic fiber without the introduction of contaminants into the drawn continuous metallic fiber.

Another object of this invention is to provide an apparatus and method for drawing continuous metallic fiber and capable of accurately producing fine metallic fiber in commercial quantities.

Another object of this invention is to provide an apparatus and method for drawing continuous metallic fiber that is reliable and energy efficient.

Another object of this invention is to provide an apparatus and method for drawing continuous metallic fiber with reduced production costs over the prior art techniques and devices.

The foregoing has outlined some of the more pertinent objects of the present invention. These objects should be construed as being merely illustrative of some of the more prominent features and applications of the invention. Many other beneficial results can be obtained by applying the

disclosed invention in a different manner or modifying the invention within the scope of the invention. Accordingly other objects in a full understanding of the invention may be had by referring to the summary of the invention and the detailed description describing the preferred embodiment of the invention.

SUMMARY OF THE INVENTION

A specific embodiment of the present invention is shown in the attached drawings. For the purpose of summarizing the invention, the invention relates to an apparatus for drawing a wire having a first diameter to provide a metallic fiber having a reduced second diameter comprising a feed mechanism for moving the wire at a first linear velocity. A laser beam heats a region of the wire and a draw mechanism draws the heated wire at a second linear velocity for providing a metallic fiber having a second diameter.

In a more specific of the invention, the laser beam heats the region of the wire to a visco-elastic temperature. The second linear velocity is greater than the first linear velocity. The feed and the draw mechanisms comprise a feed capstan drive and a draw capstan drive, respectively. The laser beam may comprise a beam splitter for dividing the laser output beam into a first laser beam and a second laser beam for impinging upon a first and a second side of the wire.

A chamber has an entry groove and an exit groove with the wire entering the chamber through the entry groove and with the drawn metallic fiber exiting the chamber through the exit groove. The chamber has a fluid inlet port for receiving a pressurized fluid atmosphere for enveloping the wire. The pressurized fluid atmosphere exits the entry groove and the exit groove for providing a fluid bearing for the wire within the entry groove and for providing a fluid bearing for the drawn metallic fiber within the exit groove. The pressurized fluid atmosphere exits the exit groove for cooling the drawn metallic fiber emanating from the heated region. The chamber has a window substantially transparent to the laser beam for heating the region of the wire within the chamber.

A first and a second sensor sense the first diameter of the wire and the second diameter of the metallic fiber, respectively. A control module is connected to the first and second sensors for controlling the first linear velocity and the second linear velocity for controlling the reduction of the second diameter from the first diameter.

The invention is also incorporated into the method of drawing a wire having a first diameter to a metallic fiber having a second diameter comprising the steps of feeding the wire at a first linear velocity. The wire is heated to a visco-elastic temperature region with a laser. The wire is drawn at second linear velocity to produce the metallic fiber having a reduced second diameter.

The foregoing has outlined rather broadly the more pertinent and important features of the present invention in order that the detailed description that follows may be better understood so that the present contribution to the art can be more fully appreciated. Additional features of the invention will be described hereinafter which form the subject matter of the invention. It should be appreciated by those skilled in the art that the conception and the specific embodiments disclosed may be readily utilized as a basis for modifying or designing other structures for carrying out the same purposes of the present invention. It should also be realized by those skilled in the art that such equivalent constructions do not depart from the spirit and scope of the invention.

BRIEF DESCRIPTION OF THE DRAWINGS

For a fuller understanding of the nature and objects of the invention, reference should be made to the following

detailed description taken in connection with the accompanying drawings in which:

FIG. 1 is an isometric view of a first embodiment of an apparatus for drawing continuous metallic fiber incorporating the present invention;

FIG. 2 is an isometric view of a second embodiment of an apparatus for drawing continuous metallic fiber incorporating the present invention;

FIG. 3 is an enlarged side view of a parabolic mirror system of FIG. 2;

FIG. 4 is an isometric view of a third embodiment of an apparatus for drawing continuous metallic fiber incorporating the present invention;

FIG. 5 is an enlarged view of a portion of FIG. 4;

FIG. 6 is a sectional view along line 6—6 in FIG. 5;

FIG. 7 is a sectional view along line 7—7 in FIG. 5;

FIG. 8 is a sectional view along line 8—8 in FIG. 5;

FIG. 9 is a block diagram of the apparatus for drawing continuous metallic fiber illustrated in FIG. 4;

FIG. 10 is a side view of illustrating the transformation of a composite wire into an metallic alloy;

FIG. 11 is a sectional view of FIG. 10;

FIG. 12 is a sectional view along line 12—12 in FIG. 11;

FIG. 13 is a sectional view along line 13—13 in FIG. 11;

FIG. 14 is a sectional view along line 14—14 in FIG. 11;

FIG. 15 is a graphical representation of a region of a wire heated by a laser to a visco-elastic temperature;

FIG. 16 is a graph illustrating the relationship of a laser wavelength versus the reflectivity of gold;

FIG. 17 is a graph illustrating the incident laser power for three distinct wavelengths of lasers versus maximum feeding speed to achieve proper drawing of a regions of a 100 micron gold metallic fiber heated to a visco-elastic temperature; and

FIG. 18 is a graph illustrating the incident laser power for three distinct wavelengths of lasers versus maximum daily output in kilograms per eight hours gold metallic fiber.

Similar reference characters refer to similar parts throughout the several Figures of the drawings.

DETAILED DISCUSSION

FIG. 1 is an isometric view of a first embodiment of an apparatus 5 for drawing continuous metallic wire 10 incorporating the present invention. The apparatus 5 transforms the metallic wire 10 having a first diameter 11 into a drawn metallic fiber 10F having a second diameter 12. The apparatus 5 of the present invention is capable of reducing the metallic wires 10 into metallic fiber 10F having less than one-third of the diameter of the metallic wires 10 during a single processing technique. Through the use of multiple processing techniques, the apparatus 5 of the present invention is capable of reducing the metallic wires 10 having the first diameter 11 of 250 microns (μm) into the drawn metallic fiber 10F having the second diameter 12 of 25 microns (μm).

The apparatus 5 comprises a wire supply 20 including a feed spool 25 rotatably mounted on a feed spool spindle 26. The feed spool 25 contains a quantity of the wire 10 having the first diameter 11. The feed spool 25 is free to rotate about the feed spool spindle 26 with minimum drag.

A feed mechanism 30 comprises a first and a second feed roller 31 and 32 having first and second cylindrical surfaces 31A and 32A. The first feed roller 31 is driven by a first roller shaft 33 in a clockwise direction (viewed from above).

5

The second feed roller **32** is driven by a second roller shaft **34** in a counterclockwise direction (viewed from above). The first and second feed roller shafts **33** and **34** are driven by a feed motor (not shown) at a constant speed. Preferably, the feed motor (not shown) may be adjusted to vary the rotational speed of the first and second feed rollers **31** and **32**.

The metallic wire **10** is threaded between the first and second cylindrical surfaces **31A** and **32A** of the first and second feed rollers **31** and **32**. Preferably, the relative positions of the first and second feed rollers **31** and **32** may be adjusted to ensure proper engagement with the wire **10**.

The first and second cylindrical surfaces **31A** and **32A** engage with the metallic wire **10** to linearly move the wire **10** upon rotation of the first and second feed rollers **31** and **32**. The adjustment of the rotational speed of the first and second feed rollers **31** and **32** provides an optimum first linear velocity of the wire **10** through the first and second feed rollers **31** and **32**.

The apparatus **5** comprises a chamber **40** having an entry orifice **41** and an exit orifice **42**. The chamber **40** defines an interior region **43** interposed between the entry orifice **41** and the exit orifice **42**. A fluid inlet port **44** communicates with the chamber **40**. Preferably, a fluid **45** is introduced through the fluid inlet port **44** into the chamber **40**.

The wire supply **20** feeds the metallic wire **10** into the entry orifice **41** of the chamber **40**. The metallic wire **10** passes through the interior region **43** of the chamber **40**. The fluid **45** surrounds the metallic wire **10** passing through the interior region **43** of the chamber **40**. The chamber **40** defines a first and a second aperture **46** and **48**.

A laser system **50** generates a first and a second laser beam **51** and **52** for entering into the interior region **43** of the chamber **40** through the first and second apertures **46** and **48**. The first and second laser beams **51** and **52** heat the wire **10** for assisting in the transformation of the wire **10** into the drawn metallic fiber **10F**.

A draw mechanism **60** draws the metallic wire **10** to form the drawn metallic fiber **10F**. The drawn metallic fiber **10F** exits from the exit orifice **42** defined in the chamber **40**. The draw mechanism **60** comprises a first and a second draw roller **61** and **62** having first and second cylindrical surfaces **61A** and **62A**. The first draw roller **61** is driven by a first roller shaft **63** in a clockwise direction (viewed from above). The second draw roller **62** is driven by a second roller shaft **64** in a counterclockwise direction (viewed from above). The first and second feed roller shafts **63** and **64** are driven by a draw motor (not shown) at a constant speed. Preferably, the draw motor (not shown) may be adjusted to vary the rotational speed of the first and second draw rollers **61** and **62**.

The drawn metallic fiber **10F** is threaded between the first and second cylindrical surfaces **61A** and **62A** of the first and second draw rollers **61** and **62**. Preferably, the relative positions of the first and second draw rollers **61** and **62** may be adjusted to ensure proper engagement with the drawn metallic fiber **10F** without slippage.

The first and second cylindrical surfaces **61A** and **62A** engage the drawn metallic fiber **10F** to linearly move the drawn metallic fiber **10F** upon rotation of the first and second draw rollers **61** and **62**. The adjustment of the rotational speed of the first and second draw rollers **61** and **62** provides an optimum second linear velocity of the drawn metallic fiber **10F** through the first and second draw rollers **61** and **62**.

The second linear velocity of the drawn metallic fiber **10F** through the first and second draw rollers **61** and **62** is

6

adjusted relative to the first linear velocity of the wire **10** through the first and second feed rollers **31** and **32** to ensure the proper drawing of the drawn metallic fiber **10F**.

The laser system **50** comprises a laser device **54** powered by a power supply **55** through a connector **56**. In this embodiment of the invention, the laser device **54** utilizes a short wavelength of light that will be absorbed by the surface of the metallic wire **10**. The specific characteristics of the laser device **54** will be described in greater detail hereinafter.

A laser output beam **58** emanates from the laser device **54** and enters a beam splitter **70**. The beam splitter **70** splits the laser output beam **58** into the first and second beams **51** and **52**. The first and second beams **51** and **52** exit in opposite directions from the beam splitter **70** and are reflected to a first and a second lens **71** and **72**.

The first laser beam **51** is reflected by planar reflectors **73** and **75** toward a chamber **40**. The second laser beam **52** is reflected by planar reflectors **74** and **76** toward the chamber **40**. The first and second laser beams **51** and **52** enter into the chamber **40** through the first and the second aperture **46** and **48** defined in the chamber **40** to impinge upon the first and second lens **71** and **72**. The first and second lenses **71** and **72** are shown mounted internal to the chamber **40**. The first and second laser beams **51** and **52** are focused by the first and second lenses **71** and **72** onto a first and a second side of the metallic wire **10** located in the interior region **43** of the chamber **40**.

The metallic wire **10** having the first diameter **11** enters the entry orifice **41** of the chamber **40**. A region **13** of the metallic wire **10** is heated by the first and second laser beams **51** and **52**. The fluid **45** blankets the region **13** of the wire **10** heated by the first and second laser beams **51** and **52**. In this example of the invention, the region **13** of the metallic wire **10** is heated to a visco-elastic temperature. The heating of the region **13** of the wire **10** to a visco-elastic temperature enables the metallic wire **10** to be drawn into the drawn metallic fiber **10F** without the use of a drawing die.

The first and second draw rollers **61** and **62** operate at the second linear velocity that is greater than the first linear velocity of the first and second feed rollers **31** and **32**. The first and second draw rollers **61** and **62** draw the region **13** of the wire **10**. The drawing of the region **13** of the wire **10** elongates the wire **10** having the first diameter **11** into the drawn metallic fiber **10F** having the second diameter **12**. The drawn metallic fiber **10F** exits the chamber **40** through exit orifice **42**.

The drawn metallic fiber **10F** enters an annealing oven **80** through an entry port **81**. The drawn metallic fiber **10F** passes through the annealing oven **80** and exits from an exit port **82**. The drawn metallic fiber **10F** is annealed within the annealing oven **80**.

A take-up mechanism **90** comprises a take-up spool **92** for receiving the drawn metallic fiber **10F**. The take-up spool **92** is rotated by a take up spool shaft **94** driven by take up spool motor (not shown). Preferably, take-up spool **92** is driven to maintain a slight tension on the drawn metallic fiber **10F**. A guide roller **96** freely rotates about guide roller spindle **98** to ensure the linearity and orientation of the drawn metallic fiber **10F** as the drawn metallic fiber **10F** traverses the annealing oven **80**.

The relationship between the first linear velocity of the first and second feed rollers **31** and **32** and the second linear velocity of the first and second draw rollers **61** and **62** in conjunction with the heat applied by the first and second laser beams **51** and **52** determine the amount of elongation or drawing of the drawn metallic fiber **10F** from the wire **10**. This specific relationship will be discussed in greater hereafter.

The fluid **45** within the chamber **40** provides a controlled environment during the heating of the metallic wire **10**. The fluid **45** may be a gas or a vapor depending upon any desired chemical reaction to take place within the chamber **40**. Preferably, an inert gas is used as the fluid **45** when the chamber **40** is merely used to provide the controlled environment during the heating of the metallic wire **10**. The inert gas may be selected from the group consisting of nitrogen, argon or a nitrogen argon mixture. In the alternative, the inert gas may be virtually any inert gas.

A specialized fluid is used as the fluid **45** when the chamber **40** is used to provide a chemical reaction within the chamber **40**. The specialized fluid may be a reactive gas, a partially reactive gas, an organic gas or a vapor containing a metal organic compound. The type of metallic wire **10** and the type of specialized fluid **45** is determined by the chemical reaction desired by the user.

FIG. **2** is an isometric view of a second embodiment of an apparatus **105** for drawing continuous metallic wire **110** incorporating the present invention. The apparatus **105** comprises a wire supply **120** including a feed spool **125** rotatably mounted on a feed spool spindle **126**. The feed spool **125** contains the metallic wire **110** having the first diameter **111**.

A feed mechanism **130** comprises a first and a second feed roller **131** and **132** having first and second cylindrical surfaces **131A** and **132A**. The first and second feed rollers **131** and **132** are driven by a first and a second roller shaft **133** and **134** as set forth previously.

The metallic wire **110** is threaded between the first and second cylindrical surfaces **131A** and **132A** of the first and second feed rollers **131** and **132** to linearly move the wire **110** upon rotation of the first and second feed rollers **131** and **132** at a first linear velocity.

The apparatus **105** comprises a chamber **140** having an entry orifice **141** and an exit orifice **142**. The chamber **140** defines an interior region **143** interposed between the entry orifice **141** and the exit orifice **142**. A fluid inlet port **144** communicates with the chamber **140** for introducing a fluid **145** into the chamber **140**. The chamber **140** defines an aperture **146**.

In this example of the invention, a drawing die **148** is located within the chamber **140**. The drawing die **148** comprises a drawing aperture **149** for drawing the metallic wire **110** to form the drawn metallic fiber **110F**.

The wire supply **120** feeds the metallic wire **110** into the entry orifice **141** of the chamber **140**. The metallic wire **110** passes through the drawing aperture **149** of the drawing die **148** located within the interior region **143** of the chamber **140**. The fluid **145** surrounds the metallic wire **110** passing through the interior region **143** of the chamber **140**.

A laser system **150** generates a laser beam **151** for heating the wire **110** for assisting in the transformation of the wire **110** into the drawn metallic fiber **110F**. The laser system **150** comprises a laser device **154** powered by a power supply **155** through a connector **156**. The laser beam **151** emanates from the laser device **154** and is reflected into the chamber **140** through the aperture **146**.

The draw mechanism **160** comprises a first and a second draw roller **161** and **162** having first and second cylindrical surfaces **161A** and **162A**. The first and second draw rollers **161** and **162** are driven by a first and a second roller shaft **163** and **164** as set forth previously.

The metallic drawn metallic fiber **110F** is threaded between the first and second cylindrical surfaces **161A** and **162A** of the first and second draw rollers **161** and **162**. The

first and second cylindrical surfaces **161A** and **162A** engage the drawn metallic fiber **110F** to linearly move the drawn metallic fiber **110F** upon rotation of the first and second draw rollers **161** and **162** at a second linear velocity. The second linear velocity of the drawn metallic fiber **110F** through the first and second draw rollers **161** and **162** is adjusted relative to the first linear velocity of the wire **110** through the first and second feed rollers **131** and **132**.

FIG. **3** is an enlarged side view of a portion of FIG. **2**. The laser beam **151** is reflected by a planar reflector **175** through the aperture **146** to a first lens **171** located within the chamber **140**. The first lens **171** focuses a first portion **151A** of the laser beam **151** onto a first side **110A** of the metallic wire **110**. A second portion **151B** of the laser beam **151** passes along side of the metallic wire **110**. The second portion **151B** of the laser beam **151** passes above and below the metallic wire **110** and impinges upon a parabolic reflector **172**. The parabolic reflector **172** focuses the second laser beam **151B** onto a second side **110B** of the metallic wire **110**.

The metallic wire **110** is heated by the first and second laser beams **151A** and **151B** focused on the first and second sides **110A** and **110B** of the wire **110**. In this example of the invention, a region **113** of the metallic wire **110** is heated to a temperature sufficient for enabling the drawing die **148** to draw the metallic wire **110** to form the drawn metallic fiber **110F**. Preferably, the region **113** of the metallic wire **110** is heated below a visco-elastic temperature.

The first and second draw rollers **161** and **162** operate at a second linear velocity that is greater than the first linear velocity of the first and second feed rollers **131** and **132**. The first and second draw rollers **161** and **162** draw the wire **110** through the drawing aperture **149** for drawing die **148**. The drawing of the wire **110** through the drawing aperture **149** for drawing die **148** elongates the wire **110** having the first diameter **111** into the drawn metallic fiber **110F** having the second diameter **112**.

The drawn metallic fiber **110F** is annealed in an annealing oven **180** as set forth previously. A take-up mechanism **190** comprises a take-up spool **192** for receiving the drawn metallic fiber **110F** from the annealing oven **180**.

FIG. **4** is an isometric view of a third embodiment of an apparatus **205** for drawing continuous metallic wire **210** incorporating the present invention. The apparatus **205** transforms the metallic wire **210** having a first diameter **211** into a drawn metallic fiber **210F** having a second diameter **212**.

The apparatus **205** comprises a wire supply **220** including a feed spool **225** rotatably mounted on a feed spool spindle **226**. The feed spool **225** contains a quantity of the wire **210** having the first diameter **211**.

A feed mechanism **230** comprises a first and a second feed roller **231** and **232** having first and second cylindrical surfaces **231A** and **232A**. The first feed roller **231** is driven by a first roller shaft **233** by a feed motor **235**. The speed of the feed motor **235** is adjusted by a control module **300** through a control cable **238** to provide optimum first linear velocity as will be further discussed.

The second feed roller **232** is an idler roller being rotatable on a second roller shaft **234**. A feed roller tension adjustment **239** is provided to enable optimum tension between first and second feed rollers **231** and **232** for engaging the wire **210** therebetween. The first and second cylindrical surfaces **231A** and **232A** engaged with the wire **210** to linearly move the wire **210** upon rotation of the first and second feed rollers **231** and **232**.

The wire **210** having a first diameter **211** traverses a feed diameter sensor **310** for measuring the first diameter **211** of

the wire **210**. The feed diameter sensor **310** supplies a signal to the control module **300** through a cable **318** of the measured first diameter **211** of the wire **210**.

The apparatus **205** comprises a chamber **240** having an entry orifice **241** and an exit orifice **242**. The chamber **240** defines an interior region **243** interposed between the entry orifice **241** and the exit orifice **242**. A fluid inlet port **244** communicates with the chamber **240** for introducing a fluid **245** into the chamber **240**.

The wire supply **220** feeds the metallic wire **210** into the entry orifice **241** of the chamber **240**. The wire **210** passes through the interior region **243** of the chamber **240** with the fluid **245** surrounding the metallic wire **210**. The chamber **240** defines a first and a second aperture **246** and **248**. The specific structure of the chamber **240** will be described in greater detail hereinafter.

A laser system **250** generates a first and a second laser beam **251** and **252** for entering into the interior region **243** of the chamber **240** through the first and second apertures **246** and **248**. The first and second laser beams **251** and **252** heat the wire **210** for assisting in the transformation of the wire **210** into the drawn metallic fiber **210F**.

A draw mechanism **260** draws the drawn metallic fiber **210F** from the exit orifice **242** defined in the chamber **240**. The draw mechanism **260** comprises a first and a second draw roller **261** and **262** having first and second cylindrical surfaces **261A** and **262A**. The first draw roller **261** is driven by a first roller shaft **263** by a draw motor **266**. The speed of the draw motor **266** is adjusted by control module **300** through a control cable **268** to provide optimum second linear velocity as will be further discussed.

The second draw roller **262** is an idler roller being rotatable on a second roller shaft **264**. A draw roller tension adjustment **269** is provided to enable optimum tension between first and second draw rollers **261** and **262** for engaging the metallic fiber **210F** therebetween. The first and second cylindrical surfaces **261A** and **262A** engaged with the drawn metallic fiber **210F** to linearly move the metallic fiber **210F** upon rotation of the first and second draw rollers **261** and **262**.

The linear velocity of the drawn metallic fiber **210F** through the first and second draw rollers **261** and **262** is adjusted relative to the linear velocity of the wire **210** through the first and second feed rollers **231** and **232** by the control module **300** to ensure the proper drawing of the drawn metallic fiber **210F**.

The laser system **250** comprises a laser device **254** powered by a power supply **255**. A laser output beam **258** emanates from the laser device **254** and enters a beam splitter **270**. The beam splitter **270** splits the laser output beam **258** into the first and second beams **251** and **252**. The first beam **251** is reflected toward the chamber **240** by planar reflectors **273–275**. The second beam **252** is directed toward the chamber **240**. The first and second laser beams **251** and **252** enter into the chamber **240** through the first and second apertures **246** and **248** to impinge upon a first and a second side **210A** and **210B** of the metallic wire **210** located in the interior region **243** of the chamber **240**.

The wire **210** having the first diameter **211** enters the entry orifice **241** of the chamber **240** and a region **213** of the wire **210** is heated to a visco-elastic temperature by the first and second laser beams **251** and **252** focused on the first and second sides **210A** and **210B** of the wire **210**. The fluid **245** blankets the region **213** of the wire **210** heated by the first and second laser beams **251** and **252**.

The first and second draw rollers **261** and **262** operate at a second linear velocity that is greater than the first linear

velocity of the first and second feed rollers **231** and **232**. The drawing of the region **213** of the wire **210** elongates the wire **210** having the first diameter **211** into the drawn metallic fiber **210F** having the second diameter **212**. The drawn metallic fiber **210F** exits the chamber **240** through exit orifice **242**.

The drawn metallic fiber **210F** enters an optional finishing die **320**. The optional finishing die **320** provides a very uniform second diameter **212** to the drawn metallic fiber **210F**. In addition, the optional finishing die **320** finishes the surface of the second diameter **212** of the drawn metallic fiber **210F**.

The optional finishing die **320** provides additional cooling of the drawn metallic fiber **210F**.

The mass of the optional finishing die **320** transfers heat from the drawn metallic fiber **210F** for substantially reducing the temperature of drawn metallic fiber **210F**. Alternately, an independent temperature control and cooling system may be used.

The drawn metallic fiber **210F** having the second diameter **212** traverses a second diameter sensor **330** for measuring the second diameter **212** of the metallic fiber **210F**. The second diameter sensor **330** supplies a signal to the control module **300** through a cable **338** of the measured second diameter **212** of the metallic fiber **210F**.

The drawn metallic fiber **210F** enters an annealing oven **280** through an entry port **281**. The drawn metallic fiber **210F** passes through the annealing oven **280** and exits from an exit port **282**. The drawn metallic fiber **210F** is annealed within the annealing oven **280**. The temperature of the annealing oven **280** is controlled by the control module **300** through a cable **288**. Alternately, an independent temperature control and cooling system may be used.

The annealed drawn metallic fiber **210F** having the second diameter **212** traverses a tension sensor **340** for measuring the tension applied to the metallic fiber **210F** by a take-up mechanism **290**. The tension sensor **340** supplies a signal to the control module **300** through a cable **348** for controlling the take-up mechanism **290**.

A take-up mechanism **290** comprises a take-up spool **292** for receiving the drawn metallic fiber **210F**. The take-up spool **292** is rotated by a take up spool shaft **294** driven by take up spool motor **295**. The spool motor **295** is controlled by the control module **300** through a control cable **299**. Preferably, take-up spool **292** is driven to maintain a slight tension on the drawn metallic fiber **210F**. A guide roller **296** freely rotates about guide roller spindle **298** to ensure the linearity and orientation of the drawn metallic fiber **210F** as the drawn metallic fiber **210F** traverses the annealing oven **280**.

The relationship between the first linear velocity of the first and second feed rollers **231** and **232** and the second linear velocity of the first and second draw rollers **261** and **262** in conjunction with the heat applied by the first and second laser beams **251** and **252** determine the amount of elongation or drawing of the drawn metallic fiber **210F** from the wire **210**. This specific relationship will be discussed in greater hereafter.

FIGS. 5–8 are enlarged views of the chamber **240** shown in FIG. 4. The entry orifice **241** and the exit orifice **242** include an elongated entry groove **241G** and an elongated exit groove **242G**. A fluid inlet port **244** introduces the fluid **245** into the interior region **243** interposed between the entry orifice **241** and the exit orifice **242** of the chamber **240**. The fluid **245** provides a positive pressure within the interior region **243** of the chamber **240**. The fluid **245** flows through

the elongated entry groove **241G** to be discharged from the entry orifice **241**. Similarly, the fluid **245** flows through the elongated exit groove **242G** to be discharged from the exit orifice **242**.

The first and second laser beams **251** and **252** enter into the chamber **240** through the first and second apertures **246** and **248**. Preferably, the first and second apertures **246** and **248** are covered with a first and a second window **246W** and **248W** that are substantially transparent to the first and second laser beams **251** and **252**. The first and second laser beams **251** and **252** impinge upon the first and second sides **210A** and **210B** of the metallic wire **210** located in the interior region **243** of the chamber **240**.

The wire **210** is heated to a visco-elastic temperature by the first and second laser beams **251** and **252** focused on the first and second sides **210A** and **210B** of the wire **210**. The fluid **245** blankets the region **213** of the wire **210**.

The fluid **245** flowing through the elongated entry groove **241G** provides a fluid bearing between the wire **210** and the elongated entry groove **241G**. The fluid **245** flowing through the elongated entry groove **241G** centers the wire **210** within the elongated entry groove **241G** as shown in FIG. 7.

The fluid **245** flowing through the elongated exit groove **242G** provides a fluid bearing between the drawn metallic fiber **210F** and the elongated exit groove **242G**. The fluid **245** flowing through the elongated exit groove **242G** centers the drawn metallic fiber **210F** within the elongated entry groove **242G** as shown in FIG. 8.

The fluid **245** flowing through the elongated exit groove **242G** cools the drawn metallic fiber **210F** within the elongated exit groove **242G**. The elongated exit groove **242G** acts as a cooling chamber with the cooling being effected by the fluid **245** flowing through the elongated entry groove **241G**.

The fluid **245** flowing through the elongated entry groove **241G** and the elongated exit groove **242G** prevent contact of the metallic wire **210** and/or the metallic fiber **210F** with the chamber **240**. The non-contact of the metallic wire **210** and/or the metallic fiber **210F** with the chamber **240** eliminates the possibility of contamination of the metallic wire **210** and/or the metallic fiber **210F**.

FIG. 9 illustrates a block diagram of the third embodiment of the apparatus **205** for drawing continuous metallic wire **210** incorporating the present invention. A control module **300** is interfaced to the components of the apparatus **205** as set forth previously.

The wire **210** having the first diameter **211** is pulled from the wire supply **220** by the feed mechanism **230** and fed through the first diameter sensor **310**. The control module **300** monitors the first diameter **211** from the first diameter sensor **310**.

The wire **210** having a first diameter **211** enters chamber **240** filled with the fluid **245**. The laser system **250** heats the region **213** of the wire to a visco-elastic temperature. The output of the laser system **250** is controlled by the control module **300**.

The draw mechanism **260** operates at the second linear velocity that is greater than the first linear velocity of the feed mechanism **230**. The first and second linear velocities of the feed mechanism **230** and the draw mechanism **260** are controlled by the control module **300**. The control of the first and second linear velocities in combination with the control of the output of the laser system **250** controls the elongation or drawing of the metallic fiber **210F** from the wire **210**.

The drawn metallic fiber **210F** enters the annealing oven **280** controlled by the control module **300**. The drawn

metallic fiber **210** enters the tension sensor **340** for controlling the take-up mechanism **290**.

The utilization of the control module **300** interfaced throughout the apparatus **205** enables process optimization by variation of the control module **300** algorithms. Any variables in the wire **210** (raw material) having a first diameter **211** are easily compensated during the process resulting in higher quality continuous metallic fiber **210F** (product).

FIGS. 10–14 are various views of illustrating the transformation of a composite wire **410** into an metallic alloy or an intermetallic fiber **410F**. The composite wire **410** comprises an inner wire component **410A** and an outer component **410B**. The outer component **410B** may be applied to the inner wire component **410A** by electroplating process, a sheathing process, a tube filling process or any other suitable process.

Preferably, an inner wire component **410A** is form from a different material then the outer component **410B** to form a desired metallic alloy or intermetallic material **410C**. The composite wire **410** containing the inner wire component **410A** and the outerwear component **410B** are transformed by heating and drawing into an metallic fiber **410F** having a surface formed from the metallic alloy or intermetallic material **410C**.

In this example of the invention, the heating of the region **413** of the composite wire **410** provides two operations that occurring at the time. First, the composite wire **410** is heated to a visco-elastic temperature for allowing the drawing of the composite wire **410** to form the fiber **410F**. Second, the composite wire **410** is heated to a temperature to diffuse the outer wire component **410B** into the surface of the inner wire component **410A**.

The process of forming the metallic alloy or intermetallic material **410C** has been illustrated the formation of the alloy material **410C** on the surface of the metallic fiber **410F**. However, it should be understood that the process may be adapted to provide an interface diffusion or a homogeneous alloy.

FIG. 12 illustrates the composite wire **410** having a first diameter **411** defines by a radius R_1 . FIG. 14 illustrates the drawn fiber **410F** having a second diameter **412** defines by a radius R_2 . The radius R_2 of the drawn fiber **410F** is approximately 0.4 the radius R_1 of the composite wire **410**.

The cross-sectional area of the composite wire **410** and the drawn fiber **410F** may be given by the well known formula:

$$A=\pi R^2$$

where A is the cross-sectional area and R is the radius. Since the radius R_2 of the drawn fiber **410F** is approximately one-third the radius R_1 of the composite wire **410**, the cross-sectional area of the drawn fiber **410F** is sixteen percent (16%) the cross-sectional area of the composite wire **410**. The process of the present invention provides a substantial savings when the process is application the making metallic fibers of precious metals such as gold, platinum and the like.

FIG. 15 illustrates the model geometry for the laser heated metallic fiber drawing process of the present invention. The first and second laser beams **51** and **52** intercept the first and second sides **10A** and **10B** of the wire **10** having a first diameter **11** to heat the region **13** of the wire **10** to a visco-elastic temperature. The wire **10** having the first diameter **11** is drawn or elongated to provide metallic fiber **10F** having a second diameter **12**.

13

FIG. 15 illustrates the metallic fiber temperature increases to a maximum at T and reduces to T_0 . The metallic fiber velocity starts at V_1 and increases to a final velocity V_0 . As the visco-elastic temperature reaches a maximum the metallic fiber velocity begins to increase and temperature then begins to decrease. If incident laser power is exclusively utilized to heat the metallic fiber, then the product of the incident laser power and the absorptivity of the metallic fiber determine the maximum velocity achievable in the drawing process. Mass conservation ensures that the metallic fiber diameter is reduced as the square root of the ratio of the constant feed linear metallic fiber velocity to the constant draw linear metallic fiber velocity.

FIG. 16 illustrates the wavelength vs. percent reflectivity for gold. Absorptivity is strongly dependent on laser wavelength. Gold is highly reflective at wavelengths greater than 600 nm. The highest absorptivity occurs at less than 400 nm (approximately 25 percent reflectivity at 0.4 microns).

FIG. 17 illustrates maximum feeding speed in meters per second vs. incident laser power in watts for an Nd:YAG laser, frequency doubled and frequency tripled. The metallic fiber material is gold with a 100 micron diameter. The absorptivity for the Nd: YAG laser (1064 nm) is 3% for frequency doubled (532 nm) absorptivity increase to 32% and for frequency tripled, (355 nm) the absorptivity is 72%.

FIG. 18 illustrates the maximum daily output in kg per 8 hours vs. incident laser power in watts. The metallic fiber material is gold and the ND: YAG laser, frequency doubled and frequency tripled are also illustrated. For a frequency tripled Nd: YAG laser processing 100 micron gold metallic fiber, laser powers of 50, 100, and 200 watts would process 10.4, 20.8, and 41.6 kg per 8 hour day.

Preferably, the type of laser is selected on the basis of a wavelength of light that will be absorbed by the surface of the metallic wire 10 or any coating on the surface of a composite metallic wire 410. Conventional lasers such as Nd:YAG, EXCIMER or CO_2 lasers may be used with the present invention. Although the laser system has been shown to provide a first and a second laser beam, it should be understood that the apparatus of the present invention may utilize a single laser beam.

EXAMPLE I

The process may be used for ductile metals including gold and gold alloys, platinum and platinum alloys, palladium and palladium alloys, nickel and nickel alloys and iron and iron alloys, titanium and titanium alloys, aluminum and aluminum alloys, copper and copper alloys. The process can also be used to process intermetallics and ceramic surface modified metal metallic fibers. The process also is suitable for rapid proto-typing of metal metallic fiber compositions and ceramic-metal metallic fiber compositions of various sizes and shapes.

EXAMPLE II

The laser metallic fiber process can be used to directly make alloys by diffusion of a surface metal layer into a substrate wire metal concurrent with the deformation by the laser metallic fiber drawing process. In this example, 6–15% by weight Copper electroplated or clad Nickel wire is prepared. Laser processing in the laser metallic fiber processing apparatus promotes the diffusion of copper into the adjacent nickel region resulting in a 50% by weight Copper-50% by weight Nickel alloy region approaching a Monel like composition. Like compositions are highly corrosion resistant to fluorides.

14

EXAMPLE III

In another example, a 6% by weight Gold electroplating on Nickel is processed in the apparatus to produce a gold-nickel surface alloy, for example 50% by weight gold and 50% by weight Nickel surface region concurrently with diameter reduction. These compositions provide jewelry optical quality appearance (14 Kt gold) and improve electrical conductivity.

EXAMPLE IV

Intermetallic compositions can be obtained by a controlled conversion where a surface metal is diffused into a substrate wire metal. An aluminum plating, coating or clad is prepared on a nickel substrate. The aluminum diffuses into the nickel surface region concurrently with the composite diameter reduction by the laser metallic fiber drawing process. A 6–15% by weight Aluminum surface layer diffuses into the nickel wire substrate creating, for example, a 50% by weight Aluminum-50% by weight Nickel aluminide intermetallic surface region. Nickel can be replaced by Iron or Titanium to create Iron aluminides and Titanium aluminides.

EXAMPLE V

Wear resistant and electrically conductive ceramic surfaces can be created on metals by the process of the present invention.

Processing titanium wire in a nitrogen atmosphere (N_2) within the chamber during the laser heated drawing process creates a titanium nitride (TiN) surface coating that is electrically conductive and wear resistant.

Processing titanium wire in an oxygen atmosphere (O_2) within the chamber during the laser heated drawing process creates a titanium oxide (TiO) surface coating.

Processing titanium wire in a methane atmosphere (CH_4) within the chamber during the laser heated drawing process creates a titanium carbide (TiC) surface coating.

Processing titanium wire in a diborane atmosphere within the chamber during the laser heated drawing process creates a titanium boride (TiB_2) surface coating.

EXAMPLE VI

A small diameter ceramic pipe may be fabricated by the process of the present invention. For example, processing titanium wire in an oxygen atmosphere (O_2) within the chamber during the laser heated drawing process creates a titanium oxide (TiO) surface coating. The metallic titanium wire is removed by a chemical or electrochemical process leaving the titanium oxide (TiO) surface coating in the form of a small diameter pipe.

EXAMPLE VII

Various type of metal to metal diffusion can be created with the process of the present invention.

The controlled conversion of a surface metal coating is diffused into a substrate metallic wire. The conversion process may be controlled to provide (1) a surface alloy, or (2) an interface diffusion, or (3) a homogeneous alloy.

In the surface alloy, the surface metal coating is diffused only into the surface of the substrate metallic wire and the interior of the substrate metallic wire remains unchanged.

In the interface diffusion, the surface metal coating is bonded to the substrate metallic wire by diffusion between

15

the surface metal coating and the substrate metallic wire. The exterior of the surface metal coating and the interior of the substrate metallic wire remain unchanged.

In the homogeneous alloy, the surface metal coating is diffused through the substrate metallic wire.

EXAMPLE VIII

Fibers with a catalytic active surface can be created with the process of the present invention.

A surface coating of a catalytic active material may be applied to the surface of a substrate metallic wire. The drawing fiber is formed with a surface coating of the catalytic active material. These catalytic active materials may include Platinum and Cobalt decomposed from metallo-organics during laser radiation.

The present apparatus provides an improved method and apparatus for providing continuous metallic fibers. The process eliminates the need for a bundled drawing and leaching process as required by the prior art. The present apparatus and method produces chemically clean metallic fibers with no contamination. In many examples, the cross-sectional area of the metallic metallic fibers can be reduced by more than 75 percent. Greater reductions may be obtained through the use of multiple or serial processing steps.

The present apparatus provides for the production of continuous metallic fibers made of alloy materials. The process may be used for providing gold, gold alloys, platinum alloys, palladium alloys, stainless-steel and nickel and nickel alloys. The process also is suitable for rapidly prototyping of metallic fibers of various sizes and shapes.

Although the invention has been described in its preferred form with a certain degree of particularity, it is understood that the present disclosure of the preferred form has been made only by way of example and that numerous changes in the details of construction and the combination and arrangement of parts may be resorted to without departing from the spirit and scope of the invention.

What is claimed is:

1. An apparatus for drawing a continuous wire having a first diameter to provide a fiber having a reduced second diameter, comprising:

a chamber having an entry orifice and an exit orifice communicating with an interior region of said chamber; a feed mechanism and a draw mechanism located adjacent to said entry orifice and said exit orifice, respectively said feed mechanism for moving the continuous wire at a first linear velocity into said entry orifice of said chamber;

a laser beam for heating a region of the continuous wire within the chamber;

said draw mechanism for drawing the heated continuous wire at a second and higher linear velocity from said exit orifice of said chamber for providing a drawn fiber having a second diameter; and

a fluid inlet port defined in said chamber for receiving a pressurized fluid atmosphere for enveloping said region of the continuous wire during said heating of the continuous wire and for exiting said entry orifice and said exit orifice for providing a entry fluid bearing for the continuous wire within said entry orifice and for providing a exit fluid bearing for the drawn metallic fiber within said exit orifice; and

said pressurized fluid atmosphere cooling said drawn fiber within said chamber prior to exiting from said exit orifice of said chamber.

16

2. An apparatus for drawing a fiber as set forth in claim 1, wherein said fluid atmosphere is a gas atmosphere.

3. An apparatus for drawing a fiber as set forth in claim 1, wherein said feed and said draw mechanism comprises a feed capstan drive and a draw capstan drive, respectively.

4. An apparatus for drawing a fiber as set forth in claim 1, wherein said entry fluid bearing and said exit fluid bearing are the sole supports of said continuous wire and said drawn fiber between said entry orifice and said exit orifice.

5. An apparatus for drawing a fiber as set forth in claim 1, wherein said laser beam comprises a laser for generating a laser output beam; and

a beam splitter for dividing said laser output beam into a first laser beam and a second laser beam for impinging upon a first and a second side of the continuous wire.

6. An apparatus for drawing a fiber as set forth in claim 1, wherein said laser beam has a first diameter that is greater than a diameter of the continuous wire;

a lens for focusing a first portion of said laser beam onto a first side of the continuous wire with a second portion of said laser beam passing along side of the continuous wire; and

a reflector for directing said second portion of said laser beam onto a second side of the continuous wire.

7. An apparatus for drawing a fiber as set forth in claim 1, wherein said laser beam comprises has a first diameter that is at least 1.42 times a diameter of the continuous wire;

a lens for focusing a first portion of said laser beam onto a first side of the continuous wire with a second portion of said laser beam passing along side of the continuous wire; and

a reflector for directing said second portion of said laser beam onto a second side of the continuous wire.

8. An apparatus for drawing a fiber as set forth in claim 1, including an annealing oven for annealing the fiber.

9. An apparatus for drawing a continuous wire having a first diameter to provide a fiber having a reduced second diameter of equal to or less than 100 micrometers, comprising:

a chamber having an entry orifice and an exit orifice communicating with an interior region of said chamber; a feed mechanism and a draw mechanism located adjacent to said entry orifice and said exit orifice, respectively said feed mechanism for moving the continuous wire at a first linear velocity into said entry orifice of said chamber;

a laser beam for heating a region of the continuous wire within the chamber;

said draw mechanism for drawing the heated continuous wire at a second and higher linear velocity from said exit orifice of said chamber for providing a drawn fiber having a second diameter; and

a gas inlet port defined in said chamber for receiving a pressurized gas atmosphere for enveloping said region of the continuous wire during said heating of the continuous wire and for exiting said entry orifice and said exit orifice for providing a gas bearing for the continuous wire within said entry orifice and for providing a gas bearing for the drawn fiber within said exit orifice; and

said pressurized gas atmosphere cooling said drawn fiber within said chamber prior to exiting from said exit orifice of said chamber.

10. An apparatus for drawing a continuous metallic wire having a first diameter to provide a metallic fiber having a reduced second diameter, comprising:

17

a chamber having an entry orifice including an entry groove communicating with an interior region of said chamber;

said chamber having an exit orifice including an exit groove communicating with said interior region of said chamber;

a feed mechanism for moving the continuous metallic wire at a first linear velocity through said entry groove and into said entry orifice of said chamber;

a laser beam for heating a region of the continuous metallic wire within the chamber;

a draw mechanism for drawing the heated continuous metallic wire at a second and greater linear velocity from said exit orifice of said chamber and through said exit groove for providing a metallic fiber having a second diameter;

a fluid inlet port defined in said chamber for receiving a pressurized fluid atmosphere for enveloping the continuous metallic wire within said chamber;

said pressurized fluid atmosphere exiting said entry groove and said exit groove for providing an entry fluid bearing for the continuous wire within said entry orifice and for providing a exit fluid bearing for the drawn metallic fiber within said exit orifice;

said entry fluid bearing and said exit fluid bearing being the sole supports of said continuous wire and said drawn fiber between said entry orifice and said exit orifice; and

said pressurized fluid atmosphere cooling said drawn fiber within said chamber and within said exit groove prior to exiting from said exit orifice of said chamber.

11. An apparatus for drawing a metallic fiber as set forth in claim **10**, wherein said chamber has an entry groove and an exit groove with the continuous metallic wire entering said chamber through said entry groove and with said drawn metallic fiber exiting said chamber through said exit groove; and

18

said chamber having a window substantially transparent to said laser beam for heating said region of the continuous metallic wire within said chamber.

12. An apparatus for drawing a metallic fiber as set forth in claim **10**, wherein the continuous metallic wire is a composite wire having an inner wire component and an outer wire component.

13. An apparatus for drawing a metallic fiber as set forth in claim **10**, including an annealing oven for annealing the drawn metallic fiber.

14. An apparatus for drawing a metallic fiber as set forth in claim **10**, including a control module for controlling said first linear velocity and said second linear velocity for controlling the reduction of said second diameter from said first diameter.

15. An apparatus for drawing a metallic fiber as set forth in claim **10**, including a first sensor and a second sensor for sensing said first diameter of said continuous metallic wire and said second diameter of said metallic fiber; and

a control module connected to said first and second sensors for controlling said first linear velocity and said second linear velocity for controlling the reduction of said second diameter from said first diameter.

16. An apparatus for drawing a metallic fiber as set forth in claim **10**, including a first sensor and a second sensor for sensing said first diameter of said continuous metallic wire and said second diameter of said metallic fiber; and

a control module connected to said first and second sensors for controlling said first linear velocity and said second linear velocity and said laser for controlling the reduction of said second diameter from said first diameter.

* * * * *