



University of Central Florida  
**STARS**

---

[Orange County Voter Registration](#)

[Vital Records of Central Florida](#)

---

1-1-1914

## Orange County Voter Registration, Gotha, District 14, 1914-1928

Orange County

Find similar works at: <https://stars.library.ucf.edu/cfm-voter>  
University of Central Florida Libraries <http://library.ucf.edu>

This Register is brought to you for free and open access by the Vital Records of Central Florida at STARS. It has been accepted for inclusion in Orange County Voter Registration by an authorized administrator of STARS. For more information, please contact [STARS@ucf.edu](mailto:STARS@ucf.edu).

---

### Recommended Citation

Orange County, "Orange County Voter Registration, Gotha, District 14, 1914-1928" (1914). *Orange County Voter Registration*. 62.  
<https://stars.library.ucf.edu/cfm-voter/62>





# General County Register

—FOR—

*Office Copy.*  
*Gotha*

*no. 14.*

District

*Orange*

County

WALKER, EVANS & COGSWELL CO., CHARLESTON, S. C.

*1928*



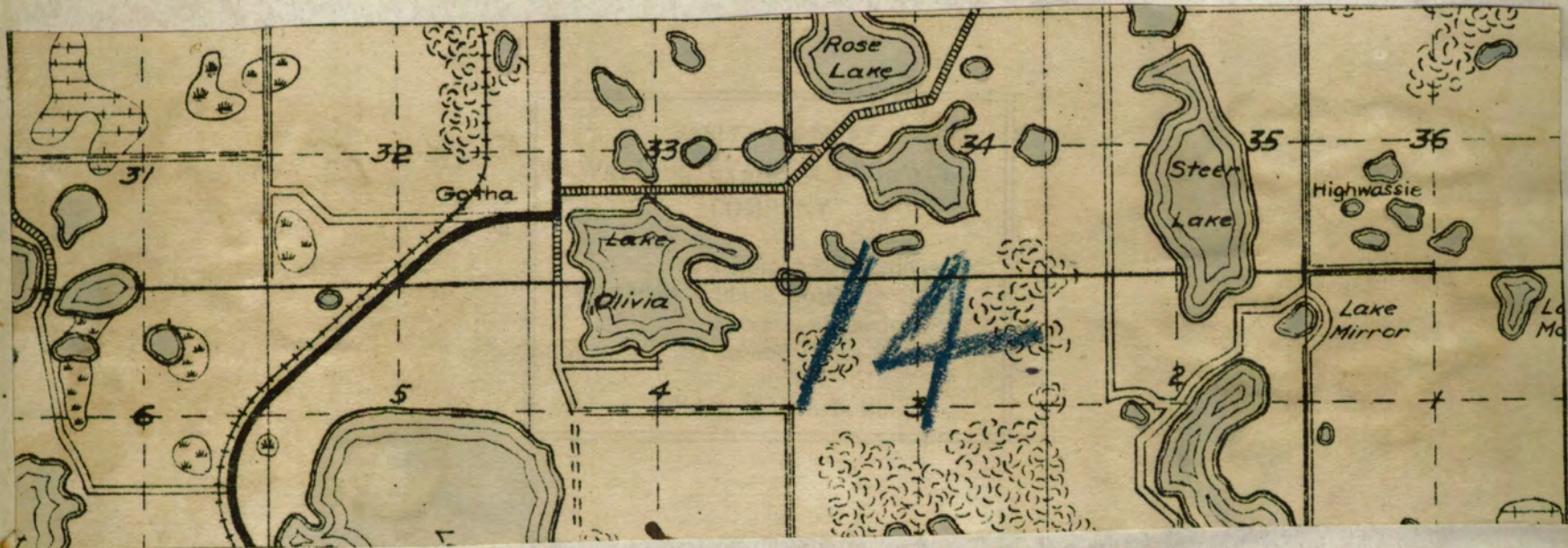

34  
3/0  
7

PRECINCT, COUNTY, FLORIDA

DECLARATION OR  
NATURALIZATION

RESIDENCE

OATH  
I, having been first duly sworn, say, upon  
Oath that the statements here entered  
opposite my name as to qualifica-  
tions as an elector, are true

SIGNATURE OF ELECTOR

SIGNATURE OF  
SUPERVISOR OR DEPUTY

REMARKS

BOOK (83)

1928

A  
B  
C  
D  
E  
F  
G  
H  
I  
J  
K  
L  
M  
N  
O  
P  
Q  
R  
S  
T  
U  
V  
W  
X  
Y  
Z



WALKER, EVANS & COBURN CO., CHARLESTON, S. C.

NUMBER	DATE	SURNAME AND GIVEN NAME	PARTY AFFILIATION	VOTED	POLL TAX		OCCUPATION	AGE	COLOR	NATIVITY	DECLARATION OR NATURALIZATION	RESIDENCE	OATH	SIGNATURE OF SUPERVISOR OR DEPUTY	REMARKS						
													I, having been first duly sworn, say, upon Oath that the statements here entered opposite my name as to qualifications as an elector, are true								
					Year	Year							SIGNATURE OF ELECTOR								
				1926	1927																
		<del>Anderson, Stewart</del>					<del>Bookkeeper</del>	<del>27</del>	<del>W</del>			<del>Gotha</del>									
		<del>Alberry, R.</del>					<del>Laborer</del>	<del>50</del>	<del>C</del>												
		<del>Akers, Sam</del>					<del>"</del>	<del>49</del>	<del>C</del>												
		<del>Akers, Ida</del>					<del>"</del>	<del>31</del>	<del>C</del>												
		<del>Altoffer, Frank E.</del>					<del>Painter</del>	<del>57</del>	<del>W</del>												
	10/6.28	Alvis Nellie					Nurse	41	W.												
	10/6.28	Alvis A. May					Jr.	43	W.												

C  
D  
E  
F  
G  
H  
I  
J  
K  
L  
M  
N  
O  
P  
Q  
R  
S  
T  
U  
V  
W  
X  
Y  
Z

John J. Anderson By: M. L. A.

John J. Anderson

John J. Anderson

John J. Anderson

John J. Anderson

B  
C  
D  
E  
F  
G  
H  
I  
J  
K  
L  
M  
N  
O  
P  
Q  
R  
S  
T  
U  
V  
W  
X  
Y  
Z



WALKER, EVANS & COGSWELL CO., CHARLESTON, S. C.

NUMBER	DATE	SURNAME AND GIVEN NAME	PARTY AFFILIATION	VOTED	POLL TAX		OCCUPATION	AGE	COLOR	NATIVITY	DECLARATION OR NATURALIZATION	RESIDENCE	OATH		SIGNATURE OF SUPERVISOR OR DEPUTY	REMARKS
					Year	Year							I, having been first duly sworn, say, upon Oath that the statements here entered opposite my name as to qualifications as an elector, are true	SIGNATURE OF ELECTOR		
	4/7/14	Belknap, C. P.			Ex	Ex	Retired.	74	W			Gotha.			J. J. Anderson By: M. L. A.	
	2/14/14	Belknap, Alf.			PD.	PD.	Farmer.	35	W						John J. Anderson	
	2/23/14	Bennet, H. W.			PD.	PD.	"	45	W						John J. Anderson	
	4/7/16	Bronson, A. L.			Ex	Ex	"	62	W						John J. Anderson	
	4/24/16	Bronson, W. F.					"	33	W						John J. Anderson	
	4/24/16	Bronson, Clinton.					Carpenter.	33	W						John J. Anderson	
	9/22/20	Boston, Berthe.					Home.	33	W						John J. Anderson	
	7/22/20	Bennin, Ella.			Ph.	Ph.	"	43	W						John J. Anderson	
	7/24/20	Bronson, Alton.					Farmer.	43	W						John J. Anderson	
	9/24/20	Bronson, Carrie.					Home.	39	W						John J. Anderson	
	3/1/26	Bernard, Frank.			Ex	Ex	Farmer.	63	W						John J. Anderson	
	3/22/26	Belknap, H. P.			Ex	Ex	Retired.	84	W						John J. Anderson	
	3/5/28	Bauchman J. W.			PD.	PD.	R. E.	51	W						John J. Anderson	
	3/24/28	Brunson J. E.			Ex	Ex	Farmer	67	W						John J. Anderson	
	3/31/28	Black F. E.			PD	PD	Operator	37	W						John J. Anderson	
	4/28/28	Brunson, Fred.	D.		Ph.	Ph.	Park Attendant.	40	W							
	4/28/28	Brunson, Lizzie.	D.		Ph.	Ph.	Home.	40	W							
	4/30/28	Baker, D. Hines.	D.		Ex	Ex	Retired.	57	W							
	4/30/28	Brunson, A. B.	D.		PD.	PD.	Bus Driver.	28	W							

C  
D  
E  
F  
G  
H  
I  
J  
K  
L  
M  
N  
O  
P  
Q  
R  
S  
T  
U  
V  
W  
X  
Y  
Z



OFFICIAL REGISTER OF ELECTORS FOR

PRECINCT, COUNTY, FLORIDA

WALKER, EVANS & COGSWELL CO., CHARLESTON, S. C.

NUMBER	DATE	SURNAME AND GIVEN NAME	PARTY AFFILIATION	VOTED	POLL TAX		OCCUPATION	AGE	COLOR	NATIVITY	DECLARATION OR NATURALIZATION	RESIDENCE	OATH	SIGNATURE OF SUPERVISOR OR DEPUTY	REMARKS
					I, having been first duly sworn, say, upon Oath that the statements here entered opposite my name as to qualifications as an elector, are true										
					Year	Year							SIGNATURE OF ELECTOR		
					1926	1927									
	<del>7/14/26</del>	<del>Carr, Cora,</del>			<del>4</del>	<del>4</del>	<del>Home.</del>	<del>52</del>	<del>w</del>			<del>Gotha.</del>		<del>J. J. Anderson</del>	<del>By: M. L. A.</del>
	3/1/26	Clanser, M. W.			Pd.	Pd.	Mechanic.	28	w					John J. Anderson	
	4/28/26	Crossley, Mary. W.	D.		Pd.	Pd.	Home.	37	w					John J. Anderson	
	4/30/26	Cochran, J. K.	D.				Real Estate.	42	w.					John J. Anderson	
	3/15/28	Chabot Ed	D.		Pd.	Pd.	Builder	35	w.					John J. Anderson	
	3/28/28	Clouser Gertrude	D.		Ex	Ex	Merchant	22	w.					John J. Anderson	

D  
E  
F  
G  
H  
I  
J  
K  
L  
M  
N  
O  
P  
Q  
R  
S  
T  
U  
V  
W



# OFFICIAL REGISTER OF ELECTORS FOR

PRECINCT, \_\_\_\_\_ COUNTY, FLORIDA

WALKER, EVANS & COWSWELL CO., CHARLESTON, S. C.

NUMBER	DATE	SURNAME AND GIVEN NAME	PARTY AFFILIATION	VOTED	POLL TAX		OCCUPATION	AGE	COLOR	NATIVITY	DECLARATION OR NATURALIZATION	RESIDENCE	OATH		SIGNATURE OF SUPERVISOR OR DEPUTY	REMARKS
					Year	Year							I, having been first duly sworn, say, upon Oath that the statements here entered opposite my name as to qualifications as an elector, are true	SIGNATURE OF ELECTOR		
	3/15/24	Dougherty, Joe.			1926	1927	Engineer.	35	W			Gotha.			J. J. Anderson	
	3/15/24	Dougherty, George.			24	24	"	57	W						John J. Anderson	
	2/10/24	De Vedy, J. E.			24	24	Farmer.	82	W						John J. Anderson	
	7/18/26	Dunlap, Julian C. D.					Road Builder.	30	W						John J. Anderson	
	10/7/26	Davis, J. H.					Representative.	25	W						John J. Anderson	
	10/7/26	Davis, Sallie Mae.					Home.	23	W						John J. Anderson	
	4/29/26	Duke, Henry G. D.					Civil Engineer.	40	W						John J. Anderson	

E  
F  
G  
H  
I  
J  
K  
L  
M  
N  
O  
P  
Q  
R  
S  
T  
U  
V  
W  
Y



# OFFICIAL REGISTER OF ELECTORS FOR

PRECINCT, COUNTY, FLORIDA

WALKER, EVANS & COSEWELL CO., CHARLESTON, S. C.

NUMBER	DATE	SURNAME AND GIVEN NAME	PARTY AFFILIATION	VOTED	POLL TAX		OCCUPATION	AGE	COLOR	NATIVITY	DECLARATION OR NATURALIZATION	RESIDENCE	OATH	SIGNATURE OF SUPERVISOR OR DEPUTY	REMARKS
					Year	Year							I, having been first duly sworn, say, upon Oath that the statements here entered opposite my name as to qualifications as an elector, are true		
					1926	1927									
	11/30/26	Embanks, H. L.	D.				Wood Worker					Giltha.		J. J. Anderson. By: M. L. A.	

F  
C  
H  
I  
J  
K  
L  
M  
N  
O  
P  
Q  
R  
S  
T  
U  
V  
W  
X  
Y



# OFFICIAL REGISTER OF ELECTORS FOR

PRECINCT, COUNTY, FLORIDA

NUMBER	DATE	SURNAME AND GIVEN NAME	PARTY AFFILIATION	VOTED	POLL TAX		OCCUPATION	AGE	COLOR	NATIVITY	DECLARATION OR NATURALIZATION	RESIDENCE	OATH		SIGNATURE OF SUPERVISOR OR DEPUTY	REMARKS
					Year	Year							I, having been first duly sworn, say, upon Oath that the statements here entered opposite my name as to qualifica- tions as an elector, are true	SIGNATURE OF ELECTOR		
	<del>5/25/20</del>	<del>Fulk, William</del>					<del>Farmer</del>	<del>43</del>	<del>W</del>			<del>Gotha</del>			<del>J. J. Anderson</del>	<del>By: M. L. A.</del>
	<del>5/25/20</del>	<del>Fulk, I. L.</del>					<del>Home</del>	<del>47</del>	<del>W</del>						<del>John J. Anderson</del>	
	7/29/22	Fischer, Edw.			X	X	Minister	52	W						<del>John J. Anderson</del>	
	3/3/26	Fanot, Wm. W.					Seaman	36	W						<del>John J. Anderson</del>	
	3/22/26	Fischer, Sophia					Home	44	W						<del>John J. Anderson</del>	
	3/17/28	Fischer Geo H.					Mechanic	24	W						<del>John J. Anderson</del>	
	3/21/28	Fischer Ed. E.					Mechanic	21	W						<del>John J. Anderson</del>	
	3/26/28	Fischer Esther L.					House	27	W						<del>John J. Anderson</del>	

P  
H  
I  
J  
K  
L  
M  
N  
O  
P  
Q  
R  
S  
T  
U  
V  
W  
Y



WALKER, EVANS & COBURN CO., CHARLESTON, S. C.

NUMBER	DATE	SURNAME AND GIVEN NAME	PARTY AFFILIATION	VOTED	POLL TAX		OCCUPATION	AGE	COLOR	NATIVITY	DECLARATION OR NATURALIZATION	RESIDENCE	OATH		SIGNATURE OF SUPERVISOR OR DEPUTY	REMARKS
					Year	Year							I, having been first duly sworn, say, upon Oath that the statements here entered opposite my name as to qualifications as an elector, are true	SIGNATURE OF ELECTOR		
					1926	1927										

10/7. 26.	Gibson H. E.						Farmer	28	W.							
10/7. 26	Gibson Jessie B.						House	26	W.							
3/31. 28	Gatlin S. H.						Farmer	25	W.							
3/31. 28	Gatlin						Farmer	29	W.							
1/5/28	Gatlin L. R.															

John J. Anderson  
 John J. Anderson  
 John J. Anderson  
 John J. Anderson  
 J. B. Mitchell

H  
I  
J  
K  
L  
M  
N  
O  
P  
Q  
R  
S  
T  
U  
V  
W  
Y  
Z



WALKER, EVANS & COGSWELL CO., CHARLESTON, S. C.

NUMBER	DATE	SURNAME AND GIVEN NAME	PARTY AFFILIATION	VOTED	POLL TAX		OCCUPATION	AGE	COLOR	NATIVITY	DECLARATION OR NATURALIZATION	RESIDENCE	OATH		SIGNATURE OF SUPERVISOR OR DEPUTY	REMARKS
					Year	Year							I, having been first duly sworn, say, upon Oath that the statements here entered opposite my name as to qualifications as an elector, are true	SIGNATURE OF ELECTOR		
	2/7/14	Hartman, L.			x	x	Farmer.	68	w			Gotha.			J. J. Anderson. By M. L. A.	
	<del>4/28/10</del>	<del>Haley, Martin L.</del>			<del>x</del>	<del>x</del>	<del>Farmer.</del>	<del>66</del>	<del>w</del>						John J. Anderson	
	<del>7/19/20</del>	<del>Hartman, A. L.</del>			<del>x</del>	<del>x</del>	<del>Laborer.</del>	<del>61</del>	<del>w</del>						John J. Anderson	
	<del>4/25/22</del>	<del>Hiles, C. M.</del>			<del>x</del>	<del>x</del>	<del>Retired.</del>	<del>69</del>	<del>w</del>						John J. Anderson	
	<del>11/2/22</del>	<del>Haley, Maud L.</del>			<del>x</del>	<del>x</del>	<del>Home.</del>	<del>52</del>	<del>w</del>						John J. Anderson	
	<del>10/10/24</del>	<del>Hartman, Antonia.</del>			<del>x</del>	<del>x</del>	<del>"</del>	<del>61</del>	<del>w</del>	Dead					John J. Anderson	
	3/1/26	Harkreader, W. F.					Farmer.	49	w						John J. Anderson	
	3/1/26	Harkreader, L. C.					Home.	30	w						John J. Anderson	
	4/25/28	Headden H. G.	D.		Pd.	Pd.	Teacher	38	w						John J. Anderson	
	4/25/28	Headden Mrs M. E.	D.		Pd.	Pd.	Jr	29	w						John J. Anderson	

I  
J  
K  
L  
M  
N  
O  
P  
Q  
R  
S  
T  
U  
V



# OFFICIAL REGISTER OF ELECTORS FOR

PRECINCT, COUNTY, FLORIDA

WALKER, EVANS & COGSWELL CO., CHARLESTON, S. C.

NUMBER	DATE	SURNAME AND GIVEN NAME	PARTY AFFILIATION	VOTED	POLL TAX		OCCUPATION	AGE	COLOR	NATIVITY	DECLARATION OR NATURALIZATION	RESIDENCE	OATH		SIGNATURE OF SUPERVISOR OR DEPUTY	REMARKS
					I, having been first duly sworn, say, upon Oath that the statements here entered opposite my name as to qualifications as an elector, are true											
					SIGNATURE OF ELECTOR											
					Year	Year										
					1926	1927										
	11/18/24	Johns, Geo. J.			Ex	4.	Farmer	71	W			Gotha			J. J. Anderson. Bk. m. L. A.	
	2/25/24	Journigan, J. G.			PD.	Pd.	Carpenter	38	W						John J. Anderson	
	3/10/28	Journigan Mr. O.			Pd.	Pd.	Farmer	40	W						John J. Anderson	
	3/14/28	Journigan Mrs F. O.			Pd.	Pd.	Wame	29	W						John J. Anderson	

K  
L  
M  
N  
O  
P  
Q  
R  
S  
T  
U  
V  
W  
Y  
Z



# OFFICIAL REGISTER OF ELECTORS FOR

PRECINCT, COUNTY, FLORIDA

WALKER, EVANS & COSEWELL CO., CHARLESTON, S. C.

NUMBER	DATE	SURNAME AND GIVEN NAME	PARTY AFFILIATION	VOTED	POLL TAX		OCCUPATION	AGE	COLOR	NATIVITY	DECLARATION OR NATURALIZATION	RESIDENCE	OATH		SIGNATURE OF SUPERVISOR OR DEPUTY	REMARKS
					Year 1926	Year 1927							I, having been first duly sworn, say, upon Oath that the statements here entered opposite my name as to qualifications as an elector, are true	SIGNATURE OF ELECTOR		
	1/14/14	Keller, Karl.			Ex	Ex	Farmer.	67	W			Gotha.			J. J. Anderson. By: M. L. A.	
	4/1/20	King, W. D.			Ex	Ex	"	63	W						John J. Anderson	
	4/1/20	King, L. F.					"	29	W						John J. Anderson	
	8/5/20	Kline, M.			Ex	Ex	Merchant.	71	W						John J. Anderson	
	4/25/22	Kline, Labor.			Pl.	Pl.	Clerk.	23	W						John J. Anderson	
	3/5/24	Kline, Estelle M.			Ex	Ex	Merchant.	59	W						John J. Anderson	
	4/1/24	Koepper, John.					Mason.	44	W						John J. Anderson	
	4/3/24	Koepper, Rebecca.					Home.	42	W						John J. Anderson	
	4/2/24	Kline, Hazel A.					Secy.	21	W						John J. Anderson	
	3/2/26	Kline, Kathleen			Pl.	Pl.	Sanitation.	24	W						John J. Anderson	
	10/9/26	King, Neal C.					Farmer.	50	W						John J. Anderson	
	10/9/26	King, Rachel V.					Home.	48	W						John J. Anderson	
	3/7/28	Koepper Carl			Ex	Ex	Mason	21	W						John J. Anderson	
	9/4/28	Kinsey Mary			Ex	Ex	Relief	63	W						John J. Anderson	
	9/1/28	Kinsey Clara P.			Ex	Ex	Home	59	W						John J. Anderson	
															Harry M. King	
															Class J. M. King	



# OFFICIAL REGISTER OF ELECTORS FOR

PRECINCT, \_\_\_\_\_ COUNTY, FLORIDA

WALKER, EVANS & COGSWELL CO., CHARLESTON, S. C.

NUMBER	DATE	SURNAME AND GIVEN NAME	PARTY AFFILIATION	VOTED	POLL TAX		OCCUPATION	AGE	COLOR	NATIVITY	DECLARATION OR NATURALIZATION	RESIDENCE	OATH		SIGNATURE OF SUPERVISOR OR DEPUTY	REMARKS
					1926	1927							I, having been first duly sworn, say, upon Oath that the statements here entered opposite my name as to qualifications as an elector, are true			
													SIGNATURE OF ELECTOR			
	<del>4/10/20</del>	<del>Lawrence, Andrew D.</del>			<del>Ex</del>	<del>Ex</del>	<del>Farmer</del>	<del>62</del>	<del>W</del>			<del>Gotha</del>				
	3/13/20	Lawrence, Erless.			Pd.	Pd.	"	41	W						John J. Anderson	
	7/24/20	Lawrence, Minnie.			Ex	Ex	Home.	65	W						John J. Anderson	
	8/16/22	Lawrence, Daisy P.			Pd	Pd	"	41	W						John J. Anderson	
	3/17.28	Lamb <sup>or W.</sup> H. J.			Pd.	Pd.	Farmer	48	W.						John J. Anderson	
	3/26.28	Lamb H. C.			Pd.	Pd.	Farmer	44	W.						John J. Anderson	

J. J. Anderson. Sec. by L. A.  
 John J. Anderson  
 John J. Anderson  
 John J. Anderson  
 John J. Anderson  
 John J. Anderson

M  
N  
O  
P  
Q  
R  
S  
T  
U  
V  
W  
X  
Y  
Z



# OFFICIAL REGISTER OF ELECTORS FOR

PRECINCT, \_\_\_\_\_ COUNTY, FLORIDA

NUMBER	DATE	SURNAME AND GIVEN NAME	PARTY AFFILIATION	VOTED	POLL TAX		OCCUPATION	AGE	COLOR	NATIVITY	DECLARATION OR NATURALIZATION	RESIDENCE	OATH		SIGNATURE OF SUPERVISOR OR DEPUTY	REMARKS
													I, having been first duly sworn, say, upon Oath that the statements here entered opposite my name as to qualifications as an elector, are true	SIGNATURE OF ELECTOR		
					1926	1927										
	4/2/14	Mank, J. A.					Farmer.	40 W				Gotha.			J. J. Anderson	By: M. L. A.
	3/25/18	Mack, Otto.			PD.	PD.	Carpenter.	45 W							John J. Anderson	
	1/13/14	Mohr, J. A.			Ex	Ex	Farmer.	82 W							John J. Anderson	
	2/14/14	Moore, H. C.			Ex	Ex	"	61 W							John J. Anderson	
	4/26/20	Mack, I D.					"	32 W							John J. Anderson	
	7/30/20	Moore, Claressa A.			Ex	Ex	Home.	68 W							John J. Anderson	
	4/2/24	Mack, Lenora.			PD.		"	39 W							John J. Anderson	
	3/15/28	Mack Mrs Otto			PD.	PD.	Heame	42 W.							John J. Anderson	
	10/5/28	Murray Geo B.			Ex	Ex	Pauling	67 W.							John J. Anderson	

N  
O  
P  
Q  
R  
S  
T  
U  
V  
W  
X  
Y  
Z



# ADIRAD, YTHU OFFICIAL REGISTER OF ELECTORS FOR

PRECINCT, COUNTY, FLORIDA

NUMBER	DATE	SURNAME AND GIVEN NAME	PARTY AFFILIATION	VOTED	POLL TAX		OCCUPATION	AGE	COLOR	NATIVITY	DECLARATION OR NATURALIZATION	RESIDENCE	OATH		SIGNATURE OF SUPERVISOR OR DEPUTY	REMARKS
					Year	Year							I, having been first duly sworn, say, upon Oath that the statements here entered opposite my name as to qualifications as an elector, are true	SIGNATURE OF ELECTOR		
	3/18/14	Nehrling, Hy.			1926	1927	Farmer.	20 w				Gotha			J. J. Anderson	
	9/27/20	Nehrling, Bell.					Home.	48 w.								

O  
P  
Q  
R  
S  
T  
U  
V  
W  
Y  
Z



NUMBER	DATE	SURNAME AND GIVEN NAME	PARTY AFFILIATION	VOTED	POLL TAX		OCCUPATION	AGE	COLOR	NATIVITY	DECLARATION OR NATURALIZATION	RESIDENCE	OATH		SIGNATURE OF SUPERVISOR OR DEPUTY	REMARKS
					I, having been first duly sworn, say, upon Oath that the statements here entered opposite my name as to qualifications as an elector, are true											
					Year 1926	Year 1927							SIGNATURE OF ELECTOR			
	1/11/14	Regener, H. A.			Ex	Ex	Farmer.	68	w			Gotha			J. J. Anderson	
	2/7/14	Regener, A. H.			PD.	PD.	"	31	w						John J. Anderson	
	3/2/14	Roberson, W. H.			Ex	Ex	"	61	w						John J. Anderson	
	4/29/16	Roberson, J. W.					"	36	w						John J. Anderson	
	4/1/20	Reaser, A. A.					Carpenter.	44	w						John J. Anderson	
	4/23/20	Rials, J. M.			Ex	Ex	Farmer.	67	w						John J. Anderson	
	8/13/20	Roberson, M.					"	26	w						John J. Anderson	
	9/18/20	Rutledge, Anna B.			Ex	Ex	Home.	58	w						John J. Anderson	
	9/22/20	Reaser, Ala L.					"	36	w						John J. Anderson	
	3/2/14	Roberson, E. D.					Farmer.	32	w						John J. Anderson	
	3/12/14	Regener, Minnie.			PD.	PD.	Home.	33	w						John J. Anderson	
	7/22/24	Rhodes, Augusta	D.		Ex	Ex	Merchant.	53	w						John J. Anderson	
	7/22/24	Rhodes, Fred J.	D.		Ex	Ex	R. Road Man.	56	w						John J. Anderson	
	3/19/26	Roberson, W. H. Jr.		Pd	Pd.	Pd.	Contractor.	22	w						John J. Anderson	
	10/4/26	Roberts, Chas. Victor.			PD.	Pd	Citrus Grower.	24	w						John J. Anderson	
	10/4/26	Roberts, Myrtle M. D.			Pd.	Pd.	Home.	24	w						John J. Anderson	
	3/28.28	Roberson Kathlin	D.		Pd.	Pd.	House	58	w						John J. Anderson	
	3/28.28	Roberson Ella Mae	D		Ex	Ex	Teacher	21	w						John J. Anderson	



NUMBER	DATE	SURNAME AND GIVEN NAME	PARTY AFFILIATION	VOTED	POLL TAX		OCCUPATION	AGE	COLOR	NATIVITY	DECLARATION OR NATURALIZATION	RESIDENCE	OATH		SIGNATURE OF SUPERVISOR OR DEPUTY	REMARKS
					Year	Year							I, having been first duly sworn, say, upon Oath that the statements here entered opposite my name as to qualifications as an elector, are true	SIGNATURE OF ELECTOR		
	8/6/20	Switzer, B. B.			Ex	Ex	Farmer	65	W	Dead		Gotha			J. J. Anderson, Secy. M. L. A.	
	6/2/21	Stone, Geo. J.			Ex	Ex	"	65	W						John J. Anderson	
	3/20/24	Scheffer, Gus.			Ex	Ex	"	64	W						John J. Anderson	
	10/10/24	Seidel, F. H.	D		Ex	Ex		61	W						John J. Anderson	
	10/10/24	Seidel, G. A.	D		Pd.	Pd.		24	W						John J. Anderson	
	4/27/26	Smith, L. U.	D				Real Estate	32	W						John J. Anderson	
	3/17/28	Summers Geo Co.					Mechanic	25	W						John J. Anderson	
	3/30/28	Seidel Anna Wood			Pd.	Pd.	House	27	W						John J. Anderson	
	3/30/28	Seidel Ernestine			Ex	Ex	House	57	W						John J. Anderson	
	3/31/28	Pikarski P.	D		Ex	Ex	Merchant	49	W						John J. Anderson	
	4/3/28	Pikarski Antoinette	D		Ex	Ex	House	43	W						John J. Anderson	Came to Fla March 1927



PRECINCT, ..... COUNTY, FLORIDA

NUMBER	DATE	SURNAME AND GIVEN NAME	PARTY AFFILIATION	VOTED	POLL TAX		OCCUPATION	AGE	COLOR	NATIVITY	DECLARATION OR NATURALIZATION	RESIDENCE	OATH		SIGNATURE OF SUPERVISOR OR DEPUTY	REMARKS
					Year	Year							I, having been first duly sworn, say, upon Oath that the statements here entered opposite my name as to qualifications as an elector, are true	SIGNATURE OF ELECTOR		
	3/28/28	Turner, Geo. H.	D.		1926	1927	Pd. Brick Layer. 52 W.								John J. Anderson	



# OFFICIAL REGISTER OF ELECTORS FOR

PRECINCT, COUNTY, FLORIDA

WALKER, EVANS & DODSWELL CO., CHARLESTON, S. C.

NUMBER	DATE	SURNAME AND GIVEN NAME	PARTY AFFILIATION	VOTED	POLL TAX		OCCUPATION	AGE	COLOR	NATIVITY	DECLARATION OR NATURALIZATION	RESIDENCE	OATH		SIGNATURE OF SUPERVISOR OR DEPUTY	REMARKS
					Year 1926	Year 1927							I, having been first duly sworn, say, upon Oath that the statements here entered opposite my name as to qualifications as an elector, are true	SIGNATURE OF ELECTOR		
	2/7/14	Wilkenings, H. A.			Y	Y	Farmer.	63	W			Both.			J. J. Anderson, By M. L. A.	
	3/4/18	Wichtendahl, Karl.			Pl.	Pl.	"	27	W						John J. Anderson	
	7/20/20	Wichtendahl, Dorothy.			Y	Y	Home.	65	W						John J. Anderson	
	7/29/20	Wilkenings, Emma.			Y	Y	"	52	W						John J. Anderson	
	4/3/24	Wendel, Henry.			Y	Y	Farmer.	55	W						John J. Anderson	
	4/3/24	Wendel, Minnie F.					Home.	49	W						John J. Anderson	
	4/3/24	Wendel, Minnie Louise.					Teacher.	22	W						John J. Anderson	
	7/22/24	Weston, R. J.	D.		Y	Y	Retired.	64	W						John J. Anderson	
	3/22/26	Wilkenings, Rose.			Pl.	Pl.	Student.	21	W						John J. Anderson	
	10/8/26	Wendel, Clara E.					Teacher.	21	W						John J. Anderson	
	7/26/28	Wichtendahl Johanna D.	D.		Pl.	Pl.	Marine	36	W						John J. Anderson	
	7/26/28	Wichtendahl Mrs D.	D.		Y	Y	"	68	W						John J. Anderson	
	4/30/28	Weis, Emil L.	D.		Pl.	Pl.	Accountant.	32	W						John J. Anderson	
	4/30/28	Wolcott, L. F.	D.		Y	Y	Builder.	65	W						John J. Anderson	

Y  
Z



