

1-1-1914

Orange County Voter Registration, Ocoee, District 36, 1914-1928

Orange County

Find similar works at: <https://stars.library.ucf.edu/cfm-voter>
University of Central Florida Libraries <http://library.ucf.edu>

This Register is brought to you for free and open access by the Vital Records of Central Florida at STARS. It has been accepted for inclusion in Orange County Voter Registration by an authorized administrator of STARS. For more information, please contact STARS@ucf.edu.

Recommended Citation

Orange County, "Orange County Voter Registration, Ocoee, District 36, 1914-1928" (1914). *Orange County Voter Registration*. 225.
<https://stars.library.ucf.edu/cfm-voter/225>

General County Register

—FOR—

Office copy. no. 10
Ocoee. Changed #36

District

Orange. County

WALKER, EVANS & COGSWELL CO., CHARLESTON, S. C.

1928

DECLARATION OR
NATURALIZATION

RESIDENCE

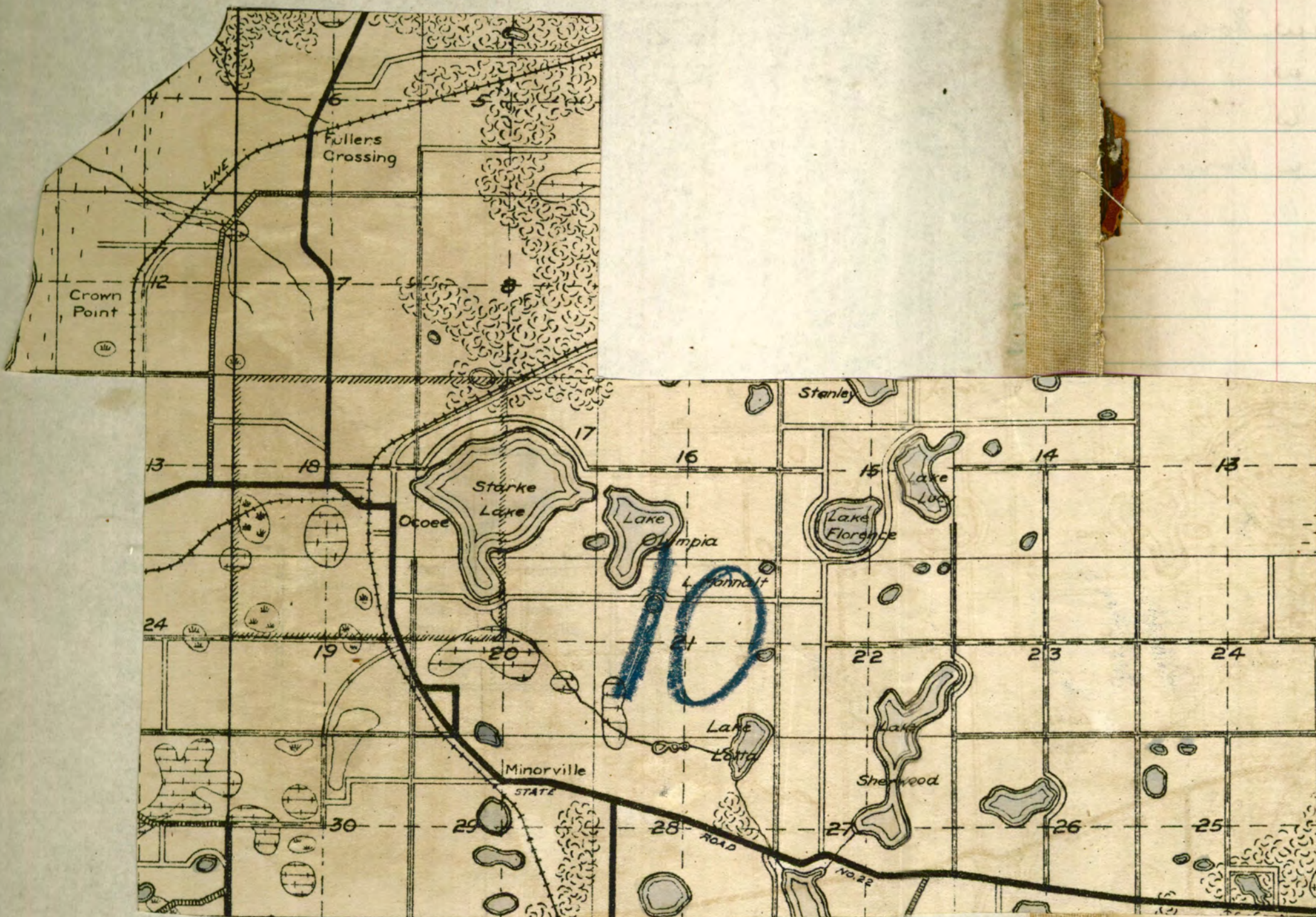

OFFICIAL REGISTER OF ELECTORS FOR

PRECINCT, _____ COUNTY, FLORIDA

NUMBER	DATE	SURNAME AND GIVEN NAME	PARTY AFFILIATION	VOTED	POLL TAX		OCCUPATION	AGE	COLOR	NATIVITY	DECLARATION OR NATURALIZATION	RESIDENCE	OATH		SIGNATURE OF SUPERVISOR OR DEPUTY	REMARKS
					Year 1926	Year 1927							I, having been first duly sworn, say, upon Oath that the statements here entered opposite my name as to qualifications as an elector, are true	SIGNATURE OF ELECTOR		
0	2/24/14	Argo, Jas. M.			PD.	PD.	Farmer.	37	W			Alcoa.			J. J. Anderson	
	7/24/20	Anderson, Mrs. A. E.			PD.	PD.	Home.	52	W	Moved					John J. Anderson	
	7/24/20	Alford, Mrs. J. B.			PD.	PD.	"	49	W						John J. Anderson	
	7/30/20	Argo, Mrs. J. M.			PD.	PD.	"	46	W						John J. Anderson	
	7/24/20	Argo, S. L.					Merchant.	38	W	Moved					John J. Anderson	
0	Feb. 28	Arnett J. B.	D.		PD.	PD.	Filling station	30	W.							

OFFICIAL REGISTER OF ELECTORS FOR

PRECINCT,

COUNTY, FLORIDA

NUMBER	DATE	SURNAME AND GIVEN NAME	PARTY AFFILIATION	VOTED	POLL TAX		OCCUPATION	AGE	COLOR	NATIVITY	DECLARATION OR NATURALIZATION	RESIDENCE	OATH I, having been first duly sworn, say, upon Oath that the statements here entered opposite my name as to qualifications as an elector, are true	SIGNATURE OF SUPERVISOR OR DEPUTY	REMARKS
					Year 1924	Year 1927							SIGNATURE OF ELECTOR		
	11/1/14	Blakely, W. P.			4	4	Farmer.	66	W			Acc.		J. J. Anderson	
	2/24/14	Bartlett, Mrs. C. E.			4	4	Home.	58	W	Moved				John J. Anderson	
0	3/5/20	Bigelow, Robt. C.			PD.	PD.	Farmer.	43	W	-				John J. Anderson	
	4/27/14	Butner, J. H.		Dead	4	4	"	68	W	Dead				John J. Anderson	
	8/31/20	Bennett, B. D.			PD.	EX.	"	48	W					John J. Anderson	
	7/18/20	Bartlett, J. L.					"	31	W	Moved				John J. Anderson	
	7/22/20	Bartlett, C. E.			4	4	"	61	W	Dead				John J. Anderson	
	7/29/20	Bennett, Mrs. B. D.			PD.	EX.	Home.	49	W					John J. Anderson	
	7/29/20	Burke, Flora.					"	46	W					John J. Anderson	
	3/8/22	Britt, G. L.					Farmer.	28	W	Moved				John J. Anderson	
	3/24/22	Brooks, Mrs. B. M.					Home.	31	W					John J. Anderson	
	2/27/22	Britt, Mrs. Guy.					"	24	W					John J. Anderson	
0	4/22/22	Beaty, B. F.					Farmer.	31	W					John J. Anderson	
	4/25/22	Blair, R. W.			4	4	"	54	W	Moved				John J. Anderson	
	3/1/24	Bartlett, Fred L.			4	4	"	57	W					John J. Anderson	
0	3/1/24	Brooker, J. W.					"	23	W					John J. Anderson	
0	3/7/24	Brown, G. A.			4	4	"	58	W					John J. Anderson	
	3/19/24	Bolo, L. C.			4	4	"	55	W					John J. Anderson	
	3/24/24	Blair, Z. C.					"	28	W	Moved				John J. Anderson	
	4/24/24	Burke, Michael.			4	4	Retired.	80	W	Dead				John J. Anderson	
	4/24/24	Beach, J. R.					Farmer.	21	W	Moved				John J. Anderson	
0	4/30/24	Brown, J. W.					"	27	W					John J. Anderson	
	4/30/24	Beach, R. L.					"	50	W	Moved				John J. Anderson	
0	4/30/24	Bell, L. J.		D.			"	26	W					John J. Anderson	
	4/4/24	Bartlett, Agnes.					Home.	21	W	Moved				John J. Anderson	
	7/17/24	Butler, Paul J.		D.	4	4	Physician.	65	W					John J. Anderson	
✓	3/4/28	Bennett L. H.		D.	Ex	Ex	Trucker	60	W					John J. Anderson	
	3/5/28	Burke Corinne		D.	Ex	Ex	Bookkeeper	21	W					John J. Anderson	
0	1/18/28	Bodo L. C.		R.	Pd.	Pd.	Carpenter	29	W					John J. Anderson	
	10/13/28	Bodo Mrs L. C.					Wame	55	W						

NUMBER	DATE	SURNAME AND GIVEN NAME	PARTY AFFILIATION	VOTED	POLL TAX		OCCUPATION	AGE	COLOR	NATIVITY	DECLARATION OR NATURALIZATION	RESIDENCE	OATH		SIGNATURE OF SUPERVISOR OR DEPUTY	REMARKS
					Year 1926	Year 1927							I, having been first duly sworn, say, upon Oath that the statements here entered opposite my name as to qualifications as an elector, are true			
													SIGNATURE OF ELECTOR			
0	7/27/14	Clark, A. M.			PD.	PD.	Farmer.	42 W				Alcoe.			J. J. Anderson	
	7/27/20	Clark, Mrs. A. M.			PD.	PD.	Home.	25 W							John J. Anderson	
	7/29/22	Carreker, W. P.					Carp.	41 W							John J. Anderson	
0	3/8/24	Chapman, J. E.			PD.	PD.	Farmer.	41 W							John J. Anderson	
	4/20/24	Craft, R. R.					"	28 W		Moved					John J. Anderson	
	4/20/24	Clark, Minnie.					Home.	42 W							John J. Anderson	
	4/30/24	Clark, J. D.					Farmer.	52 W							John J. Anderson	
	10/4/24	Cochran, J. J.	D.				Citrus Grower.	41 W		See below					John J. Anderson	
	10/11/24	Clark, P. B.	D.		PD.		Merchant.	39 W							John J. Anderson	
	10/11/24	Craft, Mrs. R. R.	D.				Home.	22 W		Moved					John J. Anderson	
	3/27/28	Chabot Mrs Earl	D.		Pd.	Pd.	Home	28 W.							John J. Anderson	
	7/28/28	Carter Mrs R.	D.				Gardener	44 W.								
	7/30/28	Corbin J. H.	R.		Ex	Ex	Salesman	57 W.								
	7/30/28	Corbin Mrs J. H.	R.				Home	46 W.								
0	7/19/28	Cochran J. J.	D.		Pd.	Pd.	Fruit	46 W.								
	10/13/28	C. Clark Jr.			Pd.	Pd.	Plasterer	42 W.								

OFFICIAL REGISTER OF ELECTORS FOR

PRECINCT,

COUNTY, FLORIDA

NUMBER	DATE	SURNAME AND GIVEN NAME	PARTY AFFILIATION	VOTED	POLL TAX		OCCUPATION	AGE	COLOR	NATIVITY	DECLARATION OR NATURALIZATION	RESIDENCE	OATH		SIGNATURE OF SUPERVISOR OR DEPUTY	REMARKS				
					I, having been first duly sworn, say, upon Oath that the statements here entered opposite my name as to qualifications as an elector, are true															
					Year 1926	Year 1927							SIGNATURE OF ELECTOR							
	2/11/14	Davis, W. M.			4 4	Farmer.	55	W.				Occ.			J. J. Anderson, By M. L. A.					
	3/3/20	Dann, Ernest G.				"	27	W.								John J. Anderson				
	7/29/20	Dann, Mrs. Geo. L.			4	4	Home.	52	W.							John J. Anderson				
	7/30/20	Davis, Mrs. W. M.			4	4	"	52	W.							John J. Anderson				
	3/23/22	Davis, J. J.			4	4	Farmer.	69	W.	Dead						John J. Anderson				
	3/25/22	Davis, Mrs. J. J.					Home.	39	W.	Moved						John J. Anderson				
	3/31/22	Dann, J. J.			PD.	PD.	Farmer.	24	W.							John J. Anderson				
	7/20/22	Davis, Sam.					"	24	W.	Moved						John J. Anderson				
	2/29/24	Danford, A. C.					"	21	W.	Moved						John J. Anderson				
	4/29/24	Davis, W. J.					"	21	W.	Moved						John J. Anderson				
	10/11/24	Drew, P. D.	D.				"	38	W.							John J. Anderson				
	3/6/28	Denham R. R.					Storekeeper	40	W.							John J. Anderson				
	3/28/28	Davis L. A.	D.		X	X	Farmer.	22	W.							John J. Anderson				
	10/6/28	Dagocher Andon			X	X	Fruit grower	70	W.											
	10/6/28	Dagocher Rosa					Wame	55	W.											

COUNTY, FLORIDA

NUMBER	DATE	SURNAME AND GIVEN NAME	PARTY AFFILIATION	VOTED	POLL TAX		OCCUPATION	AGE	COLOR	NATIVITY	DECLARATION OR NATURALIZATION	RESIDENCE	OATH		SIGNATURE OF SUPERVISOR OR DEPUTY	REMARKS
					Year	Year							I, having been first duly sworn, say, upon Oath that the statements here entered opposite my name as to qualifications as an elector, are true	SIGNATURE OF ELECTOR		
2/10/14	Eckles, Jas. D.	4	4	Farmer	78	W						O. coll.			J. J. Anderson. By M. L. A.	
4/14/14	Evans, J. D.	2	4	"	63	W									John J. Anderson	
4/29/16	Eckles, J. J.	PD.	PD.	Merchant	44	W									John J. Anderson	
4/29/16	Ewing, B. E.	PD.	PD.	Merchant	33	W									John J. Anderson	
4/11/16	Eckles, R. G.	PD.	PD.	Contr.	39	W									John J. Anderson	
3/28/22	Eckles, Lucy S.	PD.	Pl.	Home	37	W									John J. Anderson	
4/24/22	Eckles, U. S.	PD.	PD.	Farmer	42	W									John J. Anderson	
10/5/22	Ewing, Jessie J.	PD.	PD.	Home	29	W									John J. Anderson	

OFFICIAL REGISTER OF ELECTORS FOR

PRECINCT,

COUNTY, FLORIDA

NUMBER	DATE	SURNAME AND GIVEN NAME	PARTY AFFILIATION	VOTED	POLL TAX		OCCUPATION	AGE	COLOR	NATIVITY	DECLARATION OR NATURALIZATION	RESIDENCE	OATH		SIGNATURE OF SUPERVISOR OR DEPUTY	REMARKS
					I, having been first duly sworn, say, upon Oath that the statements here entered opposite my name as to qualifications as an elector, are true								SIGNATURE OF ELECTOR			
					Year 1926	Year 1927										
	7/14/19	Farmer, C. W.			Pd.	Ex	Farmer.	43	W			Occ.			J. J. Anderson. By: M. L. A.	
	8/12/20	Fluelling, E. H.			Ex	Ex	"	60	W						John J. Anderson	
	8/12/20	Fluelling, D. Q.			Ex	Ex	"	51	W						John J. Anderson	
	3/13/22	Fluelling, C. H.			Pd.	Pd.	"	38	W						John J. Anderson	
	3/6/24	Fluelling, H. B.			Pd.	Pd.	"	35	W						John J. Anderson	
	3/6/24	Farmer, J. W.					"	21	W						John J. Anderson	
	4/4/24	Fluelling, Stella			Pd.	Pd.	Home.	35	W						John J. Anderson	
	4/4/24	Fluelling, Lula L.			Pd.	Pd.	"	37	W						John J. Anderson	
	4/20/24	Ferguson, Will.					Bk. Mason.	24	W	Moved					John J. Anderson	
	3/6/28	Felker, May.	D.		Pd	Pd.	Home.	56	W.						John J. Anderson	
	3/6/28	Felker, Whittier W.	D.		Pd	Pd.	Retired Farmer.	54	W.						John J. Anderson	
	10/12/28	Fulford Mary			Ex	Ex	House	22	W.							

NUMBER	DATE	SURNAME AND GIVEN NAME	PARTY AFFILIATION	VOTED	POLL TAX		OCCUPATION	AGE	COLOR	NATIVITY	DECLARATION OR NATURALIZATION	RESIDENCE	OATH	SIGNATURE OF SUPERVISOR OR DEPUTY	REMARKS
					Year 1926	Year 1927							I, having been first duly sworn, say, upon Oath that the statements here entered opposite my name as to qualifica- tions as an elector, are true		
	3/3/14	Graves, J. W.			PD.	EX.	Farmer.	45	W			O'coe,		J. J. Anderson. 34: in f. a.	
	2/22/14	Graves, Isaac.			EX	EX.	"	66	W					John J. Anderson	
	3/4/14	Gray, J. Wilson.			EX	EX.	"	62	W					John J. Anderson	
	2/27/14	Griffin, B. L.			EX	EX.	"	69	W					John J. Anderson	
	2/2/14	Griffin, E. L.					"	29	W	Moved				John J. Anderson	
	3/30/18	Griffin, A. L.					Pyman.	42	W					John J. Anderson	
	3/29/20	Gilmore, J. J.			EX	EX.	Farmer.	60	W					John J. Anderson	
	7/14/20	Griffin, Mrs. E. L.			PD.	PD.	Home.	32	W	Moved				John J. Anderson	
	7/27/20	Gray, Mrs. J. W.			EX	EX.	"	58	W					John J. Anderson	
	7/27/20	Griffin, Mrs. Lee.					"	26	W					John J. Anderson	
	3/12/24	Gardner, M. C.					Farmer.	33	W	Moved				John J. Anderson	
	3/12/24	Gardner, J. F.					"	42	W	Moved				John J. Anderson	
	3/12/24	Gore, Florence M.			PD.	PD.	Home.	41	W					John J. Anderson	
	3/22/24	Gore, A. J.			PD.	PD.	Farmer.	31	W					John J. Anderson	
	3/4/26	Gower, C. C.	D		PD.	PD.	Carpenter.	41	W					John J. Anderson	
	3/13/26	Goirer, W. M.	D		EX	EX.	Trucking.	62	W					John J. Anderson	
	3/13/26	Grafton, J. M.	D		PD.	PD.	Mechanic.	21	W.					John J. Anderson	
	7/3 28	Barlington L. W.	D.		EX	EX	Farmer	66	W.					John J. Anderson	
	3/31. 28	Godbold Roy	D.		EX	PD.	Farmer	22	W.					John J. Anderson	
	10/4. 28	Gava Emma			EX	EX	Home	60	W.						

NUMBER	DATE	SURNAME AND GIVEN NAME	PARTY AFFILIATION	VOTED	POLL TAX		OCCUPATION	AGE	COLOR	NATIVITY	DECLARATION OR NATURALIZATION	RESIDENCE	OATH		SIGNATURE OF SUPERVISOR OR DEPUTY	REMARKS
					Year 1926	Year 1927							I, having been first duly sworn, say, upon Oath that the statements here entered opposite my name as to qualifications as an elector, are true	SIGNATURE OF ELECTOR		
	2/14/14	Hawthorne, J. C.			Pl.	PD.	Farmer.	30	w			Oce.			J. J. Anderson	
	2/2/14	Hennes, J. D.			Ex	Ex	"	49	w			W 1 P			John J. Anderson	
	2/25/14	Hoffman, Jos.			Ex	Ex	"	50	w			W 02			John J. Anderson	
	2/23/14	Hudson, Thos. D.			Ex	Ex	"	46	w			W 0 P			John J. Anderson	
	7/18/20	Hudson, Mrs. J. D.			PD.	PD.	Home.	39	w			W 02			John J. Anderson	
	7/28/20	Howard, Mrs. R.					"	39	w			W 02			John J. Anderson	
	7/29/20	Hennes, Mrs. J. D.			PD.	PD.	"	45	w			W 02			John J. Anderson	
	3/28/22	Harper, O. L.					Bookkeeper.	31	w	Moved		W 12			John J. Anderson	
	3/30/22	Hodge, G. F.					Farmer.	31	w			W 12			John J. Anderson	
	7/15/22	Helms, J. H.			Ex	Ex	"	56	w			W 02			John J. Anderson	
	9/16/22	Howard, R. B.					"	40	w			W 0 P			John J. Anderson	
	7/22/22	Hurst, Arthur.					"	27	w			W 02			John J. Anderson	
	3/3/24	Henley, D. H.					Druggist.	35	w	Moved		W 12			John J. Anderson	
	3/3/24	Henley, Jennie E.					Home.	29	w	Moved		W 12			John J. Anderson	
	3/6/24	Hain, Albert.			PD.	PD.	Carp.	38	w			W 02			John J. Anderson	
	3/24/24	Holtzclow, E. E.					Drayman.	24	w	Moved		W 02			John J. Anderson	
	3/24/24	Head, J. L.					Plasterer.	24	w	Moved		W 02			John J. Anderson	
	3/29/24	Hudson, Malba.					Farmer.	22	w			W 02			John J. Anderson	
	4/24/24	Harper, Betsey.					Home.	30	w	Moved		W 02			John J. Anderson	
	4/30/24	Hall, J. Edw.					Farmer.	52	w	Moved		W 02			John J. Anderson	
	4/30/24	Holland, J. A.					Laborer.	36	w			W 02			John J. Anderson	
	3/6/28	Hayes, J. R.	D.				Sharekeeper	39	w						John J. Anderson	
	4/26/28	Helms, J. H.	D.		pd	pd.	Farmer.	27	w							
	7/6/28	Barrell H. E.	D.		Pl.	Pl.	Merchant	25	w							
	8/15/28	Hearn E. H. M.	R.		pd.	pd.	Hearn	54	w							

OFFICIAL REGISTER OF ELECTORS FOR

PRECINCT,

COUNTY, FLORIDA

NUMBER	DATE	SURNAME AND GIVEN NAME	PARTY AFFILIATION	VOTED	POLL TAX		OCCUPATION	AGE	COLOR	NATIVITY	DECLARATION OR NATURALIZATION	RESIDENCE	OATH		SIGNATURE OF SUPERVISOR OR DEPUTY	REMARKS
					Year 1926	Year 1927							I, having been first duly sworn, say, upon Oath that the statements here entered opposite my name as to qualifications as an elector, are true	SIGNATURE OF ELECTOR		
	3/28/28	Ingold Edna W.	R.		Pl.		Teacher	37	W.						John J. Anderson	

OFFICIAL REGISTER OF ELECTORS FOR

PRECINCT, _____ COUNTY, FLORIDA

NUMBER	DATE	SURNAME AND GIVEN NAME	PARTY AFFILIATION	VOTED	POLL TAX		OCCUPATION	AGE	COLOR	NATIVITY	DECLARATION OR NATURALIZATION	RESIDENCE	OATH		SIGNATURE OF SUPERVISOR OR DEPUTY	REMARKS
					I, having been first duly sworn, say, upon Oath that the statements here entered opposite my name as to qualifications as an elector, are true											
					Year 1926	Year 1927							SIGNATURE OF ELECTOR			
	3/3/20	Jordan, J. R. W.			X	X	Clerk.	56	W	Mixed		Alcoa.			J. J. Anderson	
	3/10/20	Jensen, H. H.			X	X	"	61	W						John J. Anderson	
	7/20/20	Jensen, Mrs. H. H.			X	X	Home.	50	W						John J. Anderson	
	3/3/24	Jackson, L. J.			PD.	PD.	Minister.	25	W						John J. Anderson	
	3/30. 28	Jackson Lucie L.			Pd.	Pd.	Wame								John J. Anderson	

OFFICIAL REGISTER OF ELECTORS FOR

PRECINCT, _____ COUNTY, FLORIDA

NUMBER	DATE	SURNAME AND GIVEN NAME	PARTY AFFILIATION	VOTED	POLL TAX		OCCUPATION	AGE	COLOR	NATIVITY	DECLARATION OR NATURALIZATION	RESIDENCE	OATH		SIGNATURE OF SUPERVISOR OR DEPUTY	REMARKS
					Year	Year							I, having been first duly sworn, say, upon Oath that the statements here entered opposite my name as to qualifications as an elector, are true			
													1926	1927		
	2/4/24	Xitchen, H. M.					Laborer.	32	W			Dece.			J. J. Anderson	Benj. M. L. A.
	7/12/24	Kelly, H. E.					Farmer.	29	W	Moved					John J. Anderson	
	3/17/24	Kersh, Benj. C.					"	63	W	Dead					John J. Anderson	
	3/19/24	Kersh, Betty.					Home.	52	W						John J. Anderson	
	8/24/24	Klineck, D. Wright.	D.				Farmer.	22	W						John J. Anderson	
	10/11/24	Kearns R. J.	D.		PD.	PD.	Electrician.	49	W						John J. Anderson	
	10/11/24	Kearns Mrs. R. J.	D.		PD.	PD.	Home.	41	W.						John J. Anderson	
	10/2/26	Kirkland, Joe J.			PD.		Merchant.	30	W						John J. Anderson	
	4/11. 28	Kureth Iris M.	D.				Home	35	W.						John J. Anderson	
	10/10 28	Ken E. J.			Ex	Ex	Electrician	21	W.						John J. Anderson	

OFFICIAL REGISTER OF ELECTORS FOR

PRECINCT, _____

COUNTY, FLORIDA

NUMBER	DATE	SURNAME AND GIVEN NAME	PARTY AFFILIATION	VOTED	POLL TAX		OCCUPATION	AGE	COLOR	NATIVITY	DECLARATION OR NATURALIZATION	RESIDENCE	OATH	SIGNATURE OF SUPERVISOR OR DEPUTY	REMARKS					
					I, having been first duly sworn, say, upon Oath that the statements here entered opposite my name as to qualifica- tions as an elector, are true															
					Year 1926	Year 1927							SIGNATURE OF ELECTOR							
	4/25/22	Lacy, C. H.					Farmer	28 W				O. C. C.		J. J. Anderson						
	3/4/24	Lairsey, E. D.					Carp.	41 W						John J. Anderson						
	4/1/24	Land, L. J.					Farmer	45 W						John J. Anderson						
	4/1/24	Land, Gady.					"	21 W						John J. Anderson						
	4/24/24	Lett, Ida.					Home.	27 W						John J. Anderson						
	10/11/28	Las. eg. G. E.					dx dx Farmer	66 W												

OFFICIAL REGISTER OF ELECTORS FOR

PRECINCT,

COUNTY, FLORIDA

NUMBER	DATE	SURNAME AND GIVEN NAME	PARTY AFFILIATION	VOTED	POLL TAX		OCCUPATION	AGE	COLOR	NATIVITY	DECLARATION OR NATURALIZATION	RESIDENCE	OATH		SIGNATURE OF SUPERVISOR OR DEPUTY	REMARKS
					Year 1926	Year 1927							I, having been first duly sworn, say, upon Oath that the statements here entered opposite my name as to qualifications as an elector, are true			
													SIGNATURE OF ELECTOR			
	4/27/14	Maguire, J. X.			PD.	Pl.	Farmer.	35	w			O'coe.			J. J. Anderson	By: M. L. A.
	1/8/14	Minor, J. J.			4	4	"	72	w						John J. Anderson	
	4/10/14	Minor, W. J.			4	4	"	73	w						John J. Anderson	
	2/23/14	Moore, W. L.			4	4	"	64	w						John J. Anderson	
	3/28/14	Mooney, W. W.					"	38	w	Moved					John J. Anderson	
	2/11/14	Minor, A. M.			4	4	"	76	w						John J. Anderson	
	4/29/18	Minor, B. A.			PD.	PD.	"	38	w						John J. Anderson	
	4/24/20	Minor, D. E.			PD.		Reg. Servant.	30	w	Moved					John J. Anderson	
	7/20/20	Maguire, Mrs. D. O.			4	4	Home.	66	w						John J. Anderson	
	7/20/20	Maguire, Lillian.					Teacher.	30	w						John J. Anderson	
	7/25/20	Murray, Mrs. D. C.					Home.	25	w						John J. Anderson	
	7/25/20	Minor, Mrs. W. J.			4	4	"	70	w						John J. Anderson	
	7/28/20	Mathews, Mrs. J. R.			PD.	Pl.	"	33	w						John J. Anderson	
	7/29/20	Minor, Mr. B. A.			PD.	PD.	"	37	w						John J. Anderson	
	7/30/20	Minor, Mrs. A. M.			4	4	"	77	w	Dead					John J. Anderson	
	4/19/22	Miller, J. L.			PD.	PD.	Painter.	33	w						John J. Anderson	
	7/2/22	Maguire, Mrs. F. H.			PD.	Pl.	Home.	30	w						John J. Anderson	
	3/4/24	Morgan, J. E.			PD.	Pl.	Farmer.	29	w						John J. Anderson	
	3/4/24	Morgan, Lena.			PD.	Pl.	Home.	25	w						John J. Anderson	
	3/6/24	Murray, E. A.			PD.	PD.	Farmer.	29	w						John J. Anderson	
	3/6/24	Murray, Ira L.					Home.	28	w						John J. Anderson	
	3/7/24	Mathews, J. R.			PD.	Pl.	Well Driller.	44	w						John J. Anderson	
	3/15/24	Miller, W. D.			PD.	PD.	Farmer.	40	w						John J. Anderson	
	3/24/24	McIntyre, J. W.			Ex	Ex	"	54	w	See Me					John J. Anderson	
	4/10/24	Marshall, R. L. E.			PD.	PD.	"	50	w	Moved					John J. Anderson	
	5/30/24	Minor, Miles J.			4	4	"	21	w						John J. Anderson	
	4/24/24	Moss, Wm. A.	D.		PD.		Salesman.	32	w	Moved					John J. Anderson	
	7/17/24	Mileham, E. J. A.			PD.	Pl.	y. m. C. A.	36	w						John J. Anderson	
	7/17/24	Mileham, D. H.					Nurse.	40	w						John J. Anderson	
	4/1/26	Moss, A. E.			PD.		Home.	28	w	Moved					John J. Anderson	
	2/3.28	Massey G. J.	D.		Ex	Ex	Retired	67	w.						John J. Anderson	
	3/5.28	Morgan A. W.	D.		Pl.	Pl.	Salesman	31	w.						John J. Anderson	
	3/12.28	Mitchell D. W.	D.		Pl.	Pl.	Merchant	45	w.						John J. Anderson	
	3/19.28	Mills Mrs J. L.	D.				Warme	32	w.						John J. Anderson	

OFFICIAL REGISTER OF ELECTORS FOR

PRECINCT,

COUNTY, FLORIDA

NUMBER	DATE	SURNAME AND GIVEN NAME	PARTY AFFILIATION	VOTED	POLL TAX		OCCUPATION	AGE	COLOR	NATIVITY	DECLARATION OR NATURALIZATION	RESIDENCE	OATH		SIGNATURE OF SUPERVISOR OR DEPUTY	REMARKS
					I, having been first duly sworn, say, upon Oath that the statements here entered opposite my name as to qualifications as an elector, are true											
					Year 1926	Year 1927							SIGNATURE OF ELECTOR			
	3/20.28	Minor Mrs L. R.	D.		Pd.	Ex	Home	56	W.						John J. Anderson	
	3/28.28	Morgan J. B.					Merchant	26	W.						John J. Anderson	
	3/29.28	Mr Hoague Geo M.	D.		Pd.	Pd.	Carpenter	35	W.	See Mr					John J. Anderson	
	4/20.28	Miller Karl	D.		Ex	Pd.	Farmer	31	W.	Naturalized					John J. Anderson	
	4/23.28	Miller W. T.	D.		Pd.	Pd.	Manager	50	W.	1927.					John J. Anderson	
	4/23.28	Miller Mrs W. T.	D.		Pd.	Pd.	Home	34	W.	Summ. La. & J. Orlando.					John J. Anderson	
	10/3.28	Mileham E.			Pd.		Salesman	40	W.	Reg. before						
	10/11.28	Maynard Nellie M.			Ex	Ex	Home	58	W.							

NUMBER	DATE	SURNAME AND GIVEN NAME	PARTY AFFILIATION	VOTED	POLL TAX		OCCUPATION	AGE	COLOR	NATIVITY	DECLARATION OR NATURALIZATION	RESIDENCE	OATH		SIGNATURE OF SUPERVISOR OR DEPUTY	REMARKS
					Year 1926	Year 1927							I, having been first duly sworn, say, upon Oath that the statements here entered opposite my name as to qualifications as an elector, are true	SIGNATURE OF ELECTOR		
	7/28/20	M. Leod, Mrs. E. E.					Home.	31	W			Peoa.			J. J. Anderson	
	3/24/22	M. Connell, E. M.					Farmer.	35	W						John J. Anderson	
	3/27/22	M. Leod, M. M.					Barber.	28	W						John J. Anderson	
	10/19/24	M. Connell, J. H.					Minister.	49	W						John J. Anderson	
	10/9/24	M. Connell, Annetta B.					Home.	50	W						John J. Anderson	
	10/9/24	M. Connell, Mildred M.					"	21	W						John J. Anderson	
	1/18 28	M. Dwyre Annie	D.			Ex Ex	Farmeress	56	W						John J. Anderson	
	9/29 28	M. Hoarue Geo M.	D.			Ex Ex	Farmer	31	W	Naturalized 1927					John J. Anderson	
	3/24 24	M. Dwyre J. W.	D.			Ex Ex	"	52							John J. Anderson	

OFFICIAL REGISTER OF ELECTORS FOR

PRECINCT,

COUNTY, FLORIDA

NUMBER	DATE	SURNAME AND GIVEN NAME	PARTY AFFILIATION	VOTED	POLL TAX		OCCUPATION	AGE	COLOR	NATIVITY	DECLARATION OR NATURALIZATION	RESIDENCE	OATH		SIGNATURE OF SUPERVISOR OR DEPUTY	REMARKS
					I, having been first duly sworn, say, upon Oath that the statements here entered opposite my name as to qualifications as an elector, are true											
					Year 1926	Year 1927							SIGNATURE OF ELECTOR			
	3/8/16	New, J. P.			4	4	Ry. Agent.	52	W			Deer			J. J. Anderson	By: M. L. A.
	7/17/20	New, Mrs. J. P.			4	4	Home.	52	W						John J. Anderson	
	7/27/20	Neely, Robt.			4	4	Labourer.	54	W	Moved					John J. Anderson	
	3/11/24	Norwood, John.			PD.	PD.	Farmer.	47	W						John J. Anderson	
	4/24/24	Nutty, Z. B.			4	4	Labourer.	61	W	Moved					John J. Anderson	
	4/12/24	Nevell, S. P.			4	4	"	57	W	Moved					John J. Anderson	
	3/28/28	Norton, Ethel.	D.		4	4	Home.	21	W.						John J. Anderson	
	3/28/28	Norton, J. C.	D.		PD.	PD.	Road Constr.	32	W						John J. Anderson	
	3/17.28	Newton J. T.	D.		PD.	PD.	Farmer	52	W.						John J. Anderson	

OFFICIAL REGISTER OF ELECTORS FOR

PRECINCT, COUNTY, FLORIDA

NUMBER	DATE	SURNAME AND GIVEN NAME	PARTY AFFILIATION	VOTED	POLL TAX		OCCUPATION	AGE	COLOR	NATIVITY	DECLARATION OR NATURALIZATION	RESIDENCE	OATH		SIGNATURE OF SUPERVISOR OR DEPUTY	REMARKS
					I, having been first duly sworn, say, upon Oath that the statements here entered opposite my name as to qualifications as an elector, are true											
					Year	Year							SIGNATURE OF ELECTOR			
					1926	1927										
	8/18/20	Osteen, W.B.			✓	✓	Sec. Foreman.	54	W			Oreoc.			J. J. Anderson	Reg. M. L. A.
	7/21/20	Osteen, Mrs. W.B.			✓	✓	Home.	49	W						John J. Anderson	
	7/28/20	Osteen, Mrs. E.			✓	✓	"	58	W						John J. Anderson	
	7/25/22	Oliver, J. F.			PD.	PD.	Farmer.	49	W						John J. Anderson	
	10/1/24	Oliver, Fred.			PD.	PD.	"	21	W						John J. Anderson	
	10/12/28	Odell Edith			Ex	Ex	Home	80	W							
	10/12/28	Odell J. L.			Ex	Ex	Farmer	55	W							

OFFICIAL REGISTER OF ELECTORS FOR

PRECINCT,

COUNTY, FLORIDA

NUMBER	DATE	SURNAME AND GIVEN NAME	PARTY AFFILIATION	VOTED	POLL TAX		OCCUPATION	AGE	COLOR	NATIVITY	DECLARATION OR NATURALIZATION	RESIDENCE	OATH		SIGNATURE OF SUPERVISOR OR DEPUTY	REMARKS
					Year 1926	Year 1927							I, having been first duly sworn, say, upon Oath that the statements here entered opposite my name as to qualifications as an elector, are true	SIGNATURE OF ELECTOR		
	3/9/16	Pounds, C. H.			PD.	PD.	Salesman.	35	W			Deer.			J. J. Anderson, Sec. M. L. A.	
	7/28/16	Pounds, J. R.			Ex	Ex	Farmer.	65	W	Dead					John J. Anderson	
	7/17/20	Pounds, Mr. C. H.			PD.	PD.	Home,	33	W						John J. Anderson	
	7/20/20	Pounds, Mrs. W. S.			Pd.	Pd.	"	42	W						John J. Anderson	
	7/24/20	Pounds, W. S.			Pd.	Pd.	Mill.	41	W						John J. Anderson	
	7/29/20	Pulliam, J. E.			PD.	PD.	Farmer.	44	W						John J. Anderson	
	7/30/20	Pulliam, Mr. J. E.					Home,	33	W						John J. Anderson	
	4/29/22	Pounds, Mattie.			Ex	Ex	"	65	W						John J. Anderson	
	3/6/24	Pease, W. D.			PD.	PD.	Farmer.	24	W						John J. Anderson	
	3/27/24	Peters, A. P.					"	51	W	Moved					John J. Anderson	
	4/10/24	Patrick, W. A.			PD.		"	23	W	Moved					John J. Anderson	
	4/30/24	Patrick, H. E.	D.		PD.	PD.	"	43	W						John J. Anderson	
	7/30/26	Pounds, W. B.			PD.		Clerk.	21	W						John J. Anderson	
	2/28/28	Paul, C. L.	D.		Pd.	Pd.	Mechanic.	25	W						John J. Anderson	
	3/26/28	Pank J. L.	D.		Ex	Ex	Plasterer	57	W						John J. Anderson	
	4/11/28	Patrick Mrs Lena M.	D.		Pd.	Pd.	Hearse	49	W						John J. Anderson	
	5/19/28	Peacock J. C.	D.		Pd.	Pd.	Carpenter	35	W						John J. Anderson	

OFFICIAL REGISTER OF ELECTORS FOR

PRECINCT,

COUNTY, FLORIDA

WALKER, EVANS & COSEWELL CO., CHARLESTON, S. C.

NUMBER	DATE	SURNAME AND GIVEN NAME	PARTY AFFILIATION	VOTED	POLL TAX		OCCUPATION	AGE	COLOR	NATIVITY	DECLARATION OR NATURALIZATION	RESIDENCE	OATH		SIGNATURE OF SUPERVISOR OR DEPUTY	REMARKS
					Year 1926	Year 1927							I, having been first duly sworn, say, upon Oath that the statements here entered opposite my name as to qualifications as an elector, are true	SIGNATURE OF ELECTOR		
	2/24/14	Russ, J. M.					Farmer.	41	W			Dece.			J. J. Anderson	By: H. L. A.
	3/3/20	Rewis, R. A.			PD.	PD.	Mechanic.	46	W						John J. Anderson	
	8/16/20	Robertson, J. J.			PD.	EX.	Farmer.	48	W						John J. Anderson	
	8/19/20	Robertson, J. W.				PD.	"	45	W						John J. Anderson	
	7/24/20	Rewis, Mrs. R. A.			PD.	PD.	Home.	43	W						John J. Anderson	
	7/24/20	Russ, Mrs. J. M.					"	42	W	Moved					John J. Anderson	
	3/23/22	Robertson, C. C.					Merchant.	37	W	Moved					John J. Anderson	
	9/30/22	Reeres, M. C.			PD.	PD.	Barber.	26	W						John J. Anderson	
	3/28/24	Rofferty, W. A.					Farmer.	32	W	Moved					John J. Anderson	
	4/20/24	Reynolds, E. P.					Well Driller	22	W						John J. Anderson	
	4/30/24	Rutherford, James.					Plasterer.	27	W						John J. Anderson	
	4/30/24	Ray, J. E.					Pyman.	30	W	Moved					John J. Anderson	
	10/6/24	Richards, J. B.	R.				Merchant.	41	W						John J. Anderson	
	10/6/24	Richards, Core A.					Home.	44	W						John J. Anderson	
	1/18.28	Russ. T. M.	D.		Ex	Ex	Farmer	21	W.						John J. Anderson	
	3/6.28	Robinson J. C.	D.		Ex	Ex	Carpenter	61	W.						John J. Anderson	
	3/12.28	Richardson G. H.	R.		Ex	Ex	Farmer	68	W.						John J. Anderson	
	3/12.28	Richardson J. W.	R.		Ex	Ex	Farmer	66	W.						John J. Anderson	
	3/28.28	Roussian M. L.	R.				Druggist	27	W.						John J. Anderson	
	3/30.28	Robbins H. P.	D.		Pl.	Pl.	Barber	42	W.						John J. Anderson	
	10/12.28	Rogers Dean					Farmer	23	W.							
	10/13.28	Rogers W. L.			Ex	Ex	"	57	W.							

OFFICIAL REGISTER OF ELECTORS FOR

PRECINCT,

COUNTY, FLORIDA

NUMBER	DATE	SURNAME AND GIVEN NAME	PARTY AFFILIATION	VOTED	POLL TAX		OCCUPATION	AGE	COLOR	NATIVITY	DECLARATION OR NATURALIZATION	RESIDENCE	OATH I, having been first duly sworn, say, upon Oath that the statements here entered opposite my name as to qualifications as an elector, are true	SIGNATURE OF SUPERVISOR OR DEPUTY	REMARKS
					Year 1926	Year 1927							SIGNATURE OF ELECTOR		
	11/8/14	Sanders, Thos. J.			EX	EX	Farmer	65	W	Dead		Deale.		J. J. Anderson	By: M. L. A.
	2/17/14	Seegar, Wm. H.			PD.	EX.	"	42	W					John J. Anderson	
	2/14/14	Sims, O. J.			EX	EX	"	50	W	Moved				John J. Anderson	
	4/24/14	Sims, Jas. W.			EX	EX	"	53	W	Dead				John J. Anderson	
	2/1/14	Sims, B. M.			EX	EX	"	85	W	Dead				John J. Anderson	
	3/1/14	Seegar, R. H.			PD.	PD.	"	38	W					John J. Anderson	
	7/8/14	Stone, R. D.			EX	EX	"	60	W					John J. Anderson	
	7/12/20	Sligh, G. R. Mrs.			EX	EX	Home	53	W					John J. Anderson	
	7/24/20	Seegar, Mrs. W. H.			PD.	PD.	"	25	W					John J. Anderson	
	7/25/20	Sims, Mrs. J. W.			PD.	PD.	"	48	W					John J. Anderson	
	7/27/20	Sanders, Mrs. J. J.			EX	EX	"	61	W					John J. Anderson	
	7/18/20	Smith, L. L.					Laborer	37	W	Moved				John J. Anderson	
	7/28/20	Stenson, H. G.					Cook	40	W					John J. Anderson	
	7/30/20	Salisbury, S. J.					Farmer	34	W					John J. Anderson	
	2/14/22	Salisbury, Nora P.			PD.	PD.	Home	32	W					John J. Anderson	
	4/25/22	Smith, J. B.					Farmer	26	W	Moved				John J. Anderson	
	4/25/22	Smith, J. J.			EX	EX	"	59	W					John J. Anderson	
	7/2/22	Sanders, C. L.					"	29	W					John J. Anderson	
	10/5/22	Stenson, Ira B.					Home	37	W					John J. Anderson	
	3/6/24	Sims, Kathryn			PD.	PD.	Clerk	22	W					John J. Anderson	
	3/6/24	Scott, Sam R.			PD.	PD.	Physician	43	W					John J. Anderson	
	3/6/24	Scott, Bessie May			PD.	PD.	Home	30	W					John J. Anderson	
	3/8/24	Snow, H. J.					Farmer	26	W	Moved				John J. Anderson	
	3/18/24	Shaw, J. L.			PD.	PD.	Wall Driller	25	W					John J. Anderson	
	4/1/24	Seegar, Cora D.			PD.	PD.	Home	42	W					John J. Anderson	
	4/25/24	Sloan, Lucille					Clerk	21	W	Moved				John J. Anderson	
	4/30/24	Sanders, Mary					Home	48	W					John J. Anderson	
	4/30/24	Shaw, John C.			EX	EX	Farmer	55	W					John J. Anderson	
	4/24/24	Shaffer, Harry			EX	EX	"	53	W					John J. Anderson	
	2/17/14	Seegar, S. J. J.			EX	EX	"	66	W					John J. Anderson	
	10/26	Stanford J. L.			PD.	EX.				Transp. for. Park Co.				John J. Anderson	
	1/21. 28	Starnes C. F.	D.		PD.	PD.	Minister	45	W.					John J. Anderson	
	3/6. 28	Snipes M. L.	D.		PD.	PD.								John J. Anderson	
	3/15. 28	Sligh Clarence	R.		EX	EX		21	W.					John J. Anderson	

WALKER, EVANS & COGSWELL CO., CHARLESTON, S. C.

NUMBER	DATE	SURNAME AND GIVEN NAME	PARTY AFFILIATION	VOTED	POLL TAX		OCCUPATION	AGE	COLOR	NATIVITY	DECLARATION OR NATURALIZATION	RESIDENCE	OATH		SIGNATURE OF SUPERVISOR OR DEPUTY	REMARKS
					Year 1926	Year 1927							I, having been first duly sworn, say, upon Oath that the statements here entered opposite my name as to qualifications as an elector, are true			
					SIGNATURE OF ELECTOR											
	3/24/28	Shaw, T. J.	D.		Pd.	Pd.	Farmer	47	W.						John F. Anderson	
	4/28/28	Starnes, Mr. C. F.	D.		Pd.	Pd.	Home	35	W.							
	4/28/28	Stanford Mrs. J. L.	D.		Pd.	Pd.	Teacher	52	W.							
	10/8/28	Snyder R. J.			Pd.	Pd.	Electrician	51	W.							

COUNTY, FLORIDA

WALKER, EVANS & COBBSWELL CO., CHARLESTON, S. C.

OFFICIAL REGISTER OF ELECTORS FOR

PRECINCT,

COUNTY, FLORIDA

WALKER, EVANS & COGSWELL CO., CHARLESTON, S. C.

NUMBER	DATE	SURNAME AND GIVEN NAME	PARTY AFFILIATION	VOTED	POLL TAX		OCCUPATION	AGE	COLOR	NATIVITY	DECLARATION OR NATURALIZATION	RESIDENCE	OATH I, having been first duly sworn, say, upon Oath that the statements here entered opposite my name as to qualifications as an elector, are true	SIGNATURE OF SUPERVISOR OR DEPUTY	REMARKS
					Year	Year							SIGNATURE OF ELECTOR		
					1926	1927									
	7/23/22	Underwood, J. A.					Farmer	52	W			0 case		J. J. Anderson, Reg. M. L. A.	
	7/30/22	Underwood, A. A.					"	26	W					John J. Anderson	
		Upshaw Upsher												John J. Anderson	
	3/27/28	Upshaw C. C.	D.				Farmer	31	W					John J. Anderson	

OFFICIAL REGISTER OF ELECTORS FOR

PRECINCT,

COUNTY, FLORIDA

NUMBER	DATE	SURNAME AND GIVEN NAME	PARTY AFFILIATION	VOTED	POLL TAX		OCCUPATION	AGE	COLOR	NATIVITY	DECLARATION OR NATURALIZATION	RESIDENCE	OATH	SIGNATURE OF SUPERVISOR OR DEPUTY	REMARKS
					Year 1926	Year 1927							I, having been first duly sworn, say, upon Oath that the statements here entered opposite my name as to qualifications as an elector, are true		
✓ 2/8/14		West, S. D.			PD.	Pl.	Farmer.	42	W			Deer.		J. J. Anderson, By M. & A.	
2/14/14		Witty, J. L.			Ex	Ex.	"	61	W					John J. Anderson	
2/11/14		Whittaker, R. J.			PD.	PD.	"	33	W					John J. Anderson	
3/24/16		Watson, M. C.					"							John J. Anderson	
3/14/20		Wilson, W. J. B.			PD.	PD.	"	27	W					John J. Anderson	
4/24/20		Wilson, W. H.			Ex	Ex.	"	69	W					John J. Anderson	
8/16/20		Wilson, Mrs. W. H.			Ex	Ex.	Home.	63	W					John J. Anderson	
9/22/20		Wofford, A. M.			Pl.	Pl.	Farmer.	43	W					John J. Anderson	
9/24/20		Watson, Mrs. M. C.					Home.	45	W					John J. Anderson	
9/24/20		Whittaker, Mrs. R. J.			PD.	PD.	"	34	W					John J. Anderson	
3/14/22		White, J.					Farmer.	40	W					John J. Anderson	
3/20/22		Wallace, J. F.			Ex	Ex.	"	64	W					John J. Anderson	
3/31/22		Whilden, A. D.					"	25	W					John J. Anderson	
4/25/22		Washburn, Geo. A.			Ex	Ex.	"	52	W					John J. Anderson	
4/26/22		White, Milford.			PD.	PD.	"	31	W					John J. Anderson	
7/21/22		Washburn, Mr. G. A.					Home.	47	W					John J. Anderson	
7/23/22		Whittaker, J. E.					Farmer.	34	W					John J. Anderson	
3/4/24		White, Rosa Bell.					Teacher.	31	W					John J. Anderson	
3/6/24		West, P. J.			PD.	PD.	Banker.	22	W					John J. Anderson	
3/6/24		Walker, P. H.					Carp.	39	W					John J. Anderson	
3/20/24		Windham, L. C.			Ex	Ex.	Farmer.	55	W					John J. Anderson	
4/24/24		Wilson, D. S.			Pl.	Pl.	"	23	W					John J. Anderson	
7/14/24		Watson, D. S.	D.		PD.	PD.	Mechanic.	21	W					John J. Anderson	
3/28/28		Wofford Everett	D.		Ex	Pl.	Farmer	23	W					John J. Anderson	
3/31/28		Wurst O'Mura M.	D		Ex	Pl.	Home	21	W					John J. Anderson	
4/28/28		Webb, L. L.	R.		Pl	Pl.	Foreman.	42	W					John J. Anderson	
10/1/28		Walker Mrs J. K.			Ex	Ex	Home	79	W						

PRECINCT, _____

WALKER, EVANS & COGSWELL CO., CHARLESTON, S. C

